

3-BEDROOM DELUXE

TYPE C1-G

872 sqft / 81 sqm

(inclusive of 5 sqm PES & 5 sqm AC Ledge)

Blk 127, #01-17

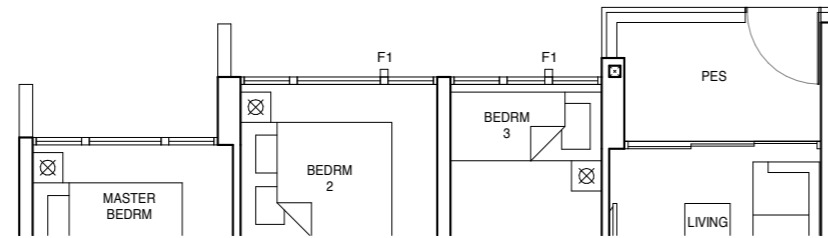

TYPE C1

872 sqft / 81 sqm

(inclusive of 5 sqm Balcony & 5 sqm AC Ledge)

Blk 127, #02-17 to #15-17

TYPE C1-PH

1066 sqft / 99 sqm

(inclusive of 5 sqm Balcony, 5 sqm AC Ledge & 18 sqm void over Living/Dining)

Blk 127, #16-17

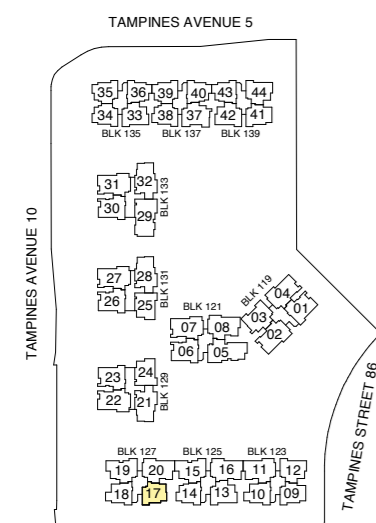
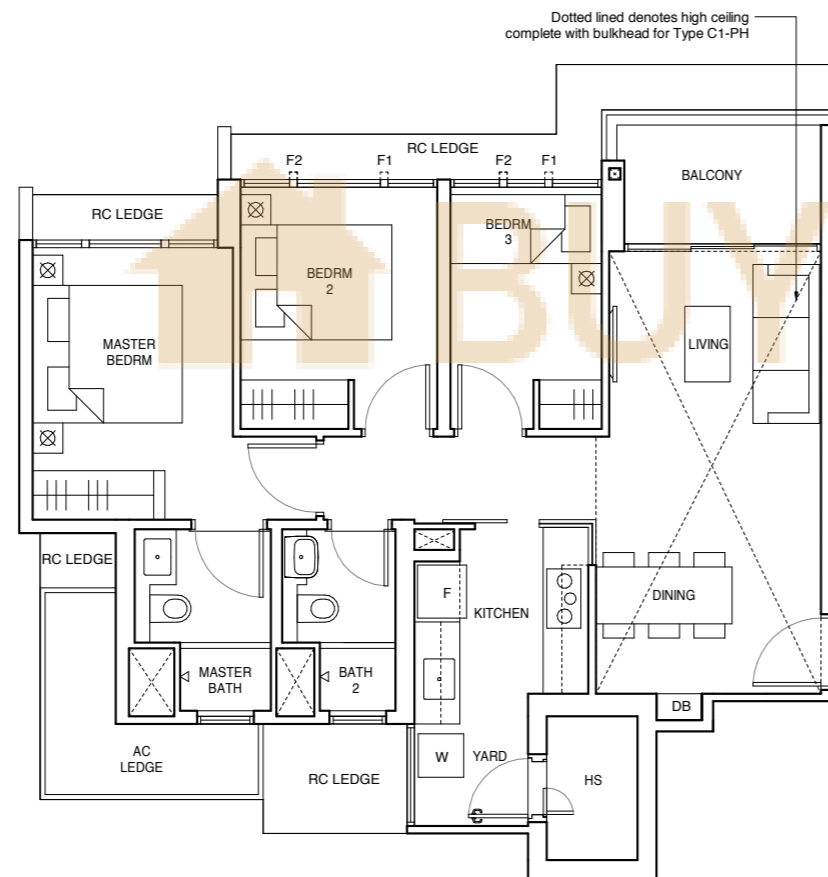

KEY PLAN
NOT TO SCALE

LEGEND

HS - Household Shelter W - Washer F - Fridge DB - Distribution Board * - Mirrored Unit

FULL HEIGHT ALUMINIUM FIN LOCATED AT LEVELS:
F1 - #01-17, #02-17, #05-17, #06-17, #09-17, #10-17, #13-17 & #14-17
F2 - #03-17, #04-17, #07-17, #08-17, #11-17, #12-17, #15-17 & #16-17



ALL PLANS ARE SUBJECT TO CHANGES BY THE RELEVANT AUTHORITIES. MEASUREMENTS ARE APPROXIMATE ONLY AND SUBJECT TO FINAL SURVEY. INFORMATION ACCURATE AT THE POINT OF PRINTING.
BP No : A1720-00006-2019-BP01 DATED 11 AUG 2020, A1720-00006-2019-BP02 DATED 12 OCT 2020

3-BEDROOM DELUXE

TYPE C2-G

893 sqft / 83 sqm

(inclusive of 5 sqm PES & 6 sqm AC Ledge)

Blk 125, #01-14

Blk 135, #01-36

Blk 137, #01-40

Blk 139, #01-43*

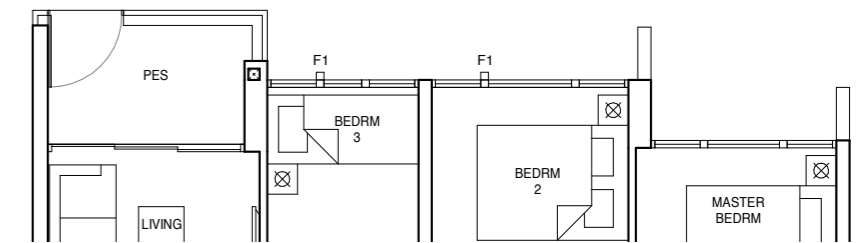

TYPE C2

893 sqft / 83 sqm

(inclusive of 5 sqm Balcony & 6 sqm AC Ledge)

Blk 125, #02-14 to #15-14

Blk 135, #02-36 to #15-36

Blk 137, #02-40 to #15-40

Blk 139, #02-43* to #15-43*

TYPE C2-PH

1098 sqft / 102 sqm

(inclusive of 5 sqm Balcony, 6 sqm AC Ledge & 19 sqm void over Living/Dining)

Blk 125, #16-14

Blk 135, #16-36

Blk 137, #16-40

Blk 139, #16-43*

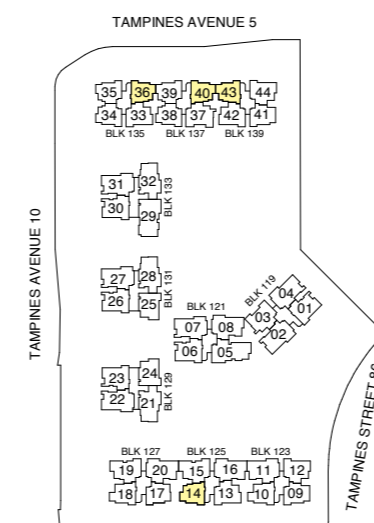
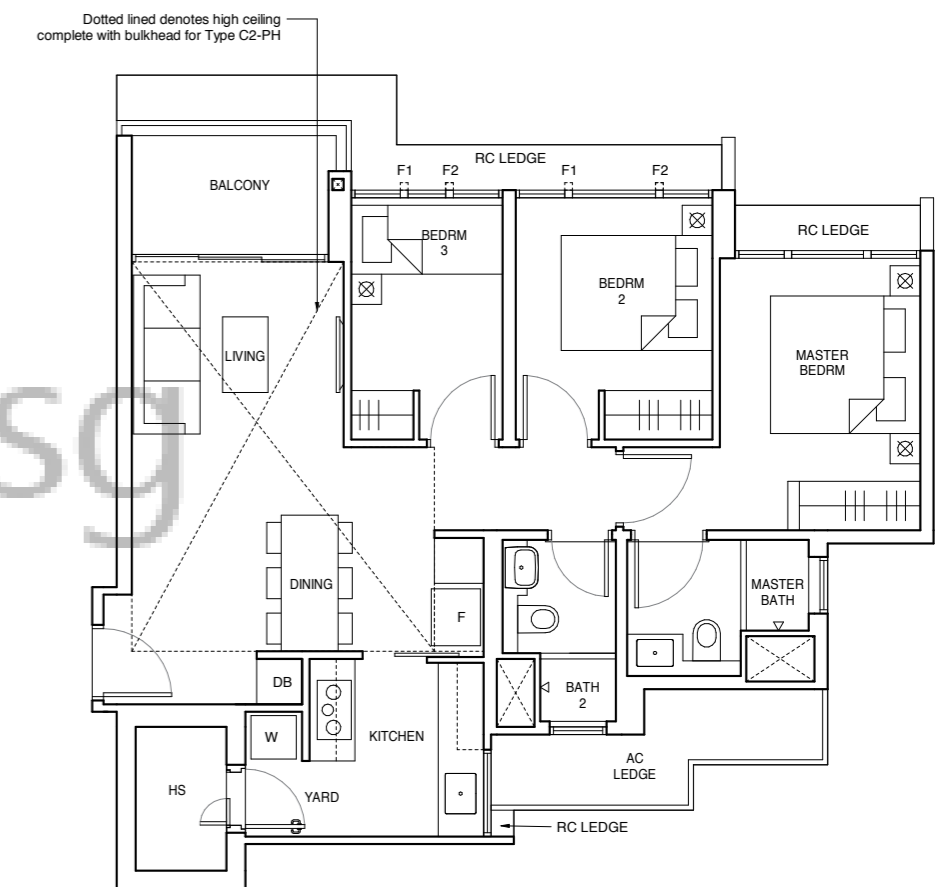

KEY PLAN
NOT TO SCALE

LEGEND

HS - Household Shelter W - Washer F - Fridge DB - Distribution Board * - Mirrored Unit

FULL HEIGHT ALUMINIUM FIN LOCATED AT LEVELS:

F1 - #01-14, #01-36, #01-40, #01-43*, #02-14, #02-36, #02-40, #02-43*, #05-14, #05-36, #05-40, #05-43*, #06-14, #06-36, #06-40, #06-43*, #09-14, #09-36, #09-40, #09-43*, #10-14, #10-36, #10-40, #10-43*, #13-14, #13-36, #13-40, #13-43*, #14-14, #14-36, #14-40 & #14-43*
F2 - #03-14, #03-36, #03-40, #03-43*, #04-14, #04-36, #04-40, #04-43*, #07-14, #07-36, #07-40, #07-43*, #08-14, #08-36, #08-40, #08-43*, #11-14, #11-36, #11-40, #11-43*, #12-14, #12-36, #12-40, #12-43*, #15-14, #15-36, #15-40, #15-43*, #16-14, #16-36, #16-40 & #16-43*

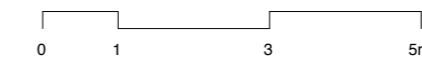

ALL PLANS ARE SUBJECT TO CHANGES BY THE RELEVANT AUTHORITIES. MEASUREMENTS ARE APPROXIMATE ONLY AND SUBJECT TO FINAL SURVEY. INFORMATION ACCURATE AT THE POINT OF PRINTING.
BP No : A1720-00006-2019-BP01 DATED 11 AUG 2020, A1720-00006-2019-BP02 DATED 12 OCT 2020

3-BEDROOM PREMIUM

3-BEDROOM PREMIUM

TYPE C3-G

926 sqft / 86 sqm

(inclusive of 5 sqm PES & 6 sqm AC Ledge)

Blk 135, #01-34
 #01-35*
 Blk 137, #01-38
 #01-39*

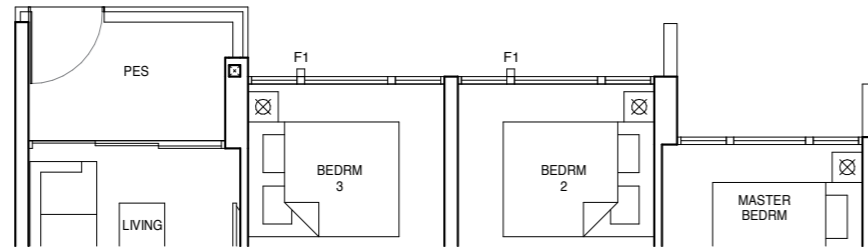

TYPE C4-G

926 sqft / 86 sqm

(inclusive of 5 sqm PES & 5 sqm AC Ledge)

Blk 123, #01-09
 Blk 139, #01-41

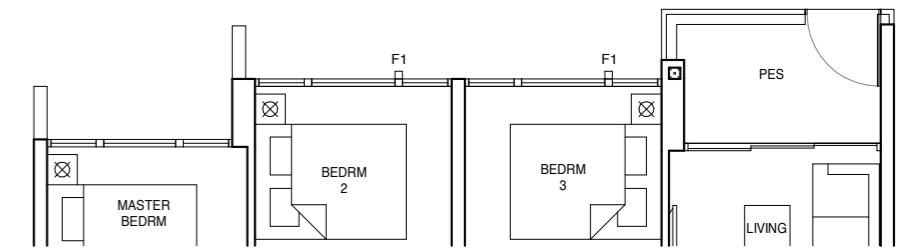

TYPE C3

926 sqft / 86 sqm

(inclusive of 5 sqm Balcony & 6 sqm AC Ledge)

Blk 135, #02-34 to #15-34
 #02-35* to #15-35*
 Blk 137, #02-38 to #15-38
 #02-39* to #15-39*

TYPE C3-PH

1130 sqft / 105 sqm

(inclusive of 5 sqm Balcony, 6 sqm AC Ledge & 19 sqm void over Living/Dining)

Blk 135, #16-34
 #16-35*
 Blk 137, #16-38
 #16-39*

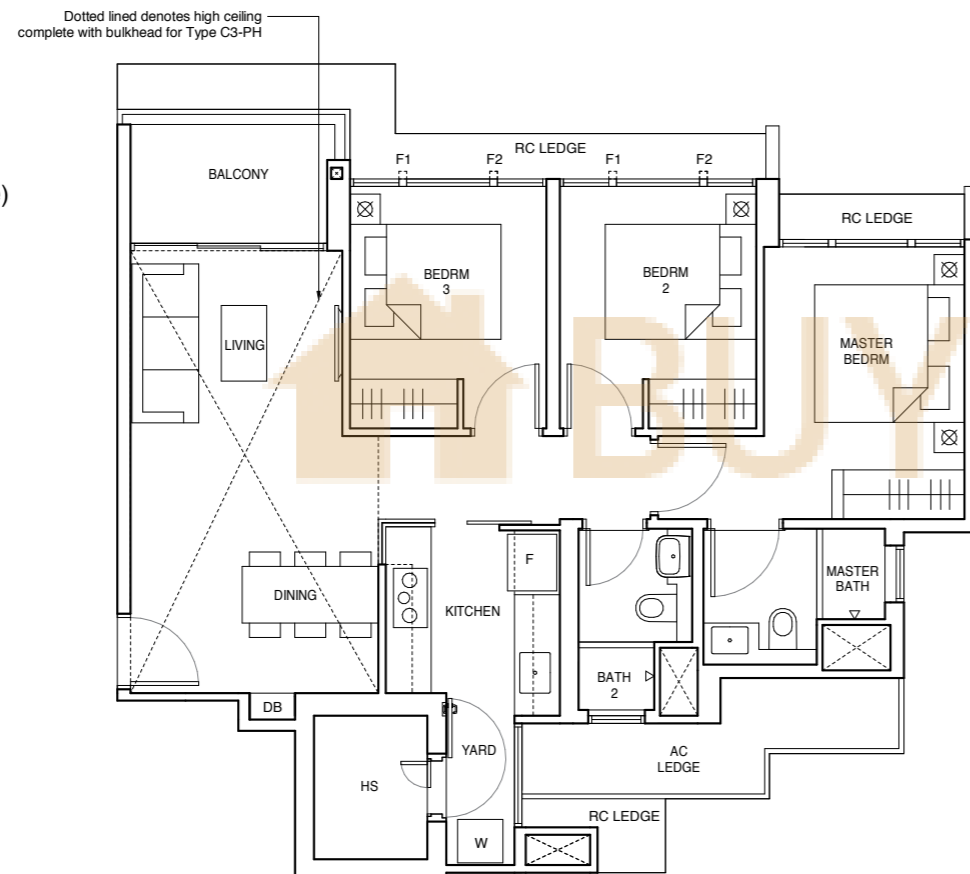

TYPE C4

926 sqft / 86 sqm

(inclusive of 5 sqm Balcony & 5 sqm AC Ledge)

Blk 123, #02-09 to #15-09
 Blk 139, #02-41 to #15-41

TYPE C4-PH

1130 sqft / 105 sqm

(inclusive of 5 sqm Balcony, 5 sqm AC Ledge & 19 sqm void over Living/Dining)

Blk 123, #16-09
 Blk 139, #16-41

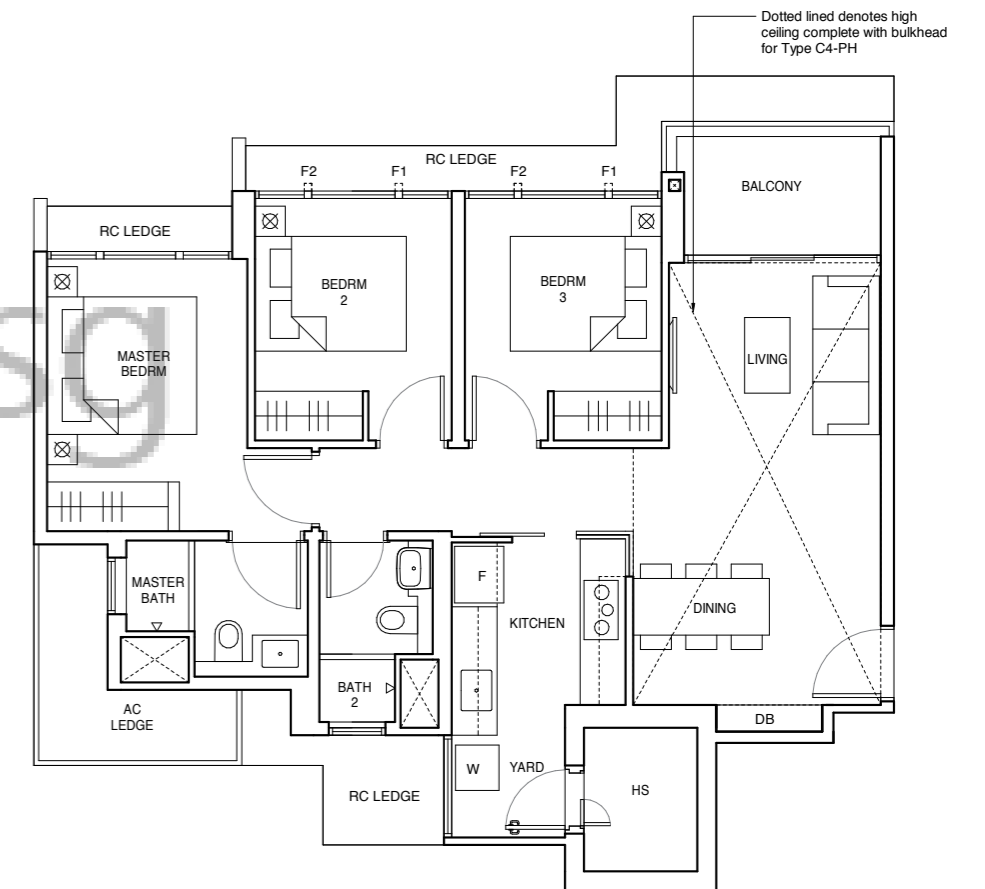

LEGEND

HS - Household Shelter W - Washer F - Fridge DB - Distribution Board * - Mirrored Unit

FULL HEIGHT ALUMINIUM FIN LOCATED AT LEVELS:
 F1 - #01-34, #01-35*, #01-38, #01-39*, #02-34, #02-35*, #02-38, #02-39*, #05-34, #05-35*, #05-38, #05-39*, #06-34, #06-35*, #06-38, #06-39*, #09-34, #09-35*, #09-38, #09-39*, #10-34, #10-35*, #10-38, #10-39*, #13-34, #13-35*, #13-38, #13-39*, #14-34, #14-35*, #14-38 & #14-39*
 F2 - #03-34, #03-35*, #03-38, #03-39*, #04-34, #04-35*, #04-38, #04-39*, #07-34, #07-35*, #07-38, #07-39*, #08-34, #08-35*, #08-38, #08-39*, #11-34, #11-35*, #11-38, #11-39*, #12-34, #12-35*, #12-38, #12-39*, #15-34, #15-35*, #15-38, #15-39*, #16-34, #16-35*, #16-38 & #16-39*

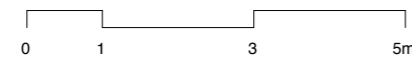

ALL PLANS ARE SUBJECT TO CHANGES BY THE RELEVANT AUTHORITIES. MEASUREMENTS ARE APPROXIMATE ONLY AND SUBJECT TO FINAL SURVEY. INFORMATION ACCURATE AT THE POINT OF PRINTING.
 BP No : A1720-00006-2019-BP01 DATED 11 AUG 2020, A1720-00006-2019-BP02 DATED 12 OCT 2020

KEY PLAN
 NOT TO SCALE



LEGEND

HS - Household Shelter W - Washer F - Fridge DB - Distribution Board * - Mirrored Unit

FULL HEIGHT ALUMINIUM FIN LOCATED AT LEVELS:
 F1 - #01-09, #01-41, #02-09, #02-41, #05-09, #05-41, #06-09, #06-41, #09-09, #09-41, #10-09, #10-41, #13-09, #13-41, #14-09 & #14-41
 F2 - #03-09, #03-41, #04-09, #04-41, #07-09, #07-41, #08-09, #08-41, #11-09, #11-41, #12-09, #12-41, #15-09, #15-41, #16-09 & #16-41

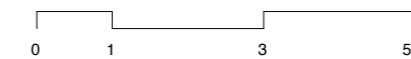

ALL PLANS ARE SUBJECT TO CHANGES BY THE RELEVANT AUTHORITIES. MEASUREMENTS ARE APPROXIMATE ONLY AND SUBJECT TO FINAL SURVEY. INFORMATION ACCURATE AT THE POINT OF PRINTING.
 BP No : A1720-00006-2019-BP01 DATED 11 AUG 2020, A1720-00006-2019-BP02 DATED 12 OCT 2020

KEY PLAN
 NOT TO SCALE

3-BEDROOM PREMIUM

3-BEDROOM LUXURY

TYPE C5-G

936 sqft / 87 sqm

(inclusive of 5 sqm PES & 4 sqm AC Ledge)

Blk 123, #01-10
Blk 127, #01-18

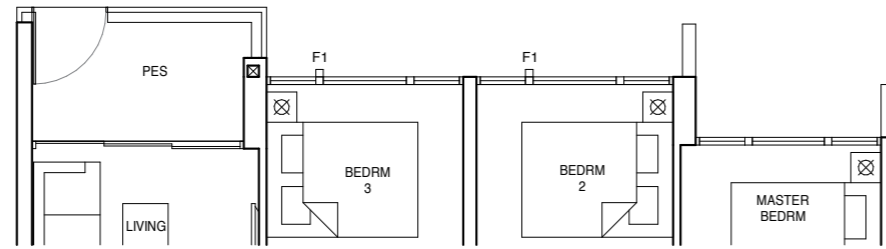

TYPE C6-G

990 sqft / 92 sqm

(inclusive of 5 sqm PES & 5 sqm AC Ledge)

Blk 123, #01-12
Blk 125, #01-13*
Blk 135, #01-33*
Blk 139, #01-42
#01-44

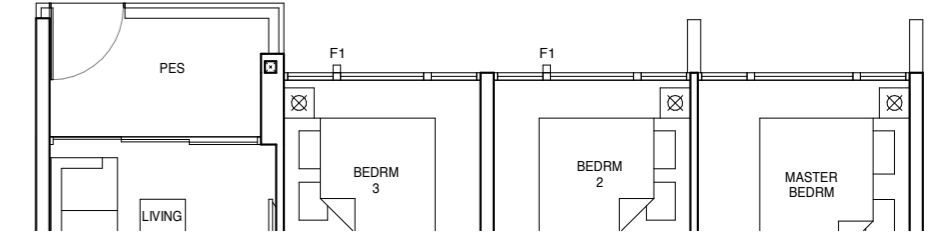

TYPE C5

936 sqft / 87 sqm

(inclusive of 5 sqm Balcony & 4 sqm AC Ledge)

Blk 123, #02-10 to #15-10
Blk 127, #02-18 to #15-18

TYPE C5-PH

1152 sqft / 107 sqm

(inclusive of 5 sqm Balcony, 4 sqm AC Ledge & 20 sqm void over Living/Dining)

Blk 123, #16-10
Blk 127, #16-18

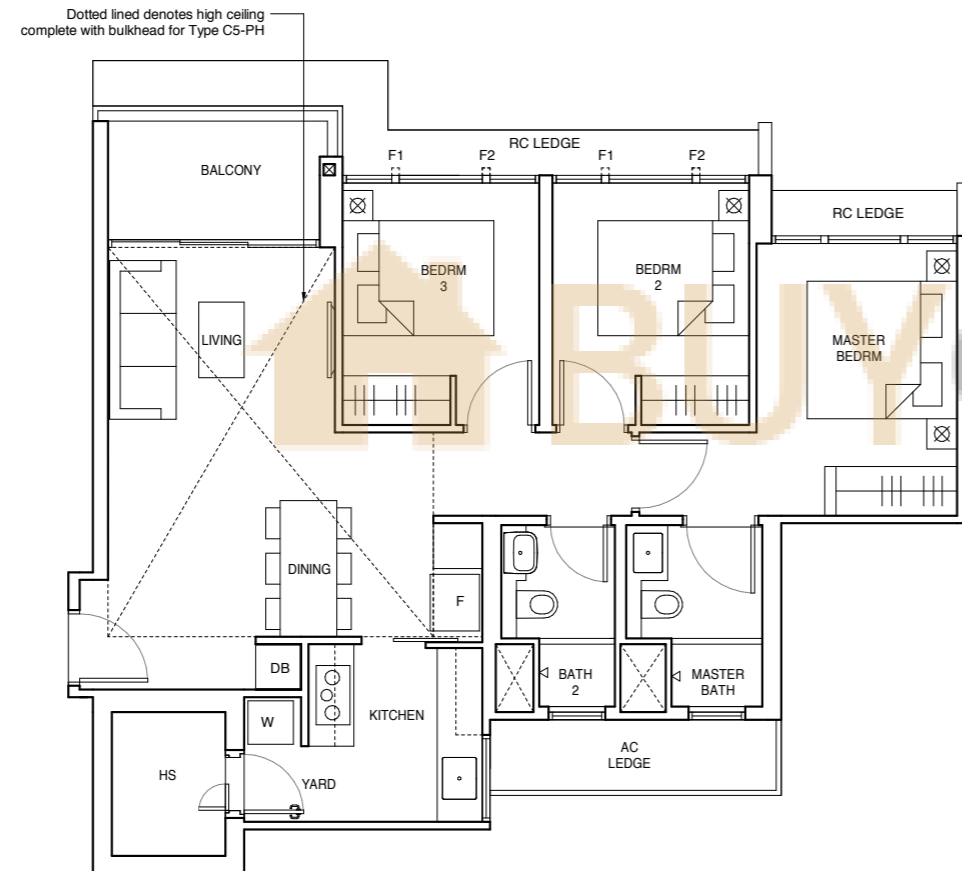

TYPE C6

990 sqft / 92 sqm

(inclusive of 5 sqm Balcony & 5 sqm AC Ledge)

Blk 123, #02-12 to #15-12
Blk 125, #02-13* to #15-13*
Blk 135, #02-33* to #15-33*
Blk 139, #02-42 to #15-42
#02-44 to #15-44

TYPE C6-PH

1206 sqft / 112 sqm

(inclusive of 5 sqm Balcony, 5 sqm AC Ledge & 20 sqm void over Living/Dining)

Blk 123, #16-12
Blk 125, #16-13*
Blk 135, #16-33*
Blk 139, #16-42
#16-44

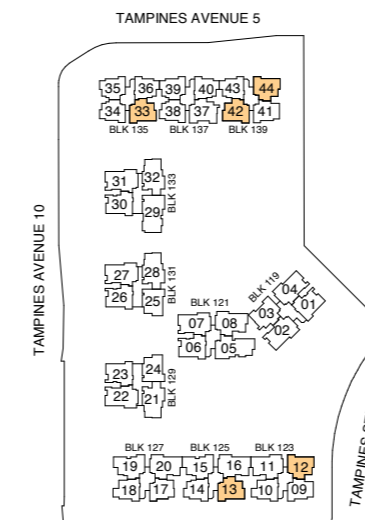
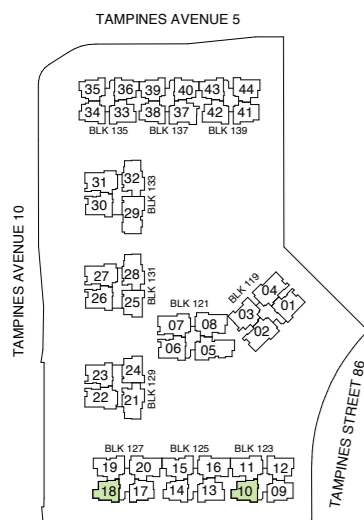
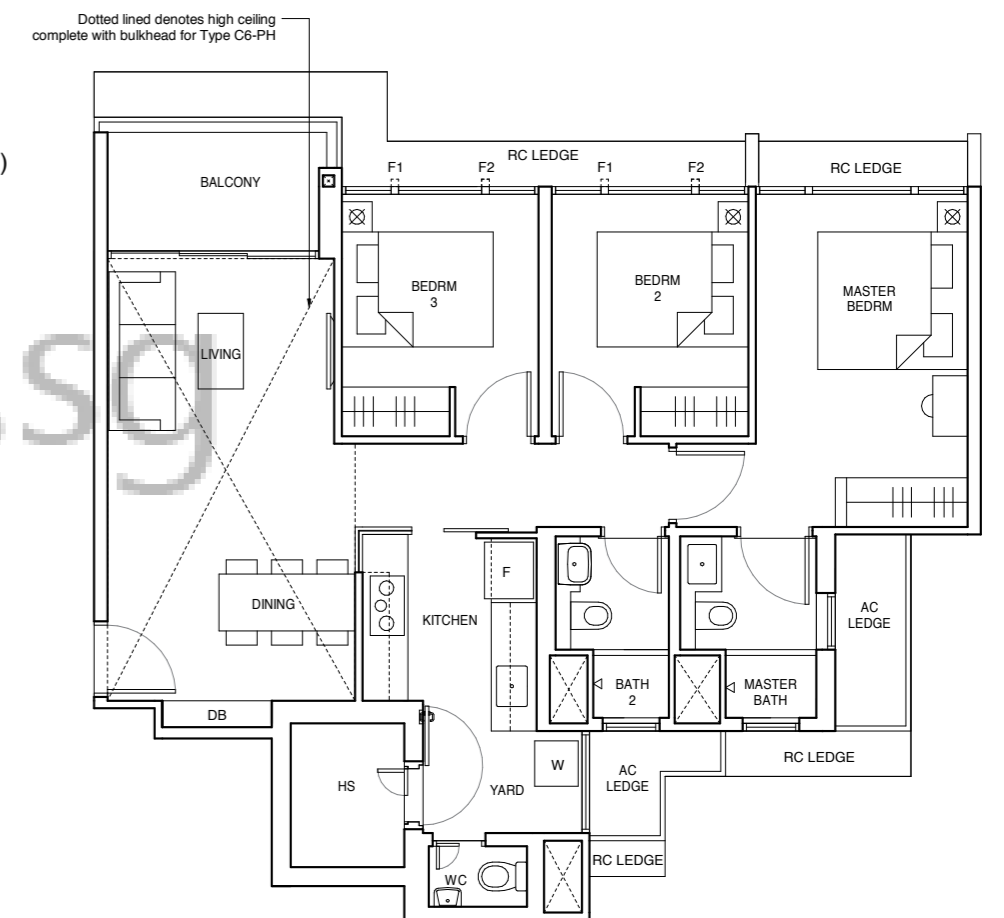

LEGEND

HS - Household Shelter W - Washer F - Fridge DB - Distribution Board * - Mirrored Unit

FULL HEIGHT ALUMINIUM FIN LOCATED AT LEVELS:

F1 - #01-10, #01-18, #02-10, #02-18, #05-10, #05-18, #06-10, #06-18, #09-10, #09-18, #10-10, #10-18, #13-10, #13-18, #14-10 & #14-18

F2 - #03-10, #03-18, #04-10, #04-18, #07-10, #07-18, #08-10, #08-18, #11-10, #11-18, #12-10, #12-18, #15-10, #15-18, #16-10 & #16-18

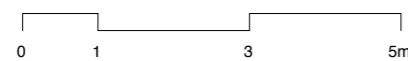

ALL PLANS ARE SUBJECT TO CHANGES BY THE RELEVANT AUTHORITIES. MEASUREMENTS ARE APPROXIMATE ONLY AND SUBJECT TO FINAL SURVEY. INFORMATION ACCURATE AT THE POINT OF PRINTING. BP No : A1720-00006-2019-BP01 DATED 11 AUG 2020, A1720-00006-2019-BP02 DATED 12 OCT 2020

KEY PLAN
NOT TO SCALE

LEGEND

HS - Household Shelter W - Washer F - Fridge DB - Distribution Board * - Mirrored Unit

FULL HEIGHT ALUMINIUM FIN LOCATED AT LEVELS:

F1 - #01-12, #01-13*, #01-33*, #01-42, #01-44, #02-12, #02-13*, #02-33*, #02-42, #02-44, #05-12, #05-13*, #05-33*, #05-42, #05-44, #06-12, #06-13*, #06-33*, #06-42, #06-44, #09-12, #09-13*, #09-33*, #09-42, #09-44, #10-12, #10-13*, #10-33*, #10-42, #10-44, #13-12, #13-13*, #13-33*, #13-42, #13-44, #14-12, #14-13*, #14-33*, #14-42 & #14-44

F2 - #03-12, #03-13*, #03-33*, #03-42, #03-44, #04-12, #04-13*, #04-33*, #04-42, #04-44, #07-12, #07-13*, #07-33*, #07-42, #07-44, #08-12, #08-13*, #08-33*, #08-42, #08-44, #11-12, #11-13*, #11-33*, #11-42, #11-44, #12-12, #12-13*, #12-33*, #12-42, #12-44, #15-12, #15-13*, #15-33*, #15-42, #15-44, #16-12, #16-13*, #16-33*, #16-42 & #16-44

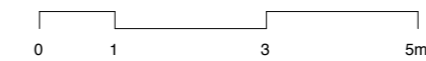

ALL PLANS ARE SUBJECT TO CHANGES BY THE RELEVANT AUTHORITIES. MEASUREMENTS ARE APPROXIMATE ONLY AND SUBJECT TO FINAL SURVEY. INFORMATION ACCURATE AT THE POINT OF PRINTING. BP No : A1720-00006-2019-BP01 DATED 11 AUG 2020, A1720-00006-2019-BP02 DATED 12 OCT 2020

KEY PLAN
NOT TO SCALE

3-BEDROOM LUXURY

TYPE C7-G

1023 sqft / 95 sqm

(inclusive of 5 sqm PES & 5 sqm AC Ledge)

Blk 129, #01-24*
Blk 131, #01-25

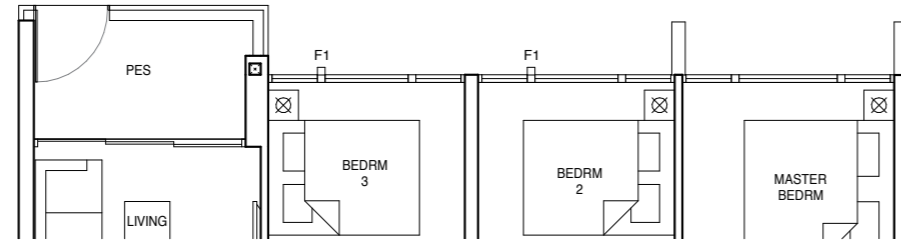

TYPE C7

1023 sqft / 95 sqm

(inclusive of 5 sqm Balcony & 5 sqm AC Ledge)

Blk 129, #02-24* to #15-24*
Blk 131, #02-25 to #15-25

TYPE C7-PH

1216 sqft / 113 sqm

(inclusive of 5 sqm Balcony, 5 sqm AC Ledge & 18 sqm void over Living/Dining)

Blk 129, #16-24*
Blk 131, #16-25

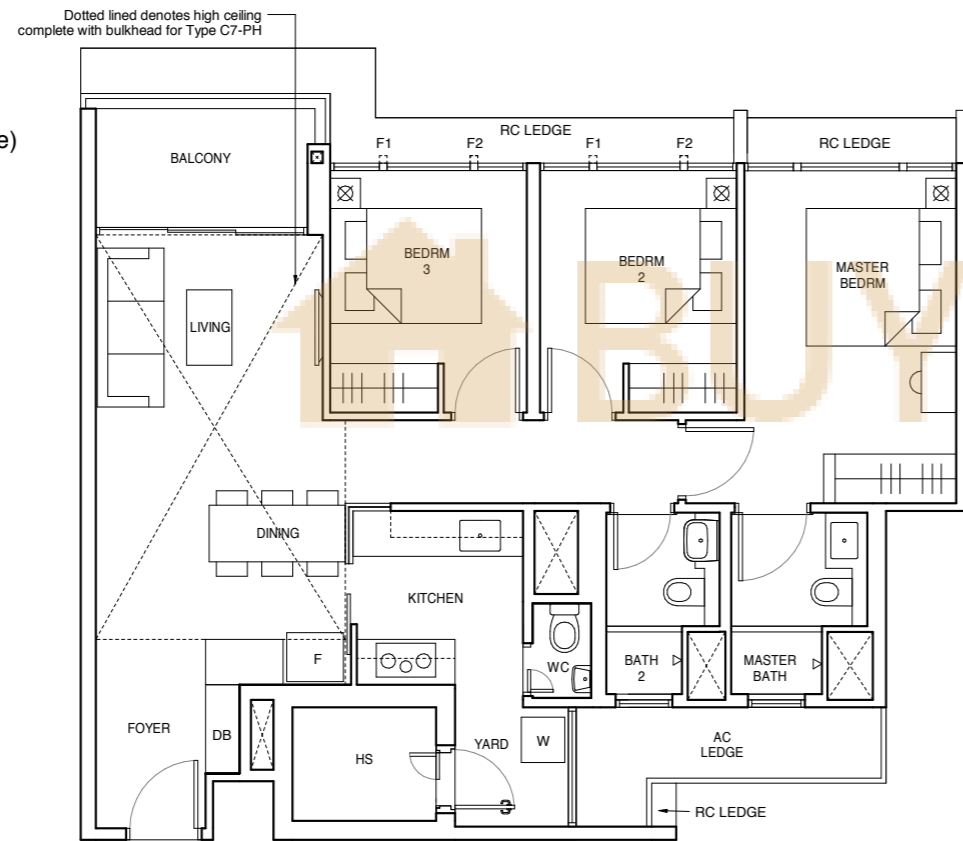

KEY PLAN
NOT TO SCALE

LEGEND

HS - Household Shelter W - Washer F - Fridge DB - Distribution Board * - Mirrored Unit

FULL HEIGHT ALUMINIUM FIN LOCATED AT LEVELS:

F1 - #01-24*, #01-25, #02-24*, #02-25, #05-24*, #05-25, #06-24*, #06-25, #09-24*, #09-25, #10-24*, #10-25, #13-24*, #13-25, #14-24* & #14-25

F2 - #03-24*, #03-25, #04-24*, #04-25, #07-24*, #07-25, #08-24*, #08-25, #11-24*, #11-25, #12-24*, #12-25, #15-24*, #15-25, #16-24* & #16-25

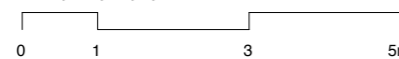

ALL PLANS ARE SUBJECT TO CHANGES BY THE RELEVANT AUTHORITIES. MEASUREMENTS ARE APPROXIMATE ONLY AND SUBJECT TO FINAL SURVEY. INFORMATION ACCURATE AT THE POINT OF PRINTING.
BP No : A1720-00006-2019-BP01 DATED 11 AUG 2020, A1720-00006-2019-BP02 DATED 12 OCT 2020

3-BEDROOM LUXURY

TYPE C8-G

1055 sqft / 98 sqm

(inclusive of 5 sqm PES & 6 sqm AC Ledge)

Blk 119, #02-01
Blk 121, #01-06*
Blk 129, #01-23
Blk 131, #01-26*
Blk 133, #01-30*

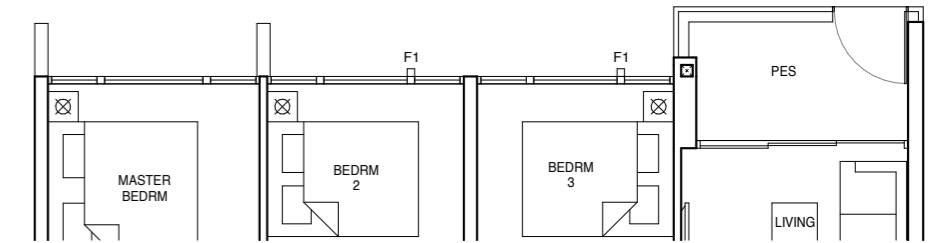

TYPE C8

1055 sqft / 98 sqm

(inclusive of 5 sqm Balcony & 6 sqm AC Ledge)

Blk 119, #03-01 to #15-01
Blk 121, #02-06* to #15-06*
Blk 129, #02-23 to #15-23
Blk 131, #02-26* to #15-26*
Blk 133, #02-30* to #15-30*

TYPE C8-PH

1270 sqft / 118 sqm

(inclusive of 5 sqm Balcony, 6 sqm AC Ledge & 20 sqm void over Living/Dining)

Blk 119, #16-01
Blk 121, #16-06*
Blk 129, #16-23
Blk 131, #16-26*
Blk 133, #16-30*

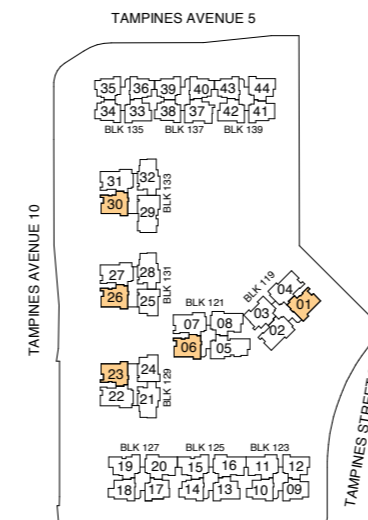
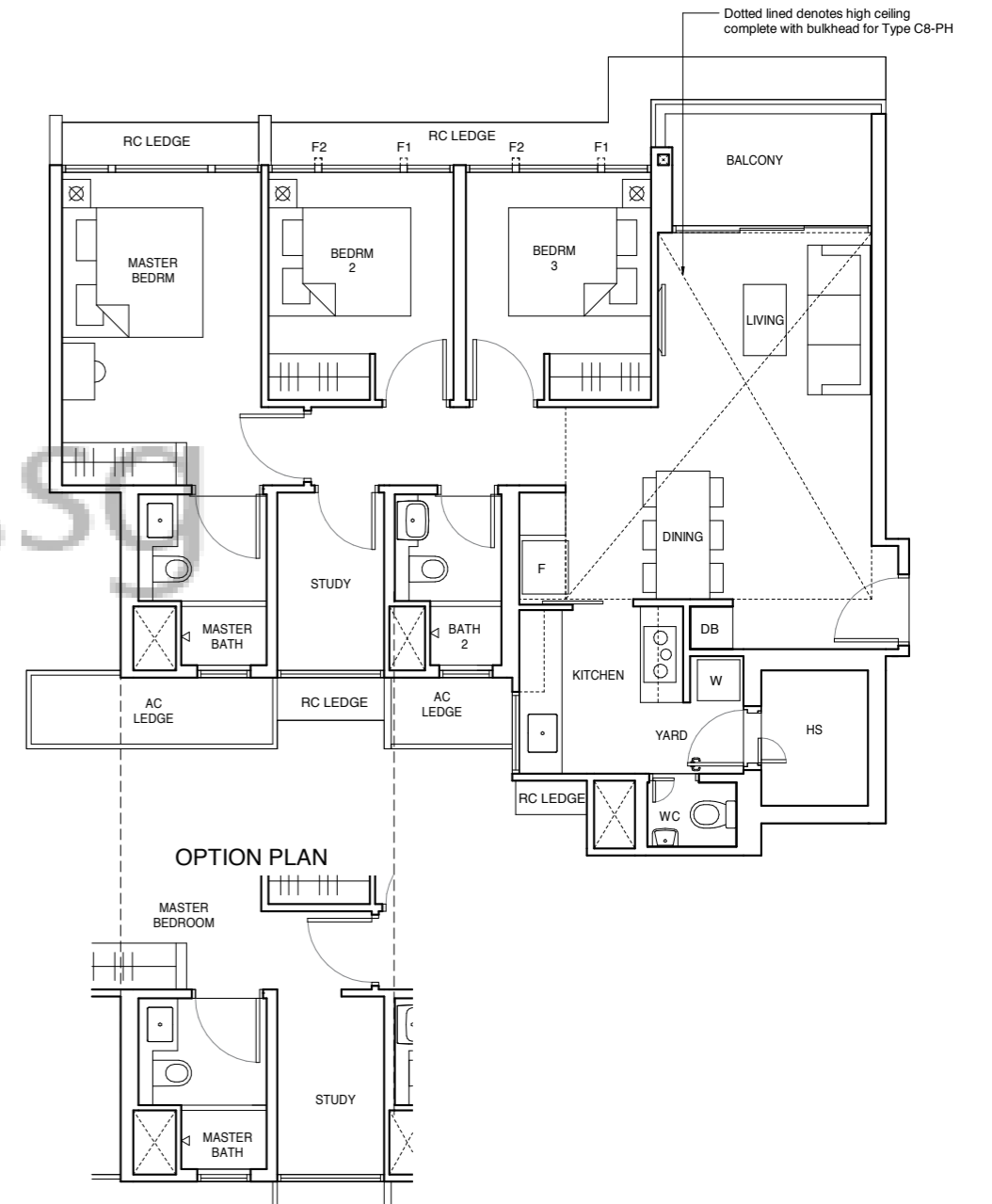

KEY PLAN
NOT TO SCALE

LEGEND

HS - Household Shelter W - Washer F - Fridge DB - Distribution Board * - Mirrored Unit

FULL HEIGHT ALUMINIUM FIN LOCATED AT LEVELS:

F1 - #01-06*, #01-23, #01-26*, #01-30*, #02-01, #02-06*, #02-23, #02-26*, #02-30*, #05-01, #05-06*, #05-23, #05-26*, #05-30*, #06-01, #06-06*, #06-23, #06-26*, #06-30*, #09-01, #09-06*, #09-23, #09-26*, #09-30*, #10-01, #10-06*, #10-23, #10-26*, #10-30*, #13-01, #13-06*, #13-23, #13-26*, #13-30*, #14-01, #14-06*, #14-23, #14-26* & #14-30*

F2 - #03-01, #03-06*, #03-23, #03-26*, #03-30*, #04-01, #04-06*, #04-23, #04-26*, #04-30*, #07-01, #07-06*, #07-23, #07-26*, #07-30*, #08-01, #08-06*, #08-23, #08-26*, #08-30*, #11-01, #11-06*, #11-23, #11-26*, #11-30*, #12-01, #12-06*, #12-23, #12-26*, #12-30*, #15-01, #15-06*, #15-23, #15-26*, #15-30*, #16-01, #16-06*, #16-23, #16-26* & #16-30*



ALL PLANS ARE SUBJECT TO CHANGES BY THE RELEVANT AUTHORITIES. MEASUREMENTS ARE APPROXIMATE ONLY AND SUBJECT TO FINAL SURVEY. INFORMATION ACCURATE AT THE POINT OF PRINTING.
BP No : A1720-00006-2019-BP01 DATED 11 AUG 2020, A1720-00006-2019-BP02 DATED 12 OCT 2020

4-BEDROOM PREMIUM

4-BEDROOM PREMIUM

TYPE D1-G

1109 sqft / 103 sqm

(inclusive of 6 sqm PES & 5 sqm AC Ledge)

Blk 119, #01-03
Blk 137, #01-37

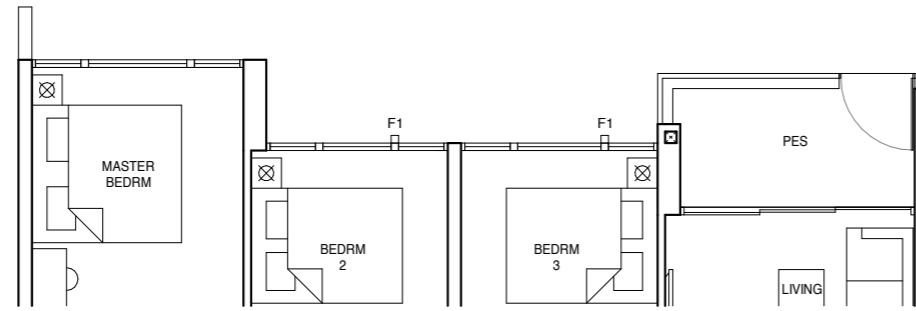

TYPE D2-G

1119 sqft / 104 sqm

(inclusive of 6 sqm PES & 6 sqm AC Ledge)

Blk 125, #01-15
Blk 127, #01-19

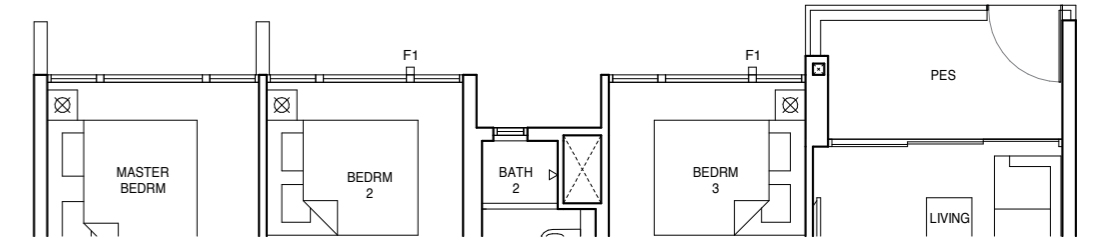

TYPE D1

1109 sqft / 103 sqm

(inclusive of 6 sqm Balcony & 5 sqm AC Ledge)

Blk 119, #02-03 to #15-03
Blk 137, #02-37 to #15-37

TYPE D1-PH

1324 sqft / 123 sqm

(inclusive of 6 sqm Balcony, 5 sqm AC Ledge & 20 sqm void over Living/Dining)

Blk 119, #16-03
Blk 137, #16-37

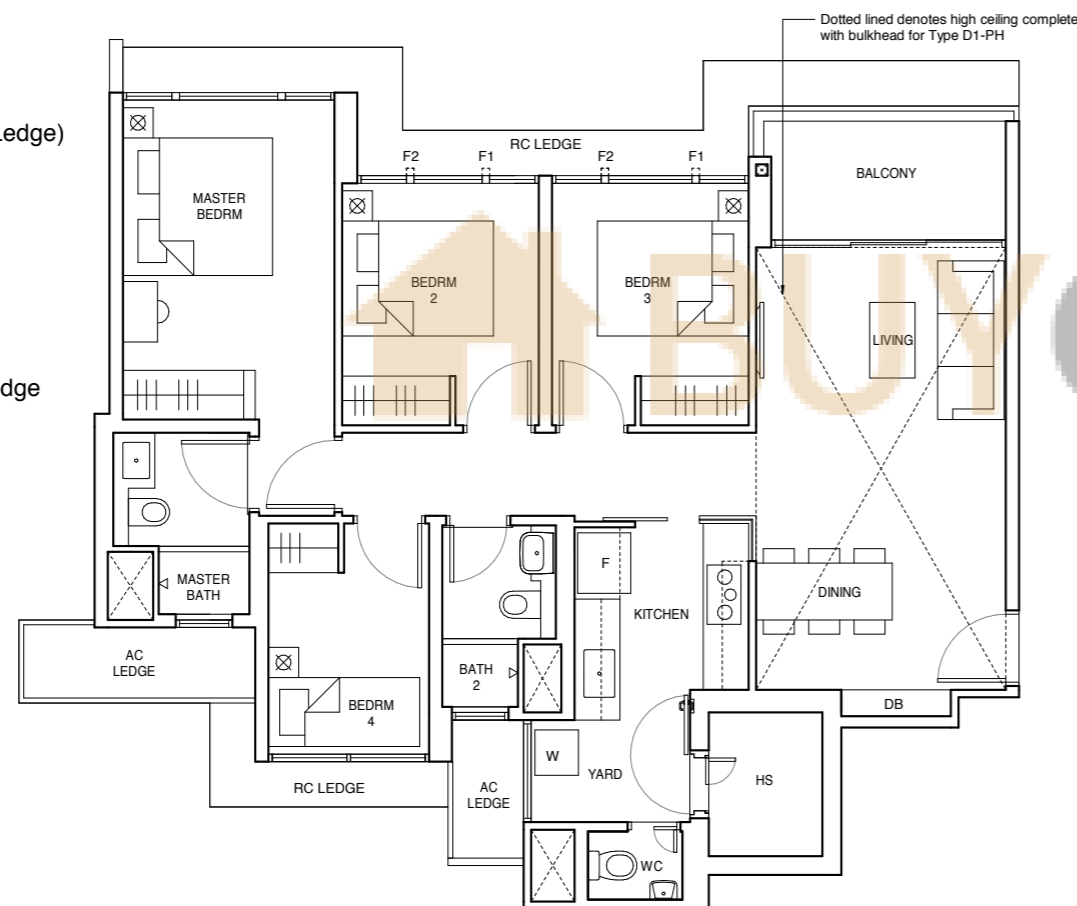

TYPE D2

1119 sqft / 104 sqm

(inclusive of 6 sqm Balcony & 6 sqm AC Ledge)

Blk 125, #02-15 to #15-15
Blk 127, #02-19 to #15-19

TYPE D2-PH

1335 sqft / 124 sqm

(inclusive of 6 sqm Balcony, 6 sqm AC Ledge & 20 sqm void over Living/Dining)

Blk 125, #16-15
Blk 127, #16-19

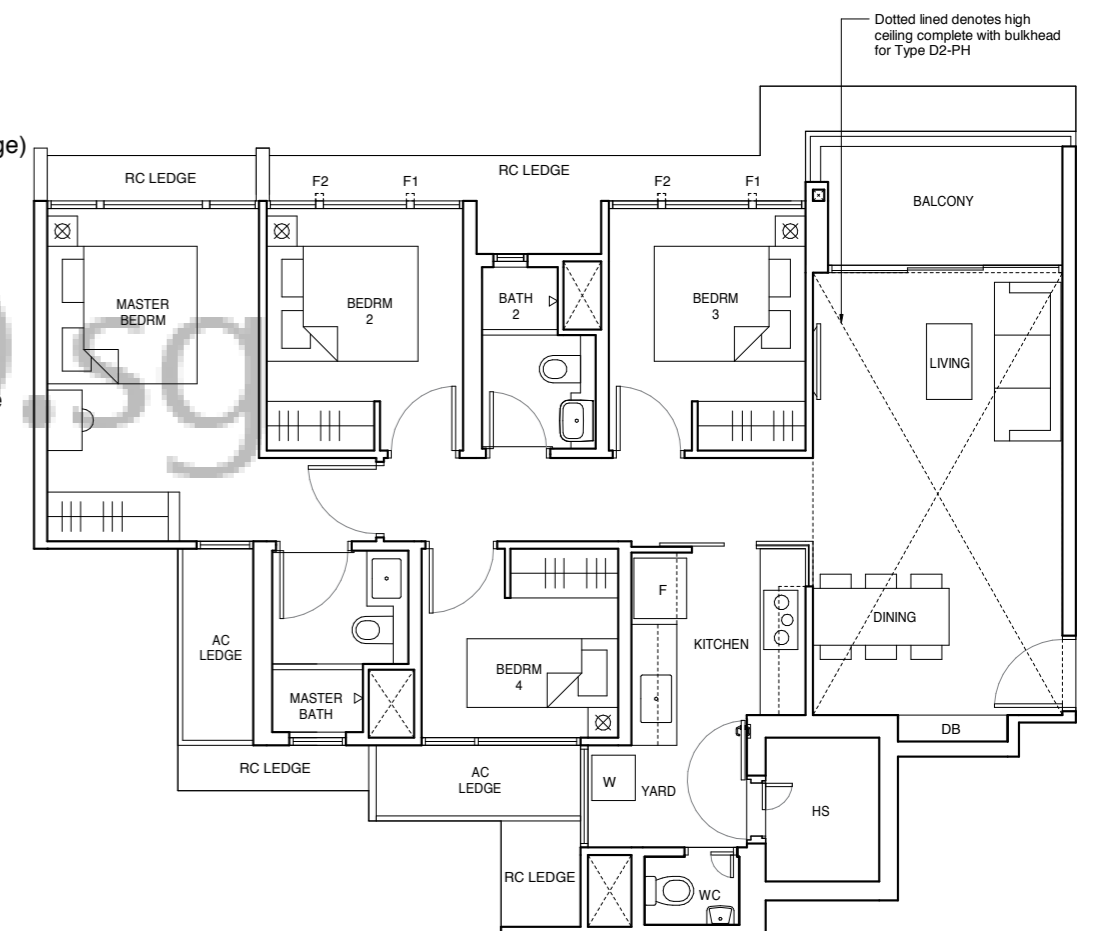

LEGEND
HS - Household Shelter W - Washer F - Fridge DB - Distribution Board * - Mirrored Unit

FULL HEIGHT ALUMINIUM FIN LOCATED AT LEVELS:
F1 - #01-03, #01-37, #02-03, #02-37, #05-03, #05-37, #06-03, #06-37, #09-03, #09-37, #10-03, #10-37, #13-03, #13-37, #14-03 & #14-37

F2 - #03-03, #03-37, #04-03, #04-37, #07-03, #07-37, #08-03, #08-37, #11-03, #11-37, #12-03, #12-37, #15-03, #15-37, #16-03 & #16-37

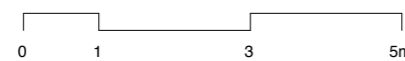

ALL PLANS ARE SUBJECT TO CHANGES BY THE RELEVANT AUTHORITIES. MEASUREMENTS ARE APPROXIMATE ONLY AND SUBJECT TO FINAL SURVEY. INFORMATION ACCURATE AT THE POINT OF PRINTING.
BP No : A1720-00006-2019-BP01 DATED 11 AUG 2020, A1720-00006-2019-BP02 DATED 12 OCT 2020

KEY PLAN
NOT TO SCALE

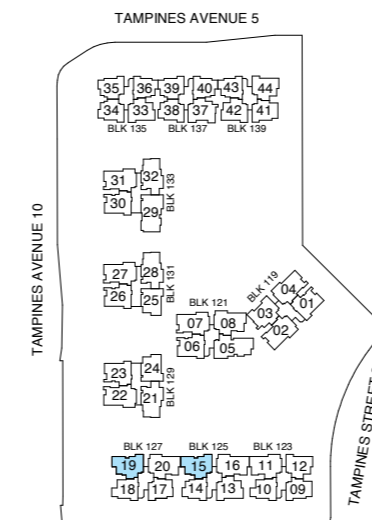

LEGEND
HS - Household Shelter W - Washer F - Fridge DB - Distribution Board * - Mirrored Unit

FULL HEIGHT ALUMINIUM FIN LOCATED AT LEVELS:
F1 - #01-15, #01-19, #02-15, #02-19, #05-15, #05-19, #06-15, #06-19, #09-15, #09-19, #10-15, #10-19, #13-15, #13-19, #14-15 & #14-19

F2 - #03-15, #03-19, #04-15, #04-19, #07-15, #07-19, #08-15, #08-19, #11-15, #11-19, #12-15, #12-19, #15-15, #15-19, #16-15 & #16-19

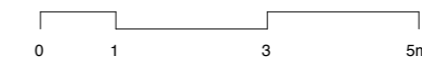

ALL PLANS ARE SUBJECT TO CHANGES BY THE RELEVANT AUTHORITIES. MEASUREMENTS ARE APPROXIMATE ONLY AND SUBJECT TO FINAL SURVEY. INFORMATION ACCURATE AT THE POINT OF PRINTING.
BP No : A1720-00006-2019-BP01 DATED 11 AUG 2020, A1720-00006-2019-BP02 DATED 12 OCT 2020

KEY PLAN
NOT TO SCALE

4-BEDROOM PREMIUM

4-BEDROOM PREMIUM

TYPE D3a-G

1206 sqft / 112 sqm

(inclusive of 10 sqm PES & 5 sqm AC Ledge)

- Blk 119, #02-04*
- Blk 121, #01-07
- Blk 129, #01-22*
- Blk 131, #01-27
- Blk 133, #01-31

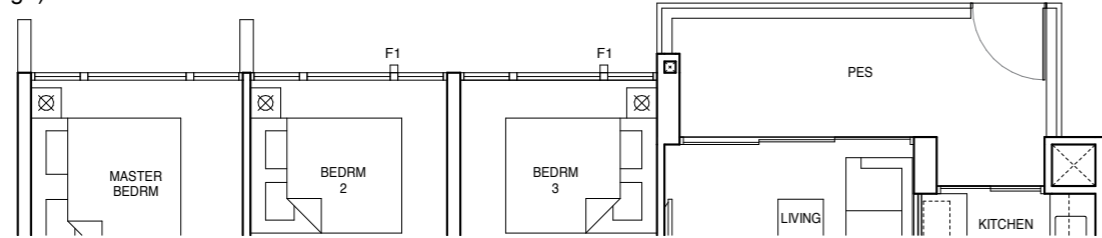

TYPE D3b-G

1206 sqft / 112 sqm

(inclusive of 10 sqm PES & 5 sqm AC Ledge)

- Blk 125, #01-16

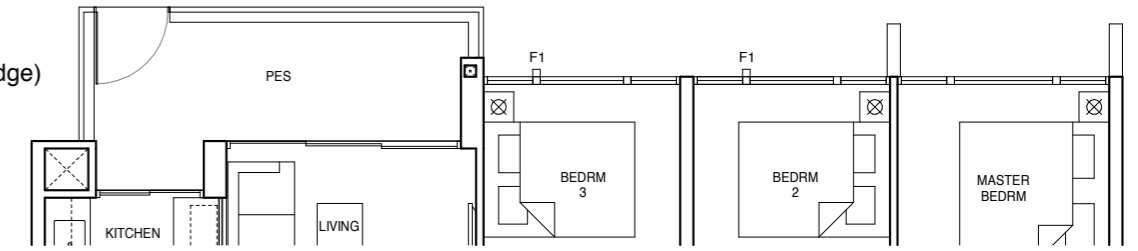

TYPE D3a

1206 sqft / 112 sqm

(inclusive of 10 sqm Balcony & 5 sqm AC Ledge)

- Blk 119, #03-02* to #15-02*
- #03-04* to #15-04*
- Blk 121, #02-07 to #15-07
- Blk 129, #02-22* to #15-22*
- Blk 131, #02-27 to #15-27
- Blk 133, #02-31 to #15-31

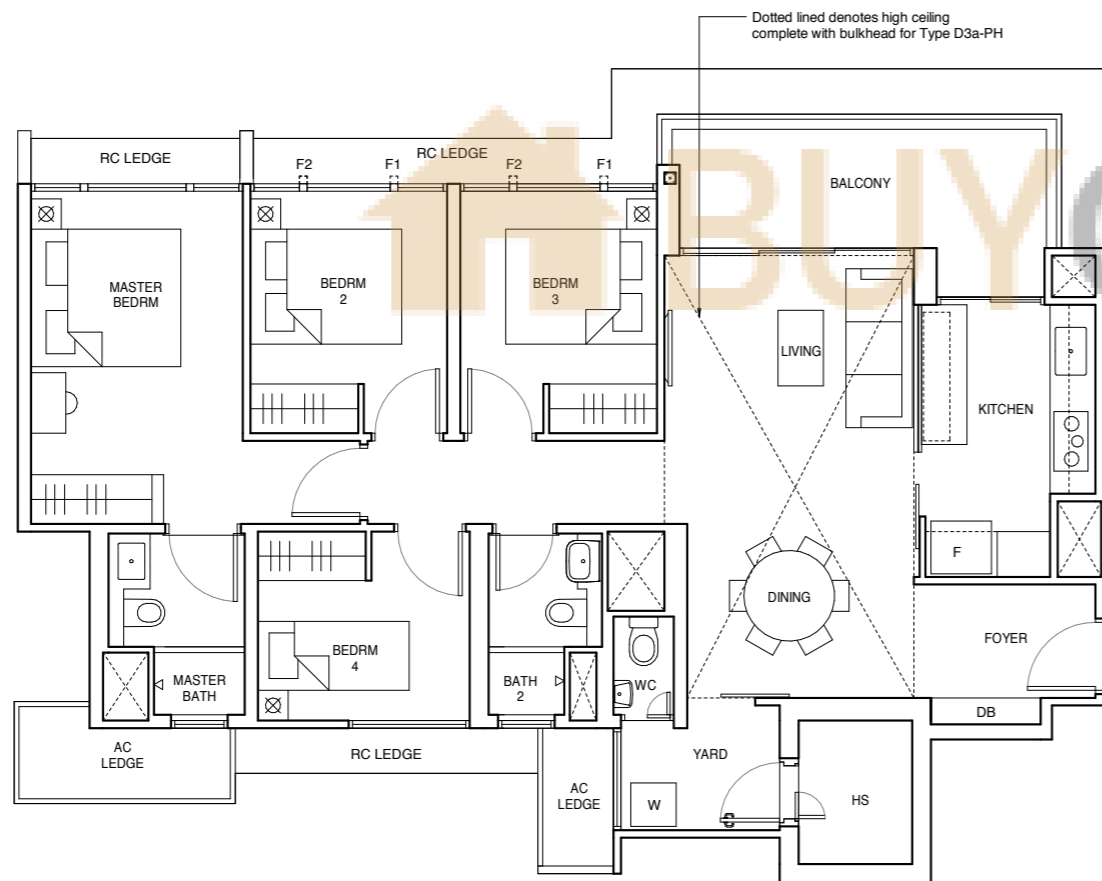

TYPE D3a-PH

1421 sqft / 132 sqm

(inclusive of 10 sqm Balcony, 5 sqm AC Ledge & 20 sqm void over Living/Dining)

- Blk 119, #16-02*
- #16-04*
- Blk 121, #16-07
- Blk 129, #16-22*
- Blk 131, #16-27
- Blk 133, #16-31

TYPE D3b

1206 sqft / 112 sqm

(inclusive of 10 sqm Balcony & 5 sqm AC Ledge)

- Blk 125, #02-16 to #15-16

TYPE D3b-PH

1421 sqft / 132 sqm

(inclusive of 10 sqm Balcony, 5 sqm AC Ledge & 20 sqm void over Living/Dining)

- Blk 125, #16-16

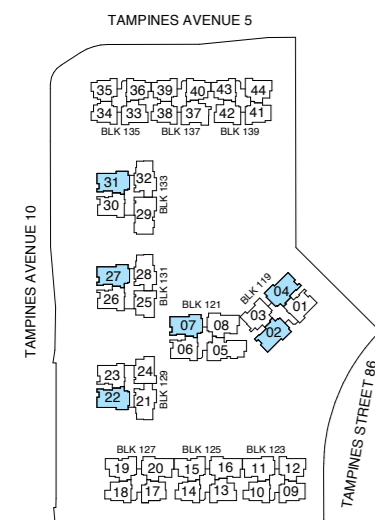
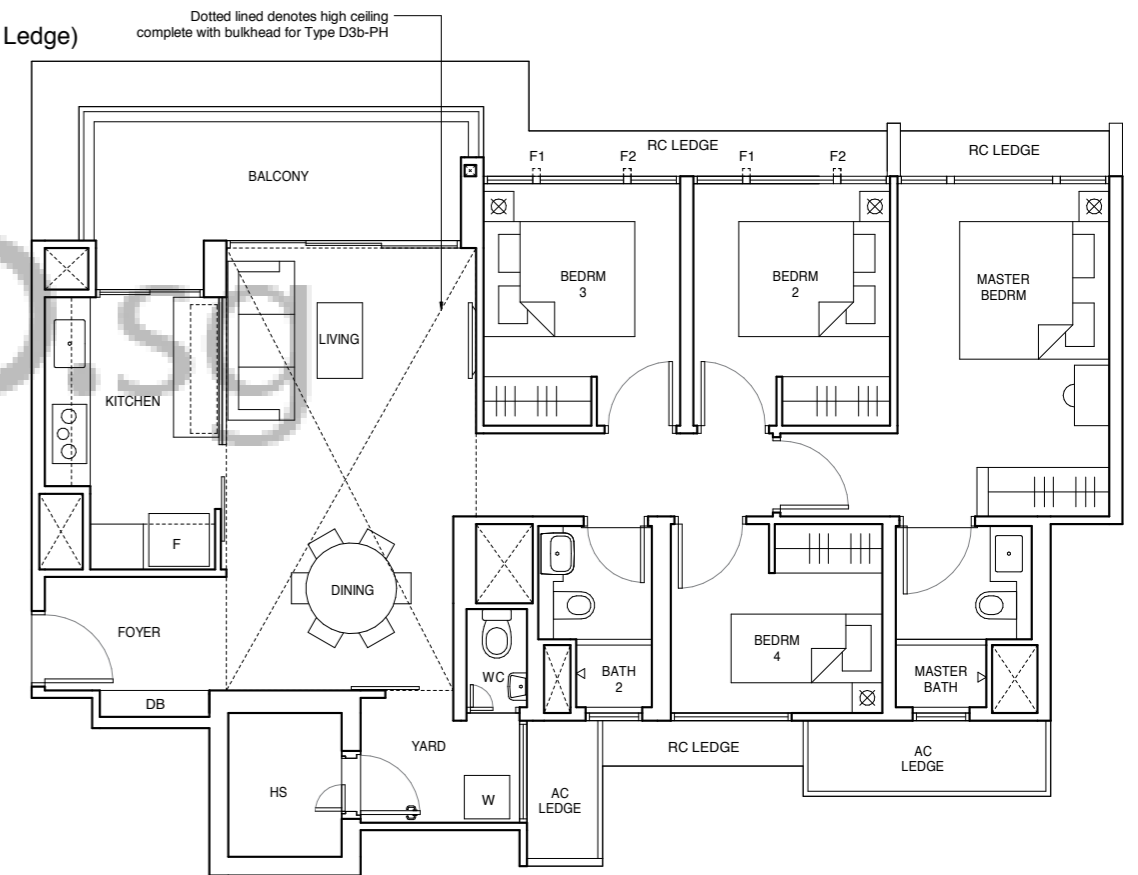

LEGEND

HS - Household Shelter W - Washer F - Fridge DB - Distribution Board * - Mirrored Unit

FULL HEIGHT ALUMINIUM FIN LOCATED AT LEVELS:

F1 - #01-07, #01-22*, #01-27, #01-31, #02-04*, #02-07, #02-22*, #02-27, #02-31, #05-02*, #05-04*, #05-07, #05-22*, #05-27, #05-31, #06-02*, #06-04*, #06-07, #06-22*, #06-27, #06-31, #09-02*, #09-04*, #09-07, #09-22*, #09-27, #09-31, #10-02*, #10-04*, #10-07, #10-22*, #10-27, #10-31, #13-02*, #13-04*, #13-07, #13-22*, #13-27, #13-31, #14-02*, #14-04*, #14-07, #14-22*, #14-27 & #14-31
 F2 - #03-02*, #03-04*, #03-07, #03-22*, #03-27, #03-31, #04-02*, #04-04*, #04-07, #04-22*, #04-27, #04-31, #07-02*, #07-04*, #07-07, #07-22*, #07-27, #07-31, #08-02*, #08-04*, #08-07, #08-22*, #08-27, #08-31, #11-02*, #11-04*, #11-07, #11-22*, #11-27, #11-31, #12-02*, #12-04*, #12-07, #12-22*, #12-27, #12-31, #15-02*, #15-04*, #15-07, #15-22*, #15-27, #15-31, #16-02*, #16-04*, #16-07, #16-22*, #16-27 & #16-31

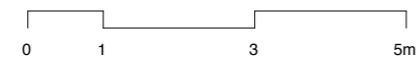

ALL PLANS ARE SUBJECT TO CHANGES BY THE RELEVANT AUTHORITIES. MEASUREMENTS ARE APPROXIMATE ONLY AND SUBJECT TO FINAL SURVEY. INFORMATION ACCURATE AT THE POINT OF PRINTING.
 BP No : A1720-00006-2019-BP01 DATED 11 AUG 2020, A1720-00006-2019-BP02 DATED 12 OCT 2020

KEY PLAN
NOT TO SCALE

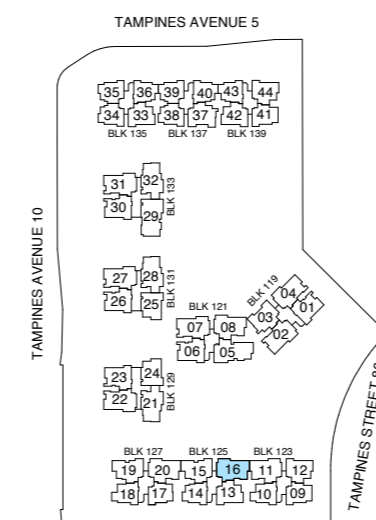

LEGEND

HS - Household Shelter W - Washer F - Fridge DB - Distribution Board * - Mirrored Unit

FULL HEIGHT ALUMINIUM FIN LOCATED AT LEVELS:

F1 - #01-16, #02-16, #05-16, #06-16, #09-16, #10-16, #13-16 & #14-16
 F2 - #03-16, #04-16, #07-16, #08-16, #11-16, #12-16, #15-16 & #16-16

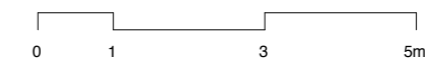

ALL PLANS ARE SUBJECT TO CHANGES BY THE RELEVANT AUTHORITIES. MEASUREMENTS ARE APPROXIMATE ONLY AND SUBJECT TO FINAL SURVEY. INFORMATION ACCURATE AT THE POINT OF PRINTING.
 BP No : A1720-00006-2019-BP01 DATED 11 AUG 2020, A1720-00006-2019-BP02 DATED 12 OCT 2020

KEY PLAN
NOT TO SCALE

4-BEDROOM PREMIUM

TYPE D4-G

1227 sqft / 114 sqm

(inclusive of 10 sqm PES & 5 sqm AC Ledge)

Blk 121, #01-08
Blk 123, #01-11*
Blk 127, #01-20

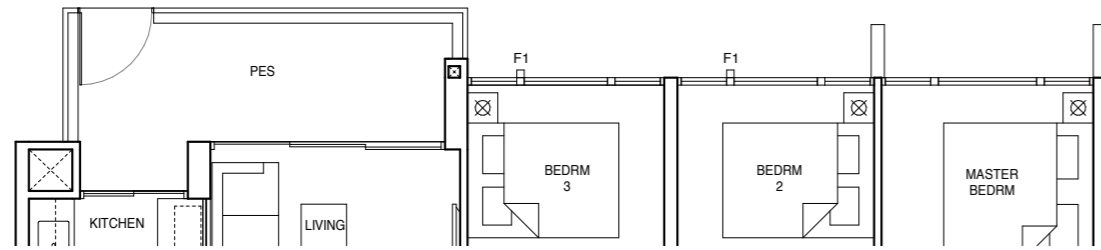

TYPE D4

1227 sqft / 114 sqm

(inclusive of 10 sqm Balcony & 5 sqm AC Ledge)

Blk 121, #02-08 to #15-08
Blk 123, #02-11* to #15-11*
Blk 127, #02-20 to #15-20

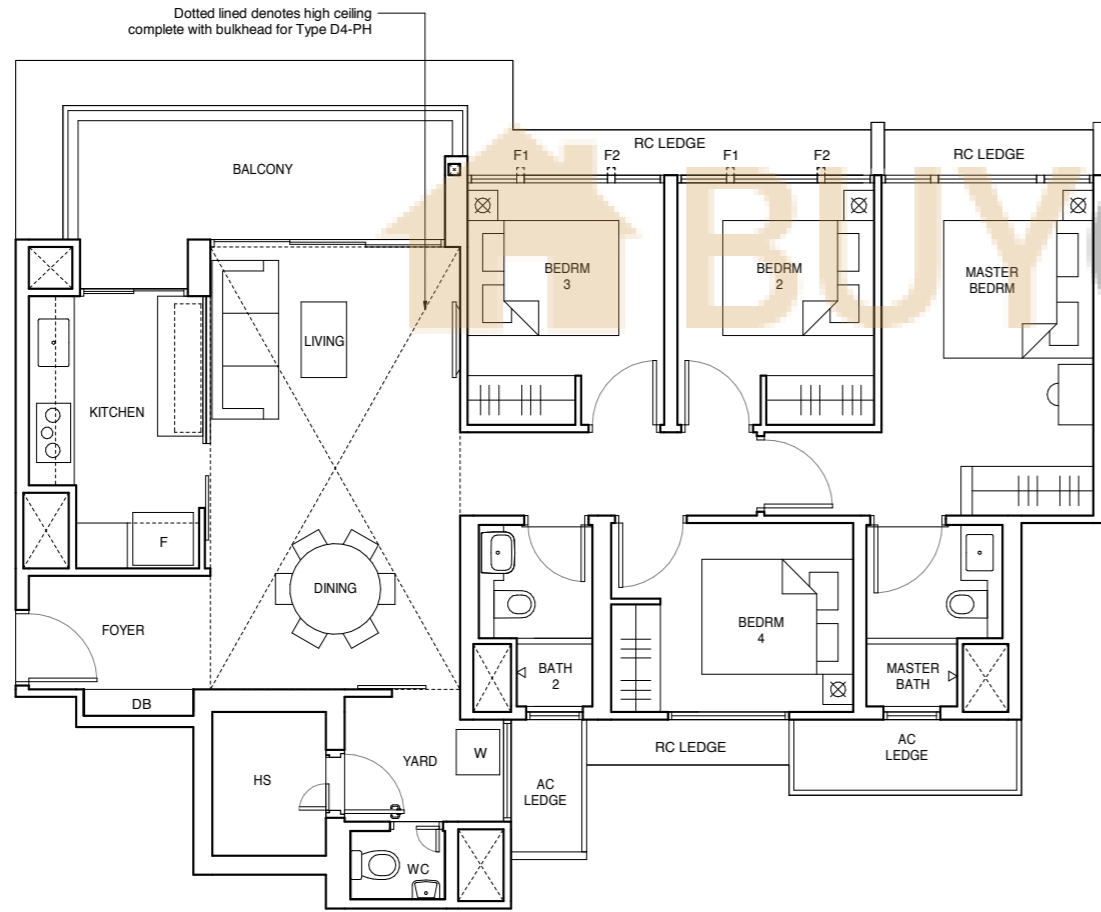

TYPE D4-PH

1442 sqft / 134 sqm

(inclusive of 10 sqm Balcony, 5 sqm AC Ledge & 20 sqm void over Living/Dining)

Blk 121, #16-08
Blk 123, #16-11*
Blk 127, #16-20

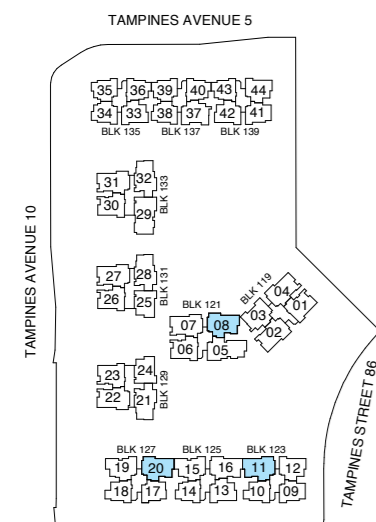
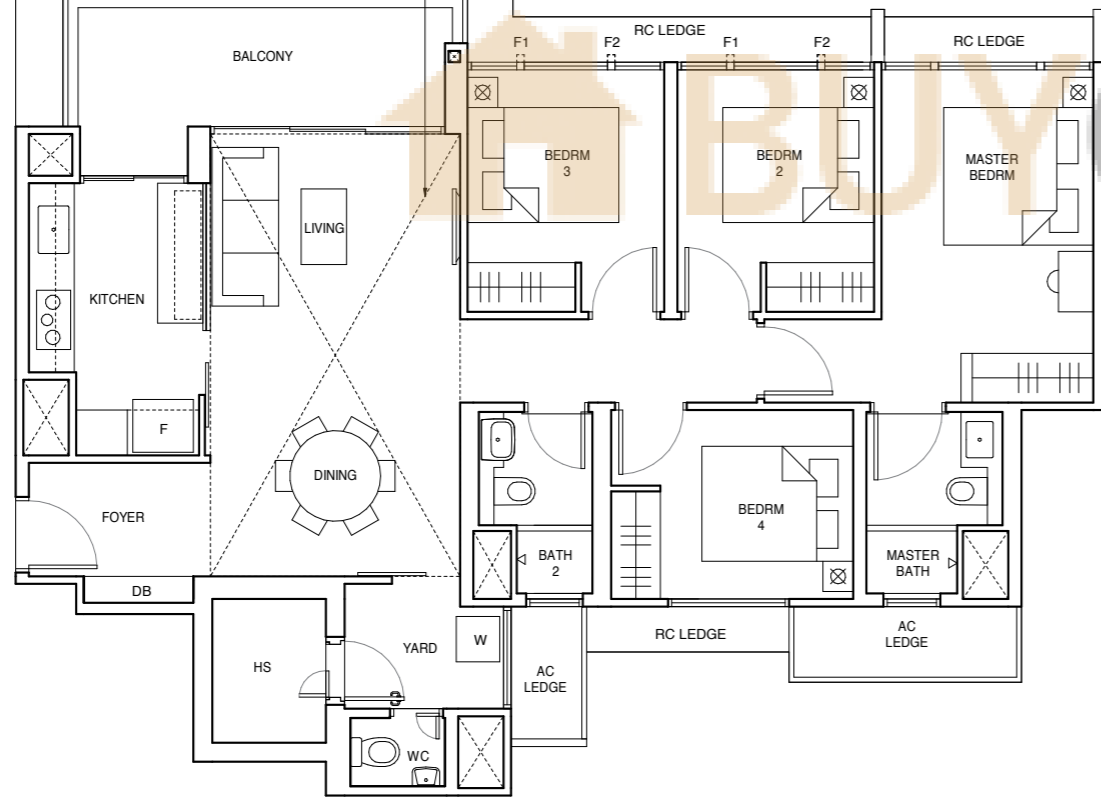

KEY PLAN
NOT TO SCALE

LEGEND

HS - Household Shelter W - Washer F - Fridge DB - Distribution Board * - Mirrored Unit

FULL HEIGHT ALUMINIUM FIN LOCATED AT LEVELS:

F1 - #01-08, #01-11*, #01-20, #02-08, #02-11*, #02-20, #05-08, #05-11*, #05-20, #06-08, #06-11*, #06-20, #09-08, #09-11*, #09-20, #10-08, #10-11*, #10-20, #13-08, #13-11*, #13-20, #14-08, #14-11* & #14-20

F2 - #03-08, #03-11*, #03-20, #04-08, #04-11*, #04-20, #07-08, #07-11*, #07-20, #08-08, #08-11*, #08-20, #11-08, #11-11*, #11-20, #12-08, #12-11*, #12-20, #15-08, #15-11*, #15-20, #16-08, #16-11* & #16-20

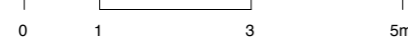

ALL PLANS ARE SUBJECT TO CHANGES BY THE RELEVANT AUTHORITIES. MEASUREMENTS ARE APPROXIMATE ONLY AND SUBJECT TO FINAL SURVEY. INFORMATION ACCURATE AT THE POINT OF PRINTING. BP No : A1720-00006-2019-BP01 DATED 11 AUG 2020, A1720-00006-2019-BP02 DATED 12 OCT 2020

4-BEDROOM LUXURY

TYPE D5-G

1270 sqft / 118 sqm

(inclusive of 10 sqm PES & 5 sqm AC Ledge)

Blk 129, #01-21
Blk 131, #01-28*
Blk 133, #01-32*

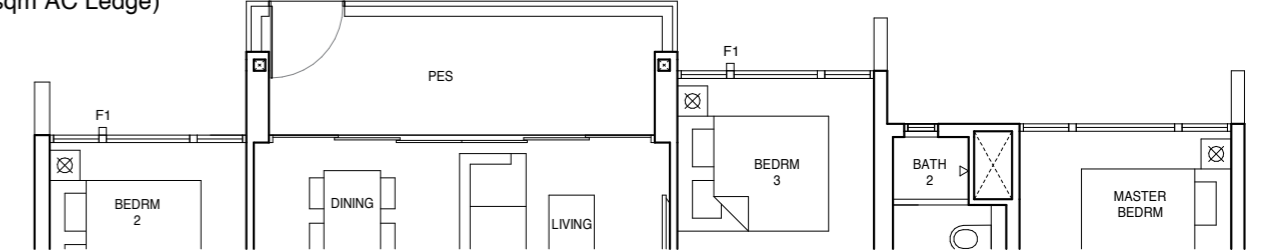

TYPE D5

1270 sqft / 118 sqm

(inclusive of 10 sqm Balcony & 5 sqm AC Ledge)

Blk 129, #02-21 to #15-21
Blk 131, #02-28* to #15-28*
Blk 133, #02-32* to #15-32*

TYPE D5-PH

1485 sqft / 138 sqm

(inclusive of 10 sqm Balcony, 5 sqm AC Ledge & 20 sqm void over Living/Dining)

Blk 129, #16-21
Blk 131, #16-28*
Blk 133, #16-32*

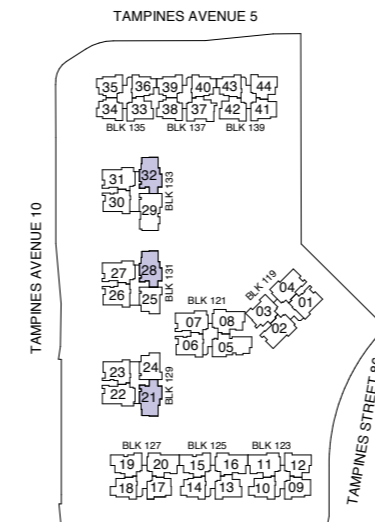
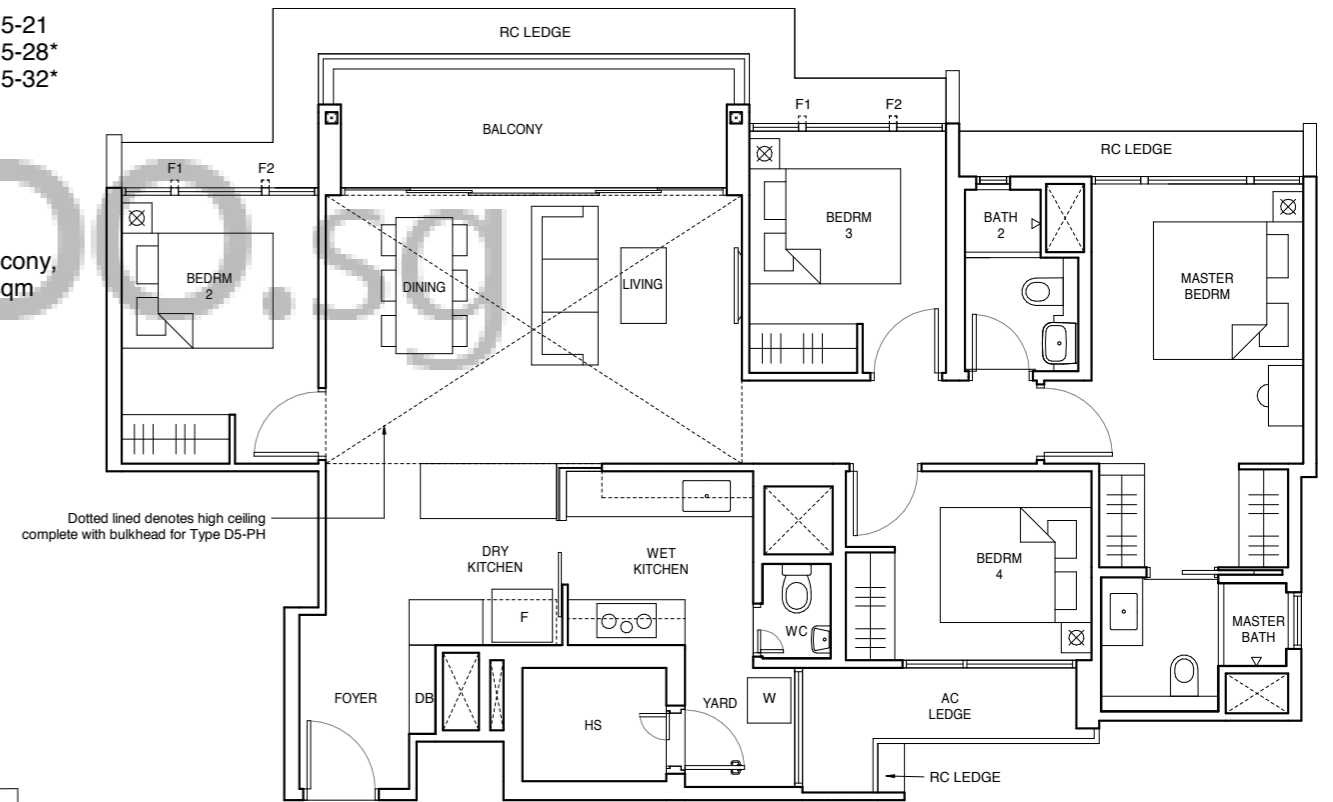

KEY PLAN
NOT TO SCALE

LEGEND

HS - Household Shelter W - Washer F - Fridge DB - Distribution Board * - Mirrored Unit

FULL HEIGHT ALUMINIUM FIN LOCATED AT LEVELS:

F1 - #01-21, #01-28*, #01-32*, #02-21, #02-28*, #02-32*, #05-21, #05-28*, #05-32*, #06-21, #06-28*, #06-32*, #09-21, #09-28*, #09-32*, #10-21, #10-28*, #10-32*, #13-21, #13-28*, #13-32*, #14-21, #14-28* & #14-32*

F2 - #03-21, #03-28*, #03-32*, #04-21, #04-28*, #04-32*, #07-21, #07-28*, #07-32*, #08-21, #08-28*, #08-32*, #11-21, #11-28*, #11-32*, #12-21, #12-28*, #12-32*, #15-21, #15-28*, #15-32*, #16-21, #16-28* & #16-32*



ALL PLANS ARE SUBJECT TO CHANGES BY THE RELEVANT AUTHORITIES. MEASUREMENTS ARE APPROXIMATE ONLY AND SUBJECT TO FINAL SURVEY. INFORMATION ACCURATE AT THE POINT OF PRINTING. BP No : A1720-00006-2019-BP01 DATED 11 AUG 2020, A1720-00006-2019-BP02 DATED 12 OCT 2020

5-BEDROOM LUXURY

TYPE E1-G

1432 sqft / 133 sqm

(inclusive of 10 sqm PES & 7 sqm AC Ledge)

Blk 121, #01-05

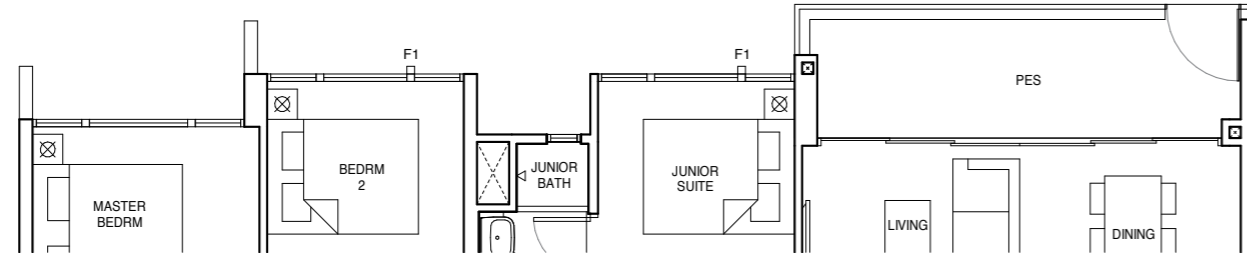

TYPE E1

1432 sqft / 133 sqm

(inclusive of 10 sqm Balcony & 7 sqm AC Ledge)

Blk 121, #02-05 to #15-05

TYPE E1-PH

1668 sqft / 155 sqm

(inclusive of 10 sqm Balcony, 7 sqm AC Ledge & 22 sqm void over Living/Dining)

Blk 121, #16-05

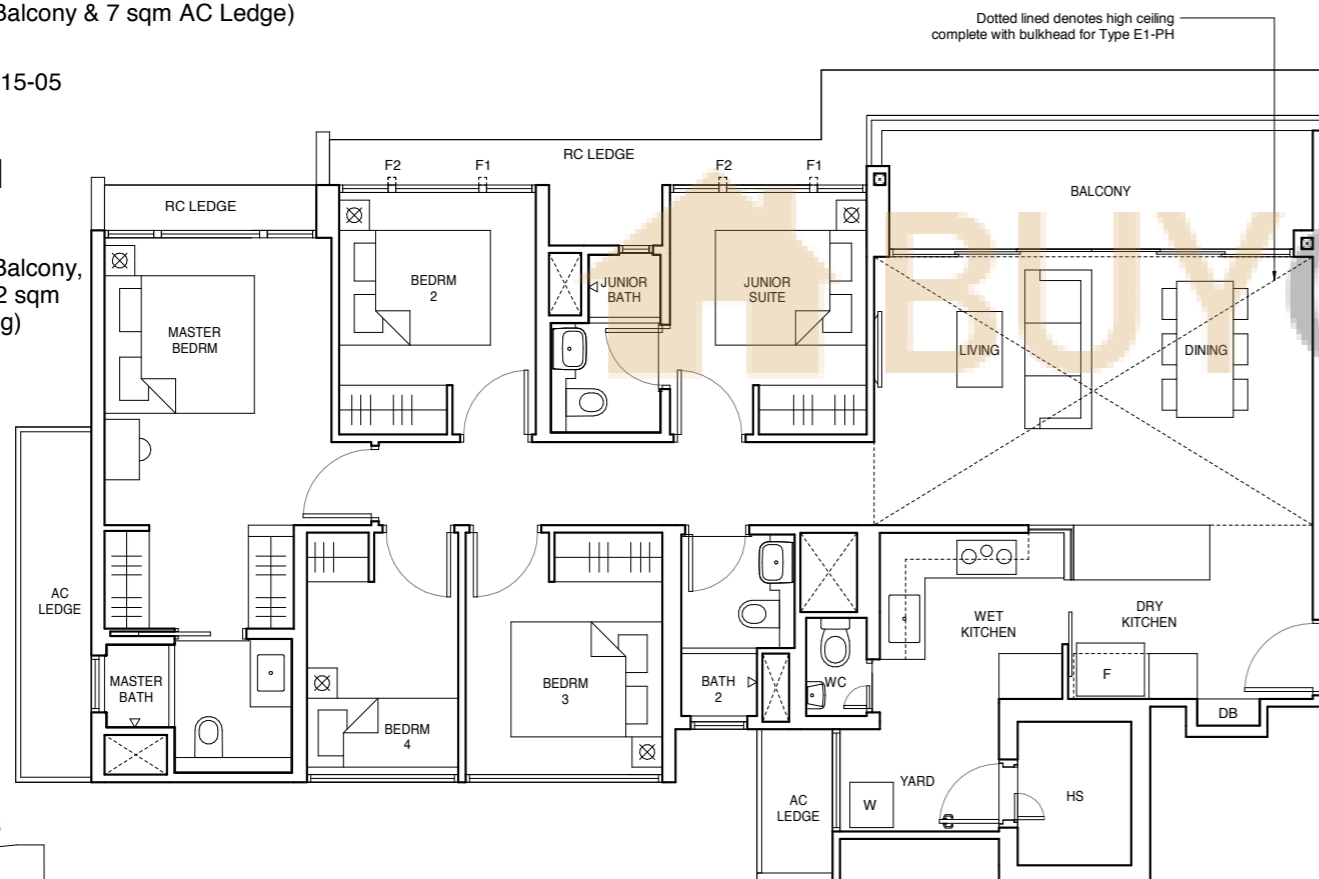

LEGEND

HS - Household Shelter W - Washer F - Fridge DB - Distribution Board * - Mirrored Unit

FULL HEIGHT ALUMINIUM FIN LOCATED AT LEVELS:
F1 - #01-05, #02-05, #05-05, #06-05, #09-05, #10-05, #13-05 & #14-05
F2 - #03-05, #04-05, #07-05, #08-05, #11-05, #12-05, #15-05 & #16-05

0 1 3 5m

ALL PLANS ARE SUBJECT TO CHANGES BY THE RELEVANT AUTHORITIES. MEASUREMENTS ARE APPROXIMATE ONLY AND SUBJECT TO FINAL SURVEY. INFORMATION ACCURATE AT THE POINT OF PRINTING. BP No : A1720-00006-2019-BP01 DATED 11 AUG 2020, A1720-00006-2019-BP02 DATED 12 OCT 2020

KEY PLAN
NOT TO SCALE

5-BEDROOM LUXURY

TYPE E2-G

1464 sqft / 136 sqm

(inclusive of 10 sqm PES & 6 sqm AC Ledge)

Blk 133, #01-29

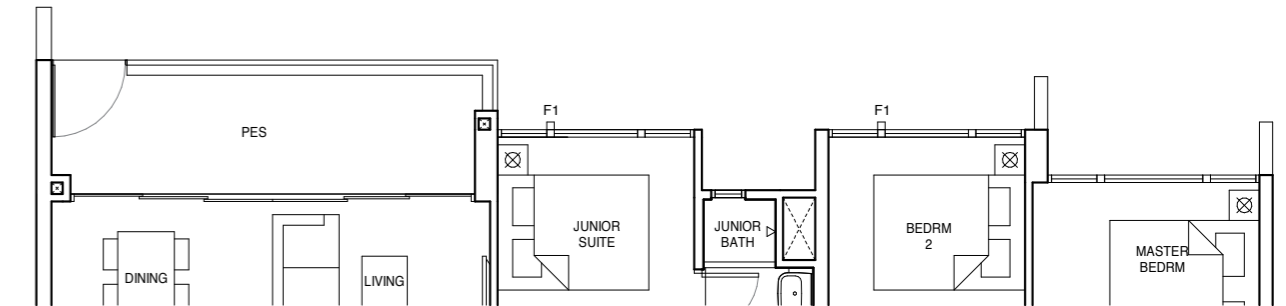

TYPE E2

1464 sqft / 136 sqm

(inclusive of 10 sqm Balcony & 6 sqm AC Ledge)

Blk 133, #02-29 to #15-29

TYPE E2-PH

1701 sqft / 158 sqm

(inclusive of 10 sqm Balcony, 6 sqm AC Ledge & 22 sqm void over Living/Dining)

Blk 133, #16-29

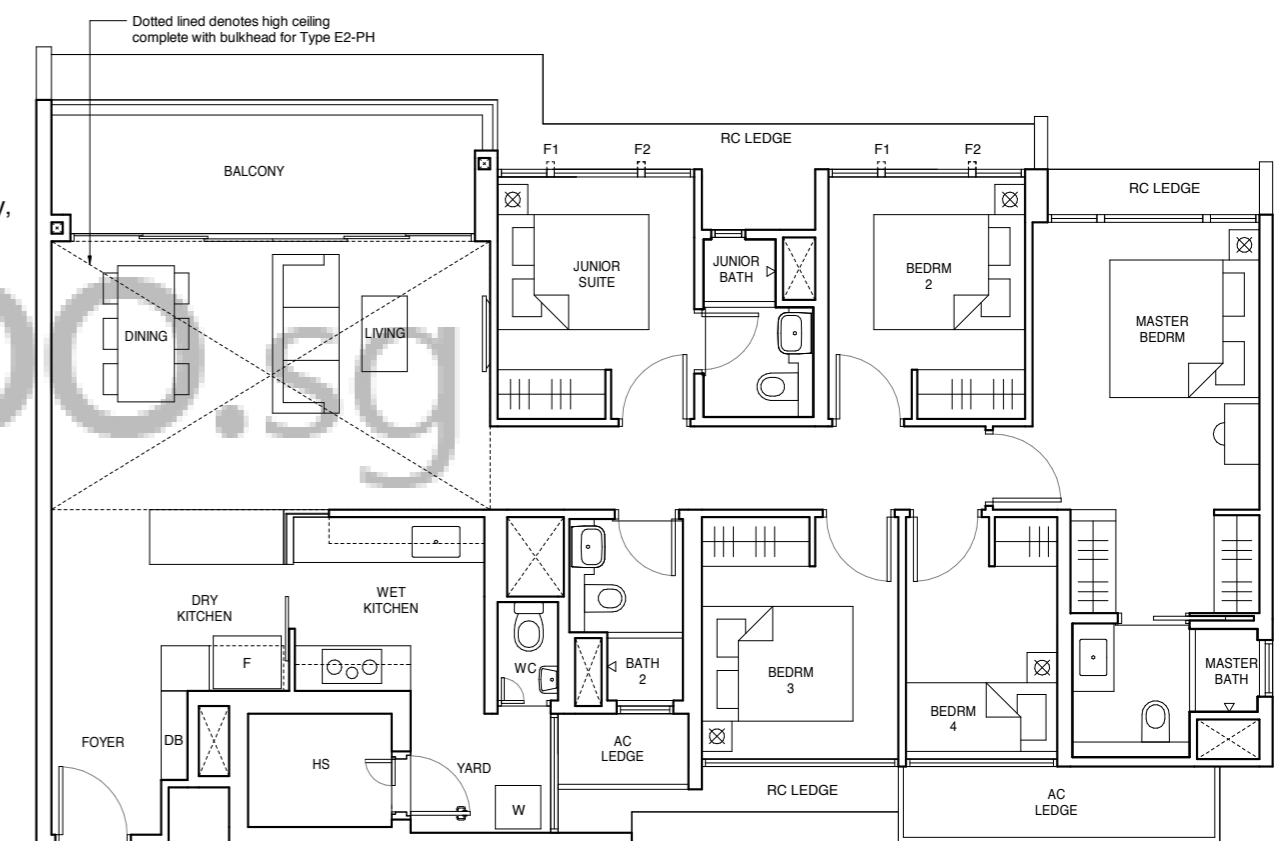

LEGEND

HS - Household Shelter W - Washer F - Fridge DB - Distribution Board * - Mirrored Unit

FULL HEIGHT ALUMINIUM FIN LOCATED AT LEVELS:
F1 - #01-29, #02-29, #05-29, #06-29, #09-29, #10-29, #13-29 & #14-29
F2 - #03-29, #04-29, #07-29, #08-29, #11-29, #12-29, #15-29 & #16-29

0 1 3 5m

ALL PLANS ARE SUBJECT TO CHANGES BY THE RELEVANT AUTHORITIES. MEASUREMENTS ARE APPROXIMATE ONLY AND SUBJECT TO FINAL SURVEY. INFORMATION ACCURATE AT THE POINT OF PRINTING. BP No : A1720-00006-2019-BP01 DATED 11 AUG 2020, A1720-00006-2019-BP02 DATED 12 OCT 2020

KEY PLAN
NOT TO SCALE

BALCONY SCREEN DETAILS

Hoi Hup Sunway is an award-winning collaboration between Hoi Hup Realty and Sunway Developments. Bringing together the expertise and experience of two real estate leaders, this winning combination has inspired many successful projects that include Rivercove Residences, Royal Square at Novena, City View @ Boon Keng and The Peak at Toa Payoh. One of their latest projects, Sophia Hills, has been honoured with Gold at the FIABCI World Prix d'Excellence Awards 2020 (Mid-rise Residential), EdgeProp Singapore Excellence Award 2020 for Top Development (Residential, Central, Completed), and FIABCI Singapore Property Awards 2019 (Mid-rise Residential and Heritage).

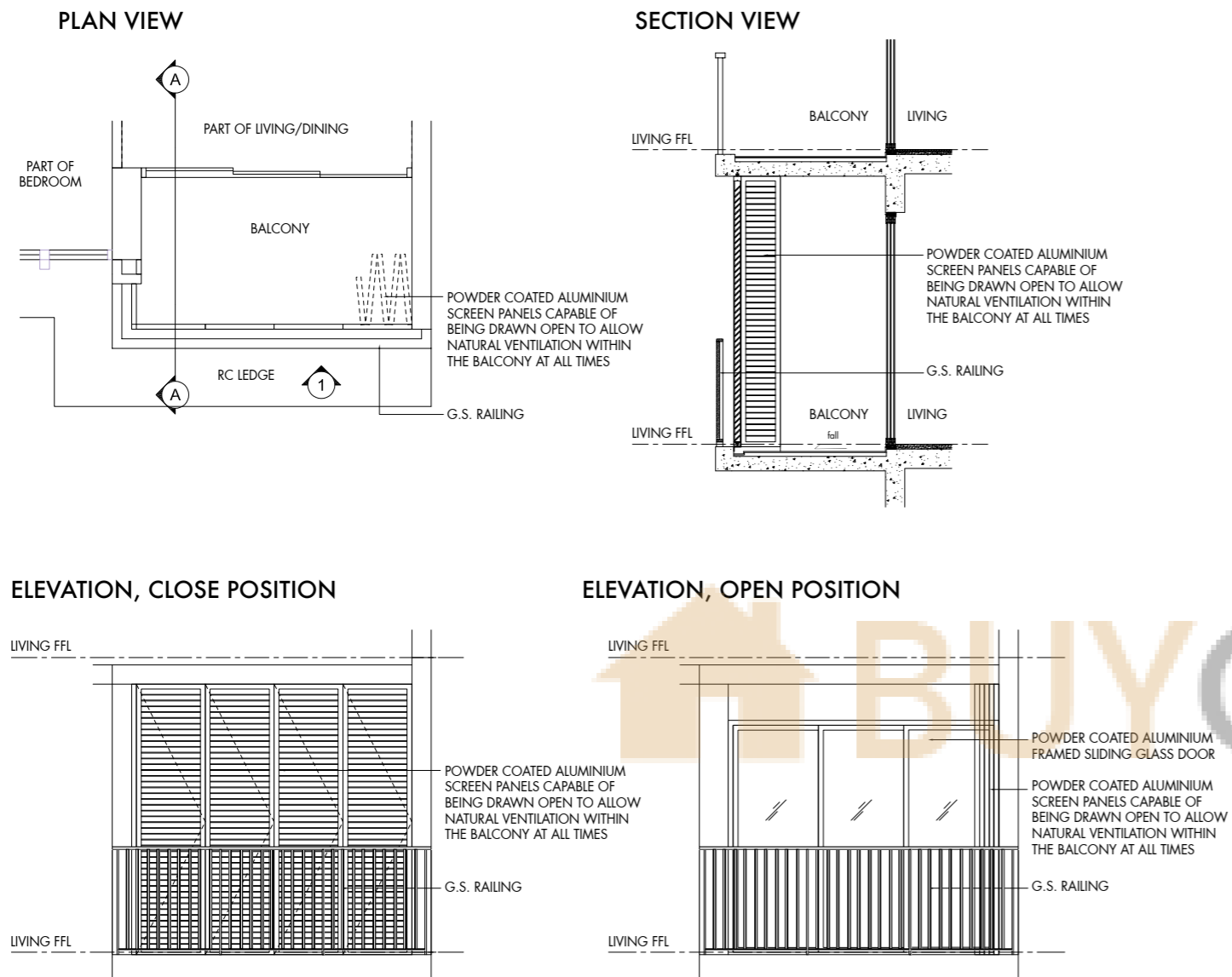

NOTES:

1. BALCONY SCREEN IS NOT PROVIDED FOR THIS DEVELOPMENT.
2. THE BALCONY SHALL NOT BE ENCLOSED UNLESS WITH THE SCREEN APPROVED BY THE RELEVANT AUTHORITIES.
3. FINAL SELECTION OF MATERIAL, COLOUR AND DETAILING OF THE SCREEN IS SUBJECT TO MCST APPROVAL.
4. APPROVAL FROM MCST IS REQUIRED BEFORE INSTALLATION.
5. OWNER TO ENGAGE THEIR OWN CONTRACTOR TO INSTALL THE SCREEN OR OPT TO PRE-INSTALL THE SCREEN.
6. ALL INSTALLATION FEES TO BE BORNE BY THE OWNER.
7. MEASUREMENTS ARE APPROXIMATE ONLY AND SUBJECT TO FINAL SURVEY.



HOI HUP REALTY

An established property developer in Singapore, Hoi Hup Realty Pte Ltd is committed to creating living spaces of the highest quality, comfort, functionality, and style. It has been recognised with numerous accolades including the BCI Asia Top Ten Developers Award from 2017 to 2019, and the BCA Quality Excellence Award – Quality Champion (Platinum) in 2018 and 2019. Its current projects include Ki Residences at Brookvale and Parc Canberra.

www.hoihup.com



SCAN THE QR CODE OR VISIT HOIHUP.COM/PARCCENTRALRESIDENCES TO FIND OUT MORE.

SUNWAY DEVELOPMENTS

As the property division of Sunway Group, Sunway Developments Pte Ltd is part of a leading property construction group that is listed on Bursa Securities, Malaysia. It has vast experience in managing and developing innovative and quality residential and non-residential properties, which include retail, leisure, healthcare, hospitality, and other commercial assets.

www.sunway.com.my

Developer: Hoi Hup Sunway Tampines JV Pte Ltd Company Reg No: 201903125Z Developer License No: C1376 Tenure of Land: 99 years from 22 April 2019 Lot No: LOT 07545K MK 28 AT TAMPINES AVENUE 10 (TAMPINES PLANNING AREA) Notice of Vacant Possession: 21 July 2025 Notice of Completion: 21 July 2028 BP Approval Number: A1720-00006-2019-BP01 dated 11 August 2020 A1720-00006-2019-BP02 dated 12 October 2020 Encumbrances on the Land: Mortgage in favour of United Overseas Bank Limited

Whilst reasonable care has been taken in the preparation of this brochure and the construction of the scale model and showflat, the Developer does not warrant their accuracy and cannot be held responsible for any inaccuracies or omissions. The statements, information and depictions may not be regarded or relied upon as statements or representations of fact, and they are not intended to form any part of the contract for the sale of the housing units. Visual representations, models, showflat, illustrations, photographs, pictures, drawings, displays and art renderings are artists' impressions of the development only, and are not to be relied upon as representations of fact. The brand, colour and model of all materials, fittings, equipment, finishes, installations and appliances supplied/provided are subject to the Developer's/its architect's selection, market availability and the sole discretion of the Developer.

All information, including equipment, materials, fittings, finishes, installations and appliances, descriptions, plans and specifications, are current at the time of publishing, and are subject to such changes as may be required by the Developer or the relevant authorities, and cannot form part of an offer or contract. All plans and layouts are not to scale and are subject to change/amendments as may be directed or approved by the relevant authorities. The areas indicated in the brochure are approximate measurements only and are subject to final survey. The Developer reserves the right to modify any unit, plans, layouts, the building, the development or any part thereof prior to completion in its absolute discretion or as directed or approved by the architect or relevant authorities.