

TYPE A
(1-BEDROOM)

UNIT #06-01 TO #13-01
AREA 441 SQFT / 41 SQM

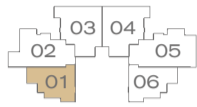

TYPE A1
(3-BEDROOM)

UNIT #15-01 TO #19-01
#21-01 TO #23-01
AREA 624 SQFT / 58 SQM



TYPE A2
(1-BEDROOM)

UNIT #05-01
AREA 474 SQFT / 44 SQM

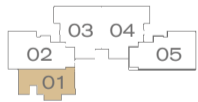

ALL PLANS ARE SUBJECT TO AMENDMENTS AS APPROVED BY THE RELEVANT AUTHORITIES.
FLOOR AREAS ARE APPROXIMATE MEASUREMENTS AND SUBJECT TO FINAL SURVEY.

BUILDING PLAN APPROVAL NUMBER: A2180-00631-2012-BP01 DATED 19 MARCH 2013



TYPE B
(2-BEDROOM)

UNIT #06-02 TO #13-02
#15-02 TO #19-02
AREA 614 SQFT / 57 SQM

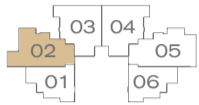

TYPE B1
(2-BEDROOM)

UNIT #24-02
AREA 1141 SQFT / 106 SQM

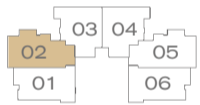

BUYCONDO.sg

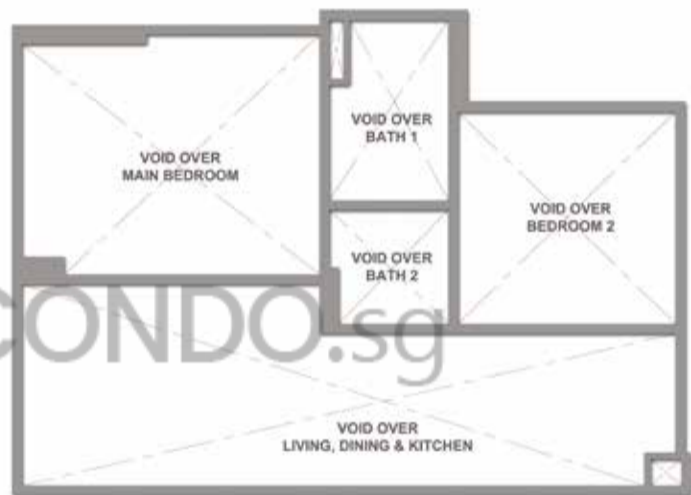

UPPER STOREY



LOWER STOREY

ALL PLANS ARE SUBJECT TO AMENDMENTS AS APPROVED BY THE RELEVANT AUTHORITIES.
FLOOR AREAS ARE APPROXIMATE MEASUREMENTS AND SUBJECT TO FINAL SURVEY.

BUILDING PLAN APPROVAL NUMBER: A2180-00631-2012-BP01 DATED 19 MARCH 2013

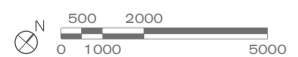

TYPE B2
(2-BEDROOM)

UNIT #05-02
AREA 700 SQFT / 65 SQM

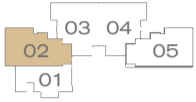

TYPE B3
(2-BEDROOM)

UNIT #21-02 TO #23-02
AREA 678 SQFT / 63 SQM

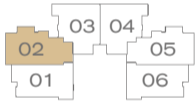

ALL PLANS ARE SUBJECT TO AMENDMENTS AS APPROVED BY THE RELEVANT AUTHORITIES.
FLOOR AREAS ARE APPROXIMATE MEASUREMENTS AND SUBJECT TO FINAL SURVEY.

BUILDING PLAN APPROVAL NUMBER: A2180-00631-2012-BP01 DATED 19 MARCH 2013



TYPE C
(2-BEDROOM)

UNIT #06-03 TO #13-03
 #15-03 TO #19-03
 #21-03 TO #23-03
 AREA 603 SQFT / 56 SQM

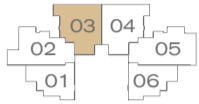

TYPE C1
(2-BEDROOM)

UNIT #24-03
 AREA 1033 SQFT / 96 SQM

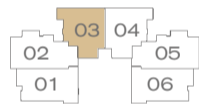

UPPER STOREY



LOWER STOREY

ALL PLANS ARE SUBJECT TO AMENDMENTS AS APPROVED BY THE RELEVANT AUTHORITIES.
 FLOOR AREAS ARE APPROXIMATE MEASUREMENTS AND SUBJECT TO FINAL SURVEY.

BUILDING PLAN APPROVAL NUMBER: A2180-00631-2012-BP01 DATED 19 MARCH 2013



TYPE C2
(2-BEDROOM)

UNIT #05-03
AREA 657 SQFT / 61 SQM

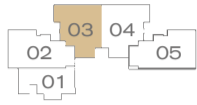

TYPE D
(2-BEDROOM)

UNIT #06-04 TO #13-04
#15-04 TO #19-04
#21-04 TO #23-04
AREA 603 SQFT / 56 SQM



ALL PLANS ARE SUBJECT TO AMENDMENTS AS APPROVED BY THE RELEVANT AUTHORITIES.
FLOOR AREAS ARE APPROXIMATE MEASUREMENTS AND SUBJECT TO FINAL SURVEY.

BUILDING PLAN APPROVAL NUMBER: A2180-00631-2012-BP01 DATED 19 MARCH 2013



TYPE D1
(2-BEDROOM)

UNIT #24-04
AREA 1033 SQFT / 96 SQM

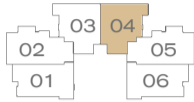

LOWER STOREY

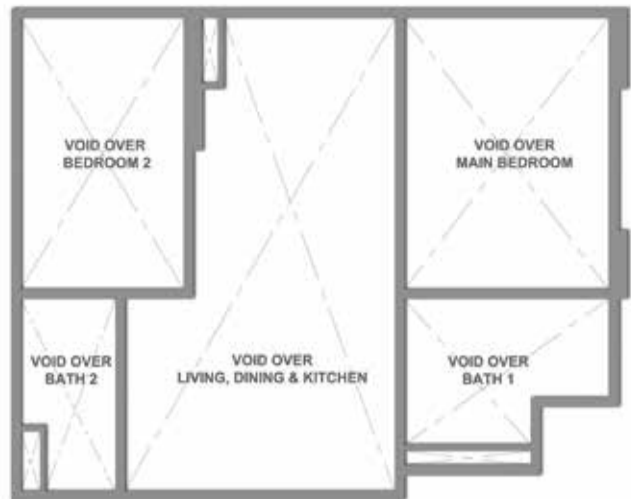

UPPER STOREY



TYPE D2
(2-BEDROOM)

UNIT #05-04
AREA 657 SQFT / 61 SQM



ALL PLANS ARE SUBJECT TO AMENDMENTS AS APPROVED BY THE RELEVANT AUTHORITIES.
FLOOR AREAS ARE APPROXIMATE MEASUREMENTS AND SUBJECT TO FINAL SURVEY.

BUILDING PLAN APPROVAL NUMBER: A2180-00631-2012-BP01 DATED 19 MARCH 2013



TYPE E
(2-BEDROOM)

UNIT #06-05 TO #13-05
AREA 678 SQFT / 63 SQM

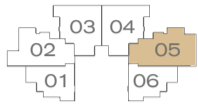

TYPE E1
(2-BEDROOM)

UNIT #24-05
AREA 1141 SQFT / 106 SQM

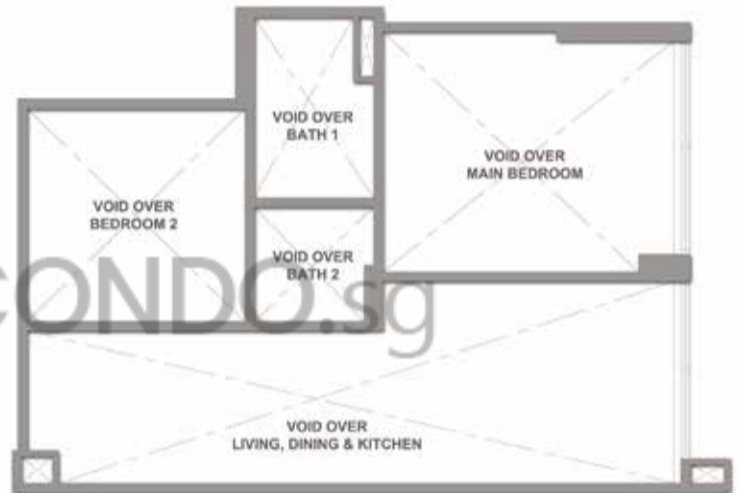
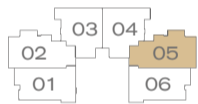

UPPER STOREY



LOWER STOREY

ALL PLANS ARE SUBJECT TO AMENDMENTS AS APPROVED BY THE RELEVANT AUTHORITIES.
FLOOR AREAS ARE APPROXIMATE MEASUREMENTS AND SUBJECT TO FINAL SURVEY.

BUILDING PLAN APPROVAL NUMBER: A2180-00631-2012-BP01 DATED 19 MARCH 2013



TYPE E2
(2-BEDROOM)

UNIT #05-05
AREA 700 SQFT / 65 SQM



TYPE E3
(2-BEDROOM)

UNIT #15-05 TO #19-05
#21-05 TO #23-05
AREA 678 SQFT / 63 SQM

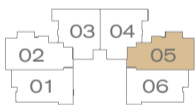

ALL PLANS ARE SUBJECT TO AMENDMENTS AS APPROVED BY THE RELEVANT AUTHORITIES.
FLOOR AREAS ARE APPROXIMATE MEASUREMENTS AND SUBJECT TO FINAL SURVEY.

BUILDING PLAN APPROVAL NUMBER: A2180-00631-2012-BP01 DATED 19 MARCH 2013

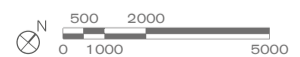

TYPE F
(1-BEDROOM)

UNIT #07-06 TO #13-06
AREA 441 SQFT / 41 SQM

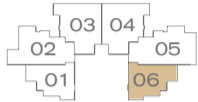

TYPE F1
(3-BEDROOM)

UNIT #15-06 TO #19-06
#21-06 TO #23-06
AREA 624 SQFT / 58 SQM

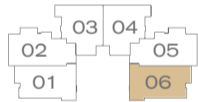

ALL PLANS ARE SUBJECT TO AMENDMENTS AS APPROVED BY THE RELEVANT AUTHORITIES.
FLOOR AREAS ARE APPROXIMATE MEASUREMENTS AND SUBJECT TO FINAL SURVEY.

BUILDING PLAN APPROVAL NUMBER: A2180-00631-2012-BP01 DATED 19 MARCH 2013



TYPE PH A
(3-BEDROOM)

UNIT #24-01
AREA 1227 SQFT / 114 SQM

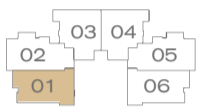

UPPER STOREY



LOWER STOREY

ALL PLANS ARE SUBJECT TO AMENDMENTS AS APPROVED BY THE RELEVANT AUTHORITIES.
FLOOR AREAS ARE APPROXIMATE MEASUREMENTS AND SUBJECT TO FINAL SURVEY.

BUILDING PLAN APPROVAL NUMBER: A2180-00631-2012-BP01 DATED 19 MARCH 2013



TYPE PH F
(3-BEDROOM)

UNIT #24-06
AREA 1227 SQFT / 114 SQM

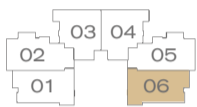

UPPER STOREY



LOWER STOREY

ALL PLANS ARE SUBJECT TO AMENDMENTS AS APPROVED BY THE RELEVANT AUTHORITIES.
FLOOR AREAS ARE APPROXIMATE MEASUREMENTS AND SUBJECT TO FINAL SURVEY.

BUILDING PLAN APPROVAL NUMBER: A2180-00631-2012-BP01 DATED 19 MARCH 2013

