

TYPE A (2-BEDROOM + UTILITY)

Unit #02-04 to #09-04
Area 1055 sqft / 98 sqm

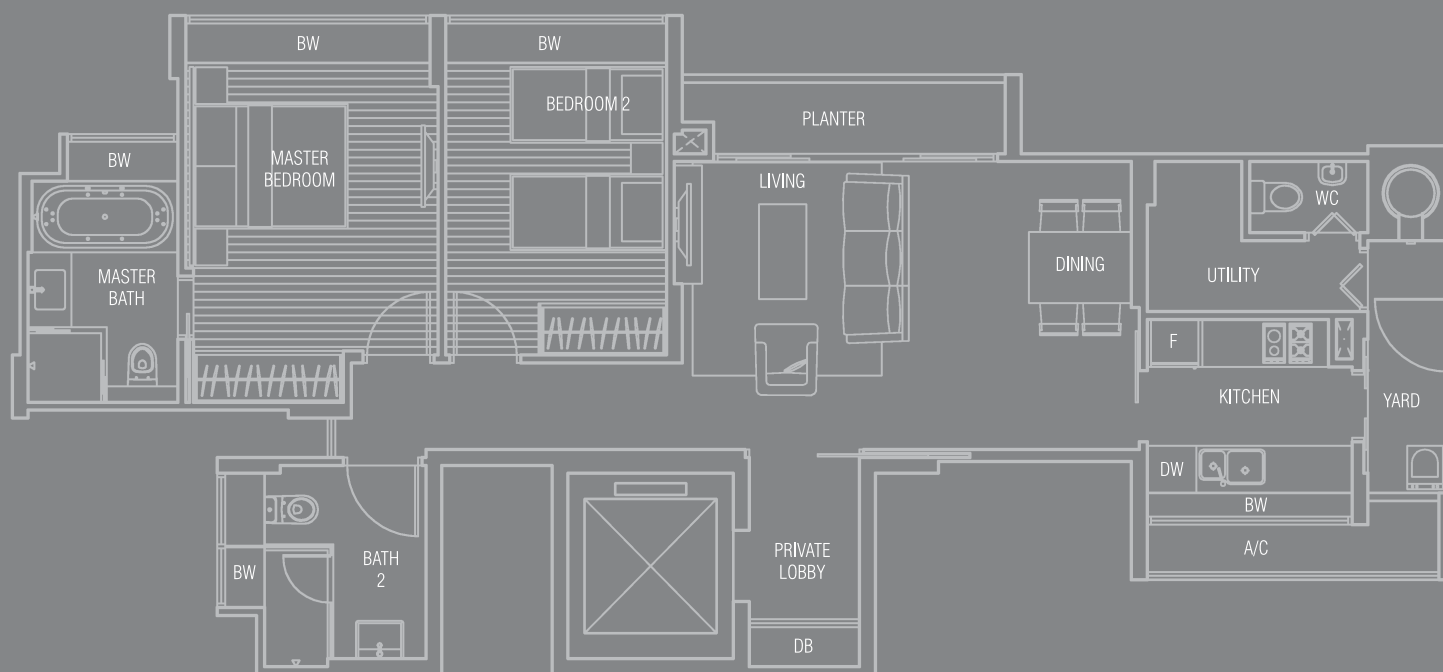

TYPE A1 (2-BEDROOM + UTILITY)

Unit #02-05 to #09-05
Area 1076 sqft / 100 sqm

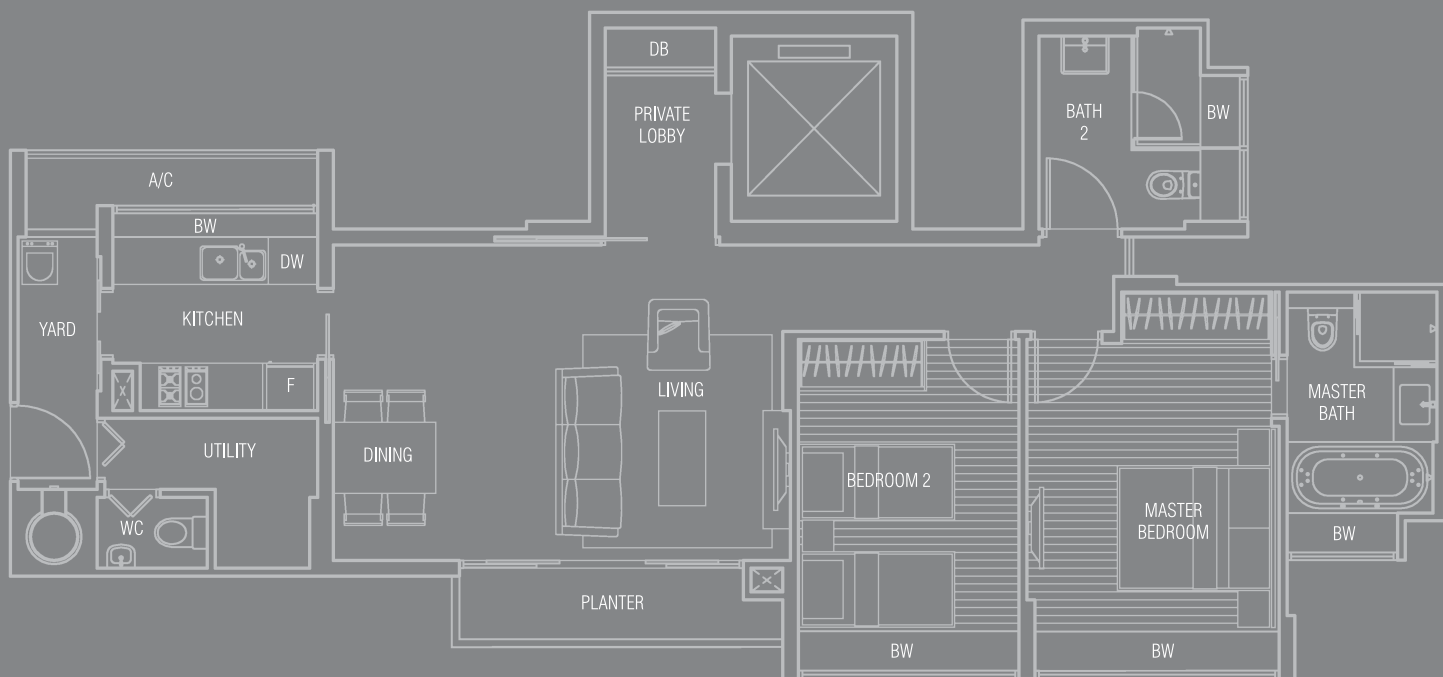

TYPE A2 (2-BEDROOM + STUDY + UTILITY)

Unit #02-03 to #09-03
Area 1324 sqft / 123 sqm

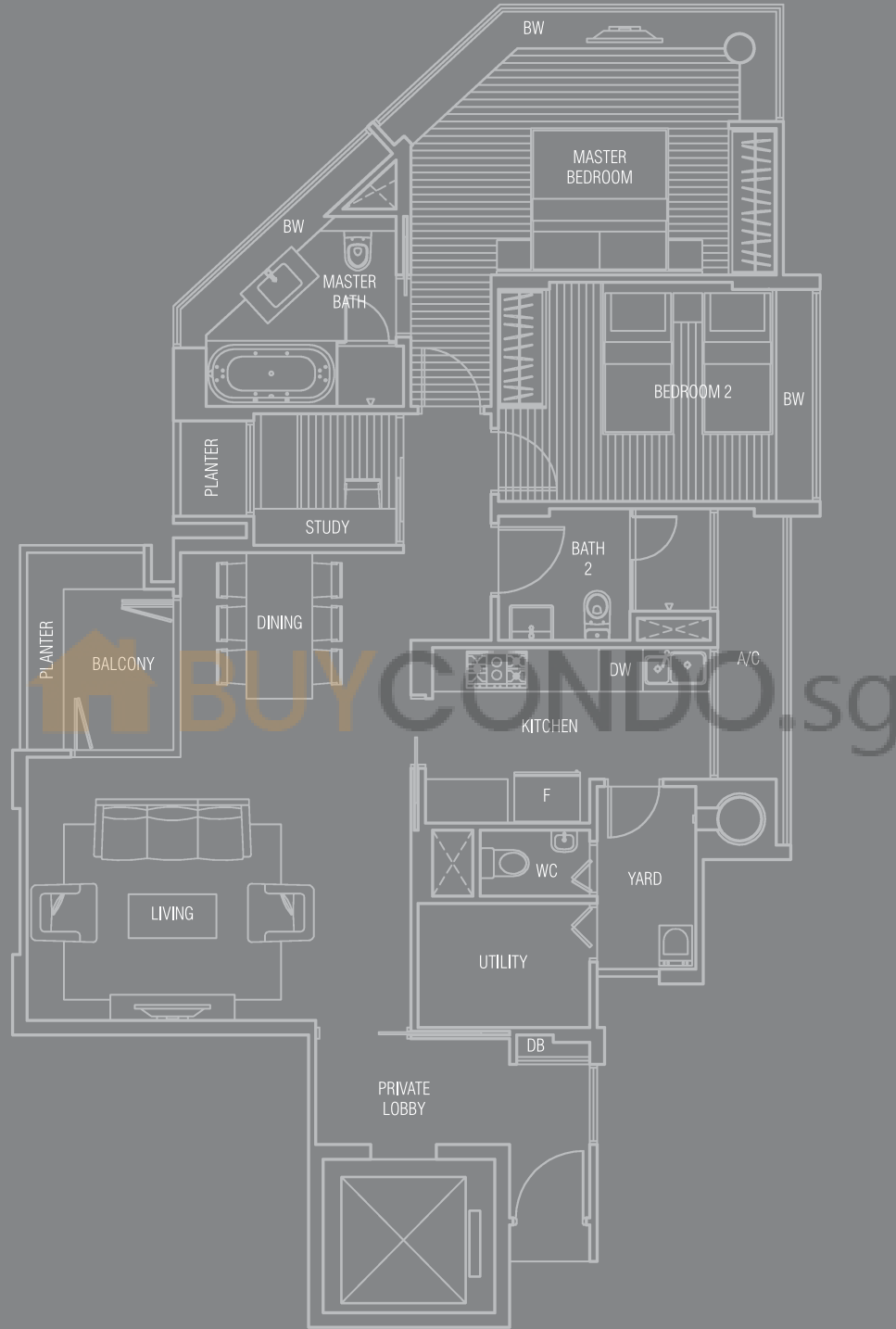

All plans are subject to amendments as approved by the relevant authorities. Floor areas are approximate measurements and subject to final survey.

TYPE B1 (3-BEDROOM + UTILITY)

Unit #02-02 to #09-02
 Area 1496 sqft / 139 sqm

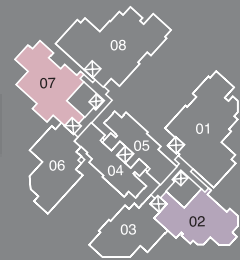
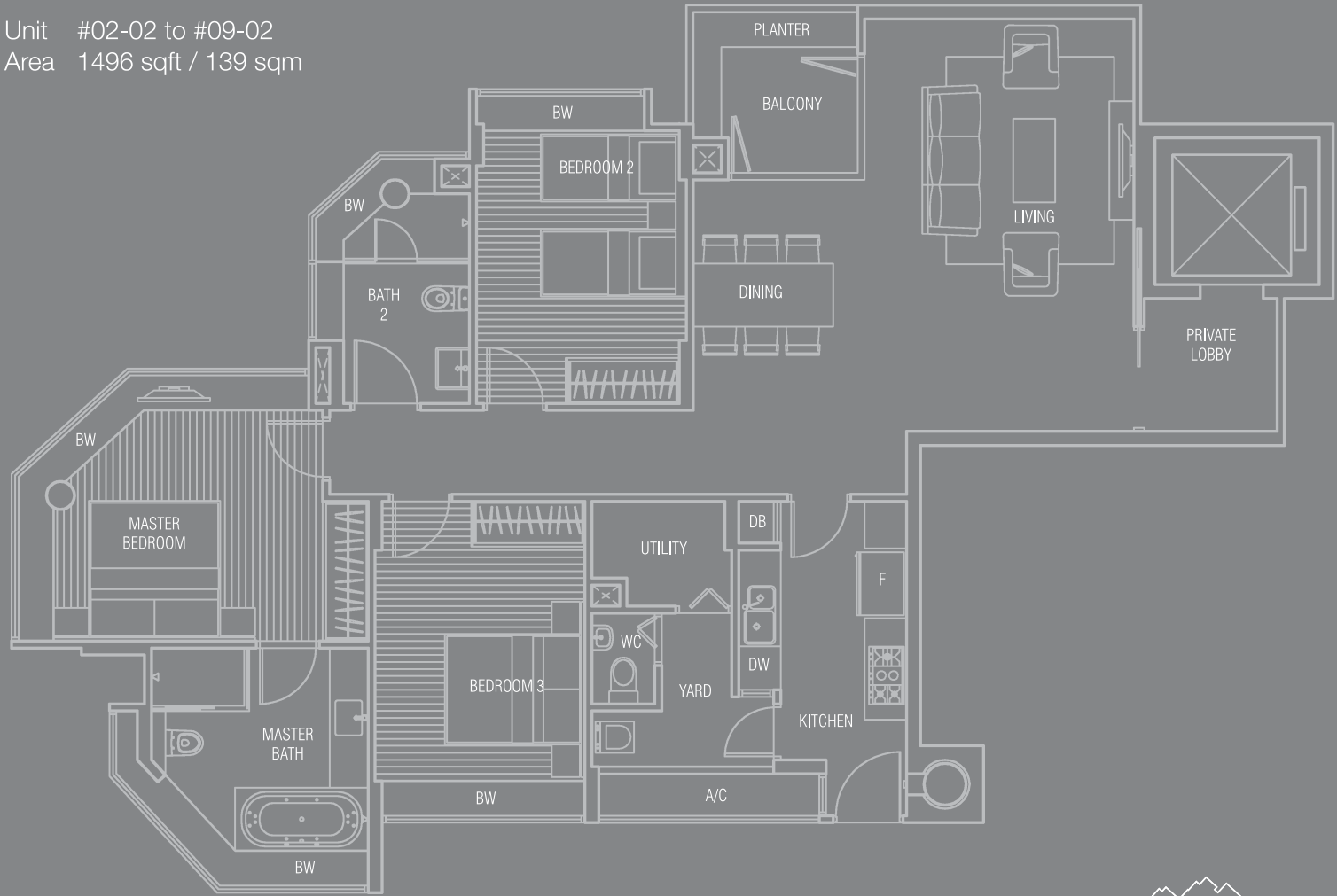

TYPE C (3-BEDROOM + STUDY + UTILITY)

Unit #02-07 to #09-07
 Area 1625 sqft / 151 sqm

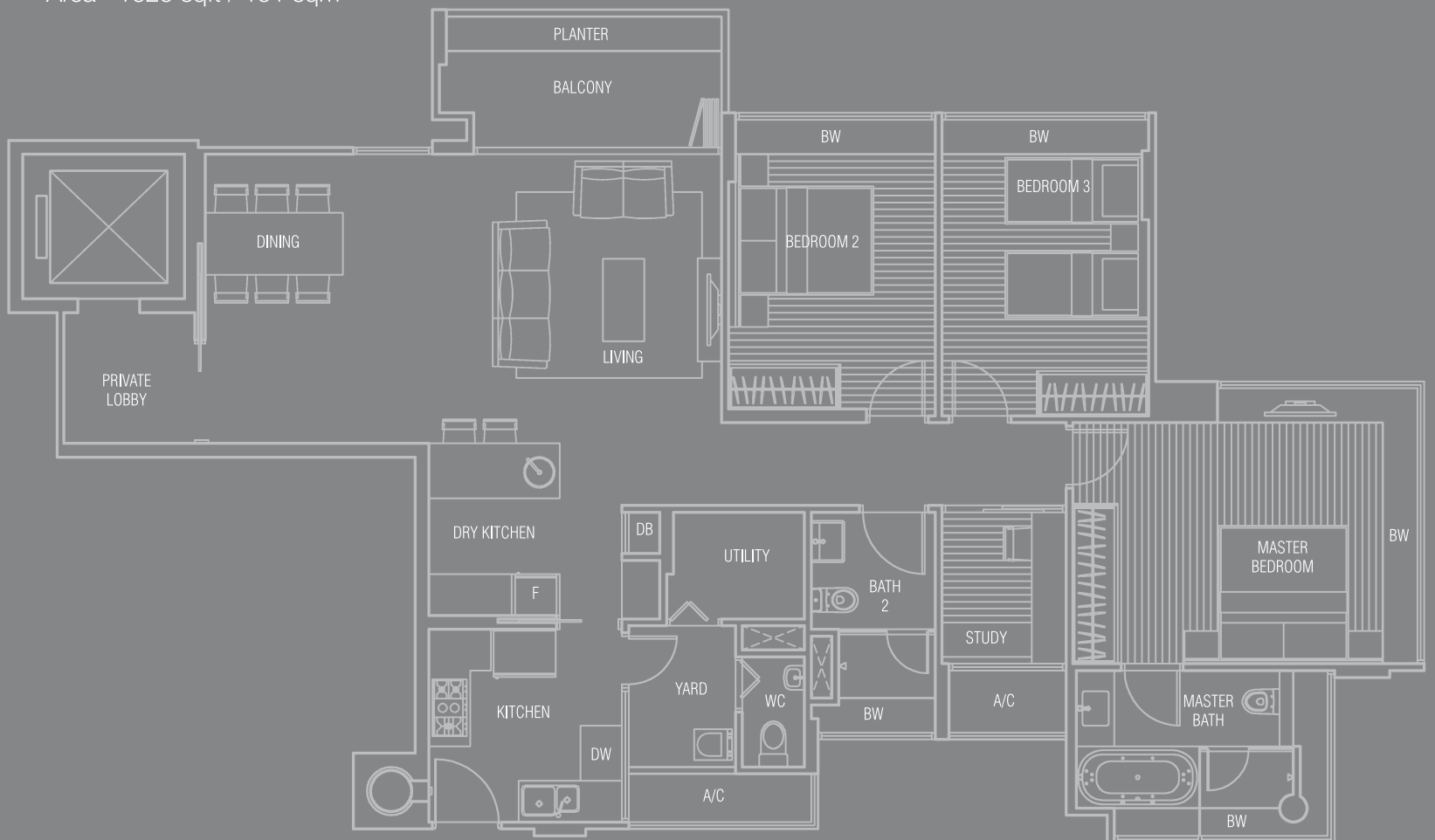

TYPE D1 (4-BEDROOM + FAMILY + UTILITY)

Unit #02-01 to #09-01
Area 2325 sqft / 216 sqm

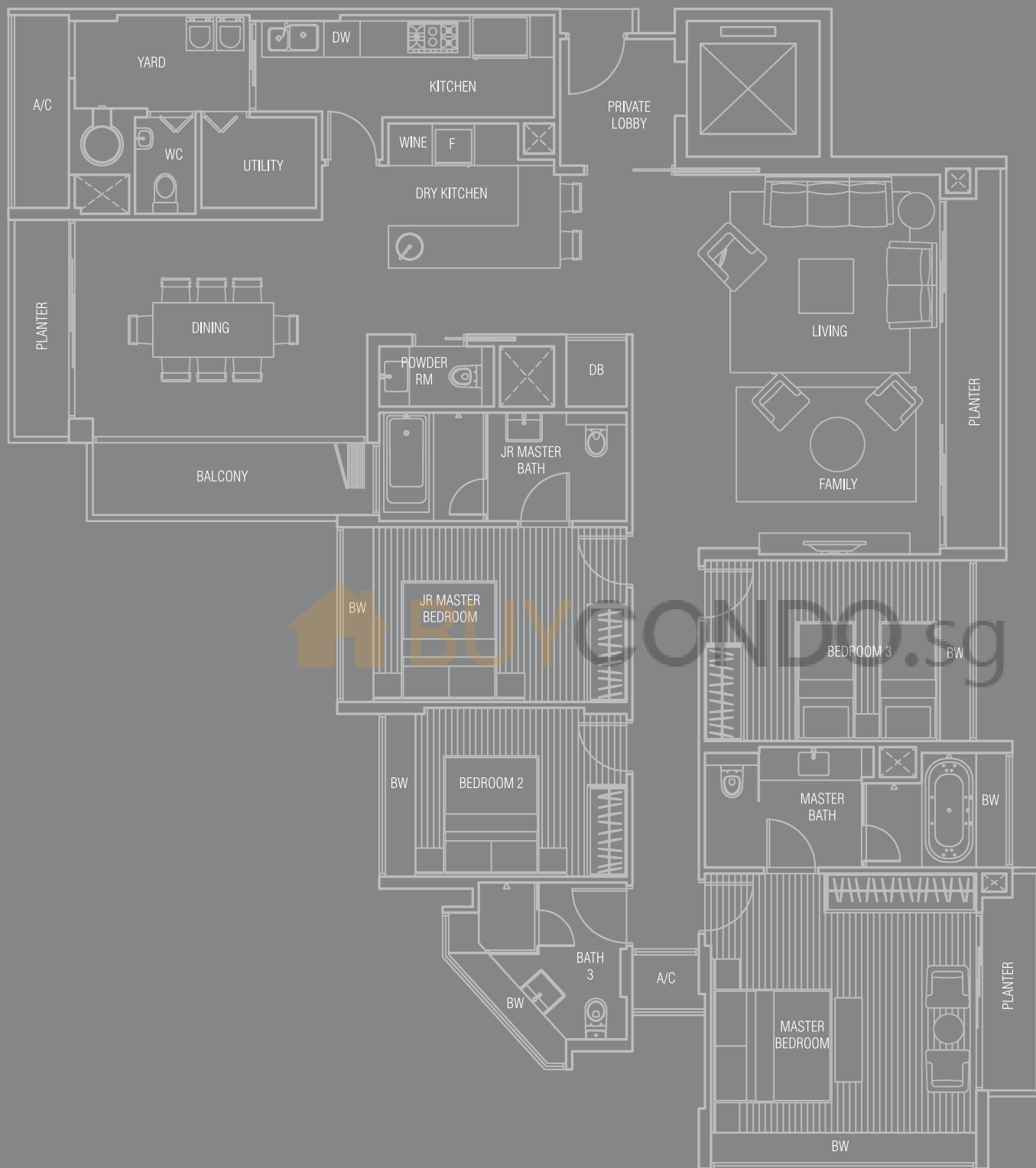

All plans are subject to amendments as approved by the relevant authorities. Floor areas are approximate measurements and subject to final survey.

TYPE D2 (4-BEDROOM + FAMILY + UTILITY)

Unit #02-08 to #09-08
Area 2368 sqft / 220 sqm

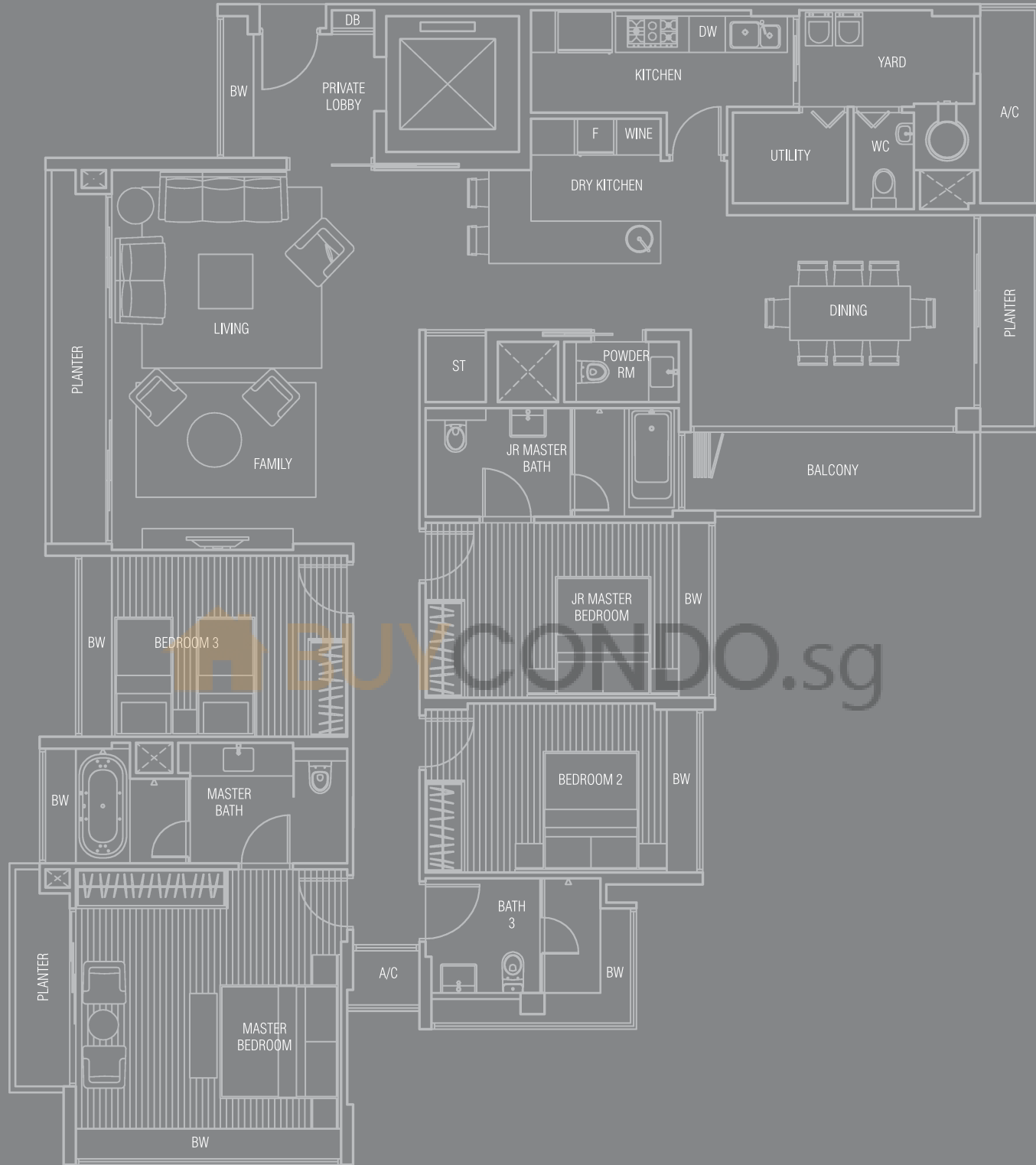

All plans are subject to amendments as approved by the relevant authorities. Floor areas are approximate measurements and subject to final survey.

TYPE E1P (4-BEDROOM PENTHOUSE + UTILITY)

Unit #10-03

Area 5059 sqft / 470 sqm

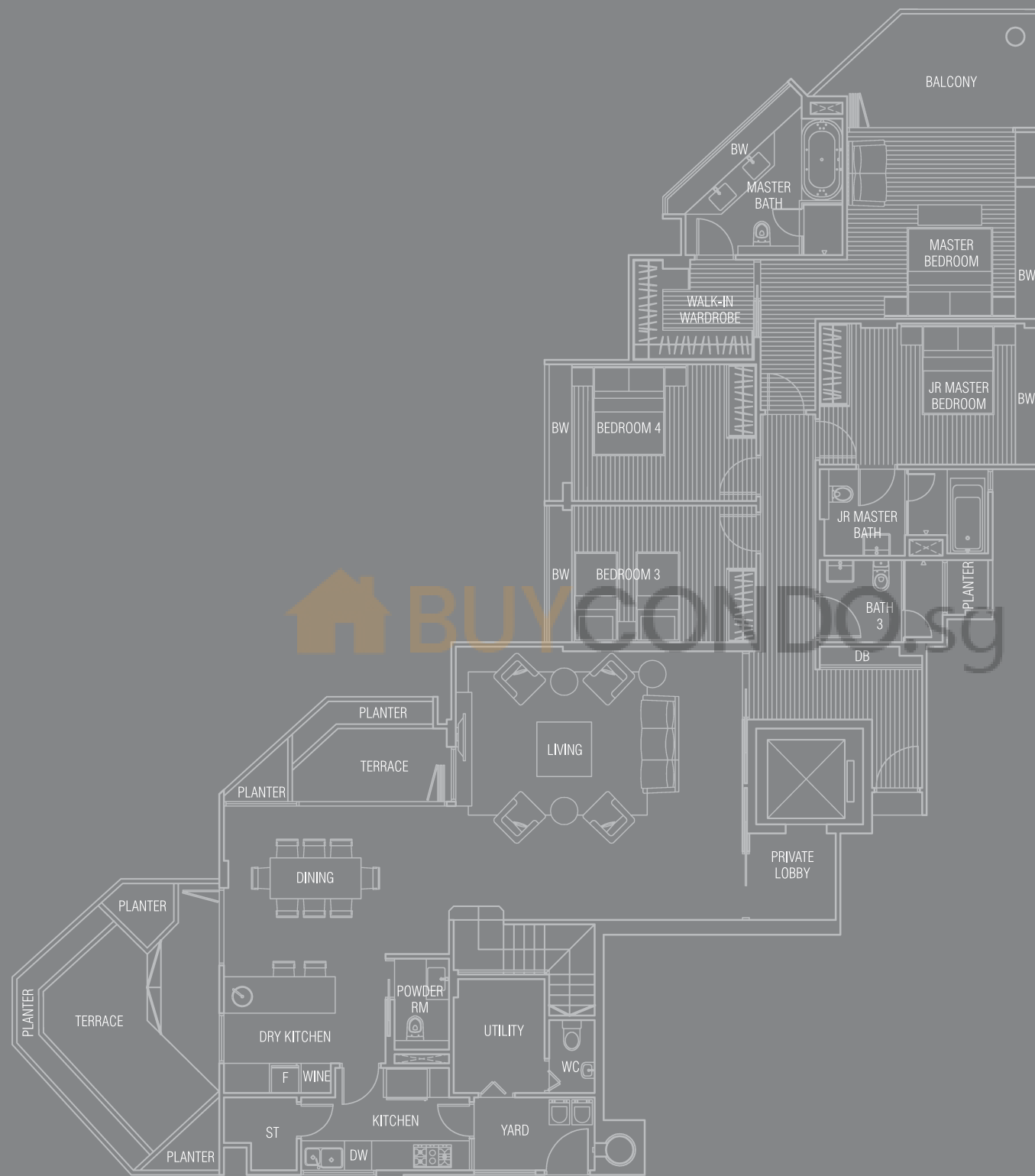

Lower Storey

BUY CONDO.sg

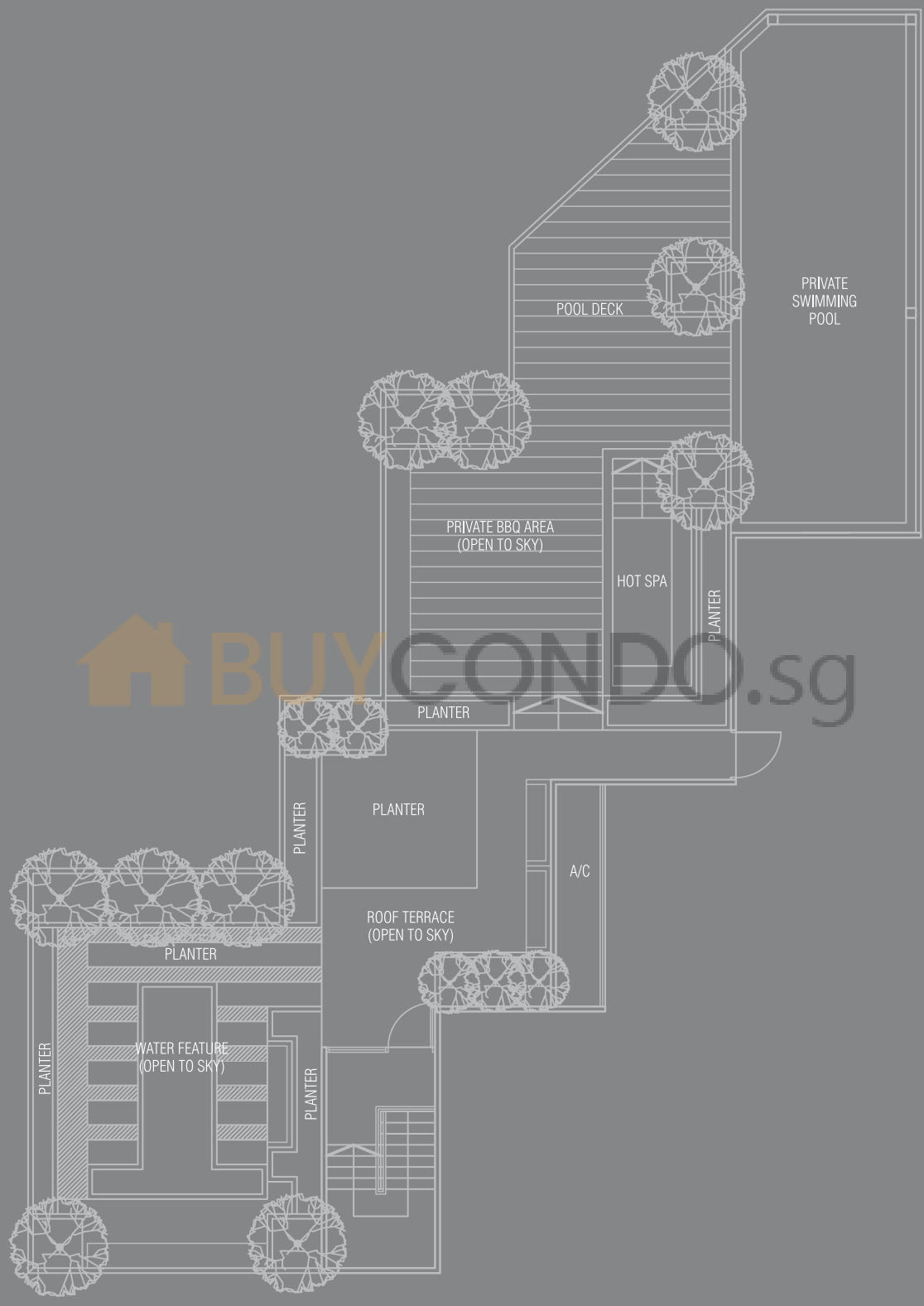

Upper Storey



All plans are subject to amendments as approved by the relevant authorities. Floor areas are approximate measurements and subject to final survey.

TYPE E2P (4-BEDROOM PENTHOUSE + STUDY + FAMILY+ UTILITY)

Unit #10-01

Area 6534 sqft / 607 sqm



Lower Storey

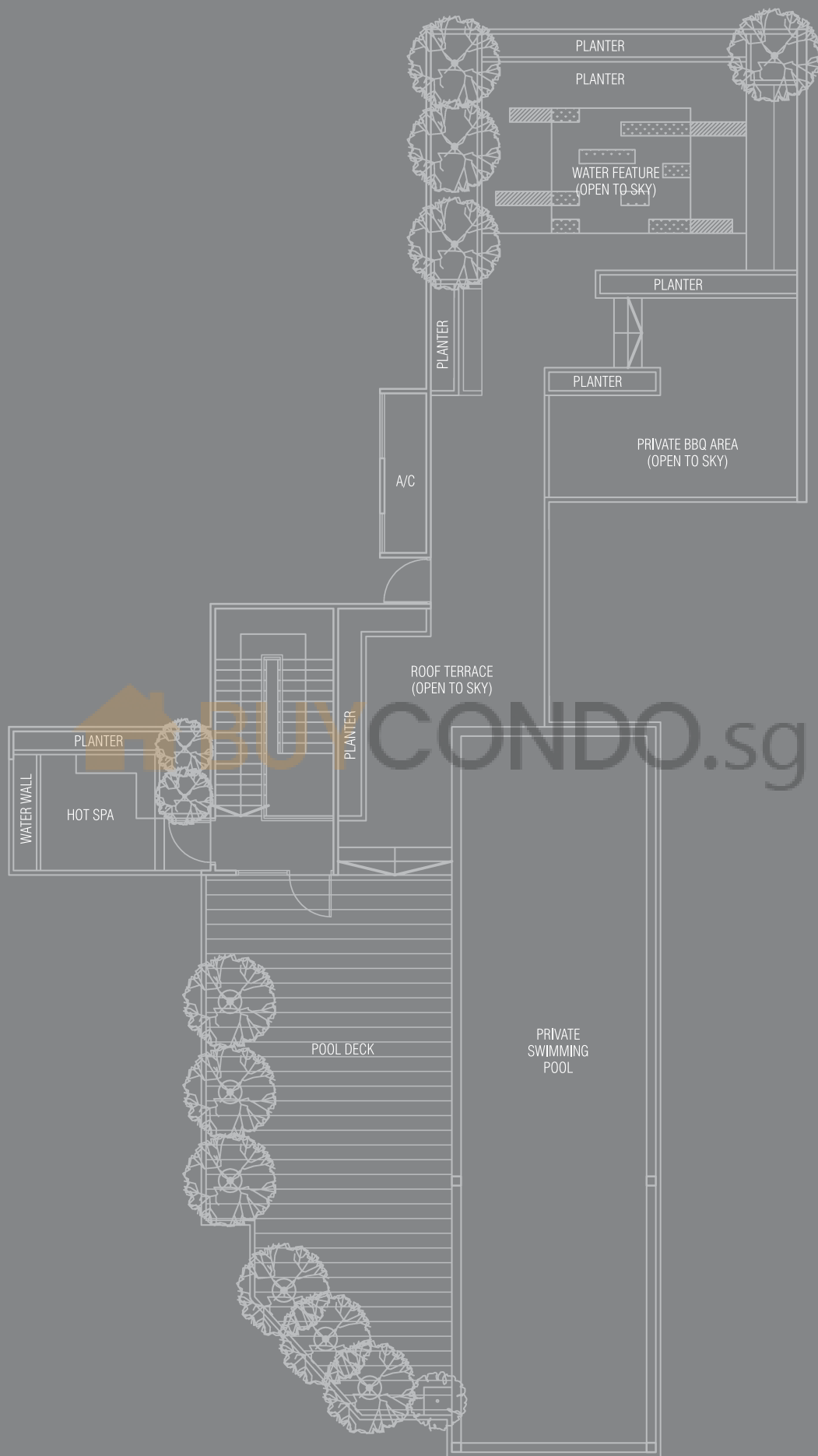

Upper Storey



TYPE E3P (4-BEDROOM PENTHOUSE + STUDY + FAMILY + UTILITY)

Unit #10-08

Area 6760 sqft / 628 sqm

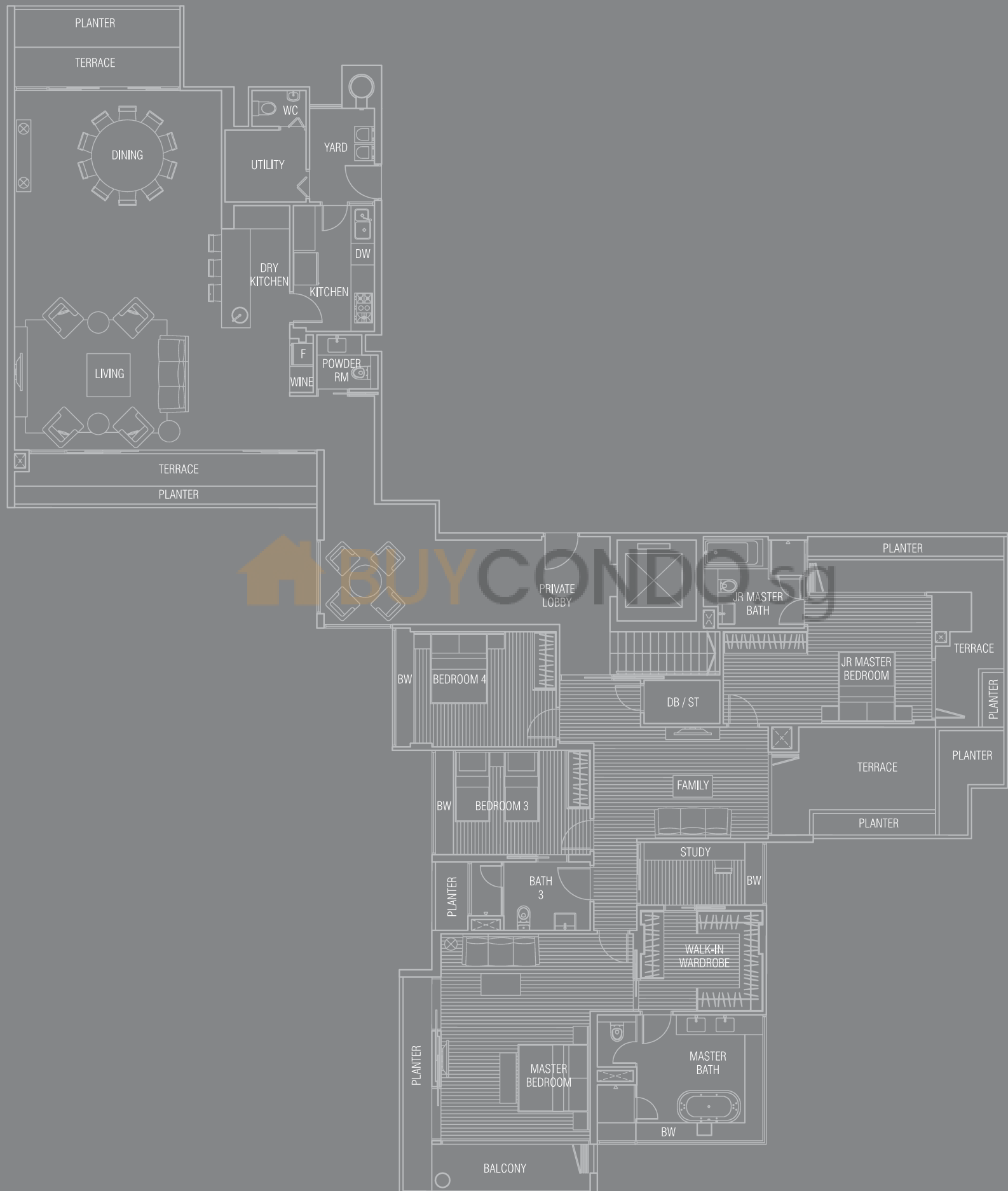

Lower Storey

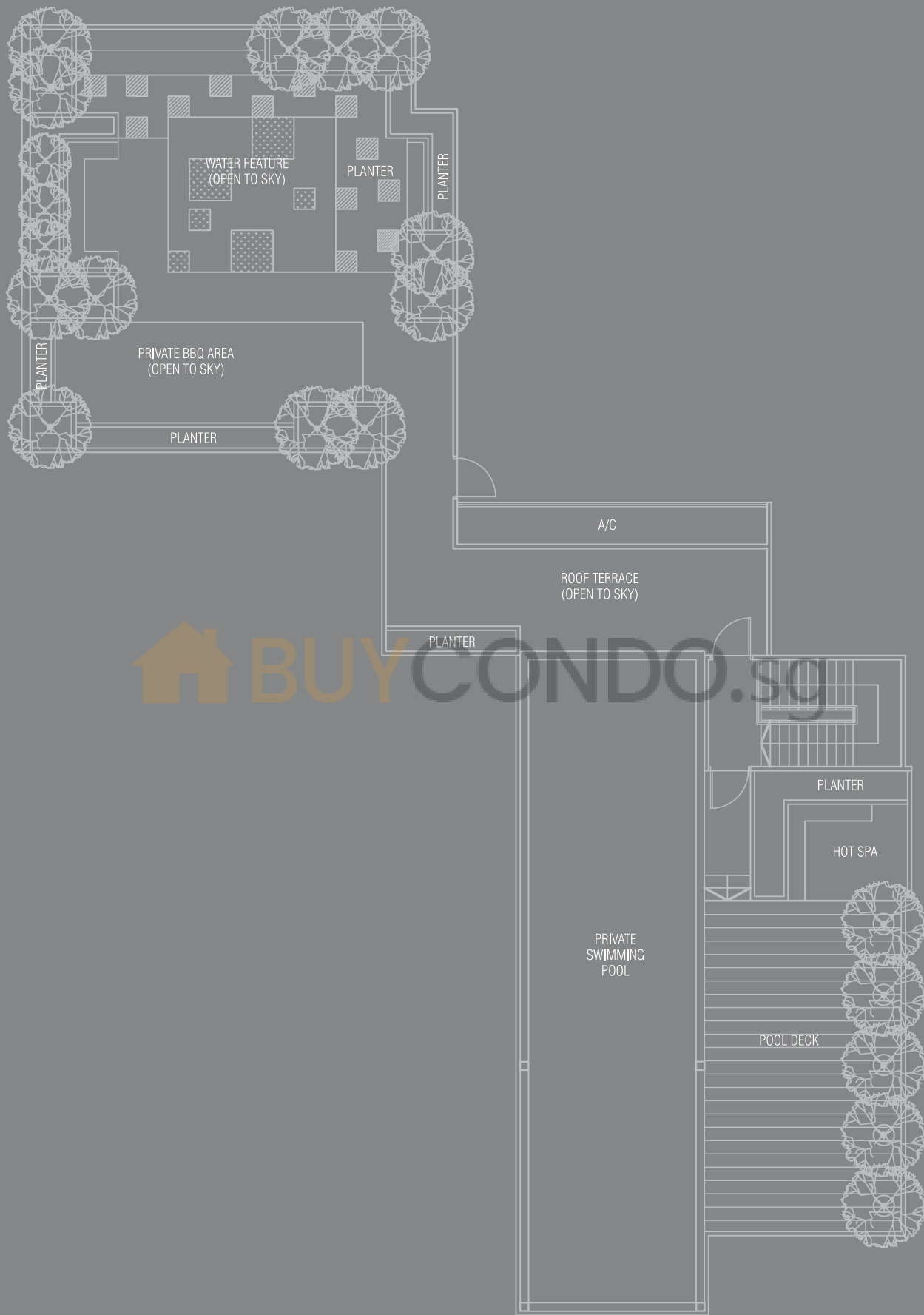

 BUY CONDO.SG

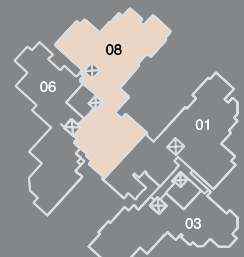

Upper Storey

TYPE E4P (4-BEDROOM PENTHOUSE + FAMILY+ UTILITY)

Unit #10-06

Area 5683 sqft / 528 sqm

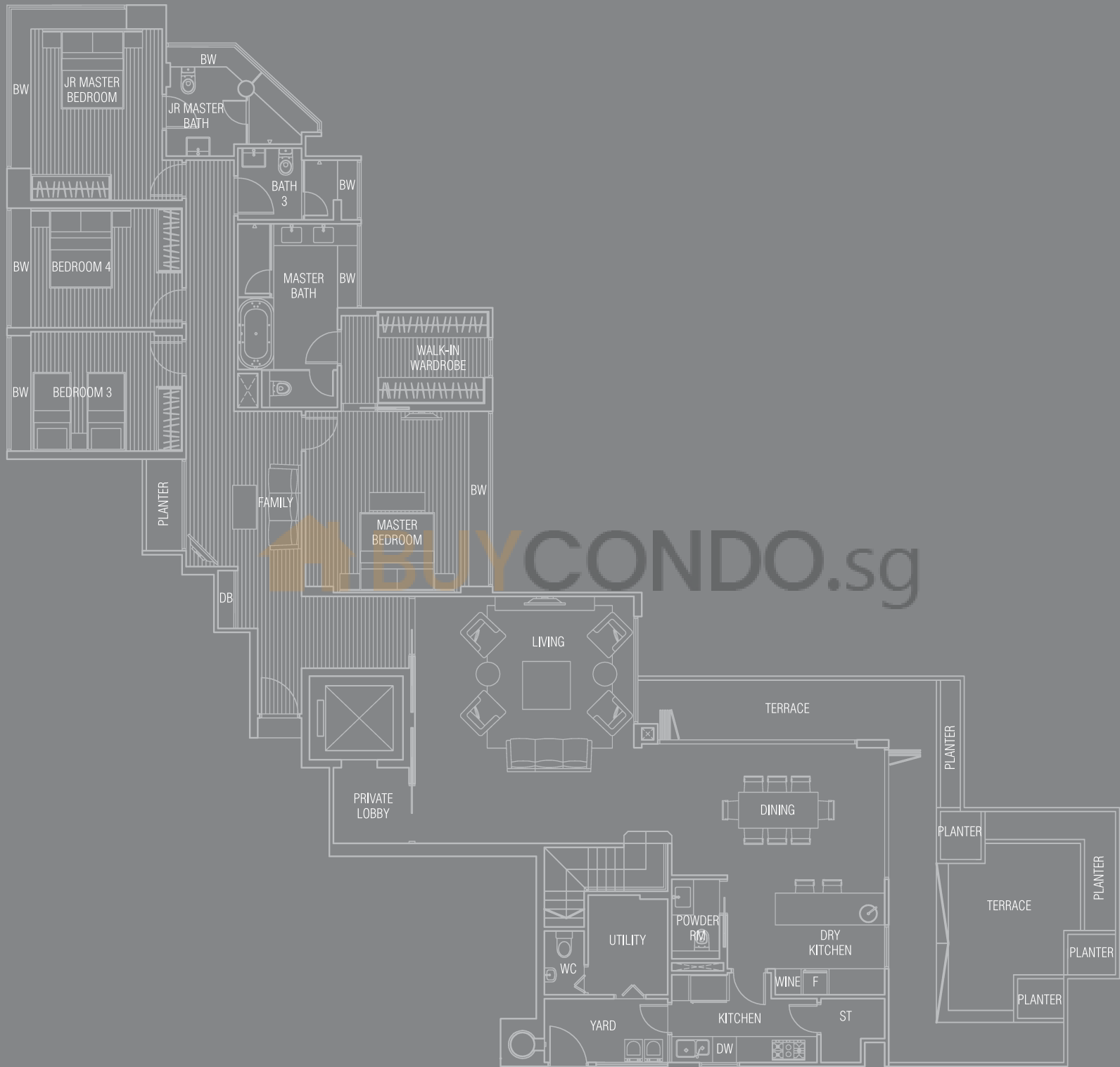

Lower Storey

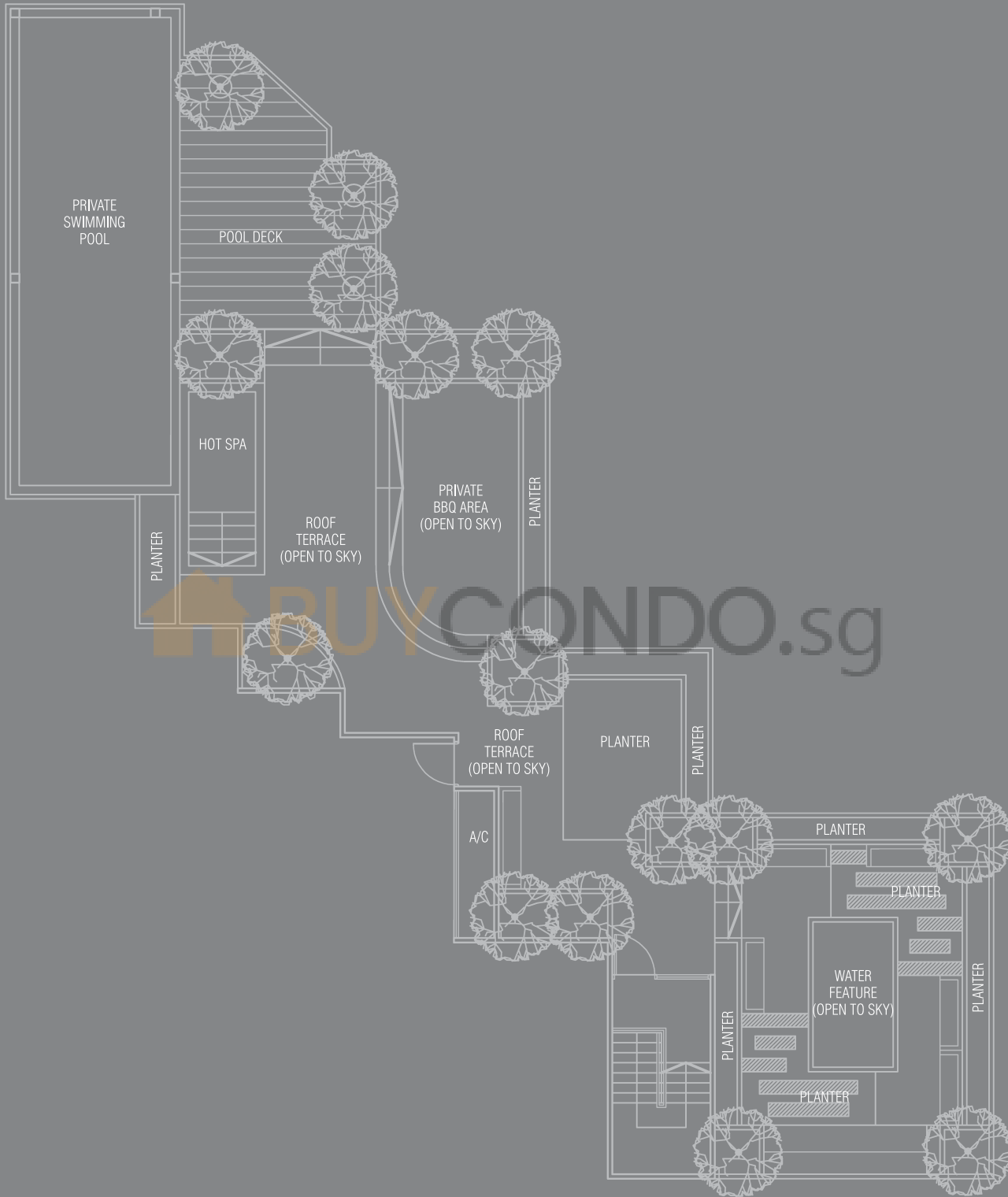

BUY CONDO.sg

Upper Storey

