

# 3 BEDROOM

TYPE A OPTION 1 - BASIC SCHEME  
188 sqm (2023 sqft)

- #03-01
- #04-01
- #05-01
- #06-01
- #07-01
- #08-01
- #09-01
- #10-01
- #11-01
- #12-01
- #13-01
- #14-01
- #15-01

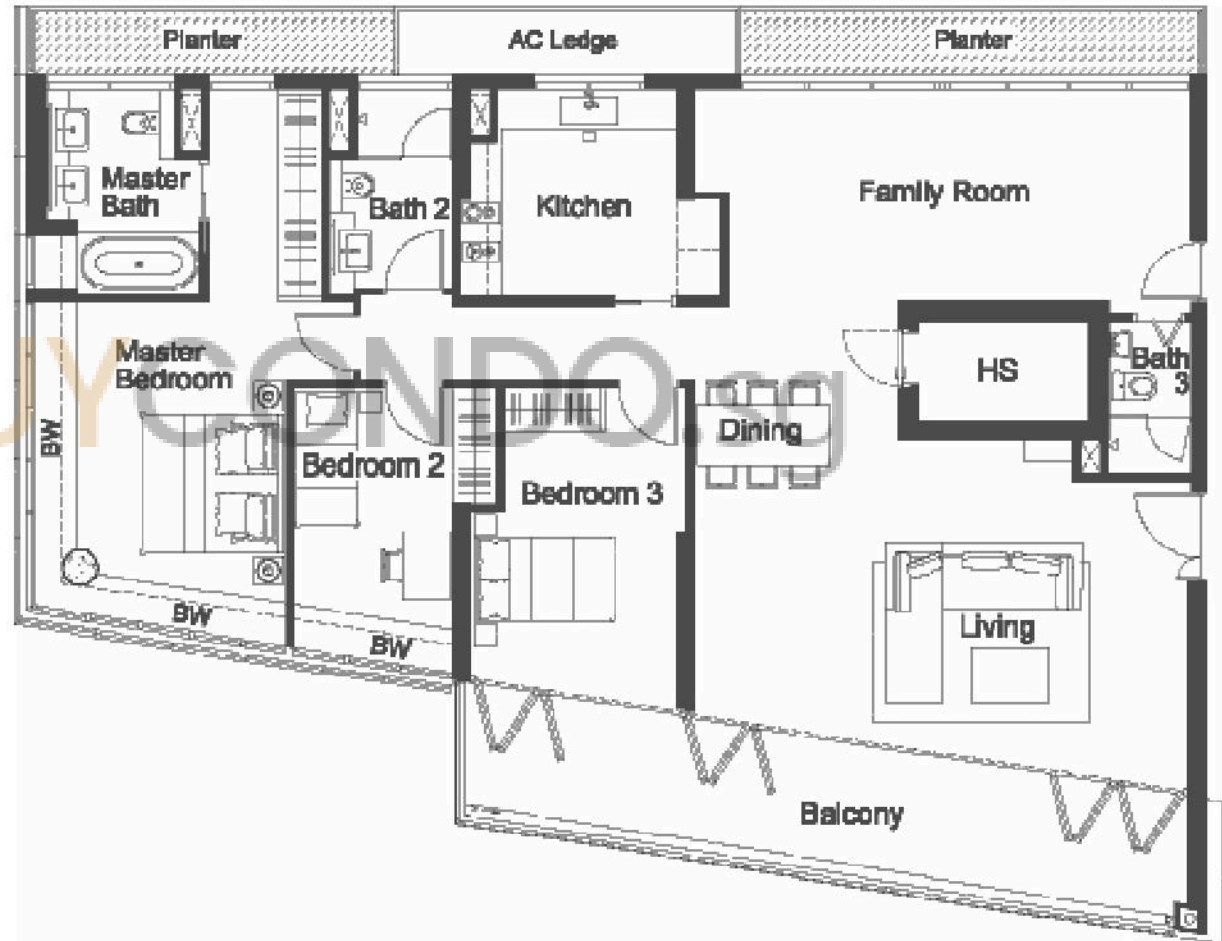

Type A unit shall be constructed in accordance with Option 1 (Basic Scheme) and TOP shall be obtained under the same basic scheme. Option 2 and 3 include additional interior design works which will be completed after TOP.

# 3 BEDROOM

**TYPE A OPTION 2**  
188 sqm (2023 sqft)

- #03-01
- #04-01
- #05-01
- #06-01
- #07-01
- #08-01
- #09-01
- #10-01
- #11-01
- #12-01
- #13-01
- #14-01
- #15-01

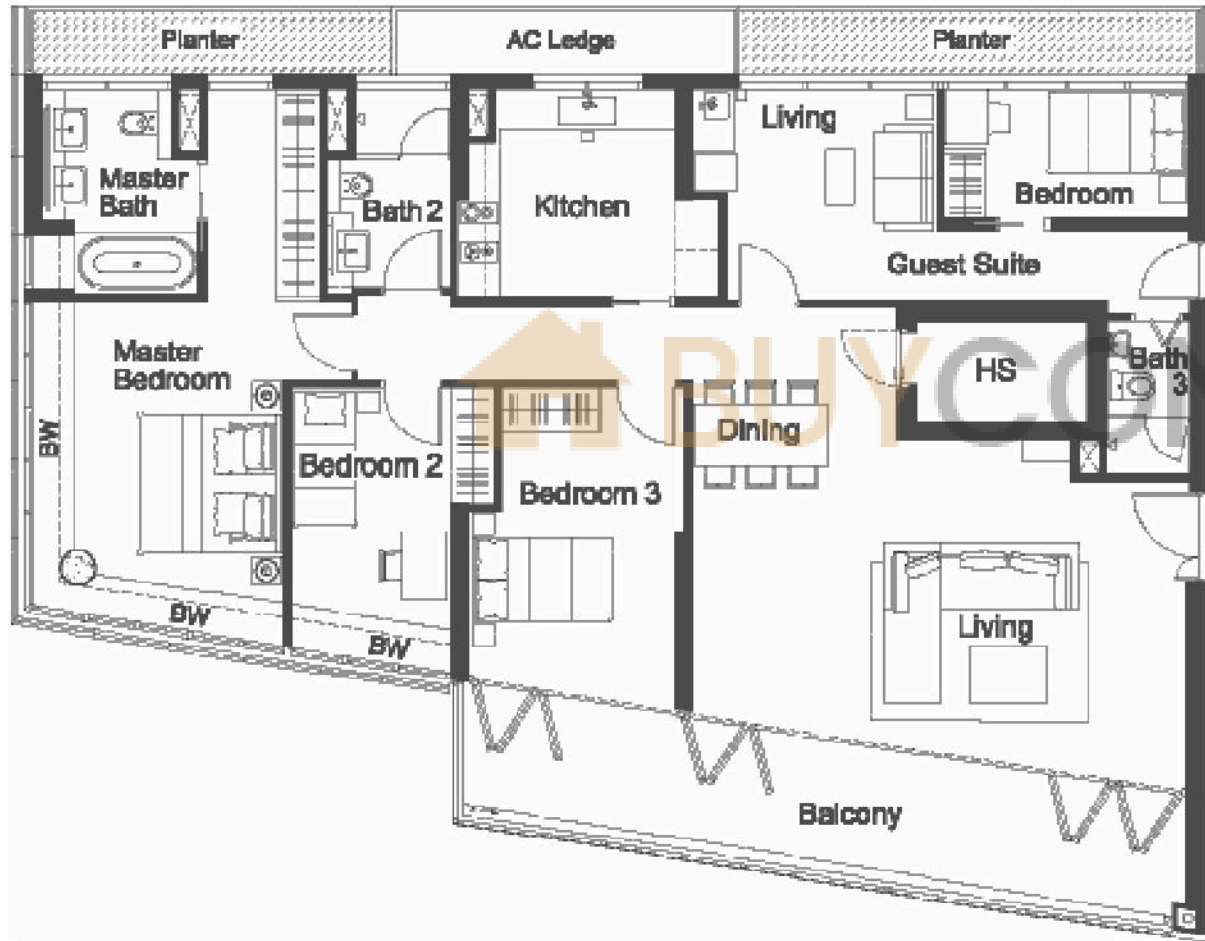

Type A unit shall be constructed in accordance with Option 1 (Basic Scheme) and TOP shall be obtained under the same basic scheme. Option 2 and 3 include additional interior design works which will be completed after TOP.

# 3 BEDROOM

TYPE A OPTION 3  
188 sqm (2023 sqft)

- #03-01
- #04-01
- #05-01
- #06-01
- #07-01
- #08-01
- #09-01
- #10-01
- #11-01
- #12-01
- #13-01
- #14-01
- #15-01

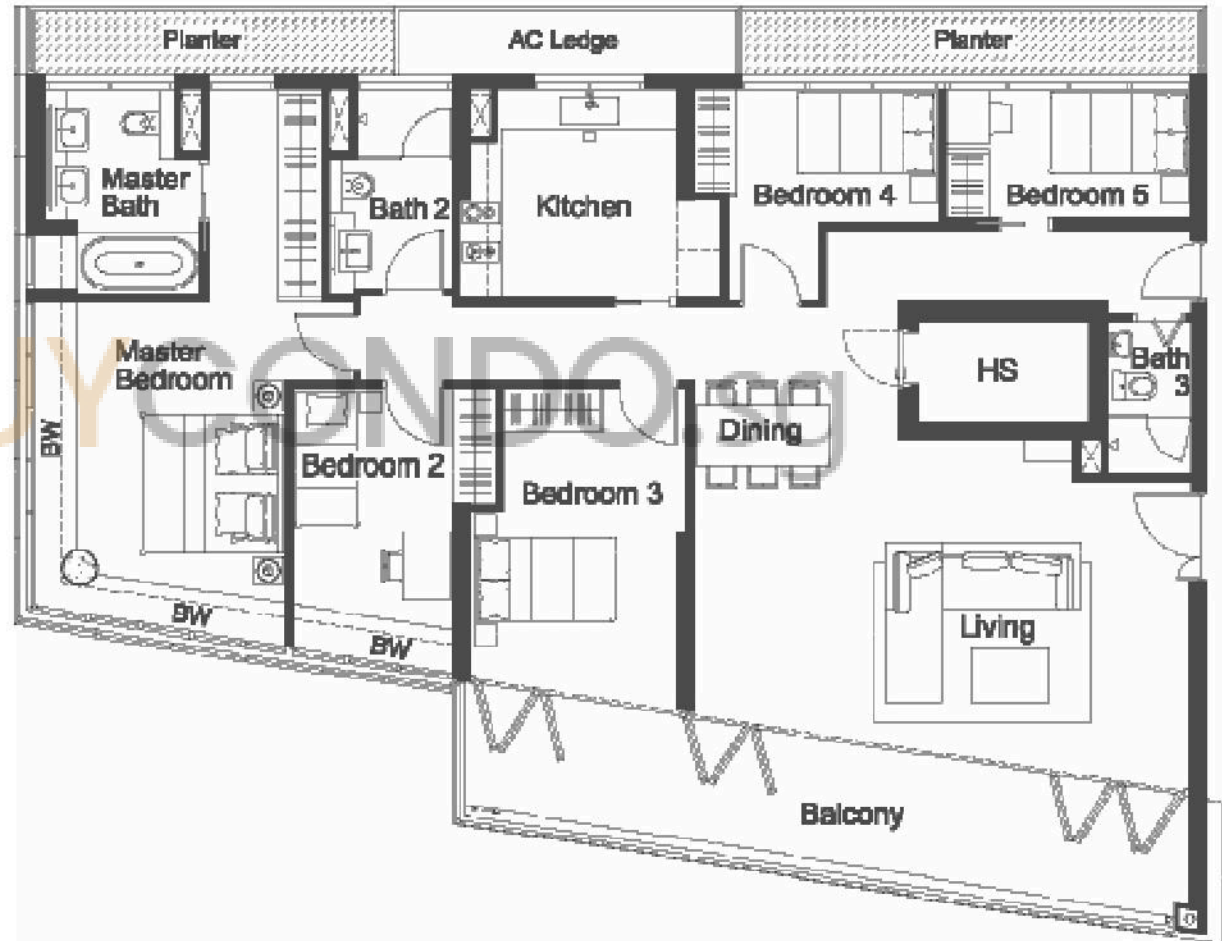

Type A unit shall be constructed in accordance with Option 1 (Basic Scheme) and TOP shall be obtained under the same basic scheme. Option 2 and 3 include additional interior design works which will be completed after TOP.



# 3 BEDROOM

**TYPE B**  
146 sqm (1572 sqft)

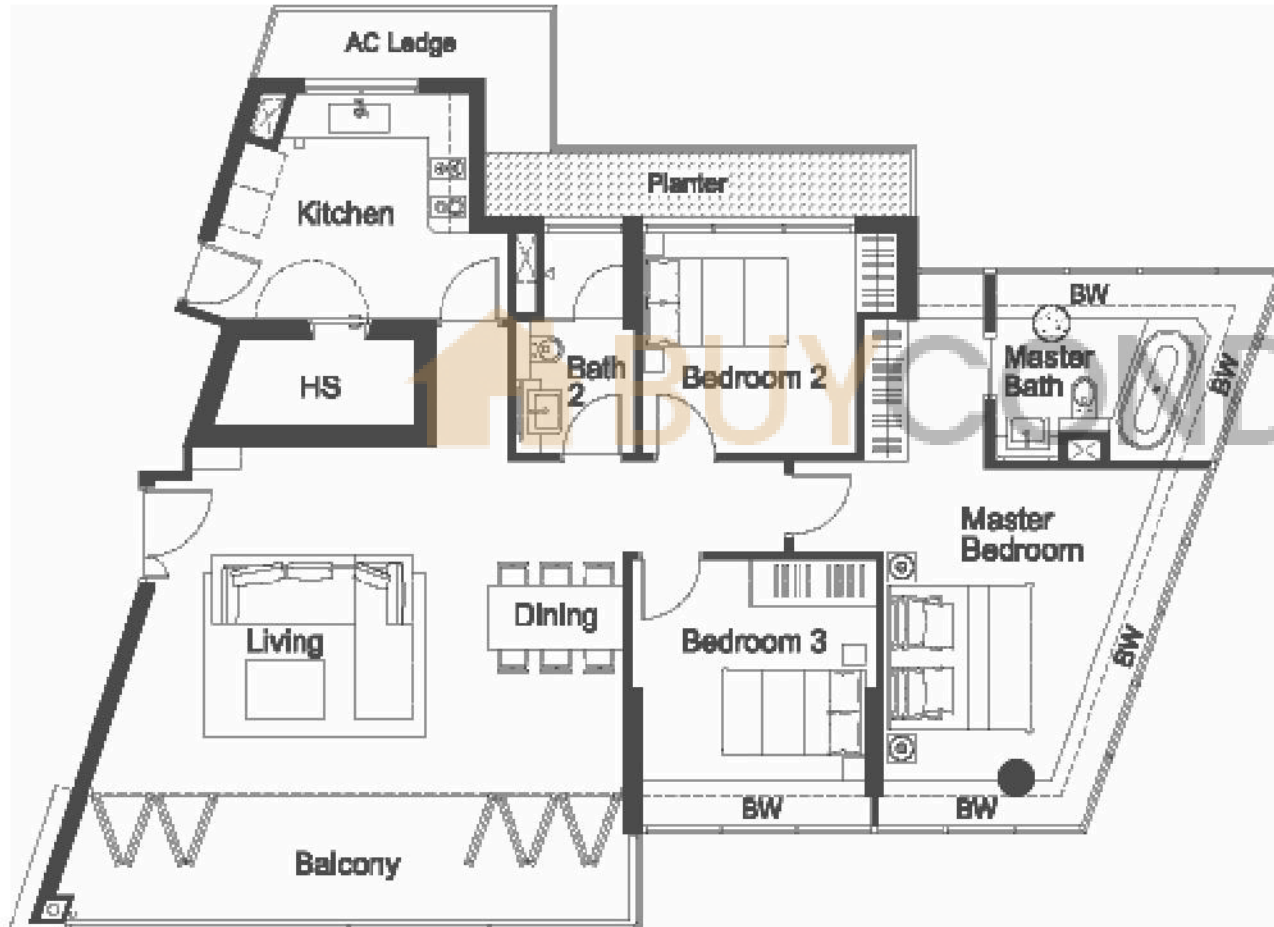

- #03-02
- #04-02
- #05-02
- #06-02
- #07-02
- #08-02
- #09-02
- #10-02
- #11-02
- #12-02
- #13-02
- #14-02
- #15-02

