

3-BEDROOM + YARD

TYPE C1-G 883 sqft / 82 sqm

(Inclusive of 6 sqm PES
& 5 sqm A/C Ledge)

- Block 268 #01-19*
- #01-20
- Block 270 #01-23*
- Block 272 #01-28
- Block 274 #01-31*

TYPE C1-G



TYPE C1 883 sqft / 82 sqm

(Inclusive of 6 sqm Balcony
& 5 sqm A/C Ledge)

- Block 268 #02-19* to #14-19*
- #02-20 to #14-20
- Block 270 #02-23* to #14-23*
- Block 272 #02-28 to #14-28
- Block 274 #02-31* to #14-31*
- Block 276 #03-36 to #14-36

TYPE C1-PH 980 sqft / 91 sqm

(Inclusive of 9 sqm Strata Void,
6 sqm Balcony & 5 sqm A/C Ledge)

- Block 268 #15-20
- Block 270 #15-23*
- Block 272 #15-28
- Block 274 #15-31*
- Block 276 #15-36

TYPE C1 / C1-PH

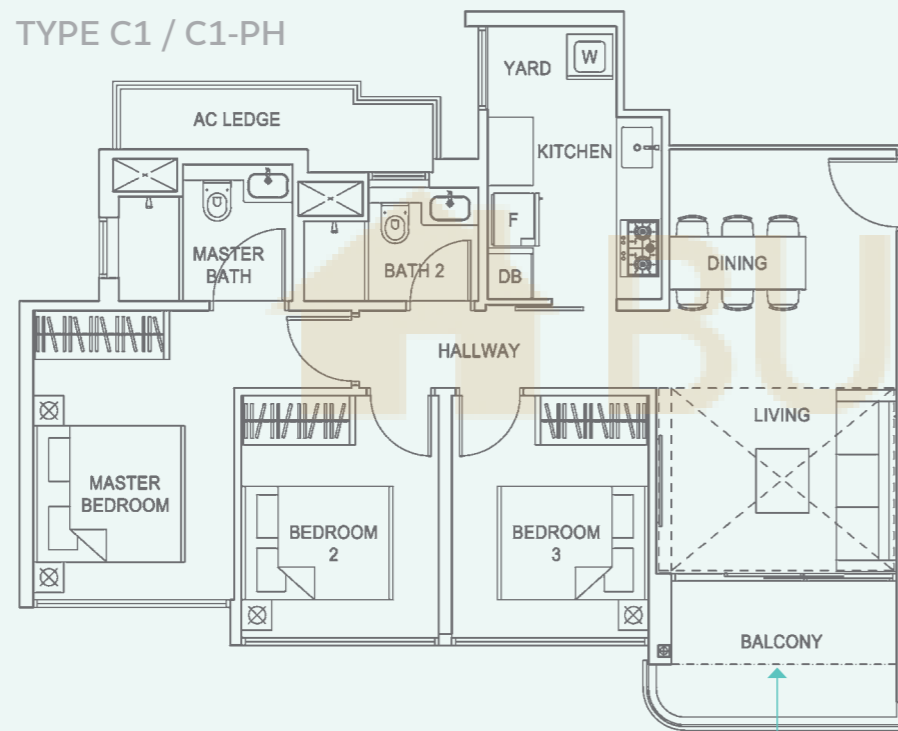

Denotes change in balcony ceiling height at unit #14-19*

Dotted line denotes high ceiling complete with bulkhead at units #15-20, #15-23*, #15-28, #15-31* & #15-36

3-BEDROOM + YARD

TYPE C2-G



TYPE C2-G 915 sqft / 85 sqm

(Inclusive of 6 sqm PES
& 5 sqm A/C Ledge)

- Block 268 #01-17
- #01-18*
- Block 270 #01-22*

TYPE C2 / C2-PH

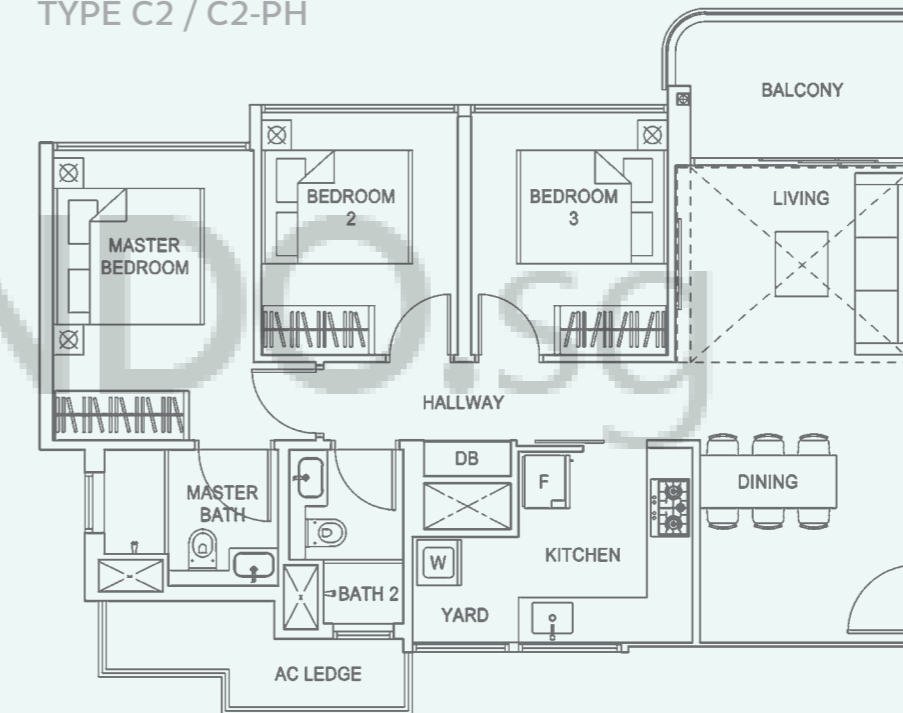

Dotted line denotes high ceiling complete with bulkhead at units #15-17, #15-18*, #15-22* & #15-33

TYPE C2 915 sqft / 85 sqm

(Inclusive of 6 sqm Balcony
& 5 sqm A/C Ledge)

- Block 268 #02-17 to #14-17
- #02-18* to #14-18*
- Block 270 #02-22* to #14-22*
- Block 276 #03-33 to #14-33

TYPE C2-PH 1,012 sqft / 94 sqm

(Inclusive of 9 sqm Strata Void,
6 sqm Balcony & 5 sqm A/C Ledge)

- Block 268 #15-17
- #15-18*
- Block 270 #15-22*
- Block 276 #15-33

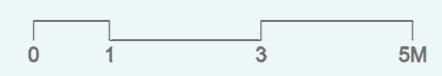
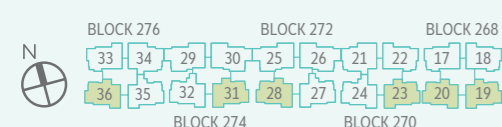
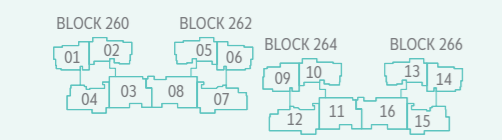

All plans are subject to changes by the authorities. Measurements are approximate only and subject to final survey.
BP No.: A2325-01161-2016-BP01 Dated 15 May 2017

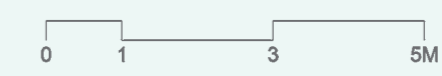
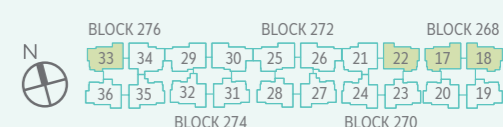
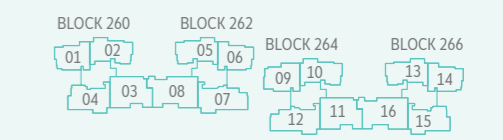
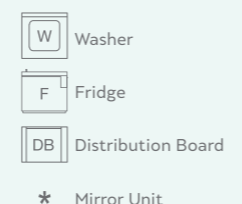

All plans are subject to changes by the authorities. Measurements are approximate only and subject to final survey.
BP No.: A2325-01161-2016-BP01 Dated 15 May 2017



3-BEDROOM + UTILITY + YARD

3-BEDROOM + STUDY + YARD

TYPE C3-G 958 sqft / 89 sqm

(Inclusive of 6 sqm PES & 5 sqm A/C Ledge)

- Block 270 #01-24*
- Block 272 #01-27
- Block 274 #01-32*
- Block 276 #01-35

TYPE C3-G



TYPE C4-G



TYPE C4-G 969 sqft / 90 sqm

(Inclusive of 6 sqm PES & 5 sqm A/C Ledge)

- Block 260 #01-01
- Block 262 #01-06*
- Block 266 #01-14*

TYPE C3 958 sqft / 89 sqm

(Inclusive of 6 sqm Balcony & 5 sqm A/C Ledge)

- Block 270 #02-24* to #14-24*
- Block 272 #02-27 to #14-27
- Block 274 #02-32* to #14-32*
- Block 276 #02-35 to #14-35

TYPE C3 / C3-PH

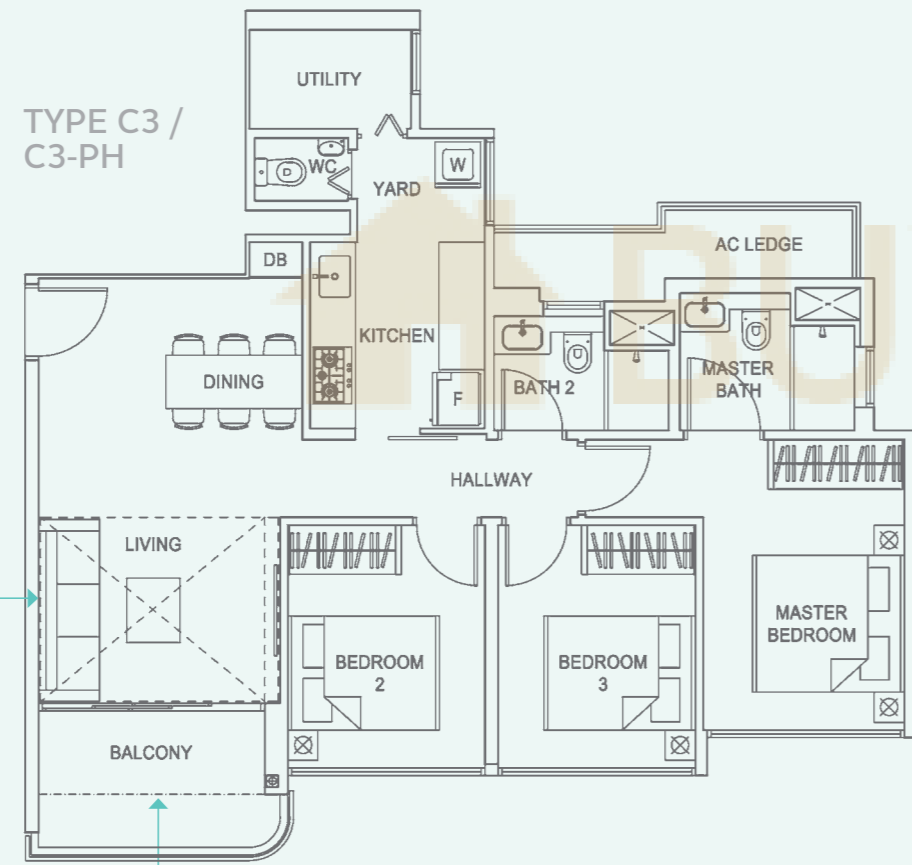

Denotes change in balcony ceiling height at units #14-24* & #14-35

Dotted line denotes high ceiling complete with bulkhead at units #15-27 & #15-32*

TYPE C4 / C4-PH

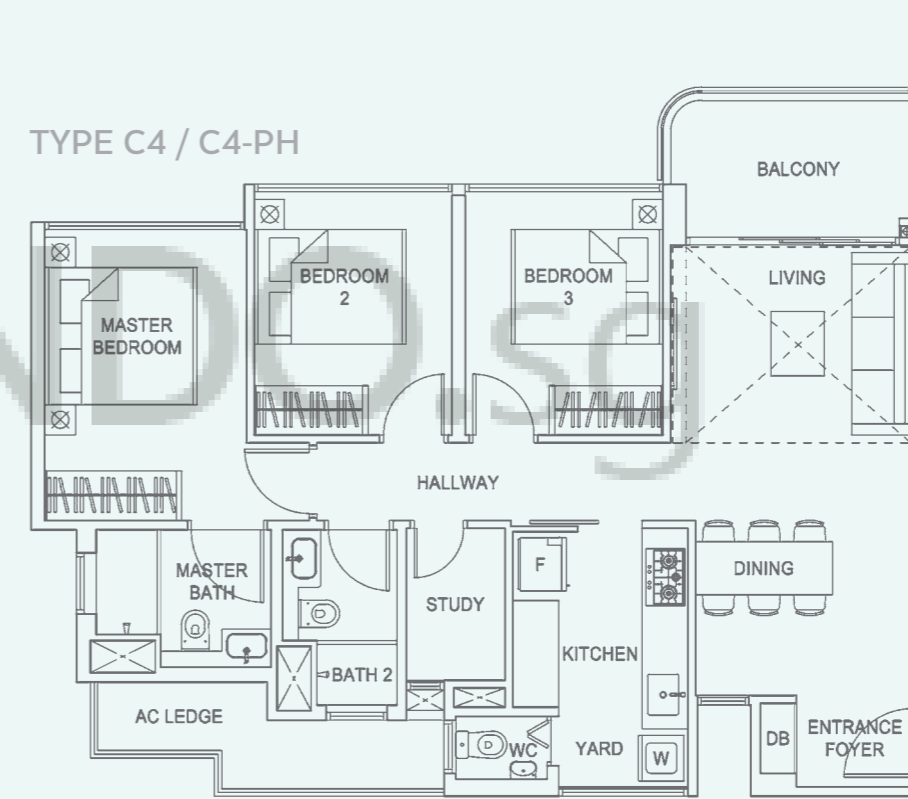

Dotted line denotes high ceiling complete with bulkhead at units #15-01, #15-06* & #15-14*

TYPE C4 969 sqft / 90 sqm

(Inclusive of 6 sqm Balcony & 5 sqm A/C Ledge)

- Block 260 #02-01 to #14-01
- Block 262 #02-06* to #14-06*
- Block 266 #02-14* to #14-14*

TYPE C4-PH 1,066 sqft / 99 sqm

(Inclusive of 9 sqm Strata Void, 6 sqm Balcony & 5 sqm A/C Ledge)

- Block 260 #15-01
- Block 262 #15-06*
- Block 266 #15-14*

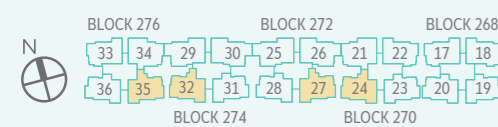
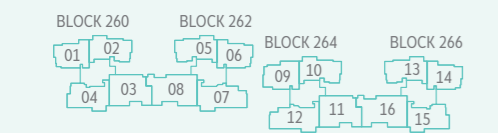

All plans are subject to changes by the authorities. Measurements are approximate only and subject to final survey. BP No.: A2325-01161-2016-BP01 Dated 15 May 2017

- W Washer
- F Fridge
- DB Distribution Board
- WC Water Closet
- * Mirror Unit

- W Washer
- F Fridge
- DB Distribution Board
- WC Water Closet
- * Mirror Unit



All plans are subject to changes by the authorities. Measurements are approximate only and subject to final survey. BP No.: A2325-01161-2016-BP01 Dated 15 May 2017

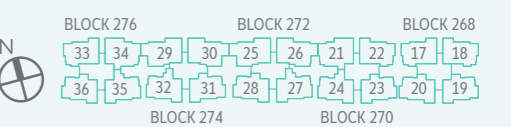
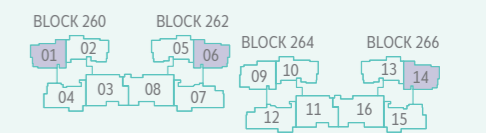

3-BEDROOM + UTILITY + YARD

3-BEDROOM + STUDY + YARD

TYPE C5-G 1,001 sqft / 93 sqm

(Inclusive of 10 sqm PES & 5 sqm A/C Ledge)

Block 270 #01-21*
Block 276 #01-34

TYPE C5-G

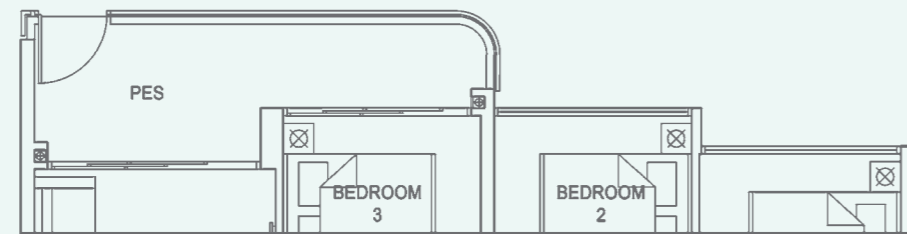

TYPE C6-G

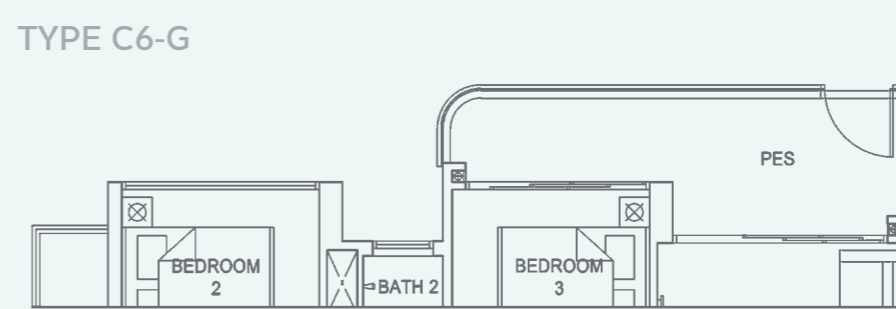

TYPE C6-G 1,012 sqft / 94 sqm

(Inclusive of 10 sqm PES & 6 sqm A/C Ledge)

Block 264 #01-09

TYPE C5 1,001 sqft / 93 sqm

(Inclusive of 10 sqm Balcony & 5 sqm A/C Ledge)

Block 270 #02-21* to #14-21*
Block 276 #02-34 to #14-34

TYPE C5 / C5-PH

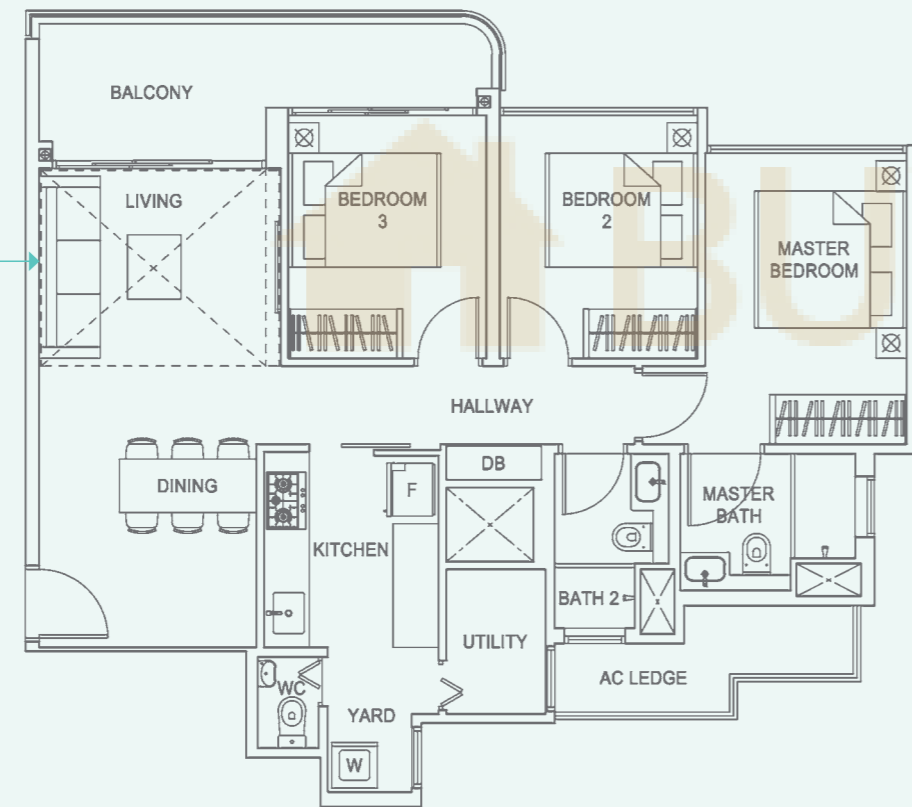

Dotted line denotes high ceiling complete with bulkhead at units #15-21* & #15-34

TYPE C6 / C6-PH

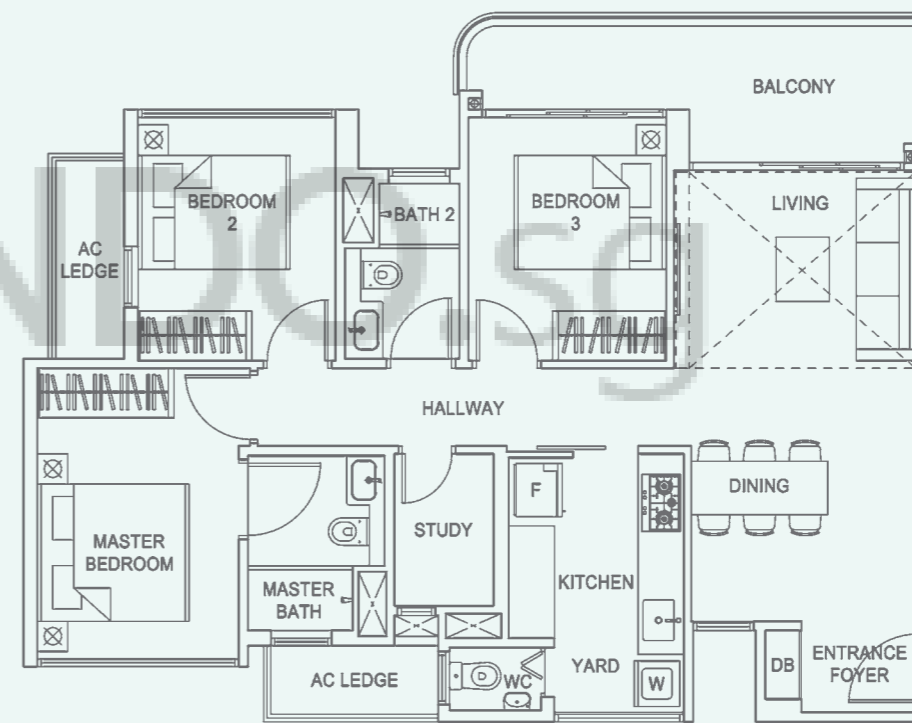

Dotted line denotes high ceiling complete with bulkhead at unit #15-09

TYPE C6 1,012 sqft / 94 sqm

(Inclusive of 10 sqm Balcony & 6 sqm A/C Ledge)

Block 264 #02-09 to #14-09

TYPE C6-PH 1,109 sqft / 103 sqm

(Inclusive of 9 sqm Strata Void, 10 sqm Balcony & 6 sqm A/C Ledge)

Block 264 #15-09

TYPE C5-PH 1,098 sqft / 102 sqm

(Inclusive of 9 sqm Strata Void, 10 sqm Balcony & 5 sqm A/C Ledge)

Block 270 #15-21*
Block 276 #15-34

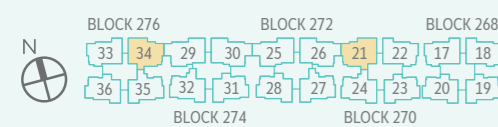
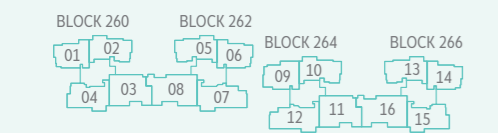

All plans are subject to changes by the authorities. Measurements are approximate only and subject to final survey.
BP No.: A2325-01161-2016-BP01 Dated 15 May 2017

- Washer
- Fridge
- Distribution Board
- Water Closet
- Mirror Unit

- Washer
- Fridge
- Distribution Board
- Water Closet



All plans are subject to changes by the authorities. Measurements are approximate only and subject to final survey.
BP No.: A2325-01161-2016-BP01 Dated 15 May 2017

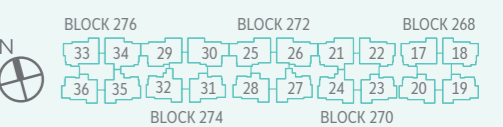
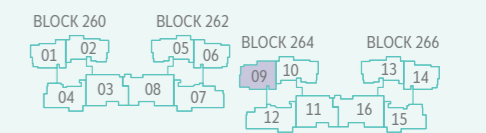

3-BEDROOM + YARD

3-BEDROOM + UTILITY + YARD

TYPE C7-G

1,055 sqft / 98 sqm

(Inclusive of 12 sqm PES & 6 sqm A/C Ledge)

- Block 260 #01-02
- Block 262 #01-05*
- Block 264 #01-10
- Block 266 #01-13*

TYPE C7-G

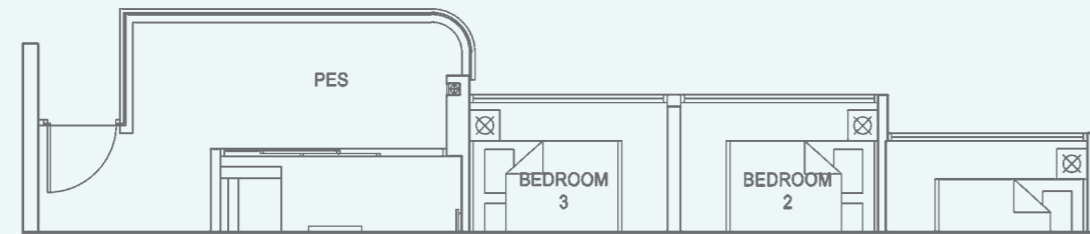

TYPE C7

1,055 sqft / 98 sqm

(Inclusive of 12 sqm Balcony & 6 sqm A/C Ledge)

- Block 260 #02-02 to #14-02
- Block 262 #02-05* to #14-05*
- Block 264 #02-10 to #14-10
- Block 266 #02-13* to #14-13*

TYPE C7 / C7-PH

Dotted line denotes high ceiling complete with bulkhead at units #15-05* & #15-10

Denotes change in balcony ceiling height at units #14-02 & #14-13*

Denotes change in balcony ceiling height at units #15-05* & #15-10

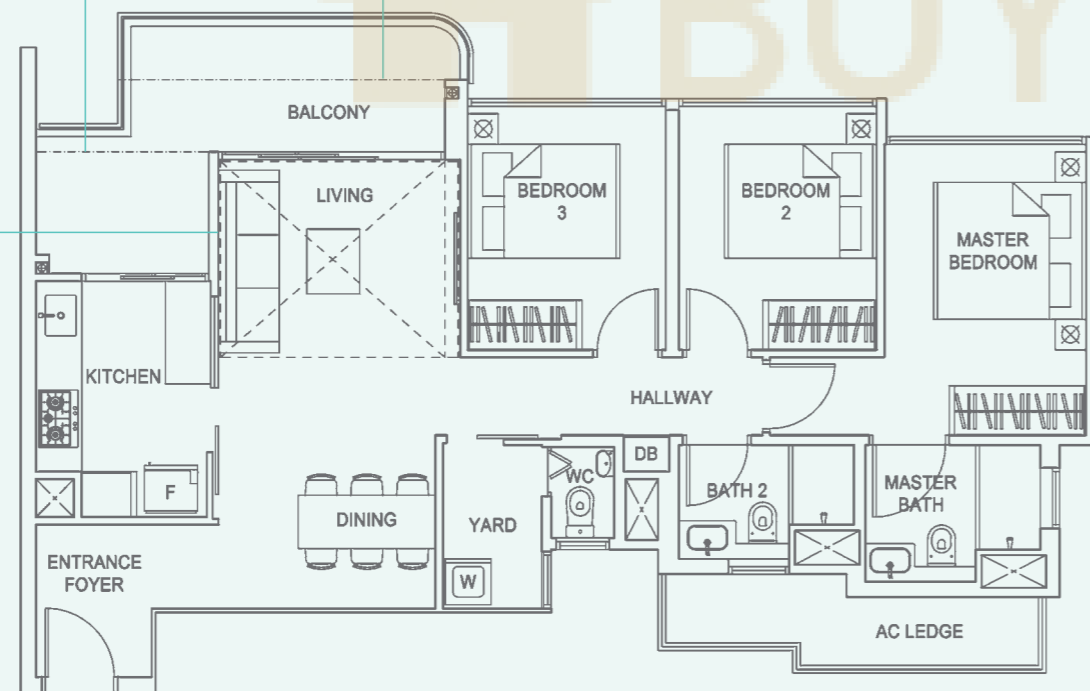

TYPE C7-PH

1,152 sqft / 107 sqm

(Inclusive of 9 sqm Strata Void, 12 sqm Balcony & 6 sqm A/C Ledge)

- Block 262 #15-05*
- Block 264 #15-10

TYPE C8-G

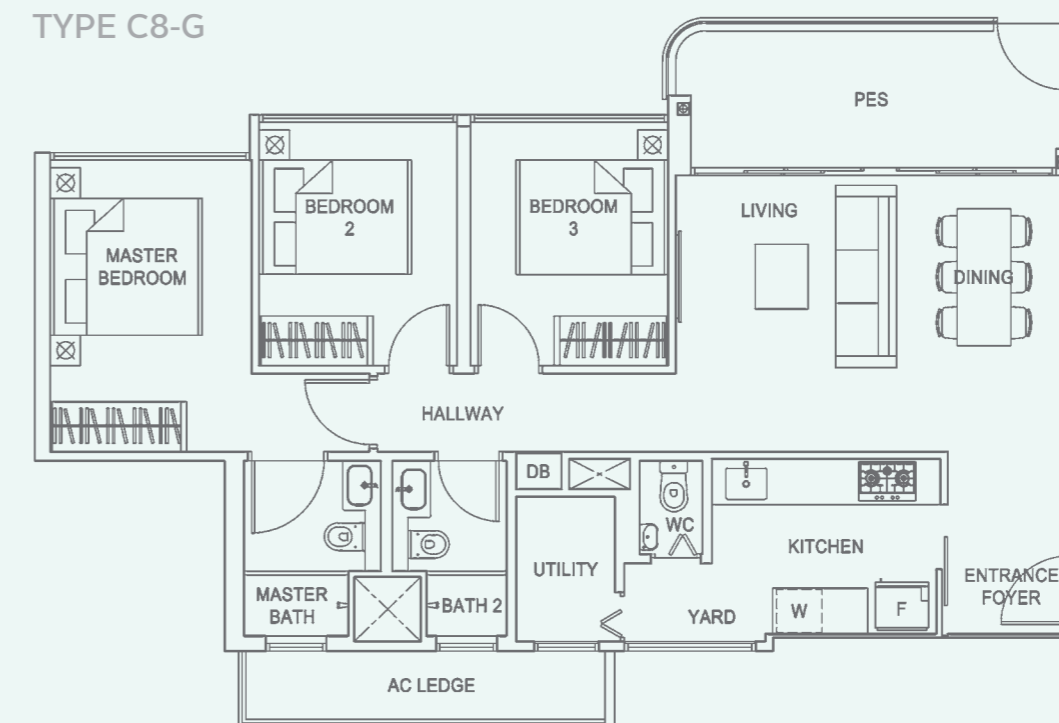

TYPE C8-G

1,044 sqft / 97 sqm

(Inclusive of 10 sqm PES & 5 sqm A/C Ledge)

- Block 272 #01-25
- #01-26*
- Block 274 #01-29
- #01-30*

TYPE C8 / C8-PH

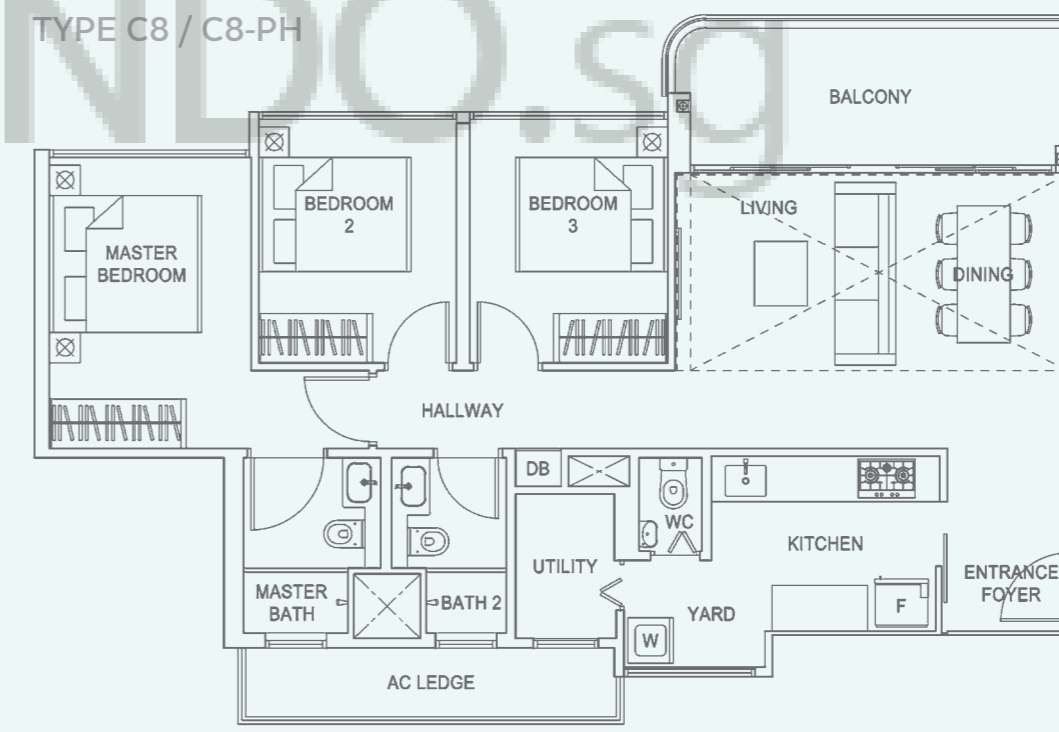

TYPE C8

1,055 sqft / 98 sqm

(Inclusive of 10 sqm Balcony & 5 sqm A/C Ledge)

- Block 272 #02-25 to #14-25
- #02-26* to #14-26*
- Block 274 #02-29 to #14-29
- #02-30* to #14-30*

TYPE C8-PH

1,216 sqft / 113 sqm

(Inclusive of 15 sqm Strata Void, 10 sqm Balcony & 5 sqm A/C Ledge)

- Block 272 #15-25
- #15-26*
- Block 274 #15-29
- #15-30*

Dotted line denotes high ceiling complete with bulkhead at unit #15-25, #15-26*, #15-29 & #15-30*

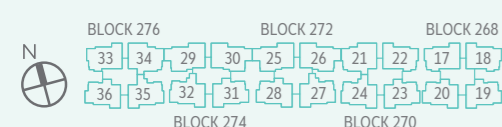
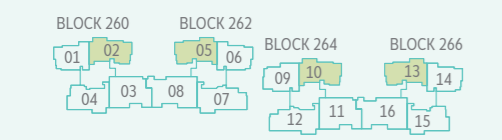

All plans are subject to changes by the authorities. Measurements are approximate only and subject to final survey. BP No.: A2325-01161-2016-BP01 Dated 15 May 2017

- W Washer
- F Fridge
- DB Distribution Board
- WC Water Closet
- * Mirror Unit

- W Undercounter Washer
- W Washer
- F Fridge
- DB Distribution Board
- WC Water Closet
- * Mirror Unit



All plans are subject to changes by the authorities. Measurements are approximate only and subject to final survey. BP No.: A2325-01161-2016-BP01 Dated 15 May 2017

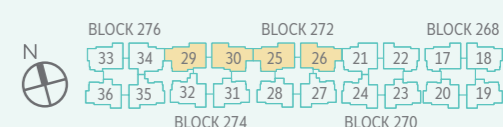
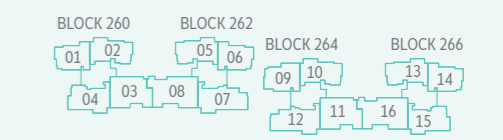

3-BEDROOM + UTILITY + YARD

4-BEDROOM + UTILITY + YARD

TYPE C9-G 1,130 sqft / 105 sqm

(Inclusive of 13 sqm PES & 6 sqm A/C Ledge)

Block 260 #01-04
Block 266 #01-15*

TYPE C9-G

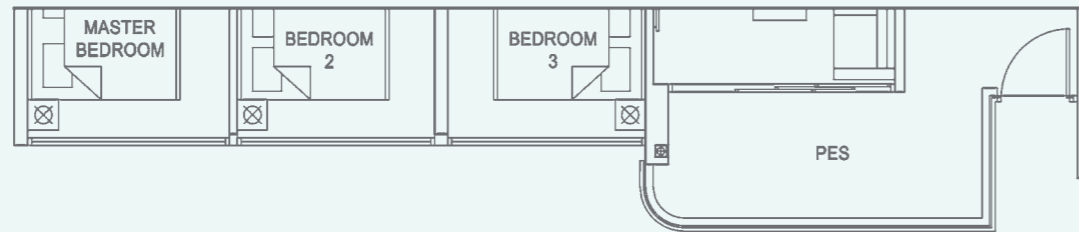

TYPE D1-G

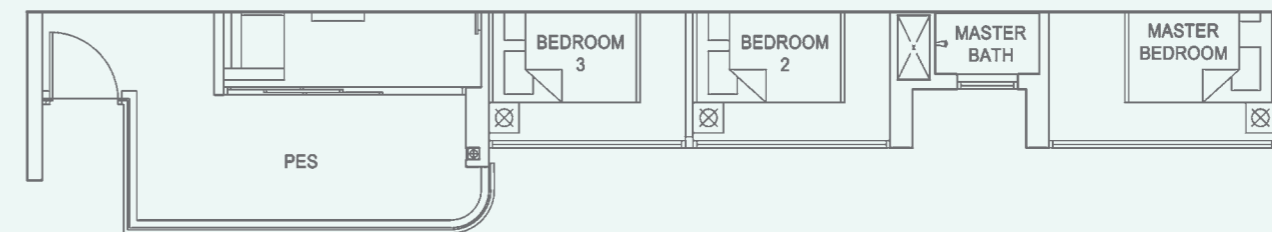

TYPE D1-G 1,270 sqft / 118 sqm

(Inclusive of 13 sqm PES & 6 sqm A/C Ledge)

Block 262 #01-07
Block 264 #01-12*

TYPE C9 1,130 sqft / 105 sqm

(Inclusive of 13 sqm Balcony & 6 sqm A/C Ledge)

Block 260 #02-04 to #14-04
Block 266 #02-15* to #14-15*

TYPE C9 / C9-PH

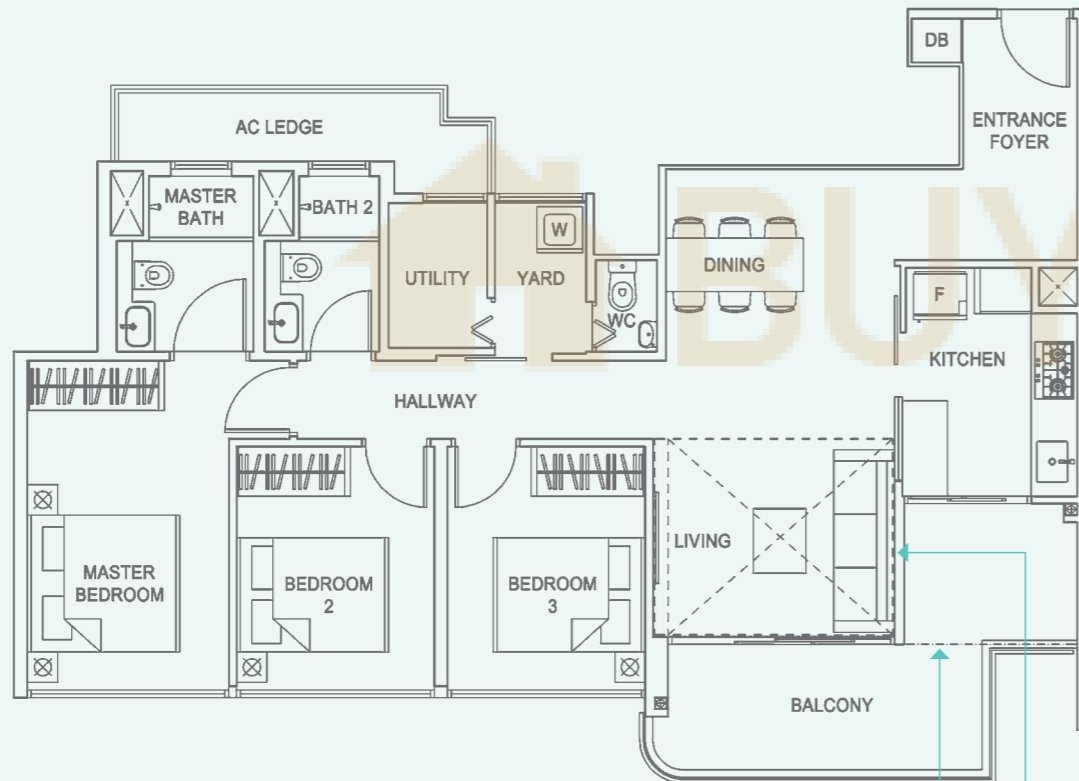

Denotes change in balcony ceiling height at units #15-04 & #15-15*

Dotted line denotes high ceiling complete with bulkhead at units #15-04 & #15-15*

TYPE D1 / D1-PH

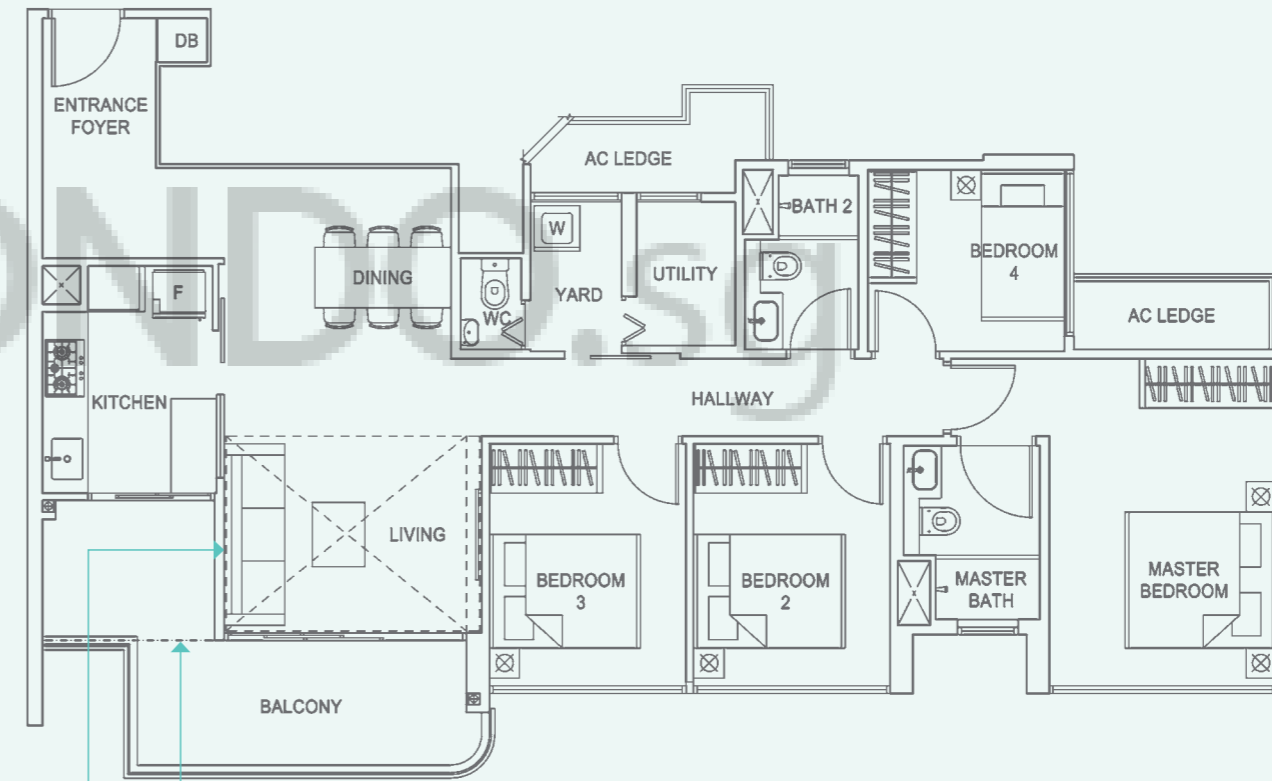

Denotes change in balcony ceiling height at units #15-07 & #15-12*

Dotted line denotes high ceiling complete with bulkhead at units #15-07 & #15-12*

TYPE D1 1,270 sqft / 118 sqm

(Inclusive of 13 sqm Balcony & 6 sqm A/C Ledge)

Block 262 #02-07 to #14-07
Block 264 #02-12* to #14-12*

TYPE C9-PH 1,227 sqft / 114 sqm

(Inclusive of 9 sqm Strata Void, 13 sqm Balcony & 6 sqm A/C Ledge)

Block 260 #15-04
Block 266 #15-15*

TYPE D1-PH 1,378 sqft / 128 sqm

(Inclusive of 10 sqm Strata Void, 13 sqm Balcony & 6 sqm A/C Ledge)

Block 262 #15-07
Block 264 #15-12*

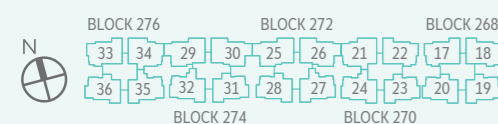
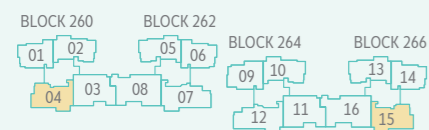

All plans are subject to changes by the authorities. Measurements are approximate only and subject to final survey.
BP No.: A2325-01161-2016-BP01 Dated 15 May 2017

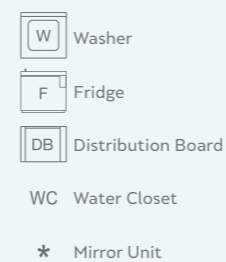
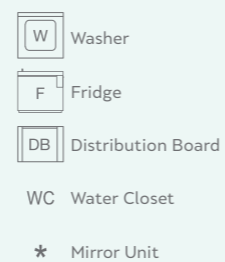

All plans are subject to changes by the authorities. Measurements are approximate only and subject to final survey.
BP No.: A2325-01161-2016-BP01 Dated 15 May 2017

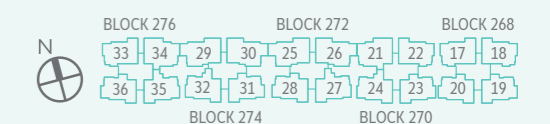
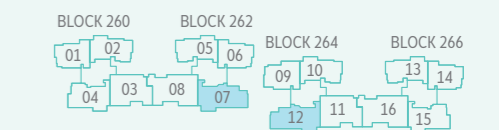

4-BEDROOM + UTILITY + YARD

5-BEDROOM + UTILITY + YARD

TYPE D2-G 1,324 sqft / 123 sqm

(Inclusive of 19 sqm PES & 6 sqm A/C Ledge)

Block 260 #01-03
Block 264 #01-11

TYPE D2-G

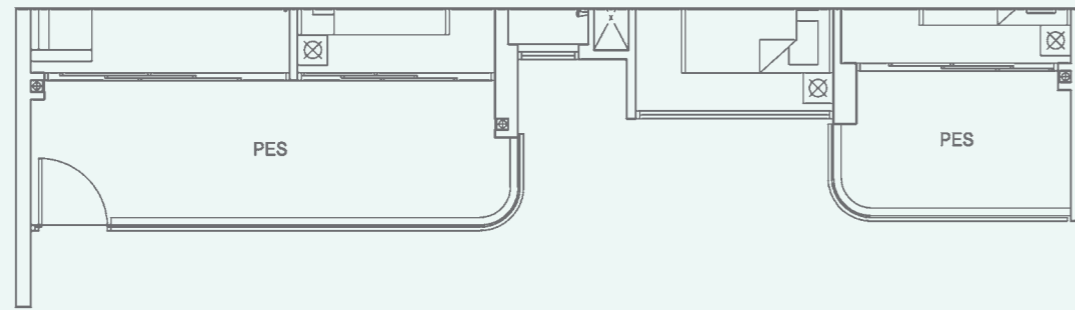

TYPE E1-G

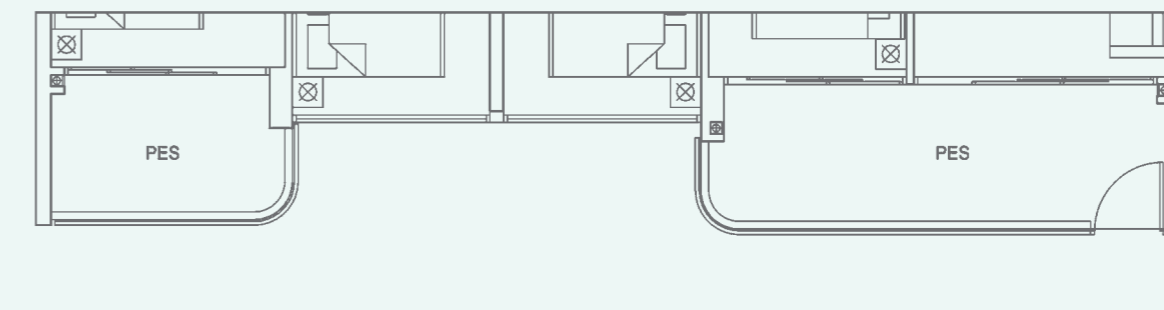

TYPE E1-G 1,528 sqft / 142 sqm

(Inclusive of 18 sqm PES & 8 sqm A/C Ledge)

Block 262 #01-08
Block 266 #01-16

TYPE D2 1,324 sqft / 123 sqm

(Inclusive of 19 sqm Balcony & 6 sqm A/C Ledge)

Block 260 #02-03 to #14-03
Block 264 #02-11 to #14-11

TYPE D2 / D2-PH

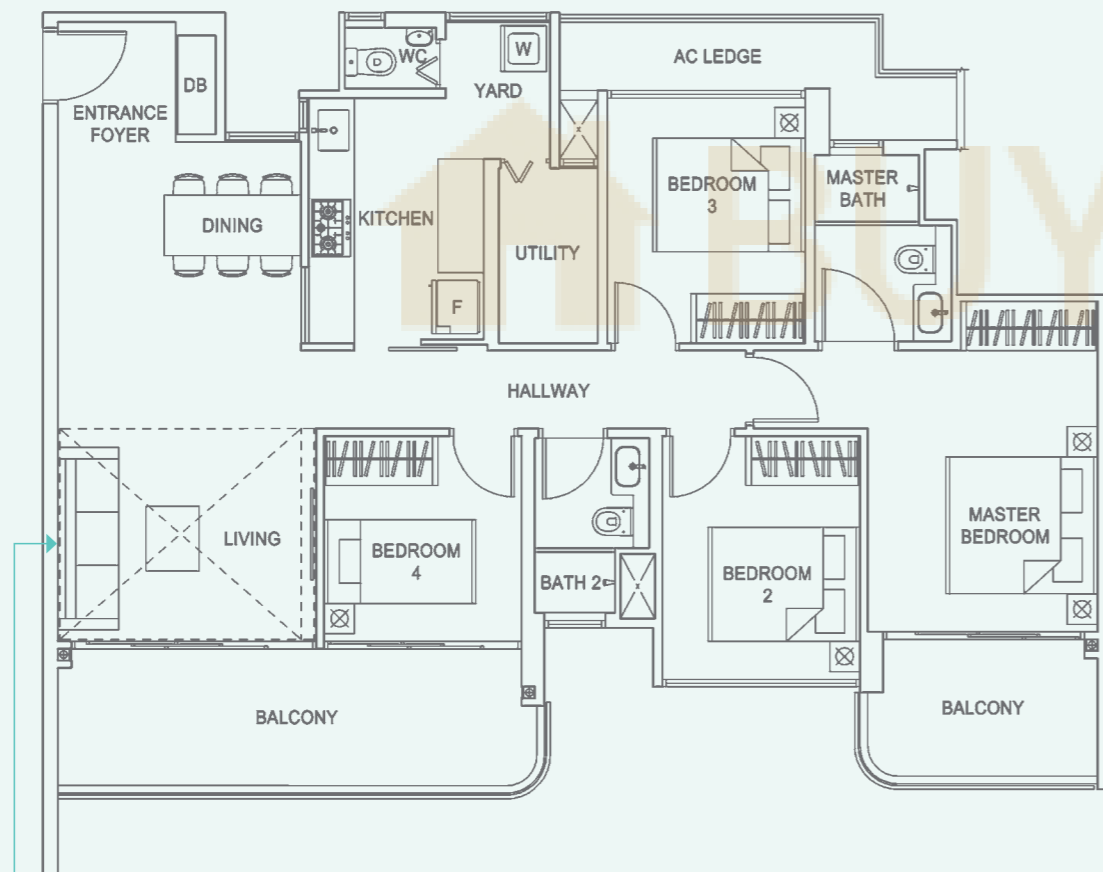

Dotted line denotes high ceiling complete with bulkhead at units #15-03 & #15-11

TYPE E1 / E1-PH

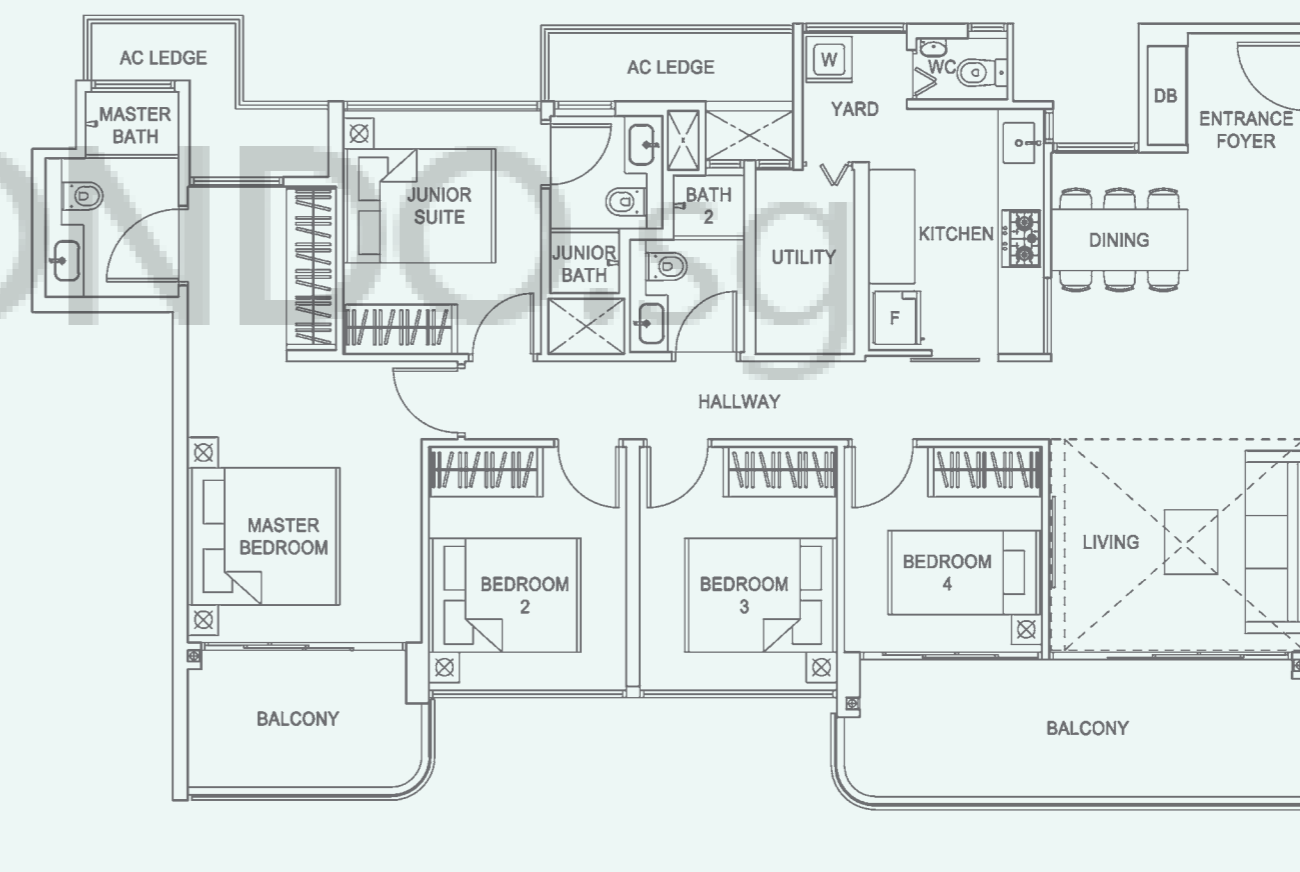

Dotted line denotes high ceiling complete with bulkhead at units #15-08 & #15-16

TYPE E1 1,528 sqft / 142 sqm

(Inclusive of 18 sqm Balcony & 8 sqm A/C Ledge)

Block 262 #02-08 to #14-08
Block 266 #02-16 to #14-16

TYPE E1-PH 1,636 sqft / 152 sqm

(Inclusive of 10 sqm Strata Void, 18 sqm Balcony & 8 sqm A/C Ledge)

Block 262 #15-08
Block 266 #15-16

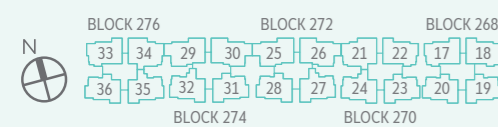
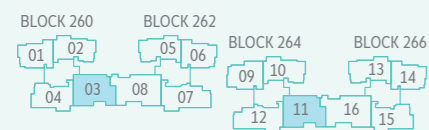

All plans are subject to changes by the authorities. Measurements are approximate only and subject to final survey.
BP No.: A2325-01161-2016-BP01 Dated 15 May 2017

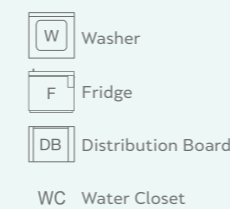
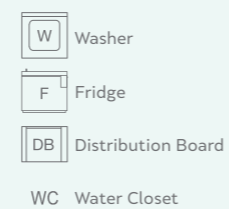

All plans are subject to changes by the authorities. Measurements are approximate only and subject to final survey.
BP No.: A2325-01161-2016-BP01 Dated 15 May 2017

