

ANCILLARY OFFICE FLOOR PLAN

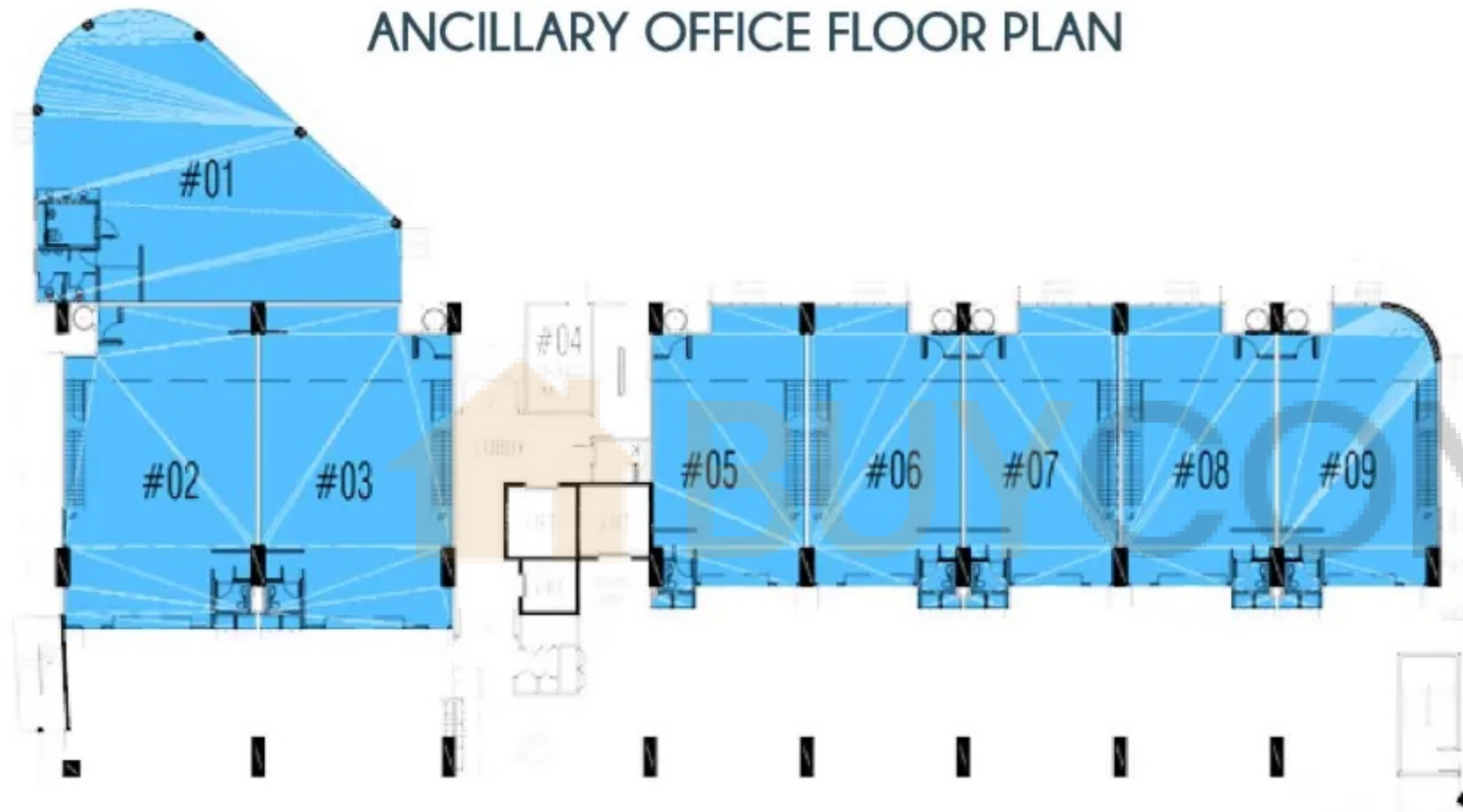

1ST STOREY PLAN

UNIT	AREA (sq ft)
#01-01	2,573 sq ft
#01-02	4,026 sq ft
#01-03	4,026 sq ft
#01-05	2,756 sq ft
#01-06	2,766 sq ft
#01-07	2,766 sq ft
#01-08	2,766 sq ft
#01-09	2,831 sq ft

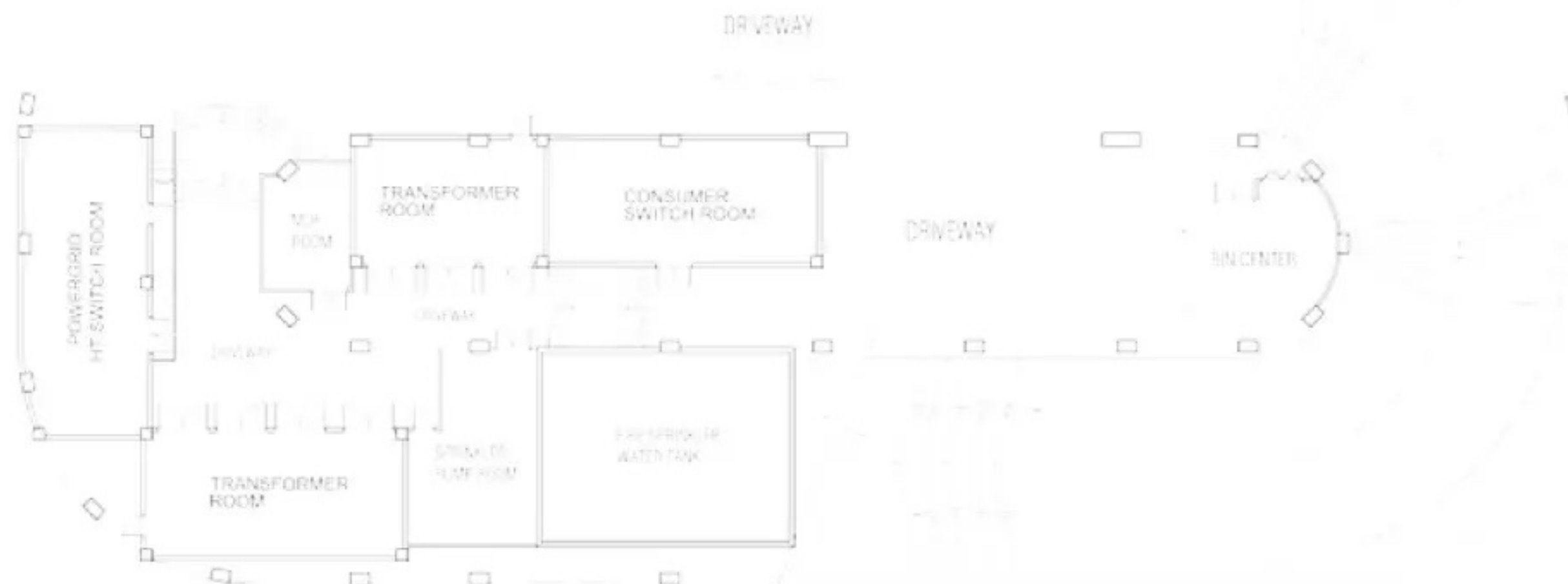

Areas include Ancillary Office, AC Ledge and Void.

2ND STOREY PLAN

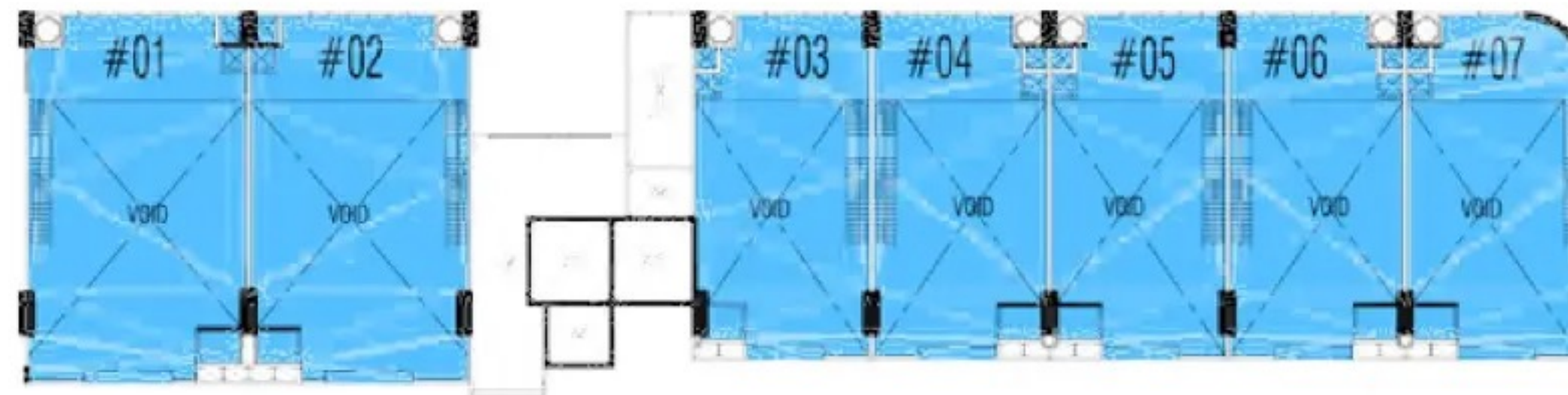

ANCILLARY OFFICE FLOOR PLAN

UNIT	AREA (sq ft)
#02-01	3,757 sq ft
#02-02	3,757 sq ft
#02-03	2,852 sq ft
#02-04	2,874 sq ft
#02-05	2,874 sq ft
#02-06	2,874 sq ft
#02-07	2,949 sq ft
#02-08	1,851 sq ft

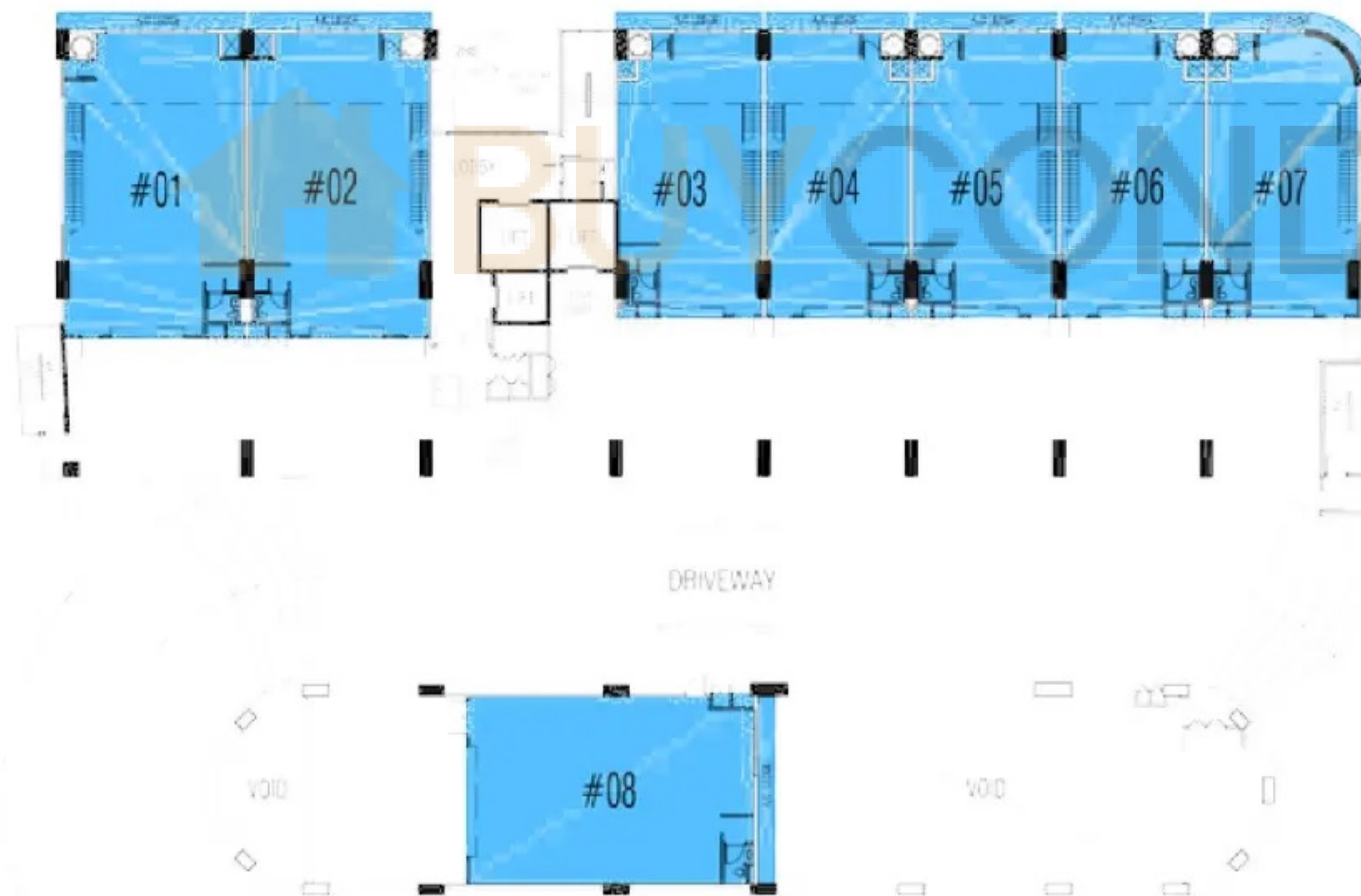

Areas include Ancillary Office, AC Ledge and Void.

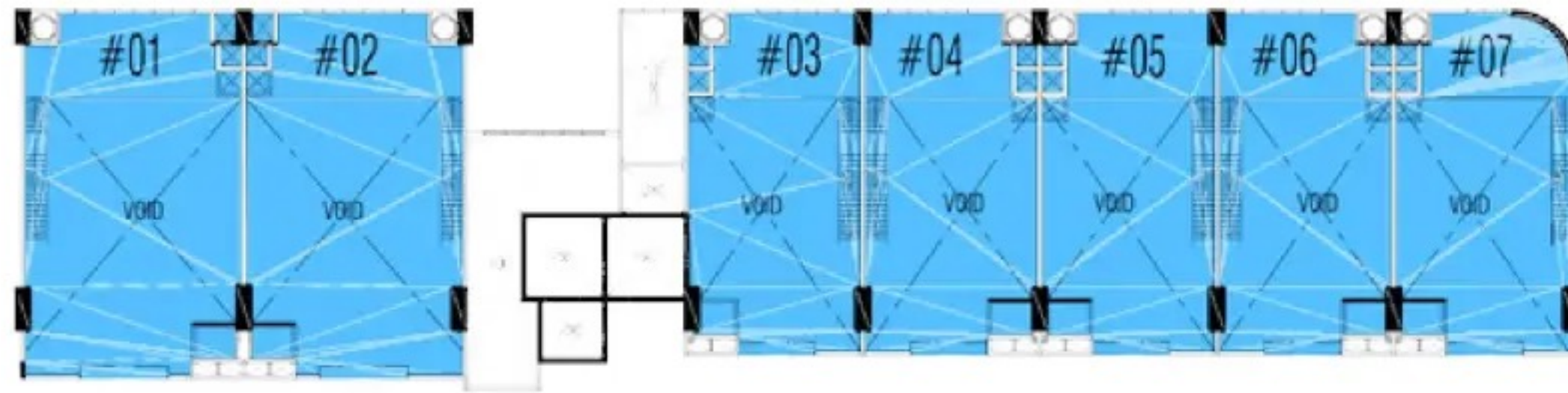

ANCILLARY OFFICE FLOOR PLAN

3RD STOREY PLAN

UNIT	AREA (sq ft)
#03-01	3,714 sq ft
#03-02	3,714 sq ft
#03-03	2,809 sq ft
#03-04	2,820 sq ft
#03-05	2,820 sq ft
#03-06	2,820 sq ft
#03-07	2,906 sq ft
#03-08	1,851 sq ft

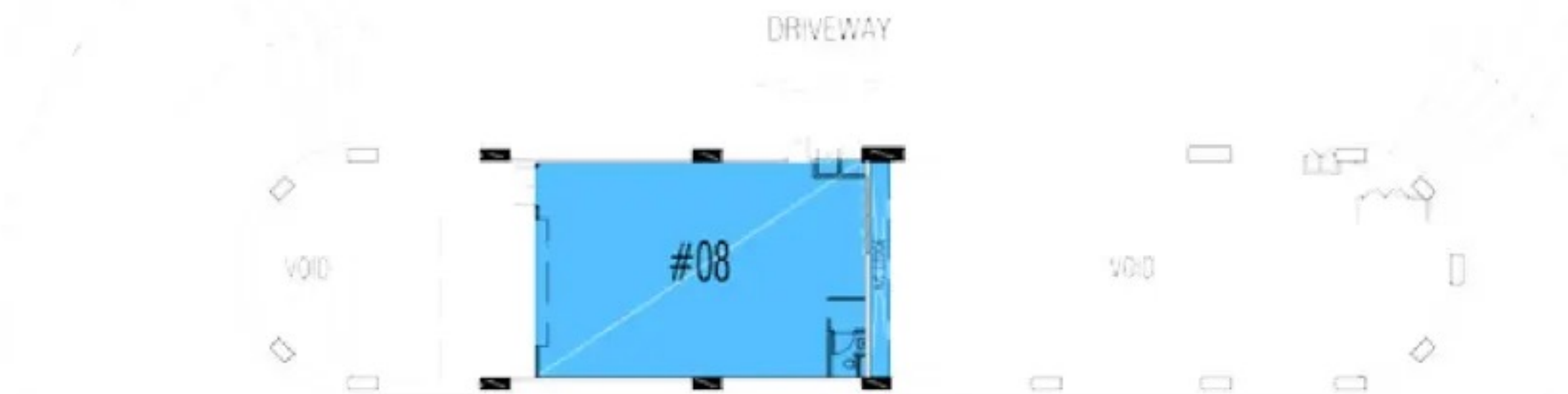
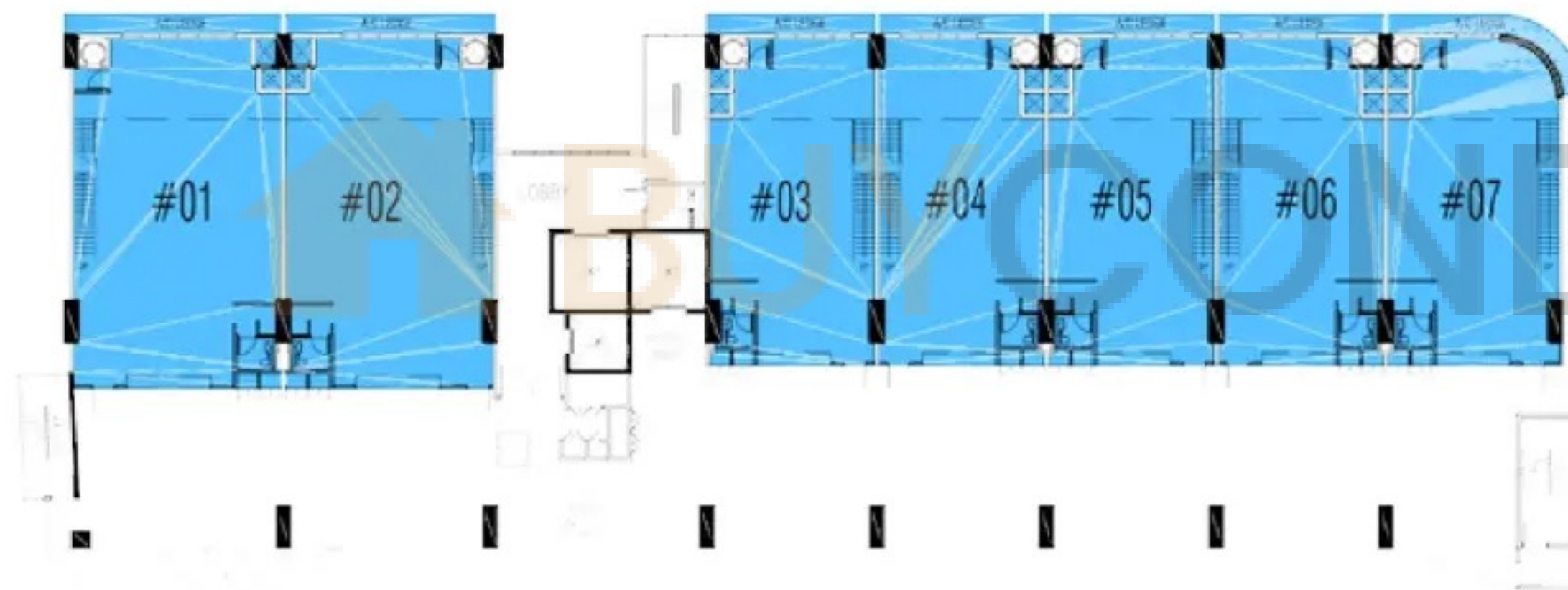

Areas include Ancillary Office, AC Ledge and Void.

4TH STOREY PLAN

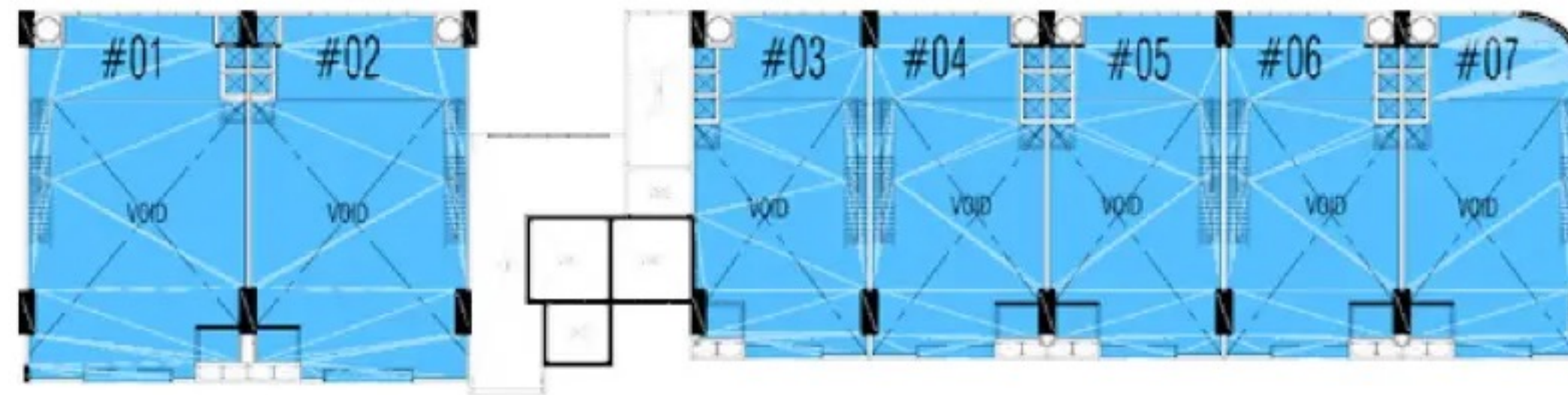

ANCILLARY OFFICE FLOOR PLAN

UNIT	AREA (sq ft)
#04-01	3,670 sq ft
#04-02	3,670 sq ft
#04-03	2,766 sq ft
#04-04	2,766 sq ft
#04-05	2,766 sq ft
#04-06	2,766 sq ft
#04-07	2,852 sq ft
#04-08	1,851 sq ft

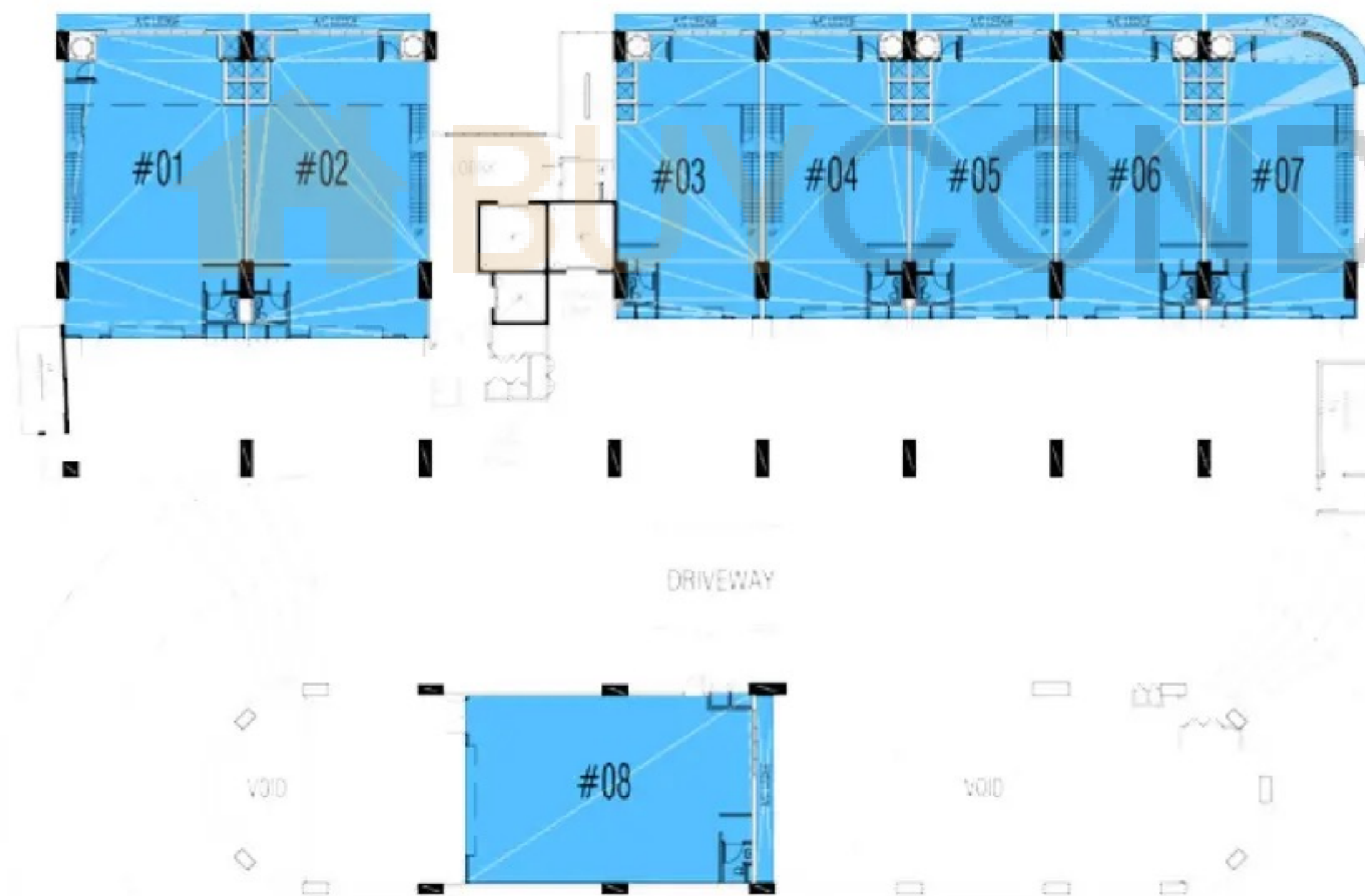

Areas include Ancillary Office, AC Ledge and Void.

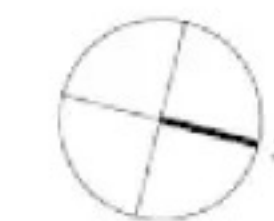

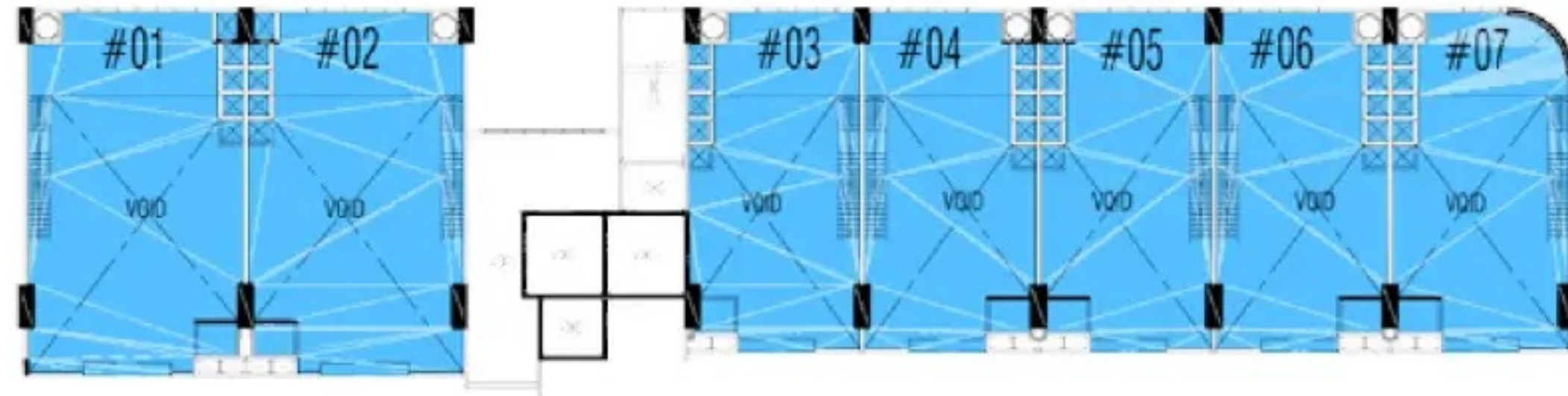

ANCILLARY OFFICE FLOOR PLAN

5TH STOREY PLAN

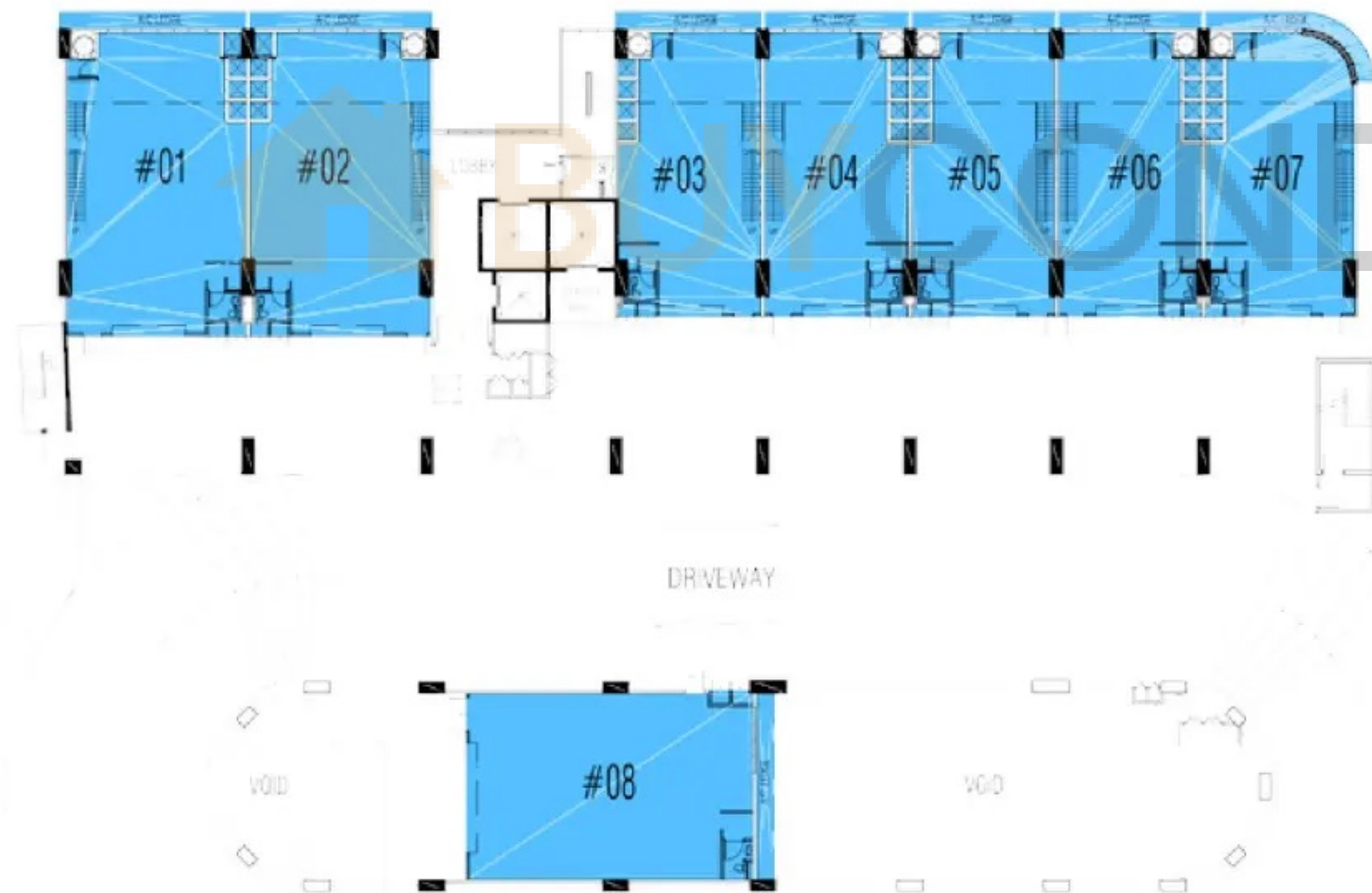

UNIT	AREA (sq ft)
#05-01	3,606 sq ft
#05-02	3,617 sq ft
#05-03	2,713 sq ft
#05-04	2,723 sq ft
#05-05	2,723 sq ft
#05-06	2,723 sq ft
#05-07	2,799 sq ft
#05-08	1,851 sq ft

Areas include Ancillary Office, AC Ledge and Void.



6TH STOREY PLAN

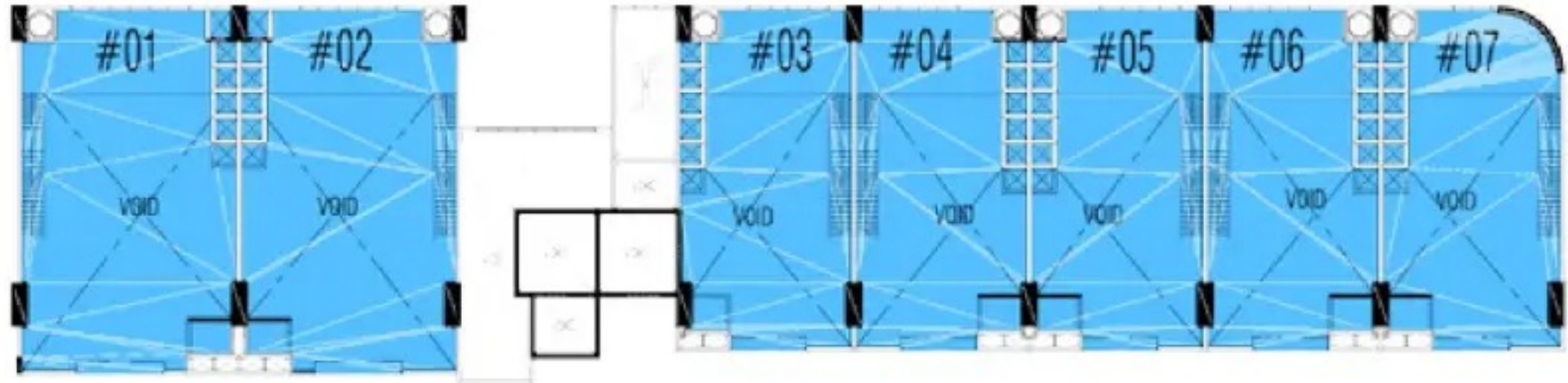

ANCILLARY OFFICE FLOOR PLAN

UNIT	AREA (sq ft)
#06-01	3,563 sq ft
#06-02	3,563 sq ft
#06-03	2,659 sq ft
#06-04	2,669 sq ft
#06-05	2,669 sq ft
#06-06	2,669 sq ft
#06-07	2,756 sq ft
#06-08	1,851 sq ft

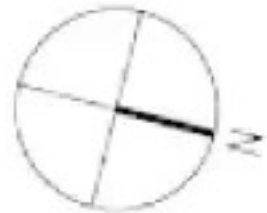
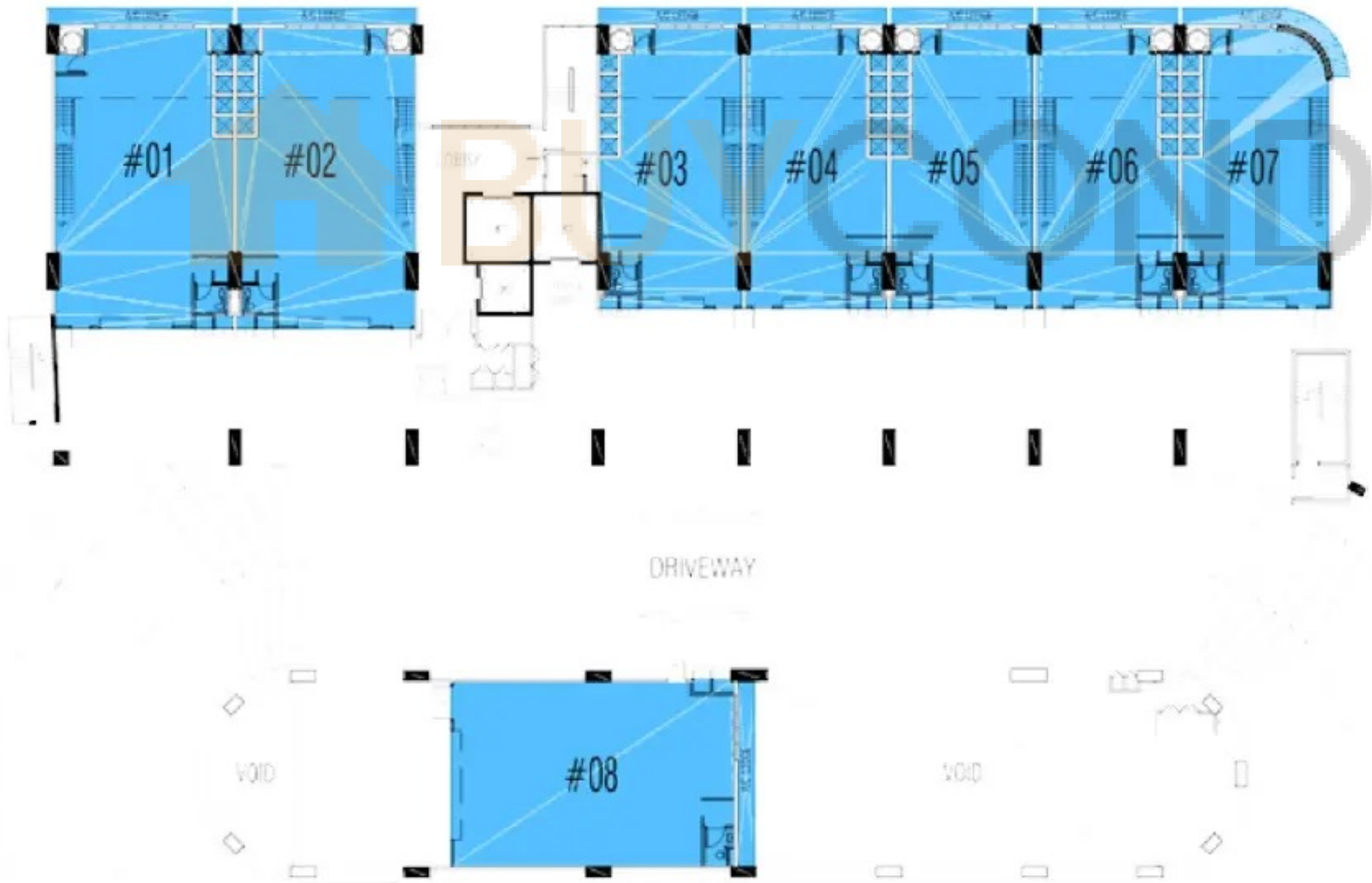

Areas include Ancillary Office, AC Ledge and Void.

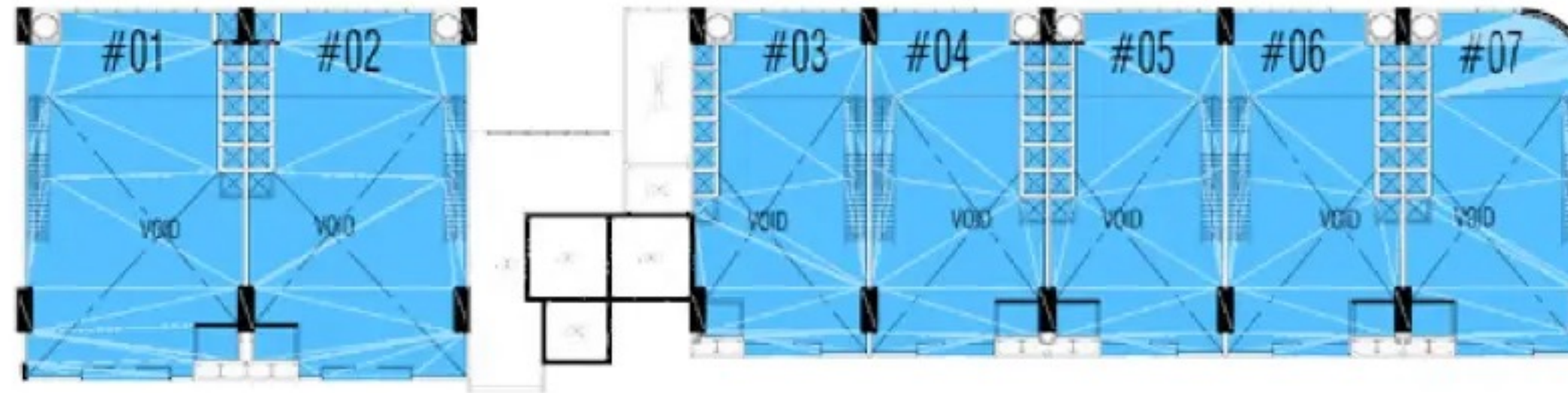

ANCILLARY OFFICE FLOOR PLAN

7TH STOREY PLAN

UNIT	AREA (sq ft)
#07-01	3,520 sq ft
#07-02	3,520 sq ft
#07-03	2,616 sq ft
#07-04	2,626 sq ft
#07-05	2,626 sq ft
#07-06	2,626 sq ft
#07-07	2,702 sq ft
#07-08	1,851 sq ft

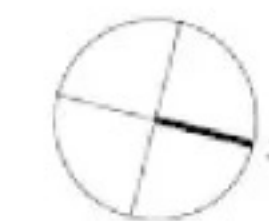
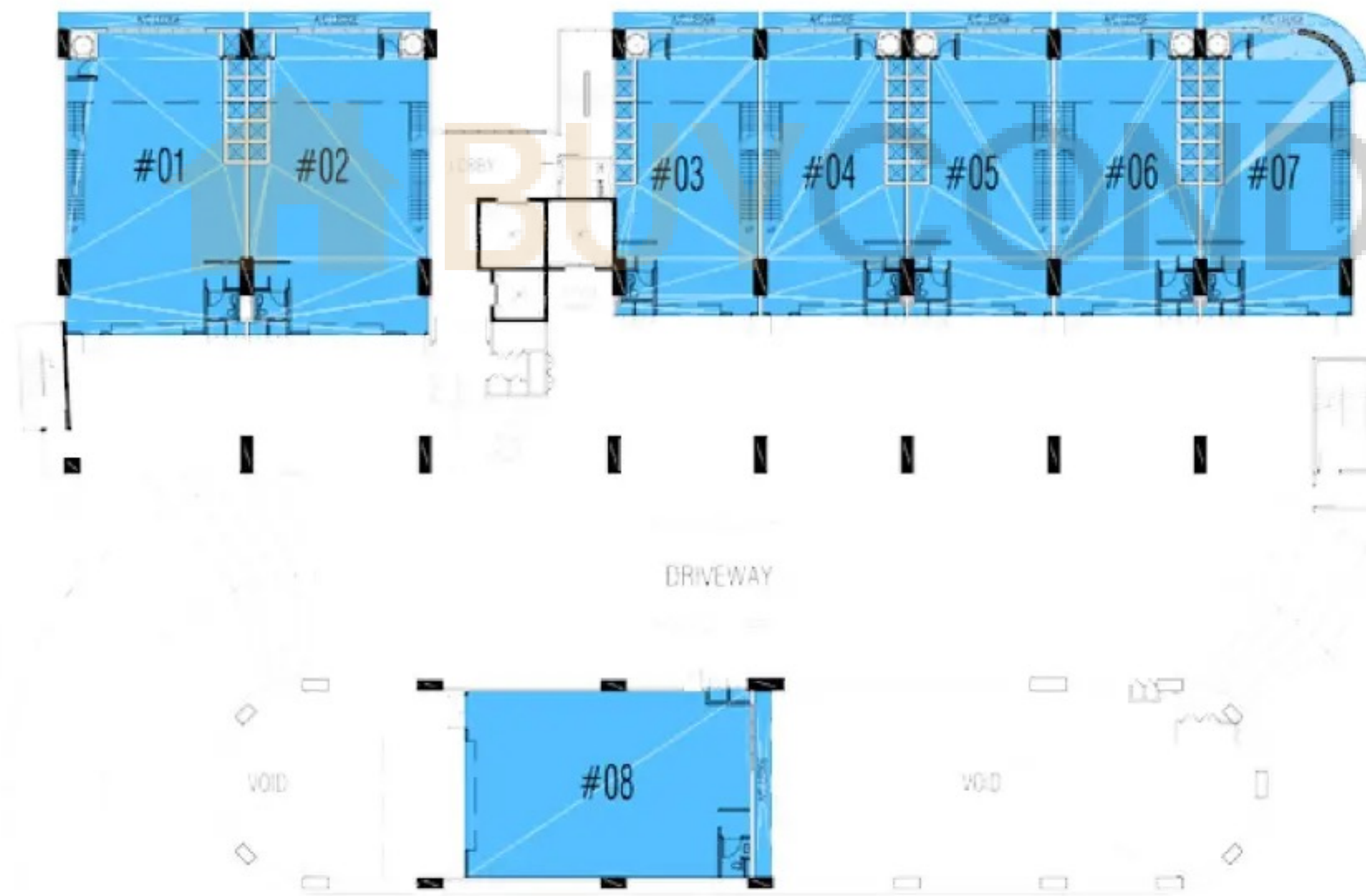

Areas include Ancillary Office, AC Ledge and Void.

8TH STOREY PLAN

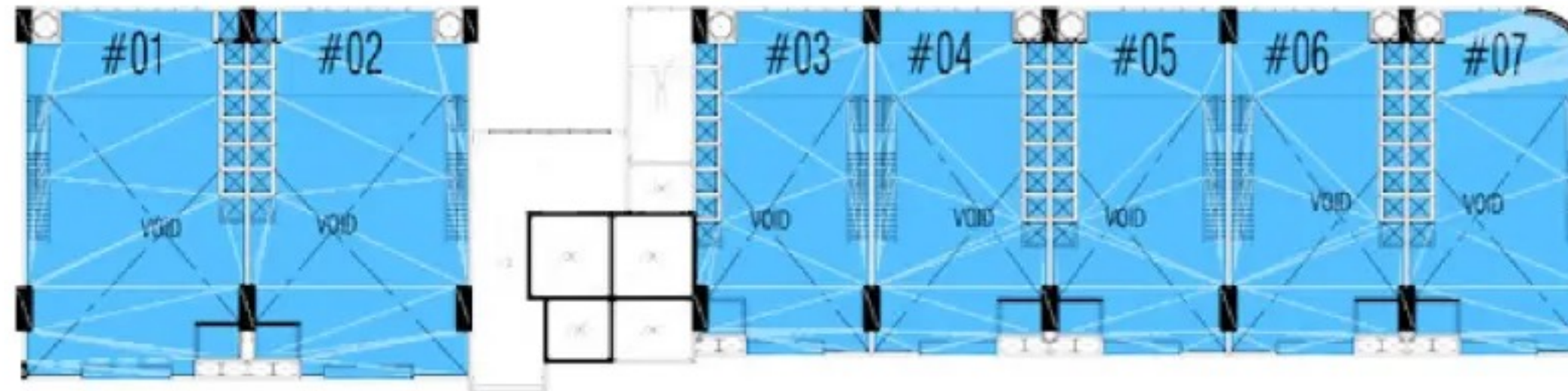

ANCILLARY OFFICE FLOOR PLAN

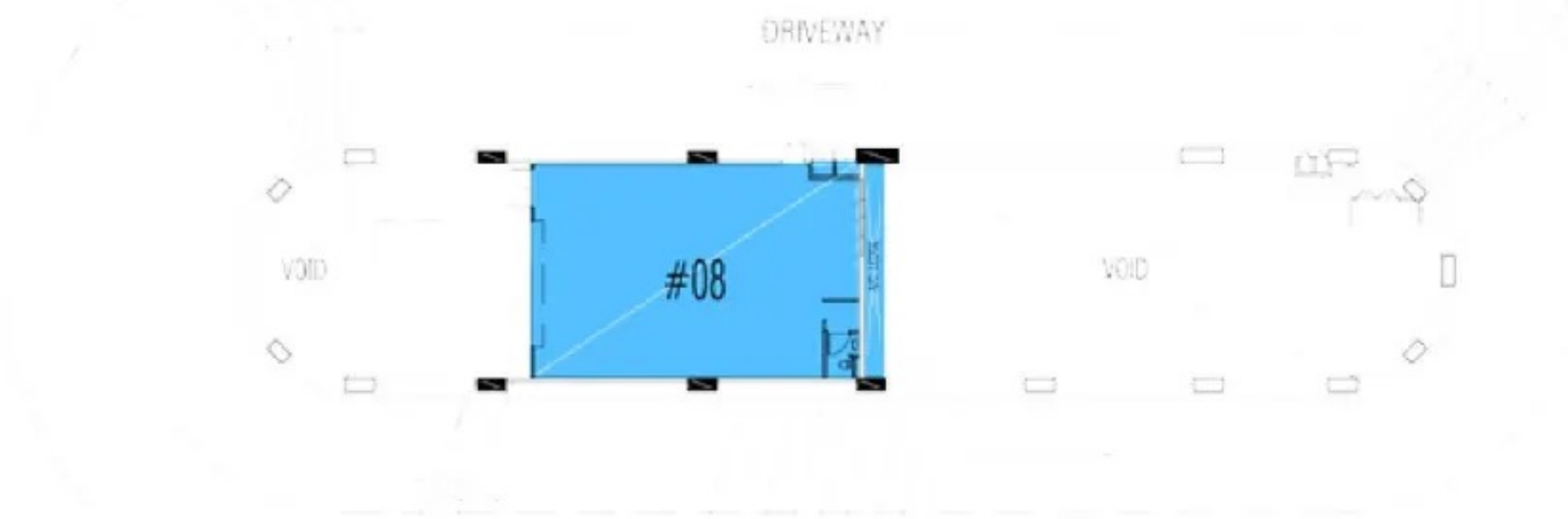
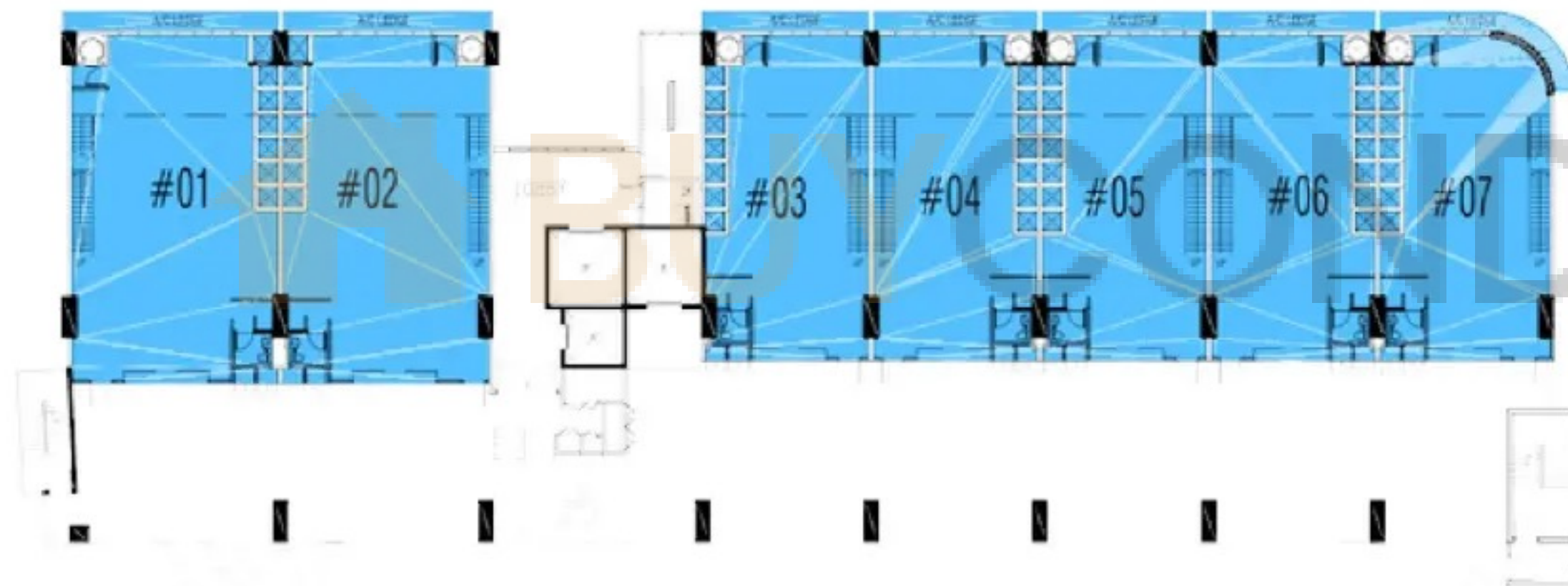

UNIT	AREA (sq ft)
#08-01	3,455 sq ft
#08-02	3,466 sq ft
#08-03	2,562 sq ft
#08-04	2,573 sq ft
#08-05	2,573 sq ft
#08-06	2,573 sq ft
#08-07	2,648 sq ft
#08-08	1,851 sq ft

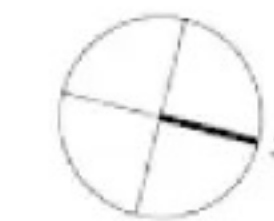

Areas include Ancillary Office, AC Ledge and Void.

9TH STOREY PLAN

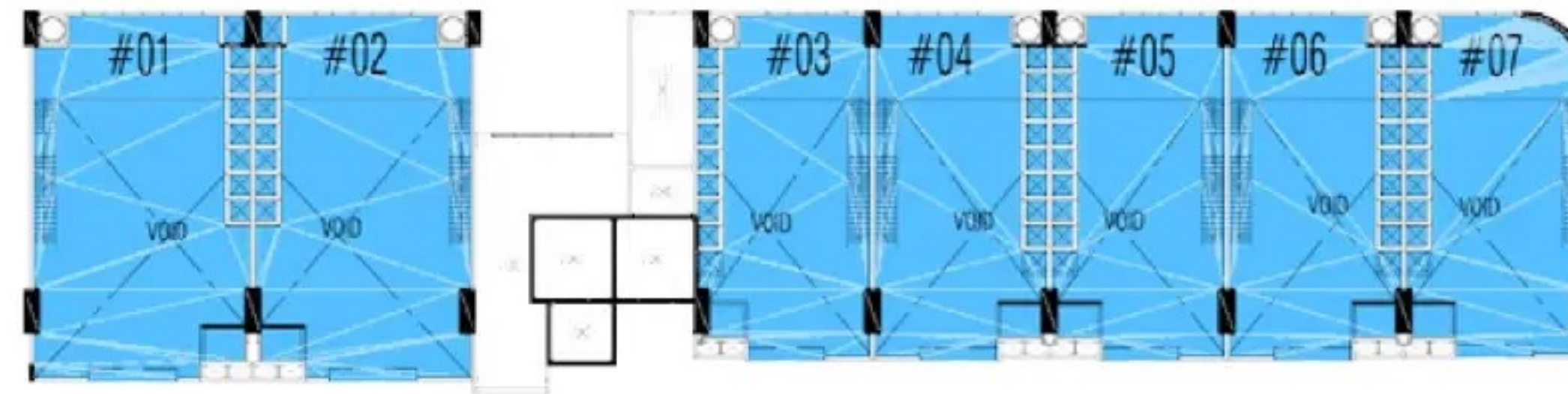

ANCILLARY OFFICE FLOOR PLAN

UNIT	AREA (sq ft)
#09-01	3,423 sq ft
#09-02	3,434 sq ft
#09-03	2,530 sq ft
#09-04	2,540 sq ft
#09-05	2,540 sq ft
#09-06	2,540 sq ft
#09-07	2,605 sq ft
#09-08	1,851 sq ft

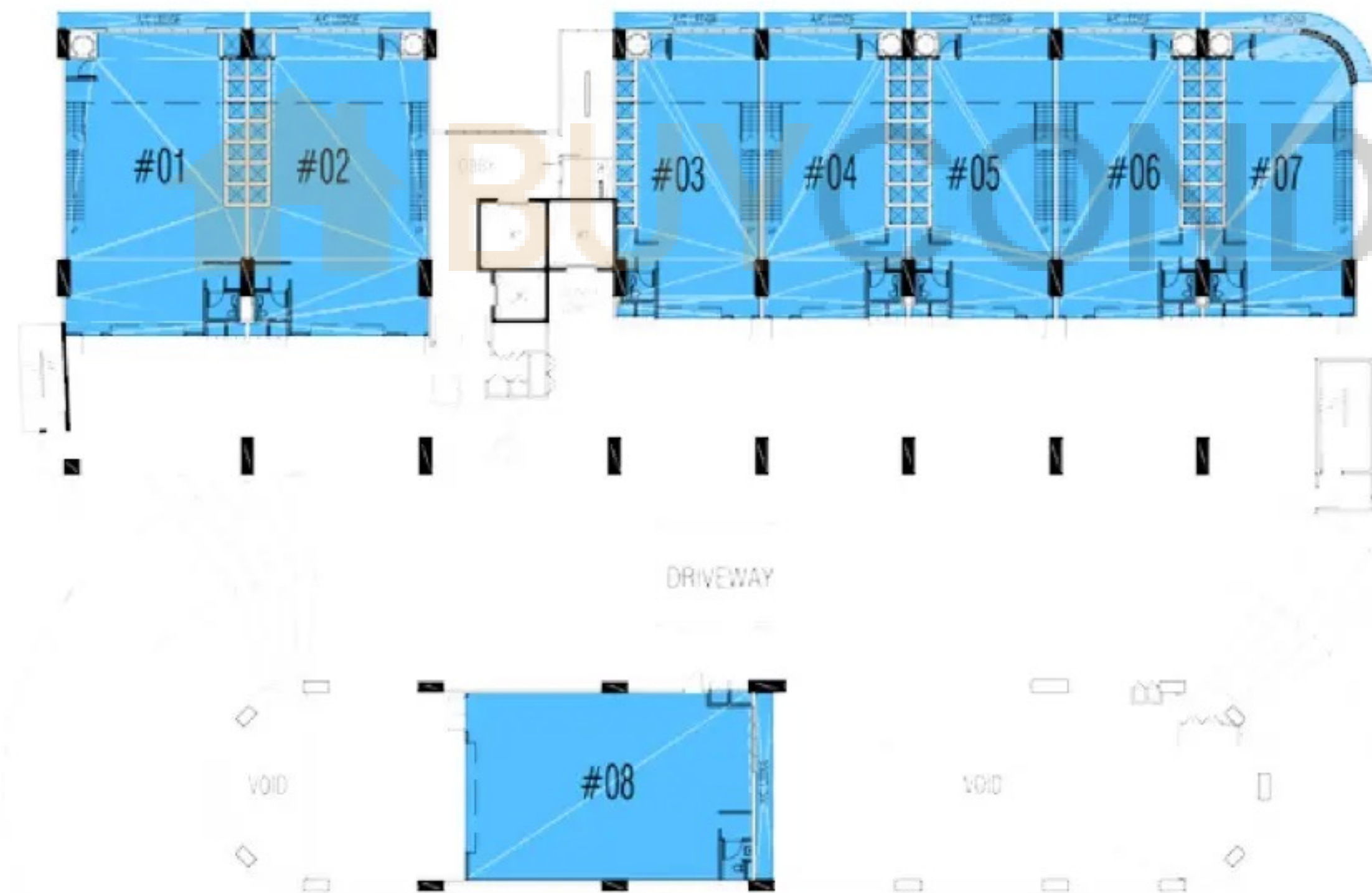

Areas include Ancillary Office, AC Ledge and Void.

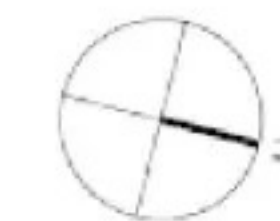

10TH STOREY PLAN

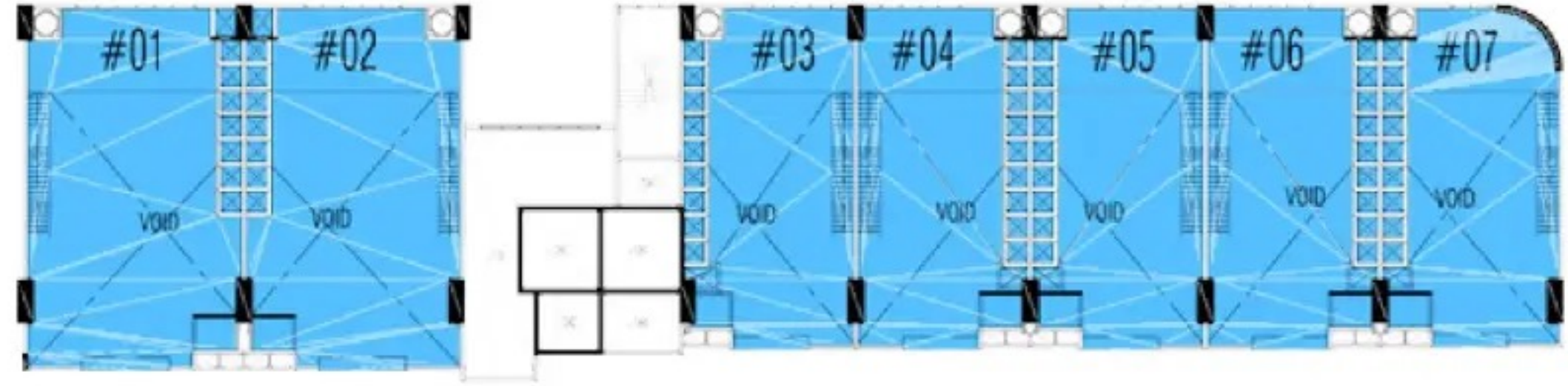

 ANCILLARY OFFICE FLOOR PLAN

UNIT	AREA (sq ft)
#10-01	3,401 sq ft
#10-02	3,412 sq ft
#10-03	2,530 sq ft
#10-04	2,530 sq ft
#10-05	2,530 sq ft
#10-06	2,530 sq ft
#10-07	2,573 sq ft
#10-08	1,851 sq ft

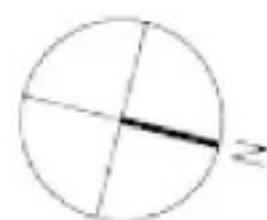
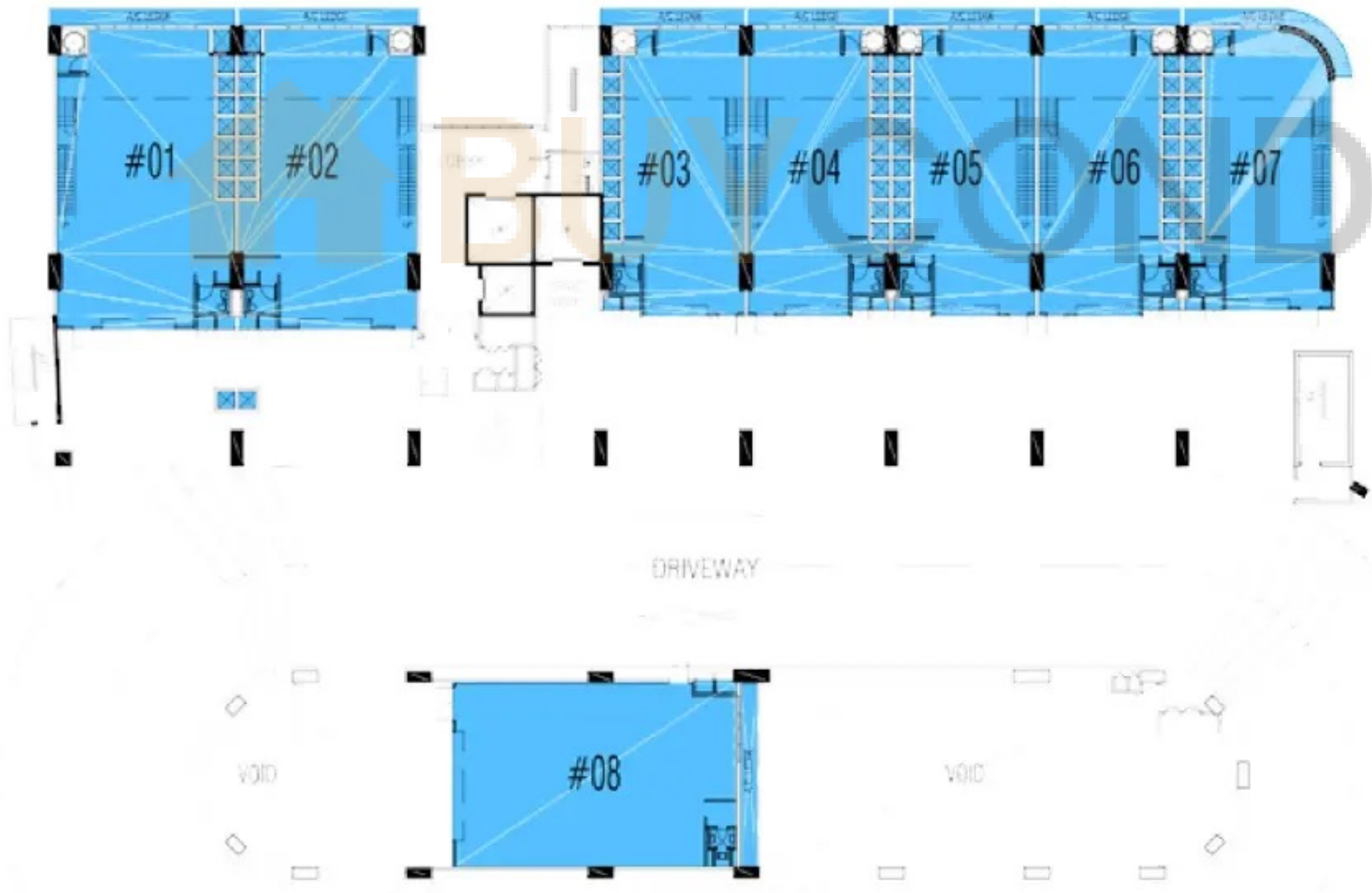

Areas include Ancillary Office, AC Ledge and Void.

11TH STOREY PLAN

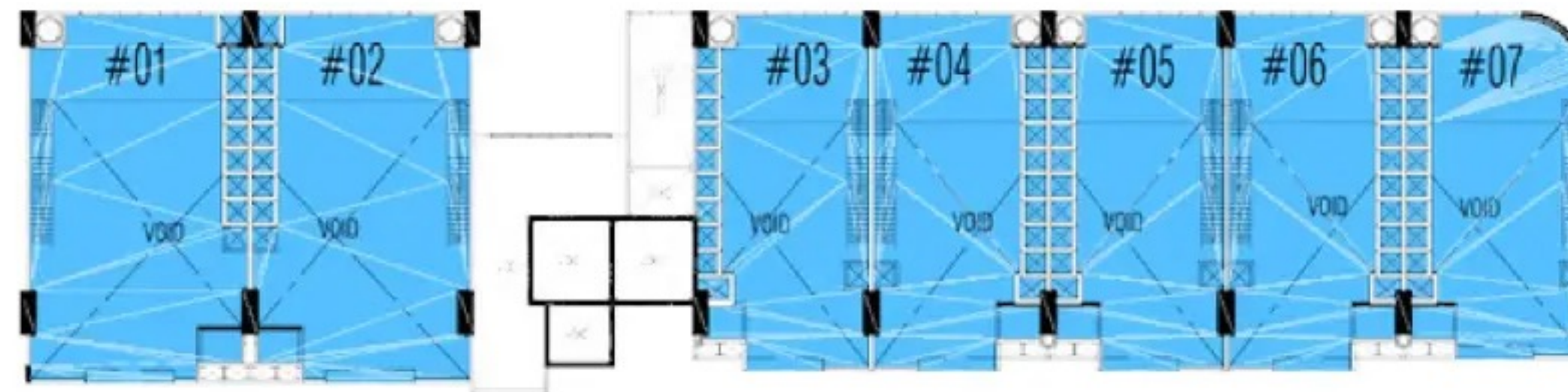

 ANCILLARY OFFICE FLOOR PLAN

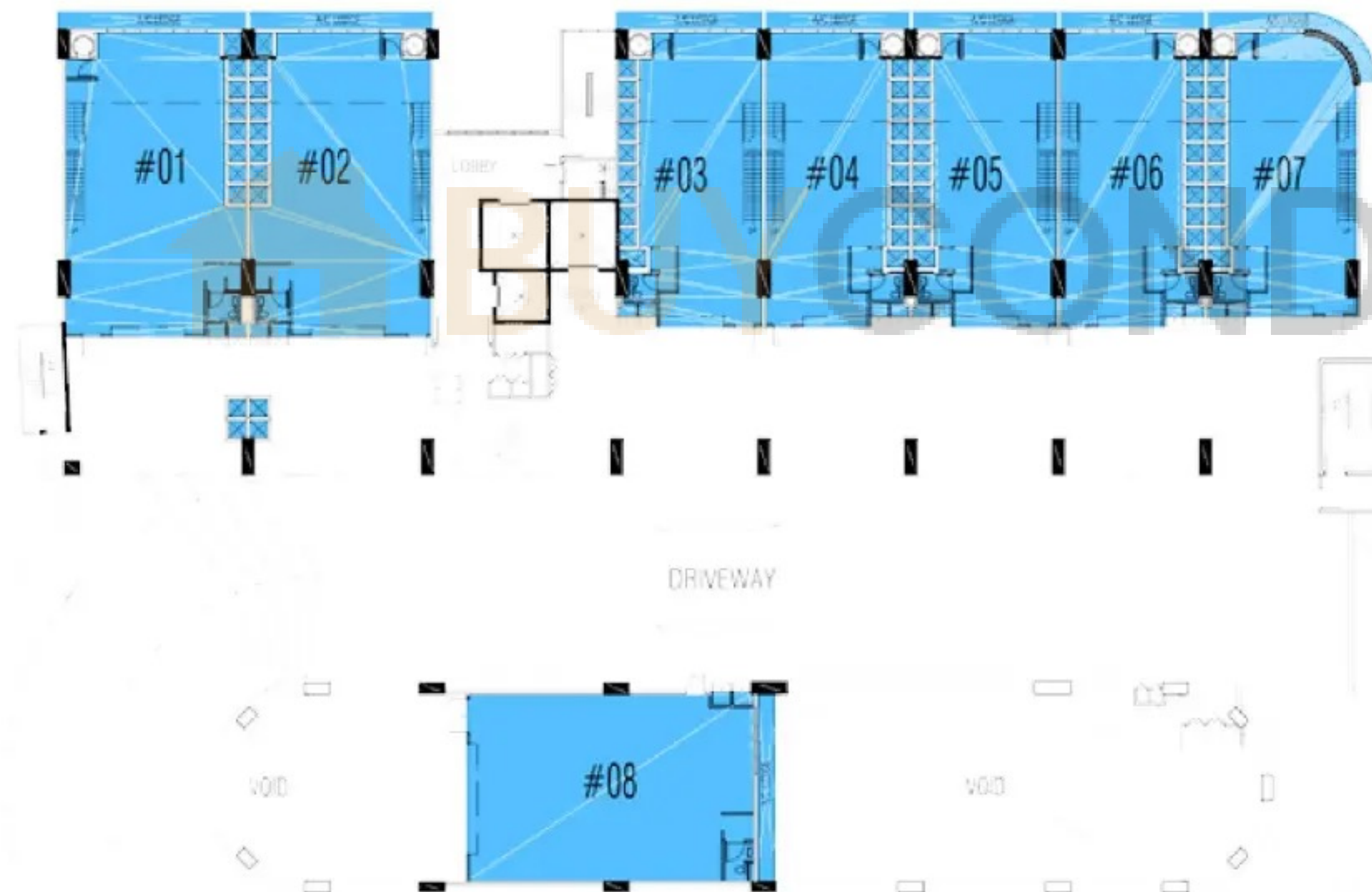

UNIT	AREA (sq ft)
#11-01	3,369 sq ft
#11-02	3,380 sq ft
#11-03	2,465 sq ft
#11-04	2,476 sq ft
#11-05	2,476 sq ft
#11-06	2,476 sq ft
#11-07	2,497 sq ft
#11-08	1,851 sq ft



Areas include Ancillary Office, AC Ledge and Void.