

SUITES: 1-BEDROOM

TYPE A

48 sq.m. / 516 sq.ft.

TOWER I #02-67/71/72/75/76 to #06-67/71/72/75/76

TOWER J #02-57/61/62/65/66 to #06-57/61/62/65/66

TOWER K #02-47/48/51/52/56 to #06-47/48/51/52/56

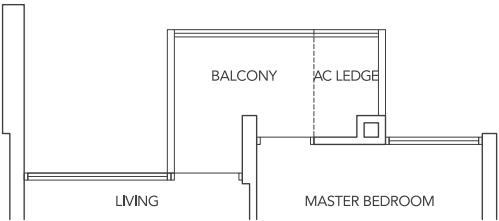

TYPE A1

47 sq.m. / 506 sq.ft.

TOWER I #02-70 to #06-70

TOWER J #02-60 to #06-60

TOWER K #02-53 to #06-53

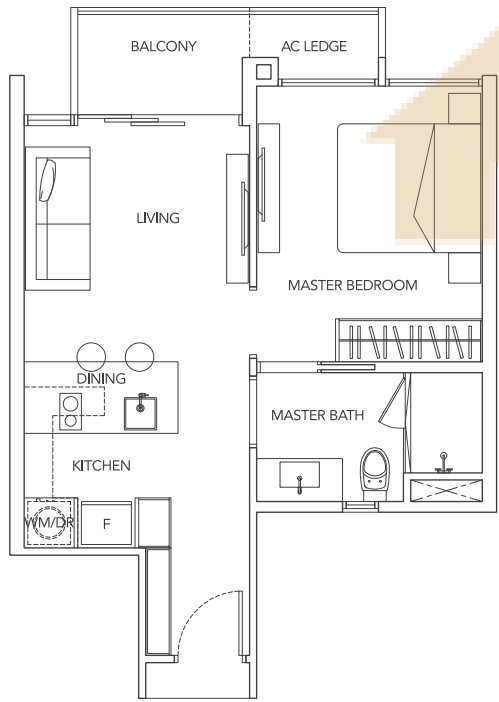

variation to window in units

TOWER I #01-76 to #06-76

TOWER J #01-66 to #06-66

TOWER K #01-47 to #06-47



TYPE AP1

52 sq.m. / 560 sq.ft.

TOWER I #01-71/72

TOWER K #01-51/52

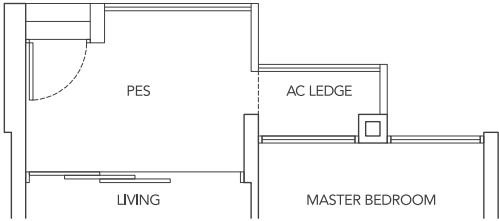
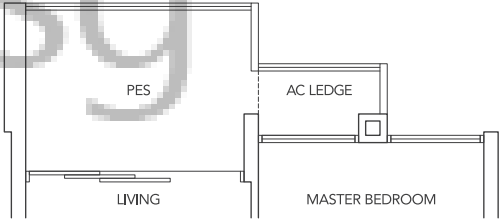
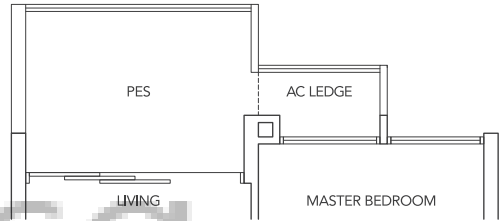
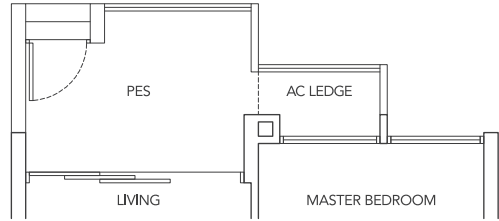

TYPE AP

52 sq.m. / 560 sq.ft.

TOWER I #01-67/75/76

TOWER J #01-57/61/62/65/66

TOWER K #01-47/48/56

TYPE AP2

52 sq.m. / 560 sq.ft.

TOWER I #01-70

TOWER K #01-53

TYPE AP3

52 sq.m. / 560 sq.ft.

TOWER J #01-60

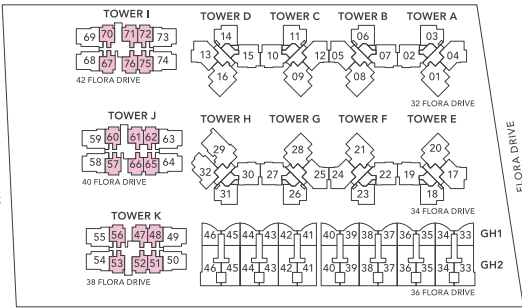

SUITES: 2-BEDROOM

TYPE B1

75 sq.m. / 807 sq.ft.

TOWER I #02-68/69/73/74 to #06-68/69/73/74

TOWER J #02-58/59/63/64 to #06-58/59/63/64

TOWER K #02-49/50/54/55 to #06-49/50/54/55

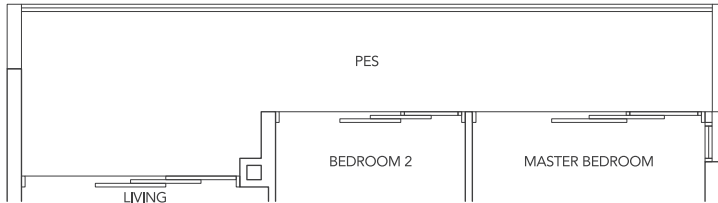

TYPE B1P1  
88 sq.m. / 947 sq.ft.

TOWER I #01-69/73  
TOWER K #01-50/54

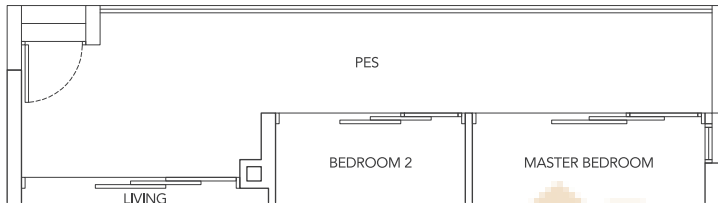

TYPE B1P  
88 sq.m. / 947 sq.ft.

TOWER I #01-68/74  
TOWER J #01-58/59/63/64  
TOWER K #01-49/55

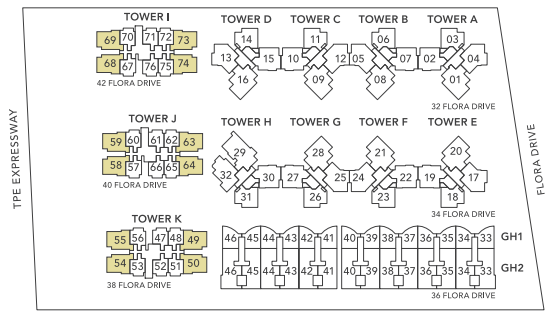
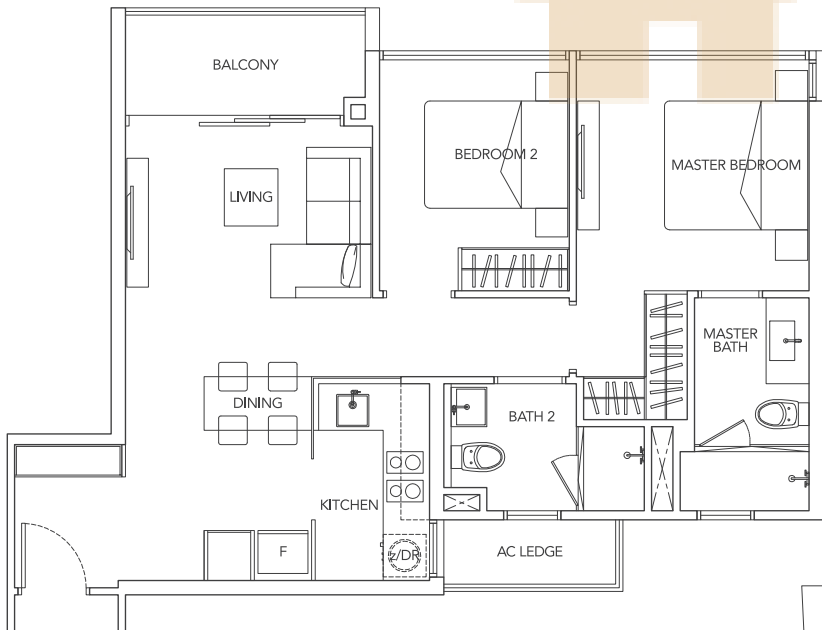

CONDO: 2 BEDROOM

TYPE B2

73 sq.m. / 785 sq.ft.

TOWER A #03-03 to #07-03

TOWER B #02-06 to #07-06

TOWER C #02-11 to #07-11

TOWER D #02-14 to #07-14

TOWER E #02-18 to #07-18

TOWER F #02-23 to #07-23

TOWER G #02-26 to #07-26

TOWER H #02-31 to #07-31

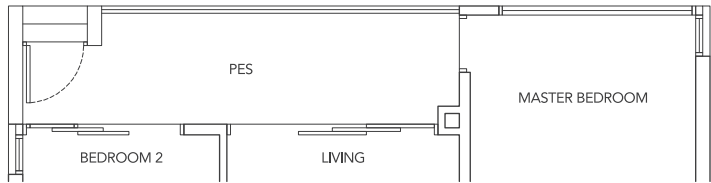

TYPE B2P  
78 sq.m. / 839 sq.ft.

TOWER B #01-06

TOWER C #01-11

TOWER D #01-14

TOWER E #01-18

TOWER F #01-23

TOWER G #01-26

TOWER H #01-31

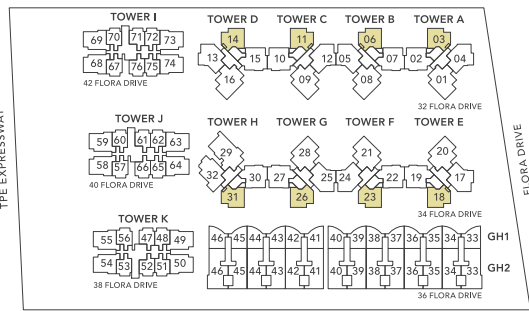
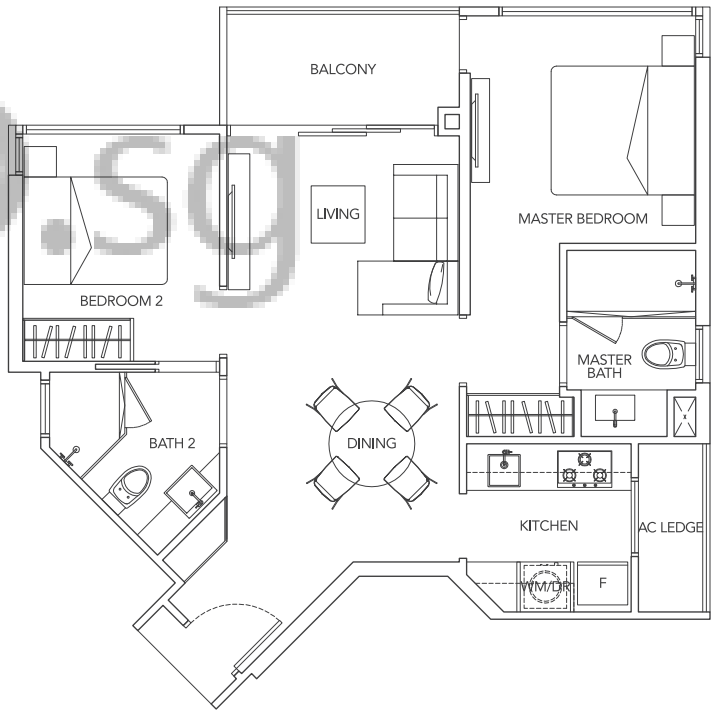

CONDO: 3-BEDROOM COMPACT

# TYPE Cc1

92 sq.m. / 990 sq.ft.

- TOWER A #02-04 to #07-04
- TOWER B #02-05 to #07-05
- TOWER C #02-12 to #07-12
- TOWER D #02-13 to #07-13
- TOWER E #02-17 to #07-17
- TOWER F #02-24 to #07-24
- TOWER G #02-25 to #07-25

## TYPE Cc1P

106 sq.m. / 1141 sq.ft.

- TOWER B #01-05
- TOWER C #01-12
- TOWER D #01-13
- TOWER E #01-17
- TOWER F #01-24
- TOWER G #01-25

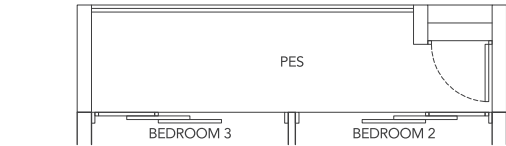
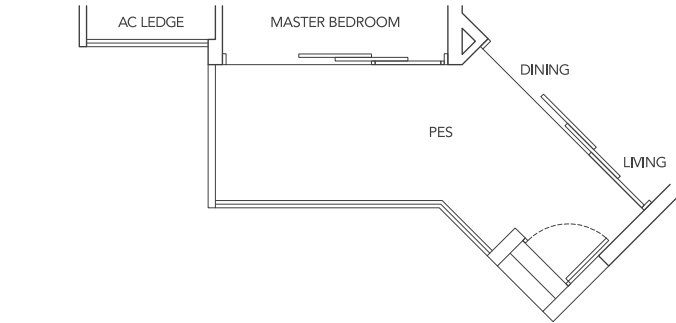

## TYPE Cc1P

106 sq.m. / 1141 sq.ft.

- TOWER B #01-05
- TOWER C #01-12
- TOWER D #01-13
- TOWER E #01-17
- TOWER F #01-24
- TOWER G #01-25

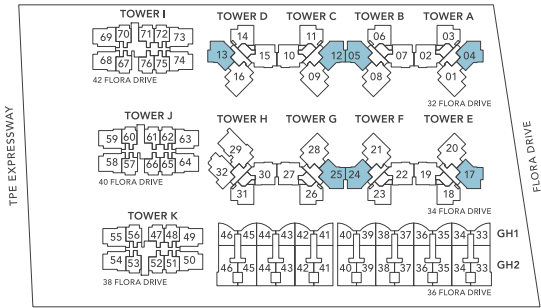
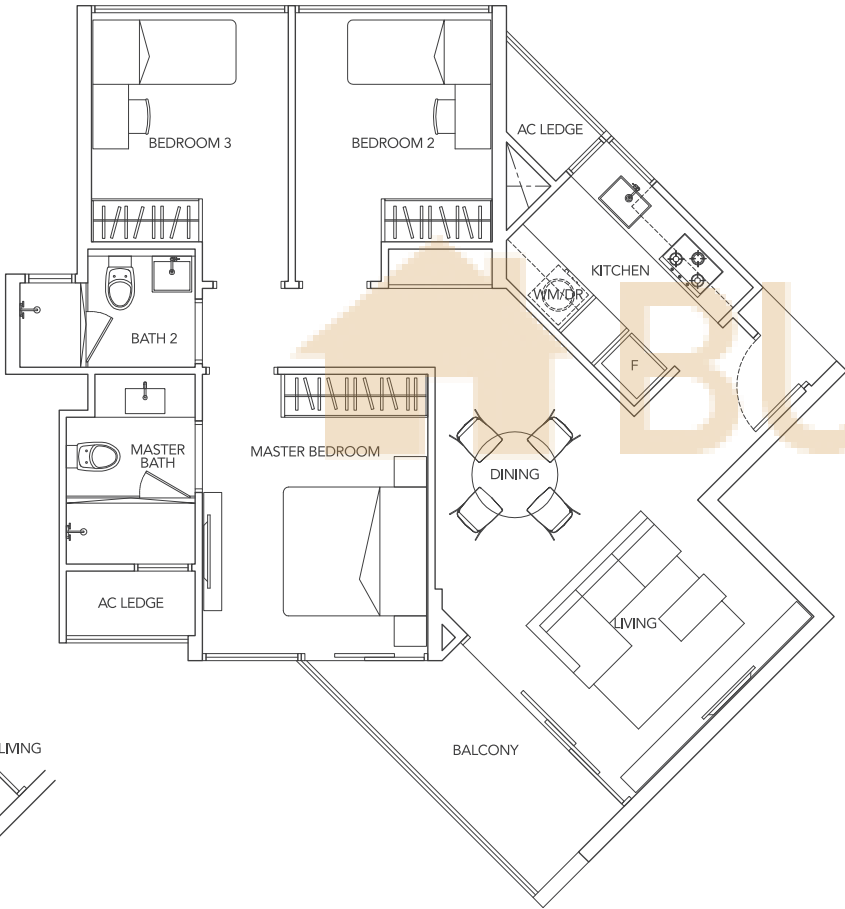

Plans are subject to change as may be approved by the relevant authorities.

CONDO: 3-BEDROOM COMPACT

# TYPE Cc2

92 sq.m. / 990 sq.ft.

- TOWER A #02-02 to #07-02
- TOWER B #02-07 to #07-07
- TOWER C #02-10 to #07-10
- TOWER D #02-15 to #07-15
- TOWER E #02-19 to #07-19
- TOWER F #02-22 to #07-22
- TOWER G #02-27 to #07-27
- TOWER H #02-30 to #07-30

## TYPE Cc2P

110 sq.m. / 1184 sq.ft.

- TOWER A #01-02
- TOWER B #01-07
- TOWER C #01-10
- TOWER D #01-15
- TOWER E #01-19
- TOWER F #01-22
- TOWER G #01-27
- TOWER H #01-30

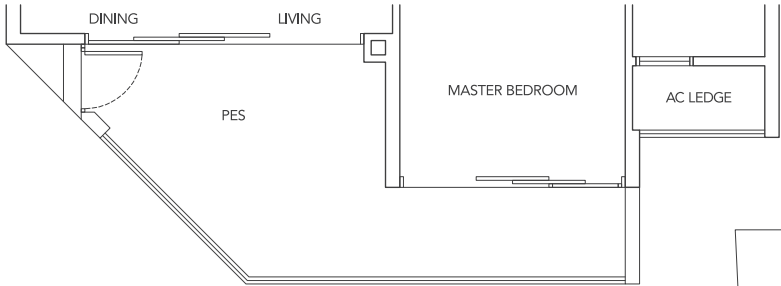

## TYPE Cc2P

110 sq.m. / 1184 sq.ft.

- TOWER A #01-02
- TOWER B #01-07
- TOWER C #01-10
- TOWER D #01-15
- TOWER E #01-19
- TOWER F #01-22
- TOWER G #01-27
- TOWER H #01-30

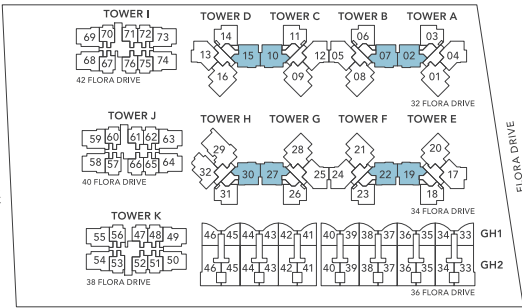

Plans are subject to change as may be approved by the relevant authorities.

CONDO: 3-BEDROOM COMPACT

# TYPE Cc3

92 sq.m. / 990 sq.ft.

TOWER H #02-32 to #07-32

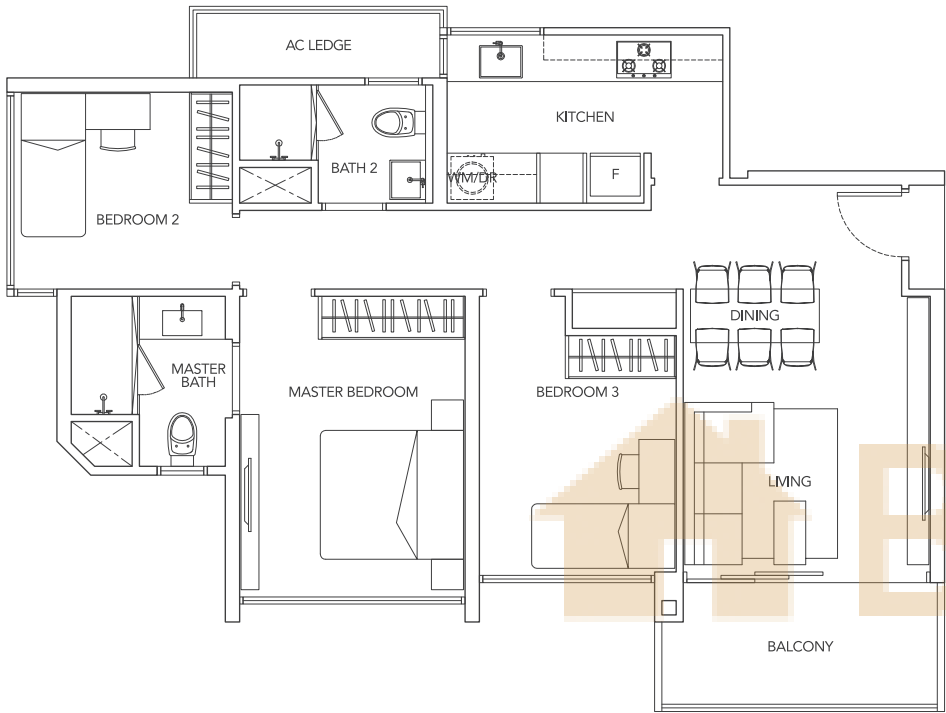

## TYPE Cc3P

104 sq.m. / 1119 sq.ft.

TOWER H #01-32

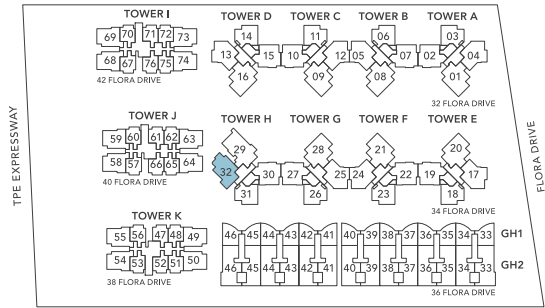
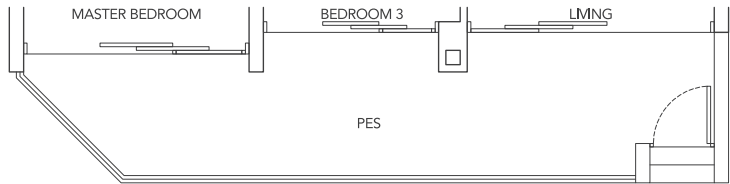

Plans are subject to change as may be approved by the relevant authorities.

CONDO: 3-BEDROOM

# TYPE C

104 sq.m. / 1119 sq.ft.

TOWER A #02-01 to #07-01

TOWER B #02-08 to #07-08

TOWER C #02-09 to #07-09

TOWER E #02-20 to #07-20

TOWER F #02-21 to #07-21

TOWER G #02-28 to #07-28

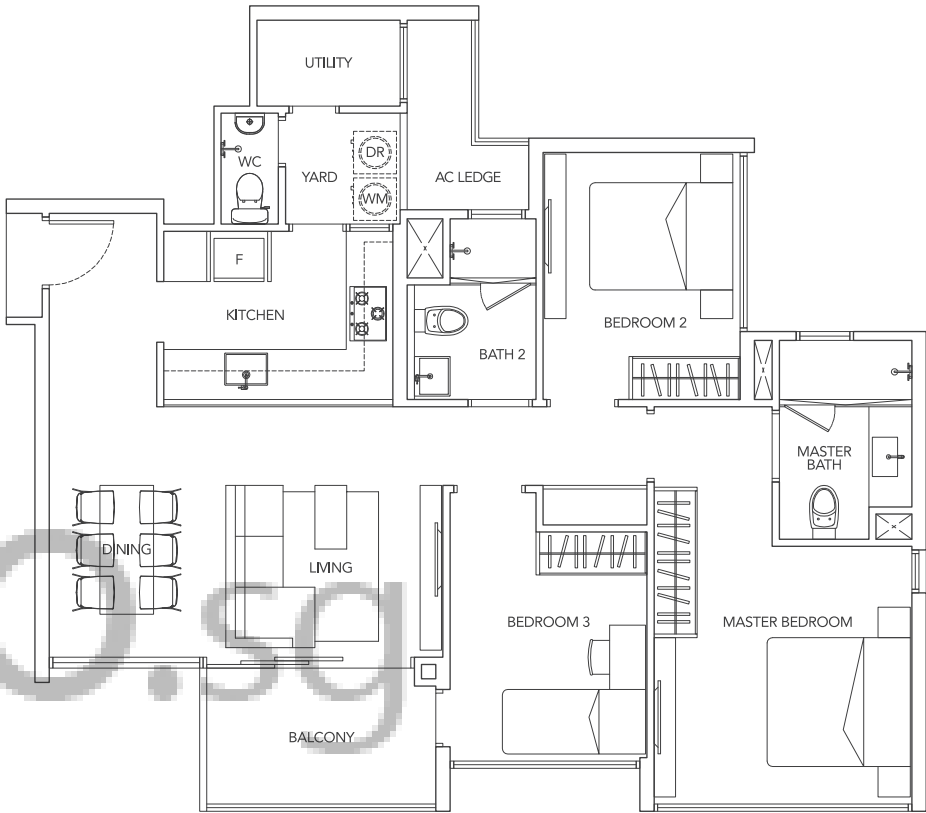

## TYPE CP

123 sq.m. / 1323 sq.ft.

TOWER A #01-01

TOWER B #01-08

TOWER C #01-09

TOWER E #01-20

TOWER F #01-21

TOWER G #01-28

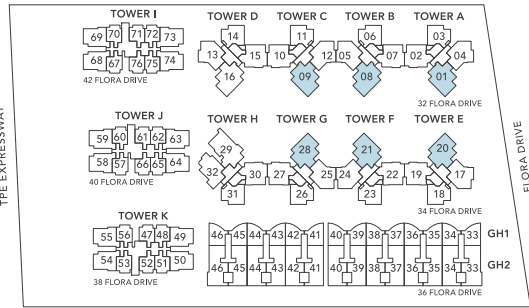
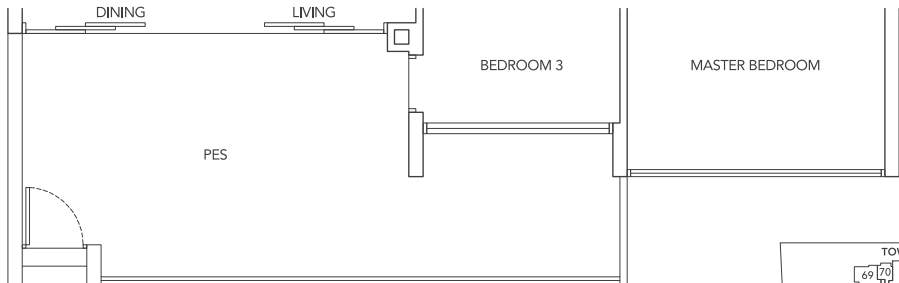

Plans are subject to change as may be approved by the relevant authorities.

TYPE D

123 sq.m. / 1323 sq.ft.

TOWER D #02-16 to #07-16  
TOWER H #02-29 to #07-29

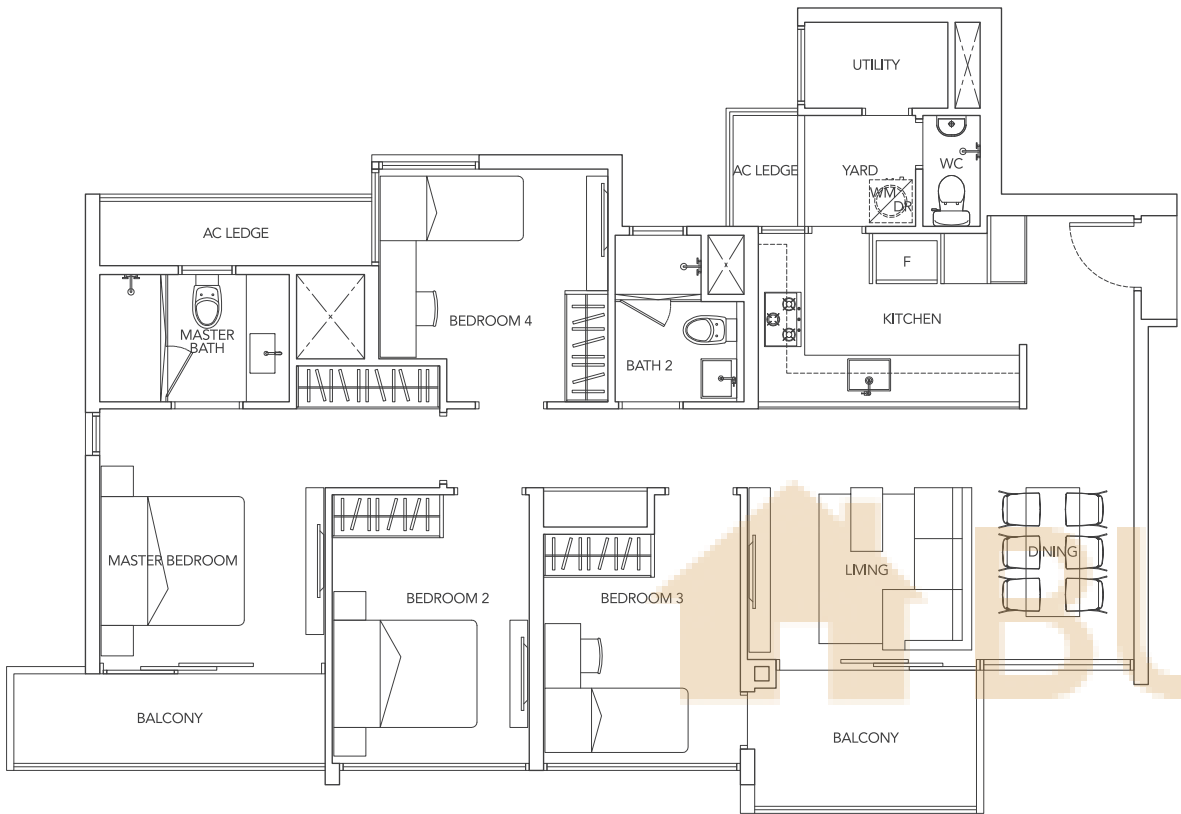

TYPE DP

140 sq.m. / 1506 sq.ft.

TOWER D #01-16  
TOWER H #01-29

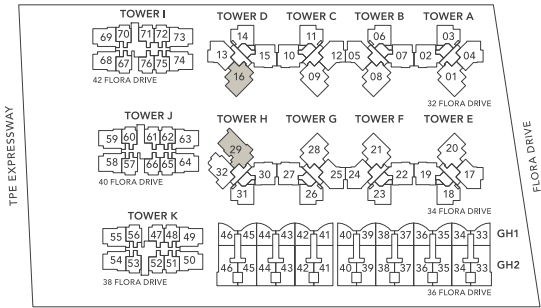
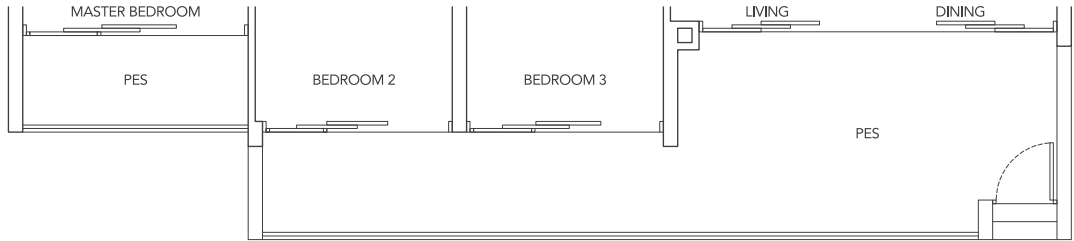

SPECIFICATIONS

1. FOUNDATION

Piled foundation.

2. SUPERSTRUCTURE

Cast in-situ and/or precast reinforced concrete structure.

3. WALLS

- a. External Walls  
In-situ RC and/or masonry wall.
- b. Internal Walls  
Masonry and/or lightweight concrete panels and/or in-situ RC wall and/or drywall partition system.

4. FLAT ROOF

Flat Roof  
Reinforced concrete slab with appropriate insulation and waterproofing system.

5. CEILING

(i) Residential Units

- a. Foyer, Living/Dining/Family, Bedrooms, Store, Yard, Utility, Open Balcony/Balcony, Private Enclosed Space (PES) and Private Carpark  
Cement and sand plaster and/or skim coat and/or plaster ceiling boards and/or bulkhead to designated areas with paint finish.
- b. Corridor leading to Bedrooms, all Bathrooms, WC, all Kitchens and Yard  
Plaster ceiling board with paint finish.
- c. Household Shelter (HS), Staircase and Landing (Garden Homes)  
Skim coat and/or plaster ceiling board with paint finish.

(ii) Common Areas

- a. Lift Lobbies, Gymnasium, Function Room, all Toilets and Changing Rooms  
Skim coat and/or plaster ceiling boards and/or box-ups to designated areas with paint finish.
- b. Carpark areas, Staircases and Storey Shelters  
Skim coat with paint finish.

6. FINISHES – WALL

(i) Residential Units – Garden Homes

- a. Foyer, Living/Dining/Family, Bedrooms, Corridor leading to Bedrooms, Staircase and Landing, Store, Yard, Household Shelter (HS), Open Balcony/Balcony, Private Enclosed Space (PES), Roof Terrace and Private Carpark  
Cement and sand plaster and/or skim coat with paint finish (up to false ceiling and at exposed surfaces only).
- b. All Kitchens  
Ceramic tiles and/or cement and sand plaster with paint finish (up to false ceiling and at exposed surfaces only).
- c. Master Bath  
Marble tiles (up to false ceiling and at exposed surfaces only).
- d. Other Bathrooms  
Marble and/or porcelain and/or homogeneous tiles (up to false ceiling and at exposed surfaces only).
- e. WC  
Porcelain and/or homogeneous and/or ceramic tiles (up to false ceiling and at exposed surfaces only).

(ii) Residential Units – Condominium and Suites

- a. Living/Dining, Bedrooms, Corridor leading to Bedrooms, Yard, Utility, Balcony and Private Enclosed Space (PES)  
Cement and sand plaster and/or skim coat with paint finish (up to false ceiling and at exposed surfaces only).
- b. All Kitchens  
Ceramic tiles and/or cement and sand plaster with paint finish (up to false ceiling and at exposed surfaces only).
- c. Master Bath  
Marble and/or porcelain and/or homogeneous tiles (up to false ceiling and at exposed surfaces only).
- d. Other Bathrooms and WC  
Porcelain and/or homogeneous and/or ceramic tiles (up to false ceiling and at exposed surfaces only).

(iii) Common Areas – Internal Wall Finishes

- a. Basement and 1st Storey Lift Lobbies  
Marble and/or granite and/or porcelain and/or homogeneous tiles and/or cement and plaster and/or skim coat with paint finish (up to false ceiling and at exposed surfaces only).
- b. Typical Lift Lobbies, Gymnasium, Function Room, all Toilets and Changing Rooms  
Porcelain and/or homogeneous tiles and/or cement and plaster and/or skim coat with paint finish (up to false ceiling and at exposed surfaces only).
- c. Carpark areas, Staircases and Storey Shelters  
Cement and plaster and/or skim coat with paint finish.

(iv) Common Areas – External Wall Finishes

- a. All external walls including Open Balcony/Balcony, Private Enclosed Space (PES) and Roof Terrace  
Cement and plaster and/or skim coat with spray textured coating and/or paint finish.

Note: No tiles behind/below kitchen cabinets, bathroom cabinets, mirrors and above false ceiling. Wall surface above the false ceiling level will be left in its original condition.

FINISHES – FLOOR

(i) Residential Units – Garden Homes

- a. Foyer, Living/Dining/Family and Corridor leading to Bedrooms  
Marble tiles with timber skirting (except for Family Room in Garden Home Type GH2 – shall be timber flooring with timber skirting).
- b. Bedrooms  
Timber flooring with timber skirting.
- c. All Kitchens, Store, Yard, Household Shelter (HS), Open Balcony/Balcony, Private Enclosed Space (PES) and Roof Terrace  
Porcelain and/or homogeneous tiles (except for Dry Kitchen in Garden Home Type GH1 – shall be marble tiles).
- d. Master Bath  
Marble tiles.
- e. Other Bathrooms and WC  
Porcelain and/or homogeneous tiles.
- f. Staircase and Landing  
Timber flooring (except for Garden Home Type GH1 from Basement to 1st Storey – shall be marble tiles with timber skirting).
- g. Private Carpark  
Homogeneous tiles.

(ii) Residential Units – Condominium and Suites

- a. Living/Dining and Corridor leading to Bedrooms  
Marble tiles with timber skirting (except for Suites – shall be porcelain and/or homogeneous tiles).
- b. Bedrooms  
Timber flooring with timber skirting.
- c. All Kitchens, all Bathrooms, WC, Yard, Utility, Balcony, Private Enclosed Space (PES) and Roof Terrace  
Porcelain and/or homogeneous tiles.