

# SITEPLAN

- 1 Aegean Arrival
- 2 Lap Pool
- 3 Kid's Pool
- 4 Lounge Deck
- 5 Aegean Splashes
- 6 Changing Rooms
- 7 Clubhouse Gymnasium
- 8 Drift-Away Hammocks
- 9 Grand Lawn
- 10 25m Lap Pool & Aqua Gym
- 11 Reflective Pool
- 12 The Gallery
- 13 Tennis Court
- 14 Alfresco BBQ Plaza
- 15 Kiddie Playground
- 16 Fitness Zone
- 17 Sunken Pavilion
- 18 Verdure Berms

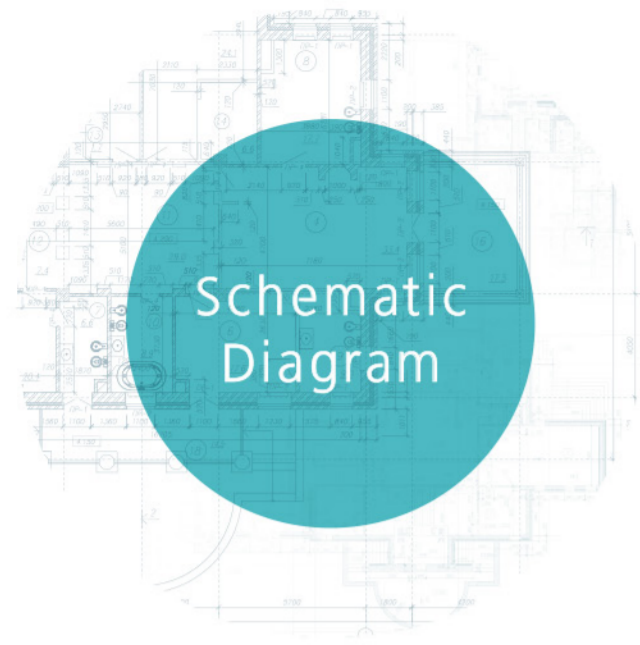



Schematic Diagram

21 TAMPINES STREET 86

UNIT FLOOR	06	05	04	03	02	01
15	A2b	A3	A2b	A2b	A3	Communal Roof Garden
14	A2	A3b	A2	A2	A3b	B1
13	A2b	A3	A2b	A2b	A3	B1b
12	A2a	A3b	A2a	A2a	A3b	B1a
11	A2	A3a	A2	A2	A3a	B1
10	A2b	A3	A2b	A2b	A3	B1b
9	A2a	A3b	A2a	A2a	A3b	B1a
8	A2	A3a	A2	A2	A3a	B1
7	A2b	A3	A2b	A2b	A3	B1b
6	A2a	A3b	A2a	A2a	A3b	B1a
5	A2	A3a	A2	A2	A3a	B1
4	A2b	A3	A2b	A2b	A3	B1b
3	A2a	A3b	A2a	A2a	A3b	B1a
2	A2	A3a	A2	A2	A3a	B1
1	A2(Pa)	A3(Pa)	A2(Pa)	A2(Pa)	A3(Pa)	B1(Pa)

23 TAMPINES STREET 86

UNIT FLOOR	17	16	15	14
15	Communal Roof Garden	PH6 (#15-16)	B5b-DK	
14	C3c	C3c	B5b-DK	C5-DK
13	C3c	C3	B5-DK	C5c-DK
12	C3b	C3c	B5b-DK	C5b-DK
11	C3	C3a	B5a-DK	C5-DK
10	C3c	C3	B5-DK	C5c-DK
9	C3b	C3c	B5b-DK	C5b-DK
8	C3	C3a	B5a-DK	C5-DK
7	C3c	C3	B5-DK	C5c-DK
6	C3b	C3c	B5b-DK	C5b-DK
5	C3	C3a	B5a-DK	C5-DK
4	C3c	C3	B5-DK	C5c-DK
3	C3b	C3c	B5b-DK	C5b-DK
2	C3	C3a	B5a-DK	C5-DK
1	C3(P)	C3(P)	B5-DK(P)	GD1-DK

27 TAMPINES STREET 86

UNIT FLOOR	23	22	25	24
15	PH3 (#15-23)	Communal Roof Garden	PH2 (#15-24)	
14	C5c-DK	C5c-DK	C3c	C1b
13	C5c-DK	C5-DK	C3c	C1
12	C5b-DK	C5c-DK	C3a	C1b
11	C5-DK	C5a-DK	C3	C1a
10	C5c-DK	C5-DK	C3c	C1
9	C5b-DK	C5c-DK	C3a	C1b
8	C5-DK	C5a-DK	C3	C1a
7	C5c-DK	C5-DK	C3c	C1
6	C5b-DK	C5c-DK	C3a	C1b
5	C5-DK	C5a-DK	C3	C1a
4	C5c-DK	C5-DK	C3c	C1
3	C5b-DK	C5c-DK	C3a	C1b
2	C5-DK	C5a-DK	C3	C1a
1	GD1-DK	GD1-DK	C3(Pa)	C1(Pa)

21 TAMPINES STREET 86

UNIT FLOOR	13	12	11	10	09	08	07
15	B1b	A1	A1	A2	A2b	A4	A2
14	B1	A1	A1	A2b	A2	A4b	A2b
13	B1b	A1	A1	A2	A2b	A4	A2
12	B1a	A1	A1	A2b	A2a	A4b	A2b
11	B1	A1	A1	A2a	A2	A4a	A2a
10	B1b	A1	A1	A2	A2b	A4	A2
9	B1a	A1	A1	A2b	A2a	A4b	A2b
8	B1	A1	A1	A2a	A2	A4a	A2a
7	B1b	A1	A1	A2	A2b	A4	A2
6	B1a	A1	A1	A2b	A2a	A4b	A2b
5	B1	A1	A1	A2a	A2	A4a	A2a
4	B1b	A1	A1	A2	A2b	A4	A2
3	B1a	A1	A1	A2b	A2a	A4b	A2b
2	B1	A1	A1	A2a	A2	A4a	A2a
1	B1(P)	A1(P)	A1(P)	A2(P)	A2(P)	A4(P)	A2(P)

25 TAMPINES STREET 86

UNIT FLOOR	21	20	19	18
15	Communal Roof Garden	PH5 (#15-20)	B5b-DK	
14	D2b-DK	D1	B5b-DK	C5-DK
13	D2-DK	D1b	B5-DK	C5c-DK
12	D2b-DK	D1a	B5b-DK	C5b-DK
11	D2a-DK	D1	B5a-DK	C5-DK
10	D2-DK	D1b	B5-DK	C5c-DK
9	D2b-DK	D1a	B5b-DK	C5b-DK
8	D2a-DK	D1	B5a-DK	C5-DK
7	D2-DK	D1b	B5-DK	C5c-DK
6	D2b-DK	D1a	B5b-DK	C5b-DK
5	D2a-DK	D1	B5a-DK	C5-DK
4	D2-DK	D1b	B5-DK	C5c-DK
3	D2b-DK	D1a	B5b-DK	C5b-DK
2	D2a-DK	D1	B5a-DK	C5-DK
1	GD2-DK	D1(P)	B5-DK(Pa)	GD1-DK

29 TAMPINES STREET 86

UNIT FLOOR	27	26
15	PH4 (#15-27)	Communal Roof Garden
14	C5c-DK	E1b
13	C5-DK	E1b
12	C5c-DK	E1a
11	C5a-DK	E1
10	C5-DK	E1b
9	C5c-DK	E1a
8	C5a-DK	E1
7	C5-DK	E1b
6	C5c-DK	E1a
5	C5a-DK	E1
4	C5-DK	E1b
3	C5c-DK	E1a
2	C5a-DK	E1
1	GD1-DK	E1(P)

33 TAMPINES STREET 86

UNIT FLOOR	35	34
15		C4b-DK
14	B3b	C4-DK
13	B3	C4b-DK
12	B3b	C4a-DK
11	B3a	C4-DK
10	B3	C4b-DK
9	B3b	C4a-DK
8	B3a	C4-DK
7	B3	C4b-DK
6	B3b	C4a-DK
5	B3a	C4-DK
4	B3	C4b-DK
3	B3b	C4a-DK
2	B3a	C4-DK
1	B3(Pa)	C4-DK(Pa)

LEGEND

- 1-BEDROOM
- 2-BEDROOM & 2-BEDROOM DUAL KEY
- 3-BEDROOM & 3-BEDROOM DUAL KEY
- 4-BEDROOM
- 5-BEDROOM
- 3- & 4-BEDROOM GARDEN DUPLEX
- PENTHOUSE

31 TAMPINES STREET 86

UNIT FLOOR	31	30	33	32
15	B4b		B2b	B5b-DK
14	B4b	B4	B2b	B5a-DK
13	B4	B4b	B2	B5-DK
12	B4b	B4a	B2b	B5b-DK
11	B4a	B4	B2a	B5a-DK
10	B4	B4b	B2	B5-DK
9	B4b	B4a	B2b	B5b-DK
8	B4a	B4	B2a	B5a-DK
7	B4	B4b	B2	B5-DK
6	B4b	B4a	B2b	B5b-DK
5	B4a	B4	B2a	B5a-DK
4	B4	B4b	B2	B5-DK
3	B4b	B4a	B2b	B5b-DK
2	B4a	B4	B2a	B5a-DK
1			B2(P)	B5-DK(P)

35 TAMPINES STREET 86

UNIT FLOOR	39	38	41	40
14	B4b	B4b	C2b	C2b
13	B4b	B4	C2b	C2
12	B4a	B4b	C2a	C2b
11	B4	B4a	C2	C2a
10	B4b	B4	C2b	C2
9	B4a	B4b	C2a	C2b
8	B4	B4a	C2	C2a
7	B4b	B4	C2b	C2
6	B4a	B4b	C2a	C2b
5	B4	B4a	C2	C2a
4	B4b	B4	C2b	C2
3	B4a	B4b	C2a	C2b
2	B4	B4a	C2	C2a
1	B4(P)	B4(P)	C2(P)	C2(P)

1 BR SUITE

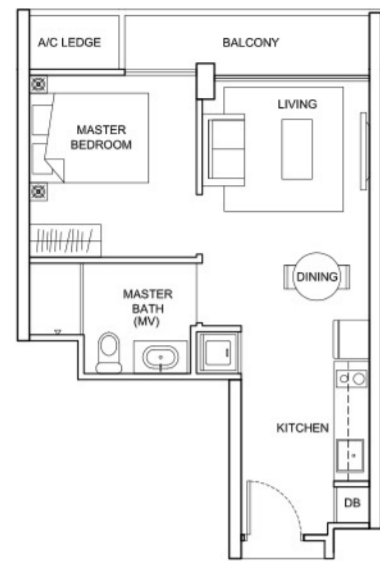

**TYPE A1**  
43 sqm

#02-11, #03-11, #04-11, #05-11, #06-11, #07-11, #08-11, #09-11, #10-11, #11-11, #12-11, #13-11, #14-11, #15-11 (Mirror Units)

#02-12, #03-12, #04-12, #05-12, #06-12, #07-12, #08-12, #09-12, #10-12, #11-12, #12-12, #13-12, #14-12, #15-12

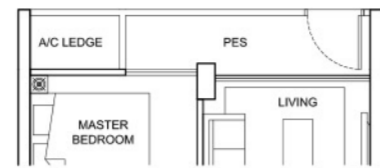

**TYPE A1(P)**  
43 sqm

#01-11 (Mirror Unit)  
#01-12



NOTE: #15-11, #15-12 - HIGH CEILING UNITS  
Area includes A/C ledge, balcony, PES, roof terrace and void (where applicable). Orientation and facings will differ depending on the unit you are purchasing (please refer to key plan). All plans are not to scale and subject to changes as may be required by relevant authorities.  
All appliances and furniture shown in the plan are for illustration purpose only and not representation of fact.  
All floor areas are estimated and subjected to final survey.

1 BR SUITE

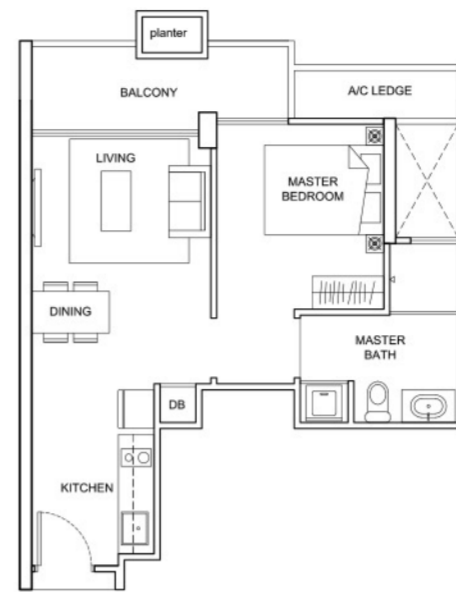

**TYPE A3**  
49 sqm

#04-05, #07-05, #10-05, #13-05, #15-05  
#04-02, #07-02, #10-02, #13-02, #15-02 (Mirror Units)



**TYPE A3(Pa)**  
49 sqm

#01-05  
#01-02 (Mirror Unit)

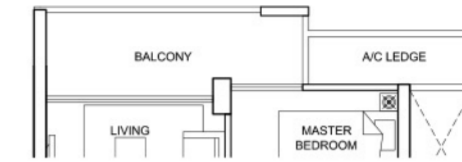

**TYPE A3a**  
49 sqm

#02-05, #05-05, #08-05, #11-05  
#02-02, #05-02, #08-02, #11-02 (Mirror Units)

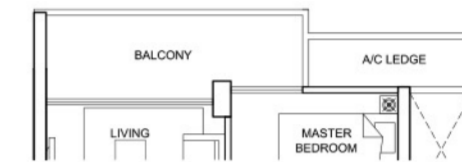

**TYPE A3b**  
49 sqm

#03-05, #06-05, #09-05, #12-05, #14-05  
#03-02, #06-02, #09-02, #12-02, #14-02 (Mirror Units)



NOTE: #15-02, #15-05 - HIGH CEILING UNITS  
Area includes A/C ledge, balcony, PES, roof terrace and void (where applicable). Orientation and facings will differ depending on the unit you are purchasing (please refer to key plan). All plans are not to scale and subject to changes as may be required by relevant authorities.  
All appliances and furniture shown in the plan are for illustration purpose only and not representation of fact.  
All floor areas are estimated and subjected to final survey.

1 BR SUITE

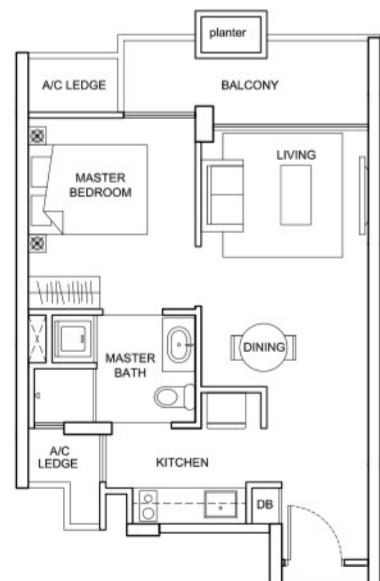

**TYPE A2**  
49 sqm

#02-04, #05-04, #08-04, #11-04, #14-04, #04-07, #07-07, #10-07, #13-07, #15-07, #04-10, #07-10, #10-10, #13-10, #15-10

#02-03, #05-03, #08-03, #11-03, #14-03, #02-06, #05-06, #08-06, #11-06, #14-06, #02-09, #05-09, #08-09, #11-09, #14-09 (Mirror Units)

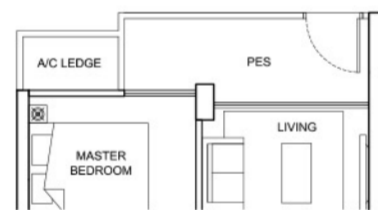

**TYPE A2(P)**  
49 sqm

#01-07, #01-10  
#01-09 (Mirror Unit)

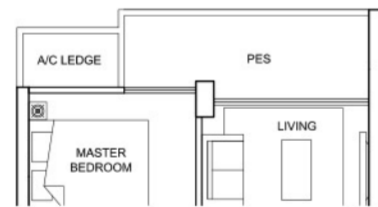

**TYPE A2(Pa)**  
49 sqm

#01-04  
#01-03, #01-06 (Mirror Units)

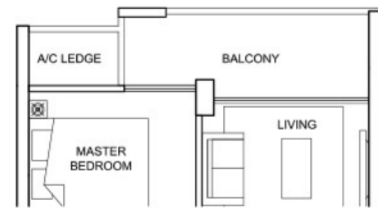

**TYPE A2a**  
49 sqm

#03-04, #06-04, #09-04, #12-04, #02-07, #05-07, #08-07, #11-07, #02-10, #05-10, #08-10, #11-10, #14-10

#03-03, #06-03, #09-03, #12-03, #02-06, #05-06, #08-06, #11-06, #14-06, #03-09, #06-09, #09-09, #12-09 (Mirror Units)

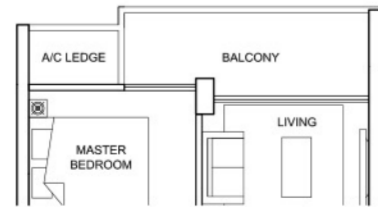

**TYPE A2b**  
49 sqm

#04-04, #07-04, #10-04, #13-04, #15-04, #03-07, #06-07, #09-07, #12-07, #14-07, #03-10, #06-10, #09-10, #12-10, #14-10, #15-10

#04-03, #07-03, #10-03, #13-03, #15-03, #04-06, #07-06, #10-06, #13-06, #15-06, #04-09, #07-09, #10-09, #13-09, #15-09 (Mirror Units)



NOTE: #15-03, #15-04, #15-06, #15-07, #15-09, #15-10 - HIGH CEILING UNITS  
Area includes A/C ledge, balcony, PES, roof terrace and void (where applicable). Orientation and facings will differ depending on the unit you are purchasing (please refer to key plan). All plans are not to scale and subject to changes as may be required by relevant authorities.  
All appliances and furniture shown in the plan are for illustration purpose only and not representation of fact.  
All floor areas are estimated and subjected to final survey.

1 BR SUITE

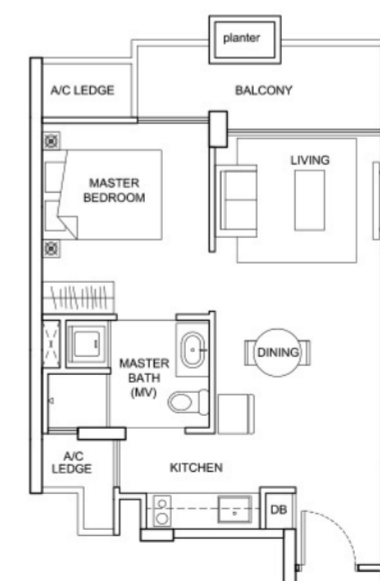

**TYPE A4**  
49 sqm

#04-06, #07-06, #10-06, #13-06, #15-06



**TYPE A4(P)**  
49 sqm

#01-08



**TYPE A4a**  
49 sqm

#02-08, #05-08, #08-08, #11-08

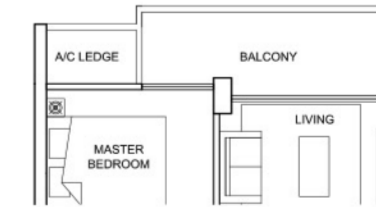

**TYPE A4b**  
49 sqm

#03-08, #06-08, #09-08, #12-08, #14-08

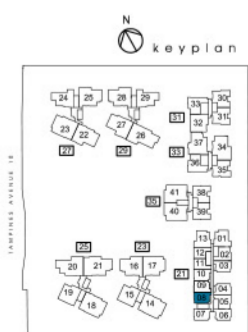

NOTE: #15-08 - HIGH CEILING UNIT  
Area includes A/C ledge, balcony, PES, roof terrace and void (where applicable). Orientation and facings will differ depending on the unit you are purchasing (please refer to key plan). All plans are not to scale and subject to changes as may be required by relevant authorities.  
All appliances and furniture shown in the plan are for illustration purpose only and not representation of fact.  
All floor areas are estimated and subjected to final survey.

2 BR SUITE

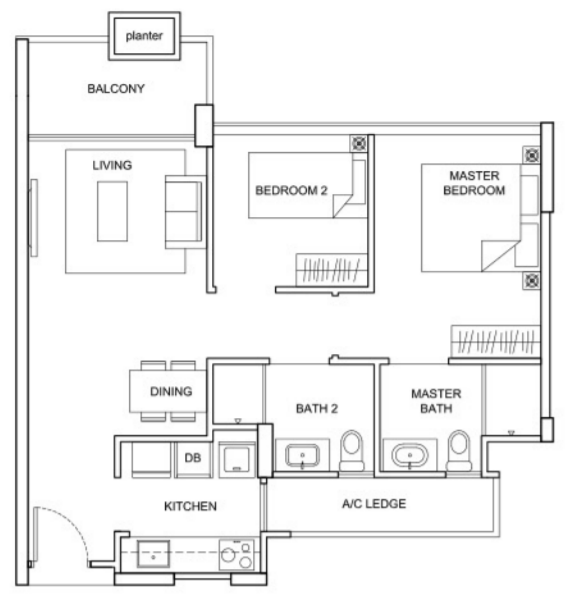

**TYPE B1**  
68 sqm  
#02-13, #05-13, #08-13, #11-13, #14-13  
#02-01, #05-01, #08-01, #11-01, #14-01 (Mirror Units)

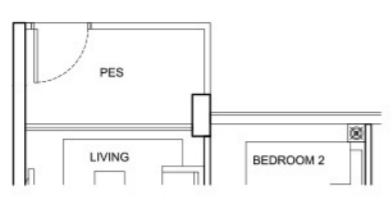

**TYPE B1(P)**  
67 sqm  
#01-13

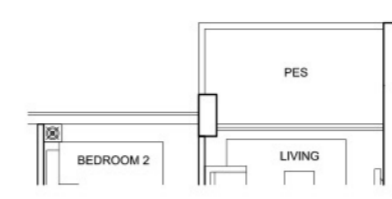

**TYPE B1(Pa)**  
67 sqm  
#01-01 (Mirror Unit)

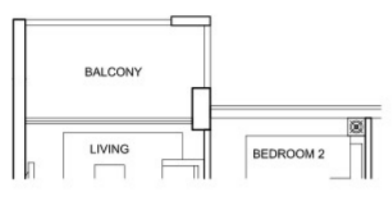

**TYPE B1a**  
67 sqm  
#03-13, #06-13, #09-13, #12-13  
#03-01, #06-01, #09-01, #12-01 (Mirror Units)

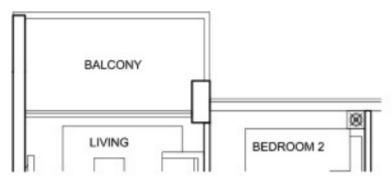

**TYPE B1b**  
67 sqm  
#04-13, #07-13, #10-13, #13-13, #15-13  
#04-01, #07-01, #10-01, #13-01 (Mirror Units)



NOTE: #15-13 - HIGH CEILING UNIT  
Area includes A/C ledge, balcony, PES, roof terrace and void (where applicable). Orientation and facings will differ depending on the unit you are purchasing (please refer to key plan). All plans are not to scale and subject to changes as may be required by relevant authorities.  
All appliances and furniture shown in the plan are for illustration purpose only and not representation of fact.  
All floor areas are estimated and subjected to final survey.

2 BR SUITE



**TYPE B2**  
66 sqm  
#04-33, #07-33, #10-33, #13-33  
#04-38, #07-38, #10-38, #13-38 (Mirror Units)

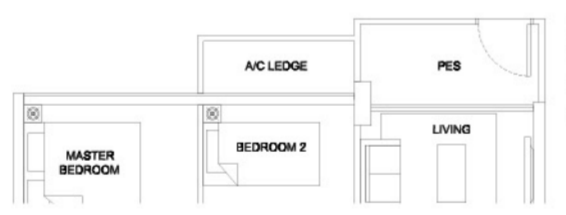

**TYPE B2(P)**  
69 sqm  
#01-33  
#01-38 (Mirror Unit)

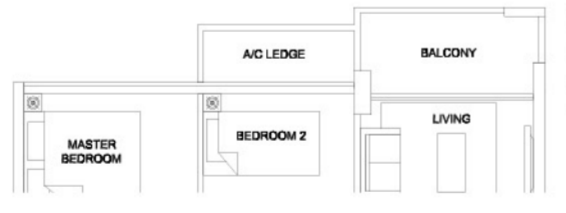

**TYPE B2a**  
69 sqm  
#02-33, #05-33, #08-33, #11-33  
#02-38, #05-38, #08-38, #11-38 (Mirror Units)

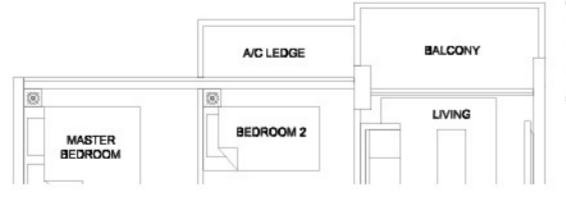

**TYPE B2b**  
69 sqm  
#03-33, #06-33, #09-33, #12-33, #14-33, #15-33  
#03-38, #06-38, #09-38, #12-38, #14-38 (Mirror Units)



NOTE: #15-33 - HIGH CEILING UNIT  
Area includes A/C ledge, balcony, PES, roof terrace and void (where applicable). Orientation and facings will differ depending on the unit you are purchasing (please refer to key plan). All plans are not to scale and subject to changes as may be required by relevant authorities.  
All appliances and furniture shown in the plan are for illustration purpose only and not representation of fact.  
All floor areas are estimated and subjected to final survey.

2 BR SUITE

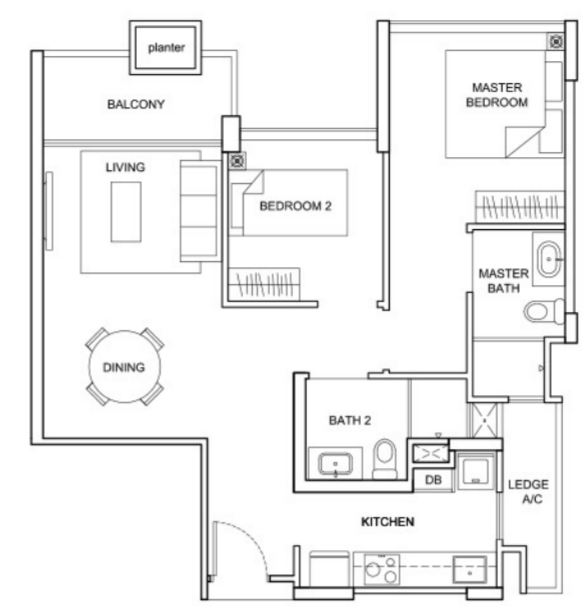

**TYPE B3**  
72 sqm  
#04-35, #07-35, #10-35, #13-35

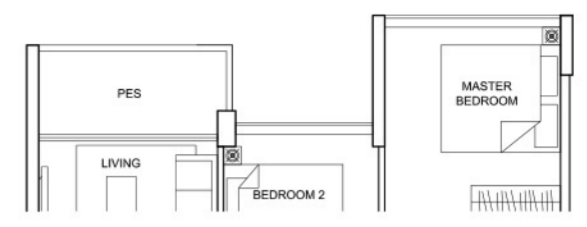

**TYPE B3(Pa)**  
71 sqm  
#01-35

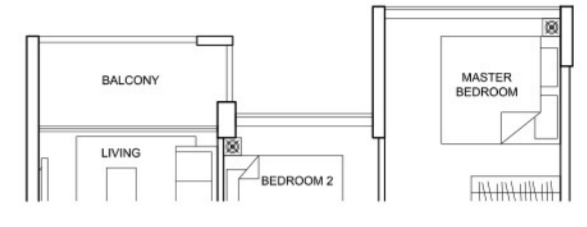

**TYPE B3a**  
71 sqm  
#02-35, #05-35, #08-35, #11-35

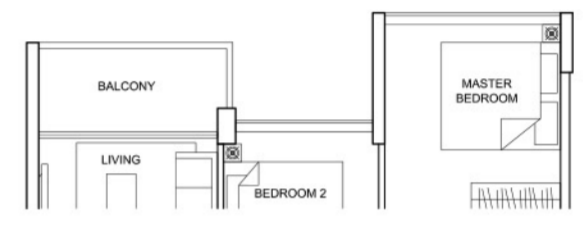

**TYPE B3b**  
71 sqm  
#03-35, #06-35, #09-35, #12-35, #14-35



Area includes A/C ledge, balcony, PES, roof terrace and void (where applicable). Orientation and facings will differ depending on the unit you are purchasing (please refer to key plan). All plans are not to scale and subject to changes as may be required by relevant authorities.  
All appliances and furniture shown in the plan are for illustration purpose only and not representation of fact.  
All floor areas are estimated and subjected to final survey.

2 BR SUITE

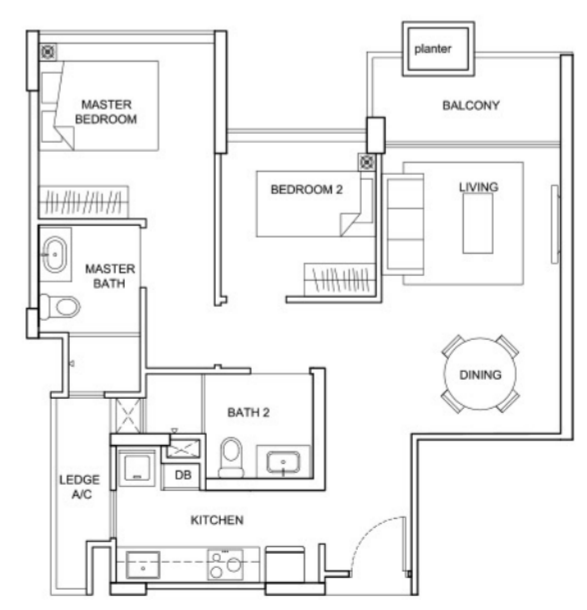

**TYPE B4**  
70 sqm  
#02-30, #05-30, #08-30, #11-30, #14-30  
#04-30, #07-30, #10-30, #13-30  
#04-31, #07-31, #10-31, #13-31  
#02-39, #05-39, #08-39, #11-39 (Mirror Units)

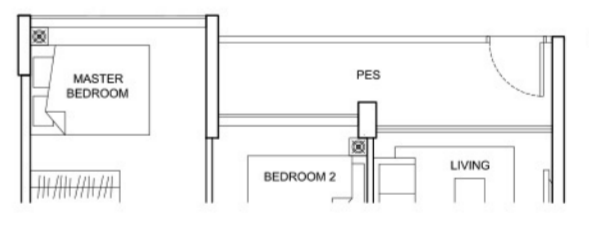

**TYPE B4(P)**  
73 sqm  
#01-38  
#01-39 (Mirror Unit)

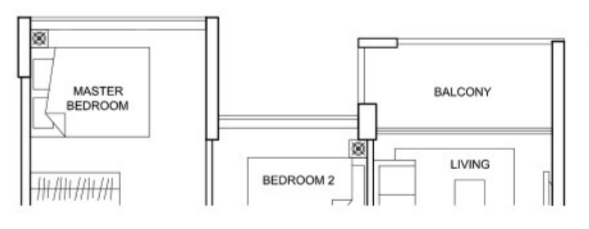

**TYPE B4a**  
70 sqm  
#02-38, #03-30, #05-38, #06-30, #08-38, #09-30, #11-38, #12-30  
#02-31, #05-31, #08-31, #11-31, #03-39, #06-39, #09-39, #12-39 (Mirror Units)

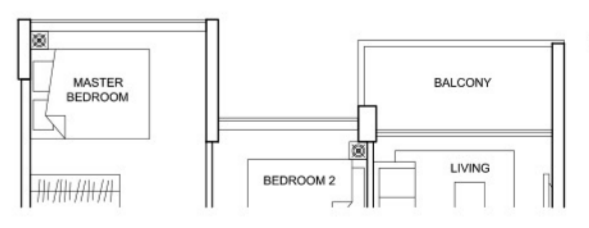

**TYPE B4b**  
70 sqm  
#04-30, #07-30, #10-30, #13-30, #03-38, #06-38, #09-38, #12-38, #14-38  
#03-31, #06-31, #09-31, #12-31, #14-31, #15-31  
#04-39, #07-39, #10-39, #13-39, #14-39 (Mirror Units)

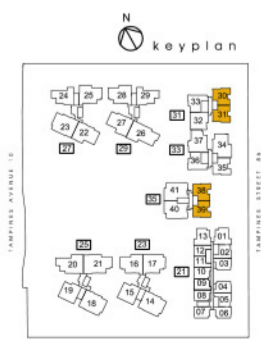

NOTE: #15-31 - HIGH CEILING UNIT  
Area includes A/C ledge, balcony, PES, roof terrace and void (where applicable). Orientation and facings will differ depending on the unit you are purchasing (please refer to key plan). All plans are not to scale and subject to changes as may be required by relevant authorities.  
All appliances and furniture shown in the plan are for illustration purpose only and not representation of fact.  
All floor areas are estimated and subjected to final survey.

2 BR  
DUAL KEY  
SUITE

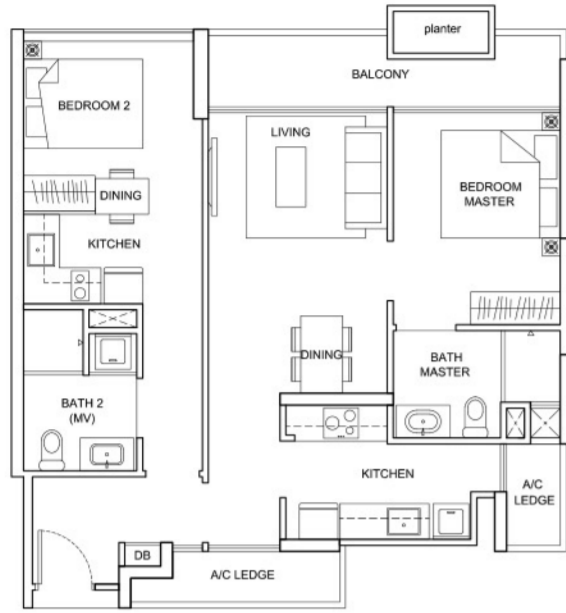

**TYPE B5-DK**

85 sqm  
#04-15, #07-15, #10-15, #13-15,  
#04-19, #07-19, #10-19, #13-19  
#04-32, #07-32, #10-32, #13-32 (Mirror Units)

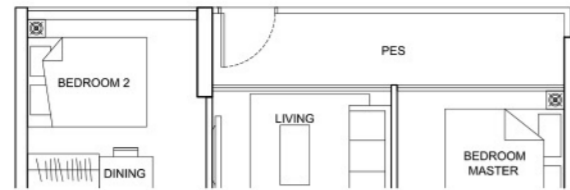

**TYPE B5-DK(P)**

84 sqm  
#01-15  
#01-32 (Mirror Unit)



**TYPE B5-DK(Pa)**

84 sqm  
#01-19



**TYPE B5a-DK**

85 sqm  
#02-15, #05-15, #08-15, #11-15  
#02-19, #05-19, #08-19, #11-19  
#02-32, #05-32, #08-32, #11-32,  
#14-32 (Mirror Units)

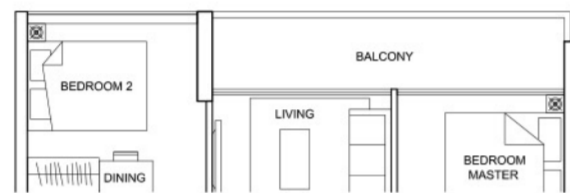

**TYPE B5b-DK**

84 sqm  
#03-15, #06-15, #09-15,  
#12-15, #14-15, #15-15  
#03-19, #06-19, #09-19,  
#12-19, #14-19, #15-19  
#03-32, #06-32, #09-32, #12-32,  
#15-32 (Mirror Units)



NOTE: #15-15, #15-19, #15-32 - HIGH CEILING UNIT  
Area includes A/C ledge, balcony, PES, roof terrace and void (where applicable). Orientation and facings will differ depending on the unit you are purchasing (please refer to key plan). All plans are not to scale and subject to changes as may be required by relevant authorities.  
All appliances and furniture shown in the plan are for illustration purpose only and not representation of fact.  
All floor areas are estimated and subjected to final survey.

3 BR  
SUITE

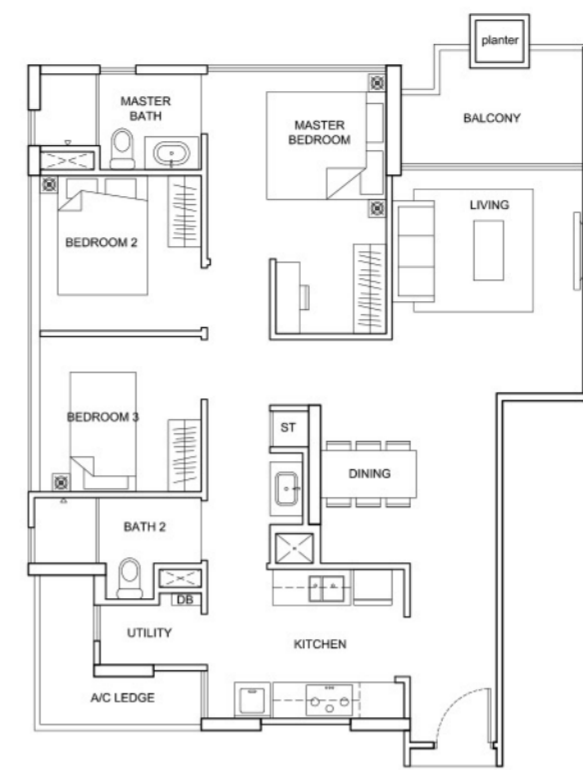

**TYPE C2**

97 sqm  
#04-40, #07-40, #10-40, #13-40  
#02-41, #05-41, #08-41, #11-41 (Mirror Units)

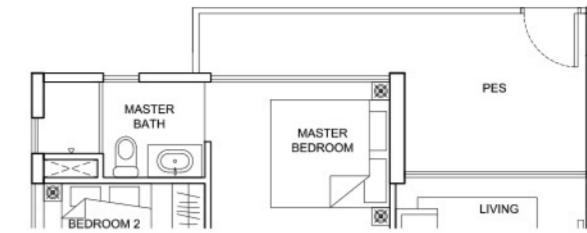

**TYPE C2(P)**

103 sqm  
#01-40  
#01-41 (Mirror Unit)



**TYPE C2a**

103 sqm  
#02-40, #05-40, #08-40, #11-40,  
#03-41, #06-41, #09-41, #12-41 (Mirror Units)



**TYPE C2b**

103 sqm  
#03-40, #06-40, #09-40, #12-40, #14-40  
#04-41, #07-41, #10-41, #13-41, #14-41 (Mirror Units)



Area includes A/C ledge, balcony, PES, roof terrace and void (where applicable). Orientation and facings will differ depending on the unit you are purchasing (please refer to key plan). All plans are not to scale and subject to changes as may be required by relevant authorities.  
All appliances and furniture shown in the plan are for illustration purpose only and not representation of fact.  
All floor areas are estimated and subjected to final survey.

3 BR  
SUITE

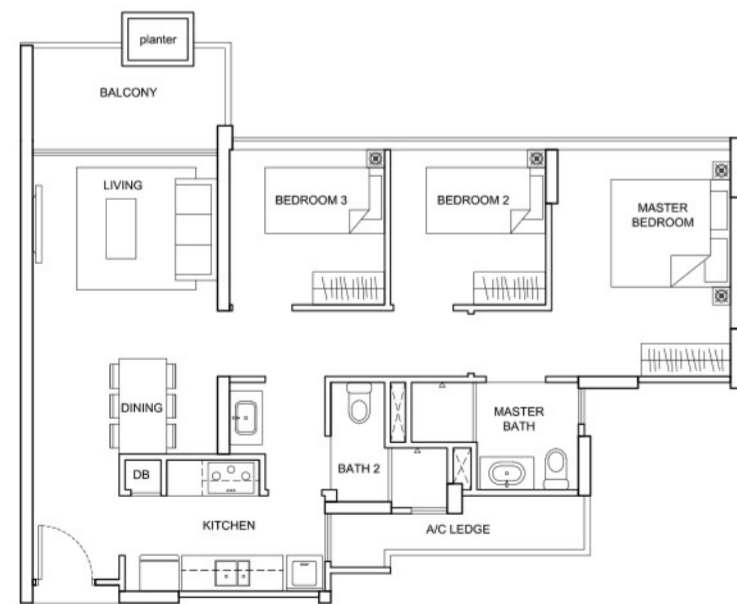

**TYPE C1**

85 sqm  
#04-24, #07-24, #10-24, #13-24 (Mirror Units)  
#04-29, #07-29, #10-29, #13-29



**TYPE C1(Pa)**

85 sqm  
#01-24 (Mirror Unit)  
#01-29



**TYPE C1a**

85 sqm  
#02-24, #05-24, #08-24, #11-24 (Mirror Units)  
#02-29, #05-29, #08-29, #11-29



**TYPE C1b**

85 sqm  
#03-24, #06-24, #09-24, #12-24, #14-24 (Mirror Units)  
#03-29, #06-29, #09-29, #12-29, #14-29



Area includes A/C ledge, balcony, PES, roof terrace and void (where applicable). Orientation and facings will differ depending on the unit you are purchasing (please refer to key plan). All plans are not to scale and subject to changes as may be required by relevant authorities.  
All appliances and furniture shown in the plan are for illustration purpose only and not representation of fact.  
All floor areas are estimated and subjected to final survey.

3 BR  
SUITE



**TYPE C3**

105 sqm  
#02-17, #05-17, #08-17, #11-17  
#02-25, #05-25, #08-25, #11-25,  
#03-37, #06-37, #09-37, #12-37  
#04-16, #07-16, #10-16, #13-16  
#02-28, #05-28, #08-28, #11-28 (Mirror Units)

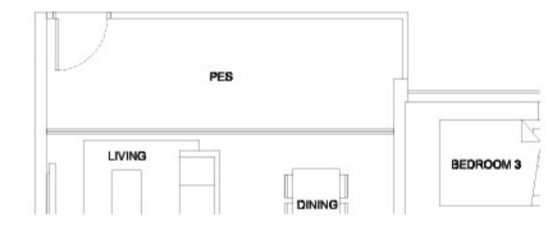

**TYPE C3(P)**

104 sqm  
#01-16 (Mirror Unit)  
#01-17, #01-37

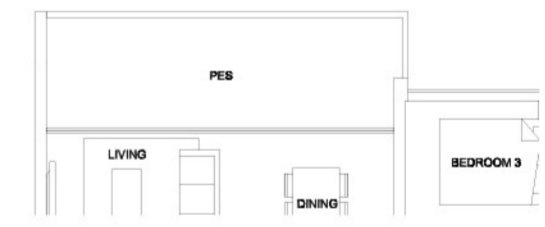

**TYPE C3(Pa)**

104 sqm  
#01-25  
#01-26 (Mirror Unit)

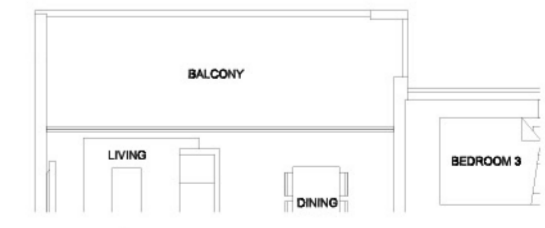

**TYPE C3a**

104 sqm  
#03-25, #06-25, #09-25, #12-25  
#02-16, #05-16, #08-16, #11-16  
#03-28, #06-28, #09-28, #12-28 (Mirror Units)



Area includes A/C ledge, balcony, PES, roof terrace and void (where applicable). Orientation and facings will differ depending on the unit you are purchasing (please refer to key plan). All plans are not to scale and subject to changes as may be required by relevant authorities.  
All appliances and furniture shown in the plan are for illustration purpose only and not representation of fact.  
All floor areas are estimated and subjected to final survey.

3 BR SUITE

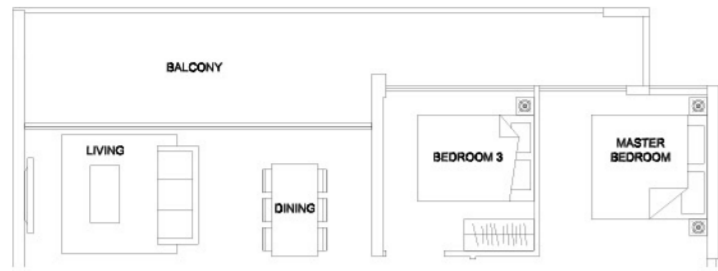

**TYPE C3b**  
110 sqm  
#03-17, #08-17, #09-17, #12-17  
#04-37, #07-37, #10-37, #13-37

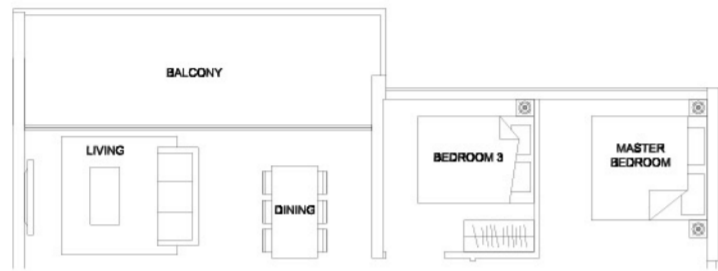

**TYPE C3c**  
104 sqm  
#04-17, #07-17, #10-17, #13-17, #14-17,  
#04-25, #07-25, #10-25, #13-25, #14-25,  
#02-37, #06-37, #08-37, #11-37, #14-37  
#03-16, #06-16, #09-16, #12-16, #14-16,  
#04-28, #07-28, #10-28, #13-28, #14-28 (Mirror Units)



Area includes A/C ledge, balcony, PES, roof terrace and void (where applicable). Orientation and facings will differ depending on the unit you are purchasing (please refer to key plan). All plans are not to scale and subject to changes as may be required by relevant authorities. All appliances and furniture shown in the plan are for illustration purpose only and not representation of fact. All floor areas are estimated and subjected to final survey.

3 BR DUAL KEY SUITE

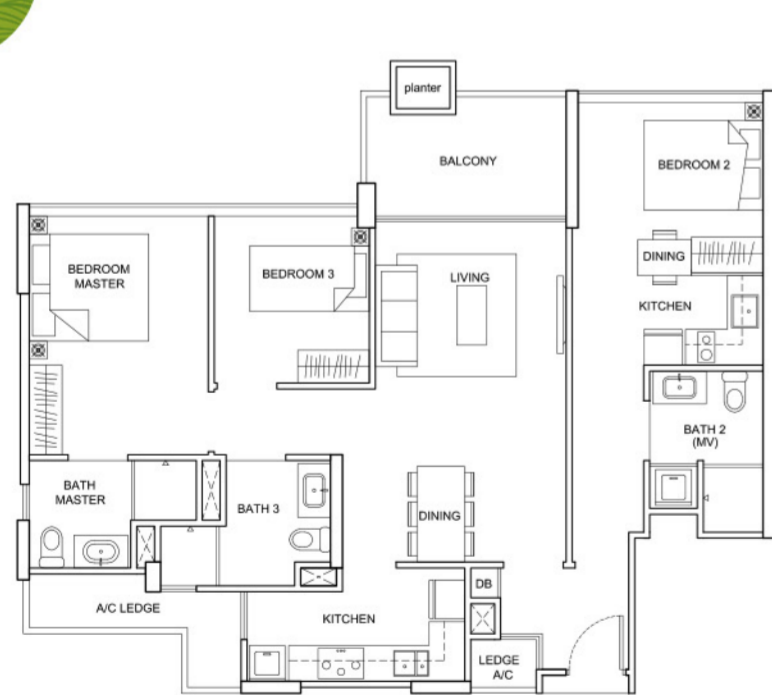

**TYPE C4-DK**  
105 sqm  
#02-34, #05-34, #08-34, #11-34,  
#14-34

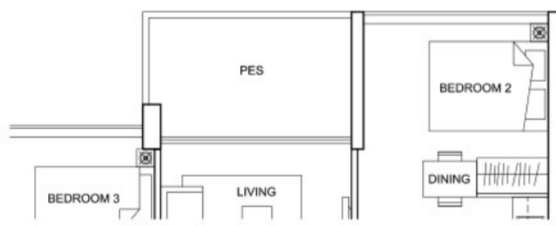

**TYPE C4-DK(Pa)**  
105 sqm  
#01-34



**TYPE C4a-DK**  
105 sqm  
#03-34, #06-34, #09-34, #12-34

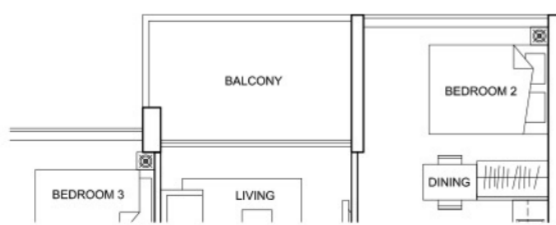

**TYPE C4b-DK**  
105 sqm  
#04-34, #07-34, #10-34, #13-34,  
#15-34



NOTE: #15-34 - HIGH CEILING UNIT  
Area includes A/C ledge, balcony, PES, roof terrace and void (where applicable). Orientation and facings will differ depending on the unit you are purchasing (please refer to key plan). All plans are not to scale and subject to changes as may be required by relevant authorities. All appliances and furniture shown in the plan are for illustration purpose only and not representation of fact. All floor areas are estimated and subjected to final survey.

3 BR DUAL KEY SUITE



**TYPE C5-DK**  
107 sqm  
#02-14, #05-14, #08-14, #11-14, #14-14,  
#02-18, #05-18, #08-18, #11-18, #14-18,  
#04-22, #07-22, #10-22, #13-22,  
#02-23, #05-23, #08-23, #11-23,  
#04-27, #07-27, #10-27, #13-27 (Mirror Units)

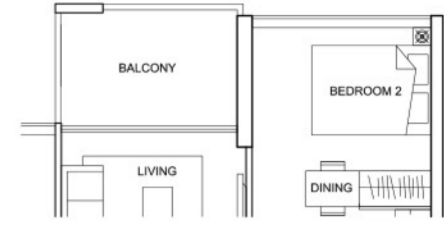

**TYPE C5a-DK**  
107 sqm  
#02-22, #05-22, #08-22, #11-22,  
#02-27, #05-27, #08-27, #11-27 (Mirror Units)

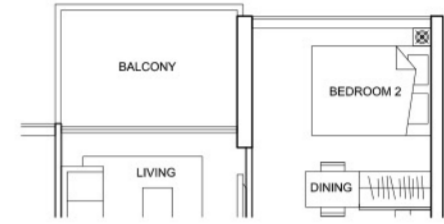

**TYPE C5c-DK**  
107 sqm  
#04-14, #07-14, #10-14, #13-14,  
#04-18, #07-18, #10-18, #13-18,  
#03-22, #06-22, #09-22, #12-22, #14-22  
#04-23, #07-23, #10-23, #13-23, #14-23,  
#03-27, #06-27, #09-27, #12-27, #14-27 (Mirror Units)



Area includes A/C ledge, balcony, PES, roof terrace and void (where applicable). Orientation and facings will differ depending on the unit you are purchasing (please refer to key plan). All plans are not to scale and subject to changes as may be required by relevant authorities. All appliances and furniture shown in the plan are for illustration purpose only and not representation of fact. All floor areas are estimated and subjected to final survey.

4 BR SUITE

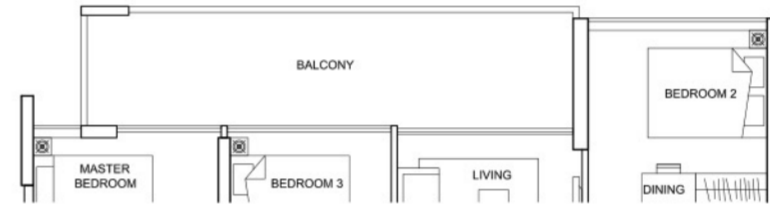

**TYPE C5b-DK**  
117 sqm  
#03-14, #06-14, #09-14, #12-14,  
#03-18, #06-18, #09-18, #12-18,  
#03-23, #06-23, #09-23, #12-23 (Mirror Units)



**TYPE D1**  
117 sqm  
#02-20, #05-20, #08-20, #11-20,  
#14-20

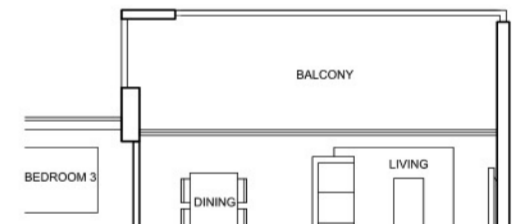

**TYPE D1a**  
116 sqm  
#03-20, #06-20, #09-20, #12-20

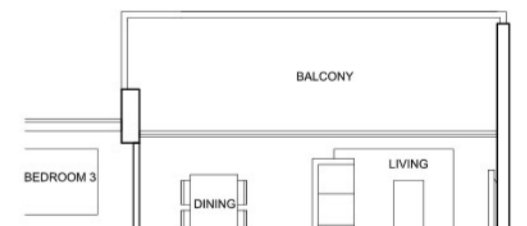

**TYPE D1b**  
116 sqm  
#04-20, #07-20, #10-20, #13-20



**TYPE D1(P)**  
115 sqm  
#01-20



Area includes A/C ledge, balcony, PES, roof terrace and void (where applicable). Orientation and facings will differ depending on the unit you are purchasing (please refer to key plan). All plans are not to scale and subject to changes as may be required by relevant authorities. All appliances and furniture shown in the plan are for illustration purpose only and not representation of fact. All floor areas are estimated and subjected to final survey.

4 BR  
DUAL KEY  
SUITE

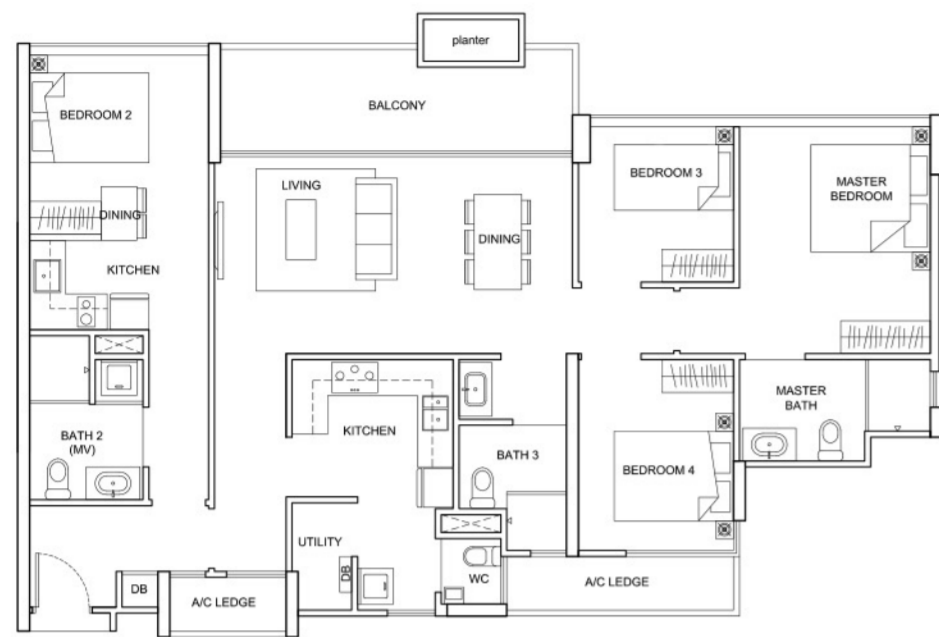

**TYPE D2-DK**  
132 sqm  
#04-21, #07-21, #10-21, #13-21

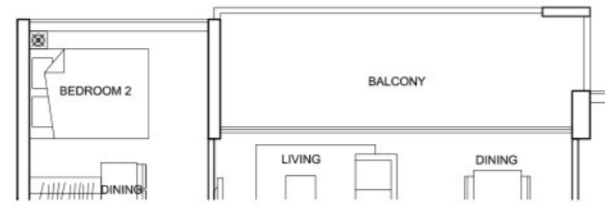

**TYPE D2a-DK**  
132 sqm  
#02-21, #05-21, #08-21, #11-21

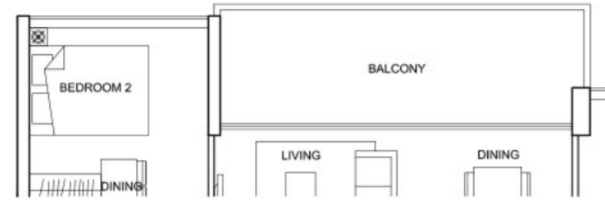

**TYPE D2b-DK**  
132 sqm  
#03-21, #06-21, #09-21, #12-21, #14-21



Area includes A/C ledge, balcony, PES, roof terrace and void (where applicable). Orientation and facings will differ depending on the unit you are purchasing (please refer to key plan). All plans are not to scale and subject to changes as may be required by relevant authorities. All appliances and furniture shown in the plan are for illustration purpose only and not representation of fact. All floor areas are estimated and subjected to final survey.

3 BR  
GARDEN  
DUPLEX

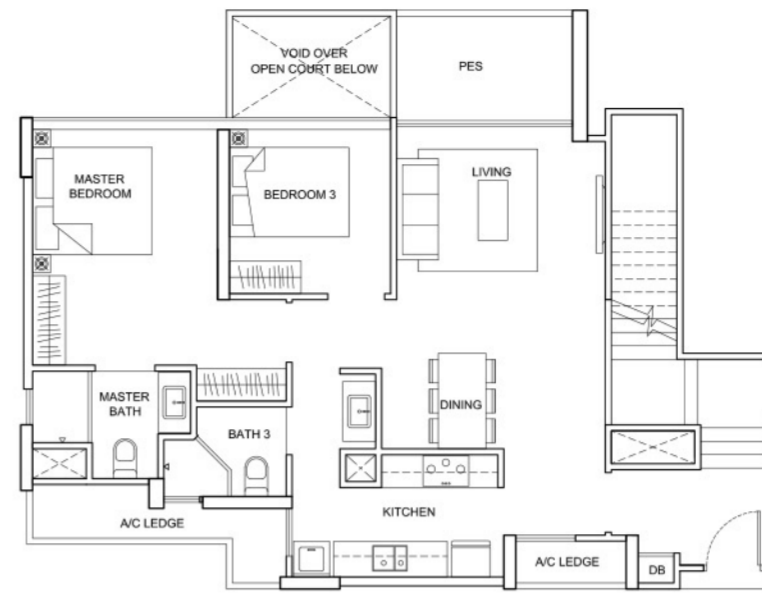

**TYPE GD1-DK UPPER**  
**TYPE GD1-DK**  
152 sqm  
#01-14, #01-18, #01-22,  
#01-23, #01-27 (Mirror Units)

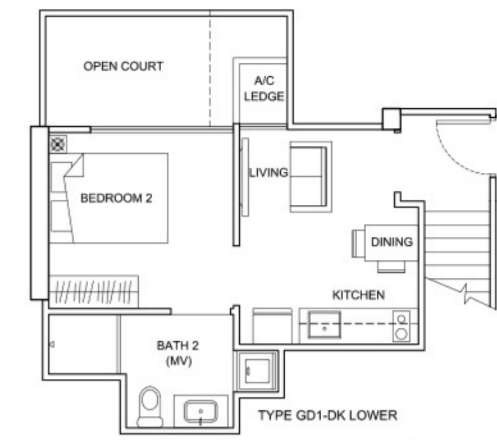

**TYPE GD1-DK LOWER**



Area includes A/C ledge, balcony, PES, roof terrace and void (where applicable). Orientation and facings will differ depending on the unit you are purchasing (please refer to key plan). All plans are not to scale and subject to changes as may be required by relevant authorities. All appliances and furniture shown in the plan are for illustration purpose only and not representation of fact. All floor areas are estimated and subjected to final survey.

5 BR  
SUITE



**TYPE E1(P)**  
127 sqm  
#01-26

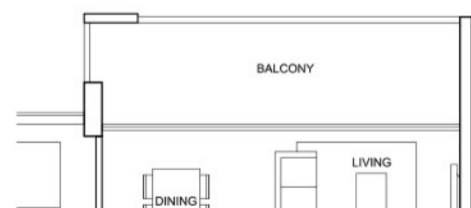

**TYPE E1a**  
127 sqm  
#03-26, #06-26, #09-26, #12-26



**TYPE E1b**  
127 sqm  
#04-26, #07-26, #10-26, #13-26, #14-26

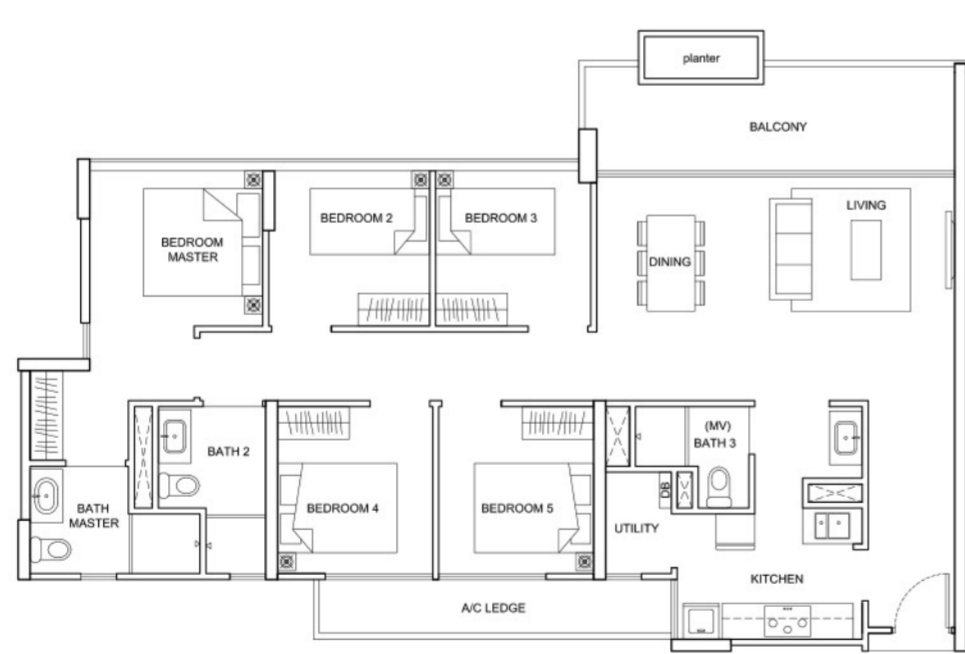

**TYPE E1**  
128 sqm  
#02-26, #05-26, #08-26, #11-26



Area includes A/C ledge, balcony, PES, roof terrace and void (where applicable). Orientation and facings will differ depending on the unit you are purchasing (please refer to key plan). All plans are not to scale and subject to changes as may be required by relevant authorities. All appliances and furniture shown in the plan are for illustration purpose only and not representation of fact. All floor areas are estimated and subjected to final survey.

4 BR  
GARDEN  
DUPLEX

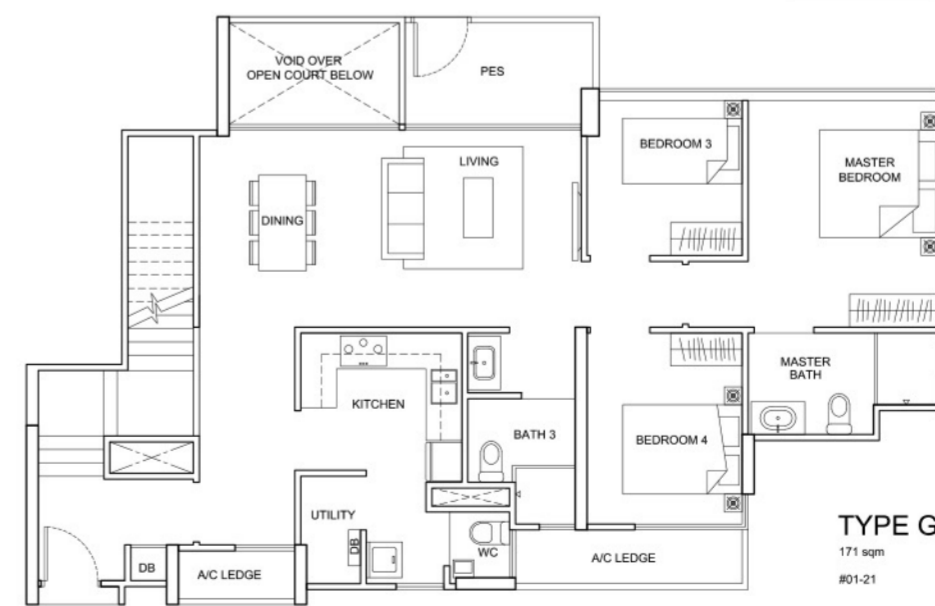

**TYPE GD2-DK UPPER**



PRIVATE CAR PARK LOTS  
(located at B1)

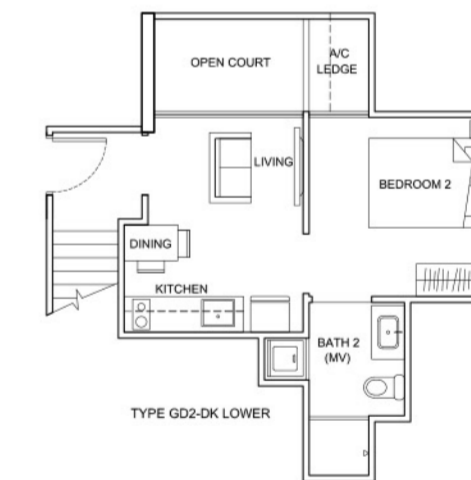

**TYPE GD2-DK LOWER**

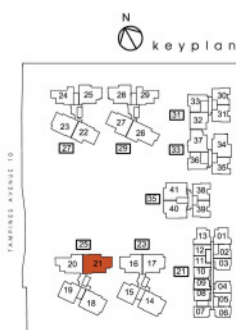

Area includes A/C ledge, balcony, PES, roof terrace and void (where applicable). Orientation and facings will differ depending on the unit you are purchasing (please refer to key plan). All plans are not to scale and subject to changes as may be required by relevant authorities. All appliances and furniture shown in the plan are for illustration purpose only and not representation of fact. All floor areas are estimated and subjected to final survey.

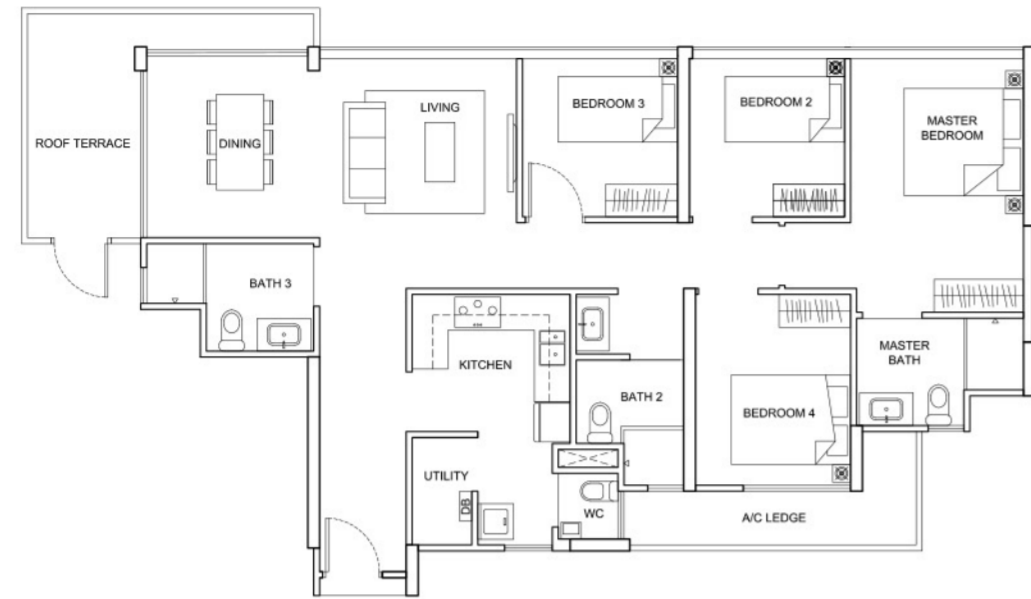

**TYPE PH1**  
122 sqm  
#15-37



NOTE: HIGH CEILING FOR ALL PENTHOUSE UNITS  
Area includes A/C ledge, balcony, PES, roof terrace and void (where applicable). Orientation and facings will differ depending on the unit you are purchasing (please refer to key plan). All plans are not to scale and subject to changes as may be required by relevant authorities.  
All appliances and furniture shown in the plan are for illustration purpose only and not representation of fact.  
All floor areas are estimated and subjected to final survey.



**TYPE PH3**  
142 sqm  
#15-23



NOTE: HIGH CEILING FOR ALL PENTHOUSE UNITS  
Area includes A/C ledge, balcony, PES, roof terrace and void (where applicable). Orientation and facings will differ depending on the unit you are purchasing (please refer to key plan). All plans are not to scale and subject to changes as may be required by relevant authorities.  
All appliances and furniture shown in the plan are for illustration purpose only and not representation of fact.  
All floor areas are estimated and subjected to final survey.

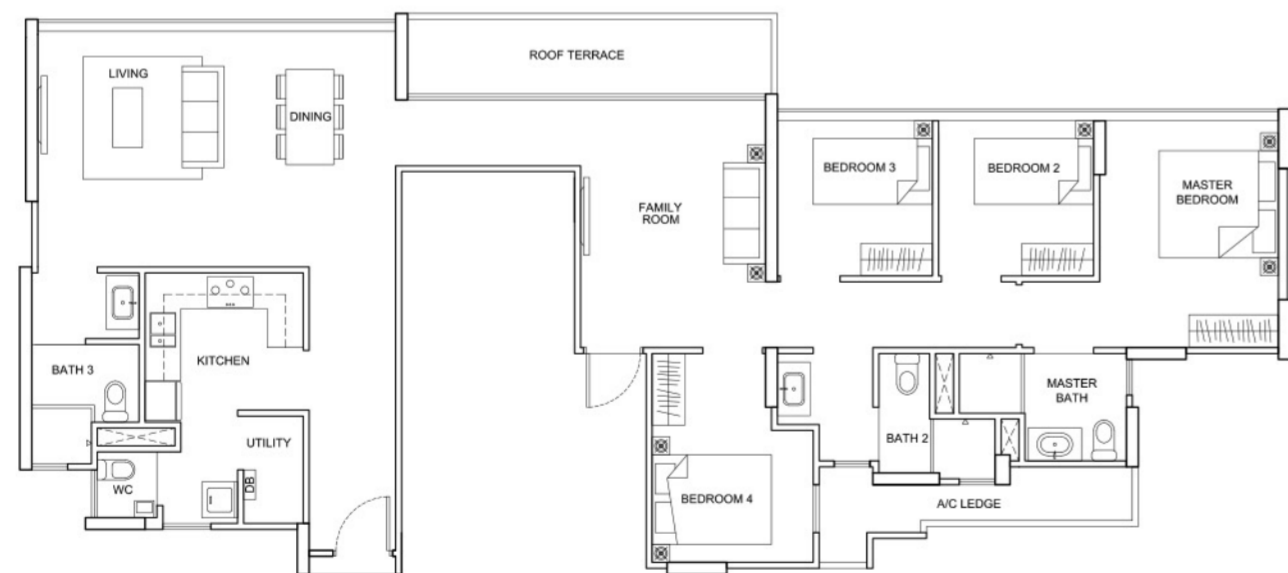

**TYPE PH2**  
140 sqm  
#15-28  
(Mirror Unit)  
#15-24

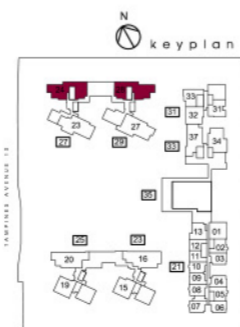

NOTE: HIGH CEILING FOR ALL PENTHOUSE UNITS  
Area includes A/C ledge, balcony, PES, roof terrace and void (where applicable). Orientation and facings will differ depending on the unit you are purchasing (please refer to key plan). All plans are not to scale and subject to changes as may be required by relevant authorities.  
All appliances and furniture shown in the plan are for illustration purpose only and not representation of fact.  
All floor areas are estimated and subjected to final survey.



**TYPE PH4**  
146 sqm  
#15-27



NOTE: HIGH CEILING FOR ALL PENTHOUSE UNITS  
Area includes A/C ledge, balcony, PES, roof terrace and void (where applicable). Orientation and facings will differ depending on the unit you are purchasing (please refer to key plan). All plans are not to scale and subject to changes as may be required by relevant authorities.  
All appliances and furniture shown in the plan are for illustration purpose only and not representation of fact.  
All floor areas are estimated and subjected to final survey.





**TYPE PH5**

149 sqm  
#15-20



NOTE: HIGH CEILING FOR ALL PENTHOUSE UNITS  
Area includes A/C ledge, balcony, PES, roof terrace and void (where applicable). Orientation and facings will differ depending on the unit you are purchasing (please refer to key plan). All plans are not to scale and subject to changes as may be required by relevant authorities.  
All appliances and furniture shown in the plan are for illustration purpose only and not representation of fact.  
All floor areas are estimated and subjected to final survey.

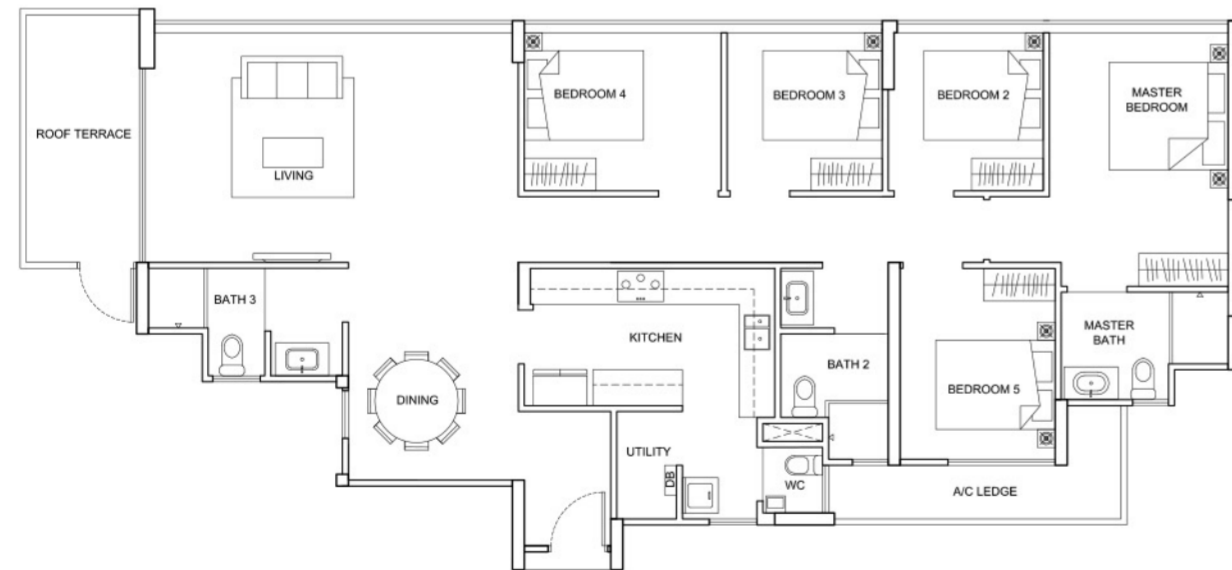

**TYPE PH6**

149 sqm  
#15-16



NOTE: HIGH CEILING FOR ALL PENTHOUSE UNITS  
Area includes A/C ledge, balcony, PES, roof terrace and void (where applicable). Orientation and facings will differ depending on the unit you are purchasing (please refer to key plan). All plans are not to scale and subject to changes as may be required by relevant authorities.  
All appliances and furniture shown in the plan are for illustration purpose only and not representation of fact.  
All floor areas are estimated and subjected to final survey.