

#03-03, #03-04, #05-02, #05-03, #07-02, #07-03, #09-02, #09-03

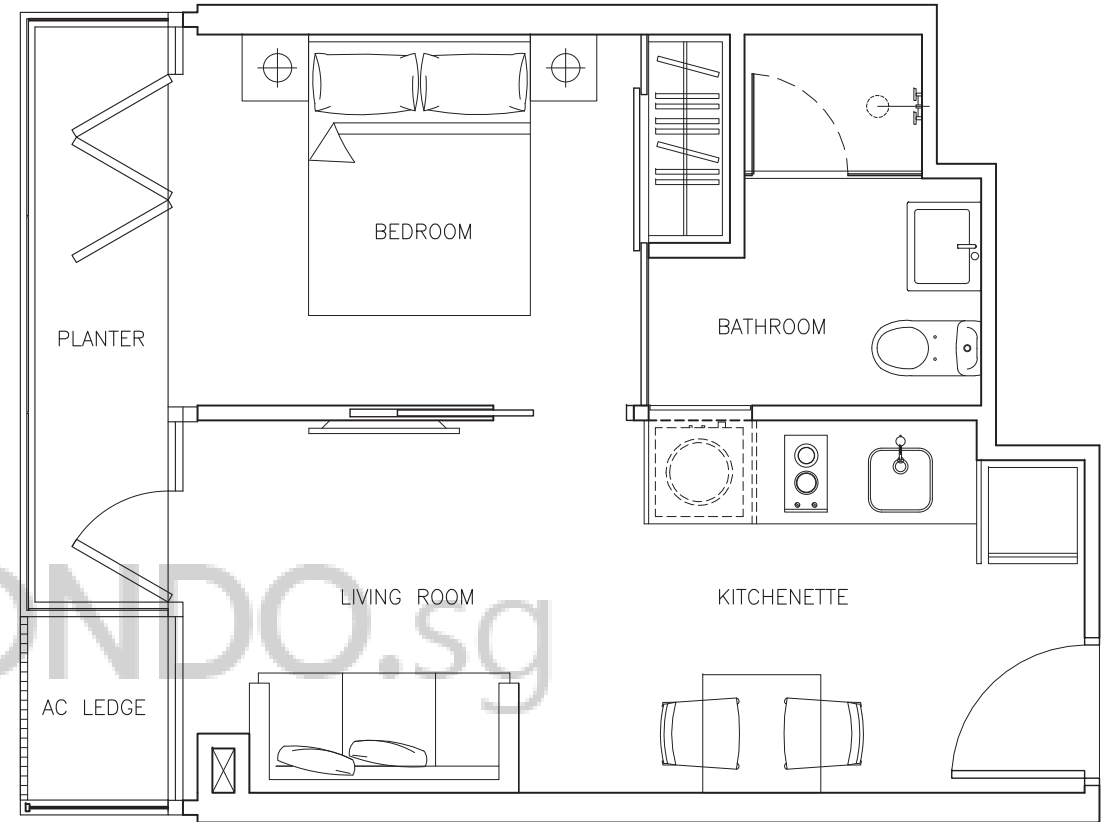

#02-03, #02-04, #04-02, #04-03, #06-02, #06-03, #08-02, #08-03

**1 BEDROOM
TYPE 1A**

37 sq.m / 398 sq.ft

- Notes:
1. Areas includes PES / Roof Terraces (where applicable), AC Ledge, strata voids and planters
 2. All plans are not to scale and subject to change as may be approved by the relevant authorities

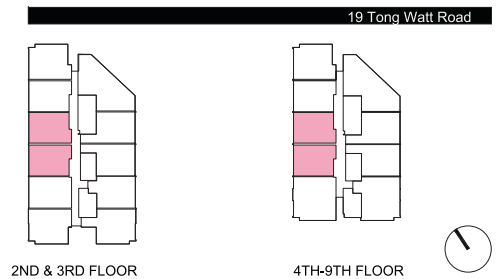

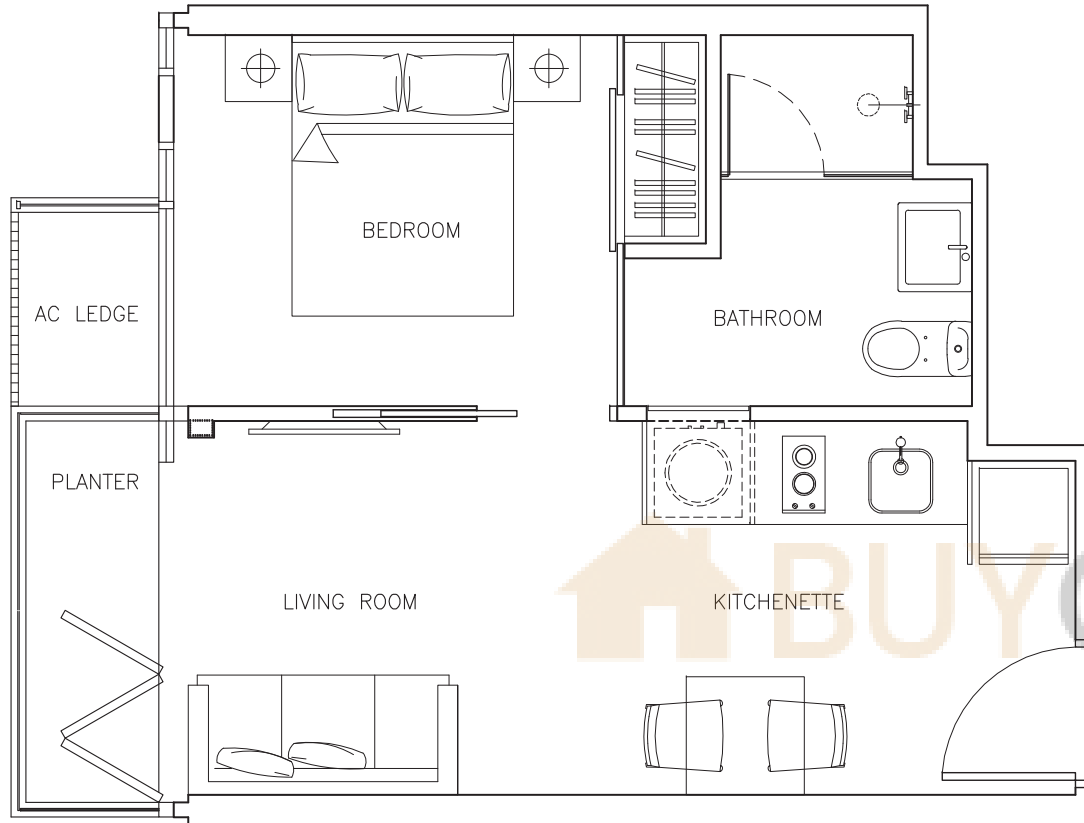

#03-02

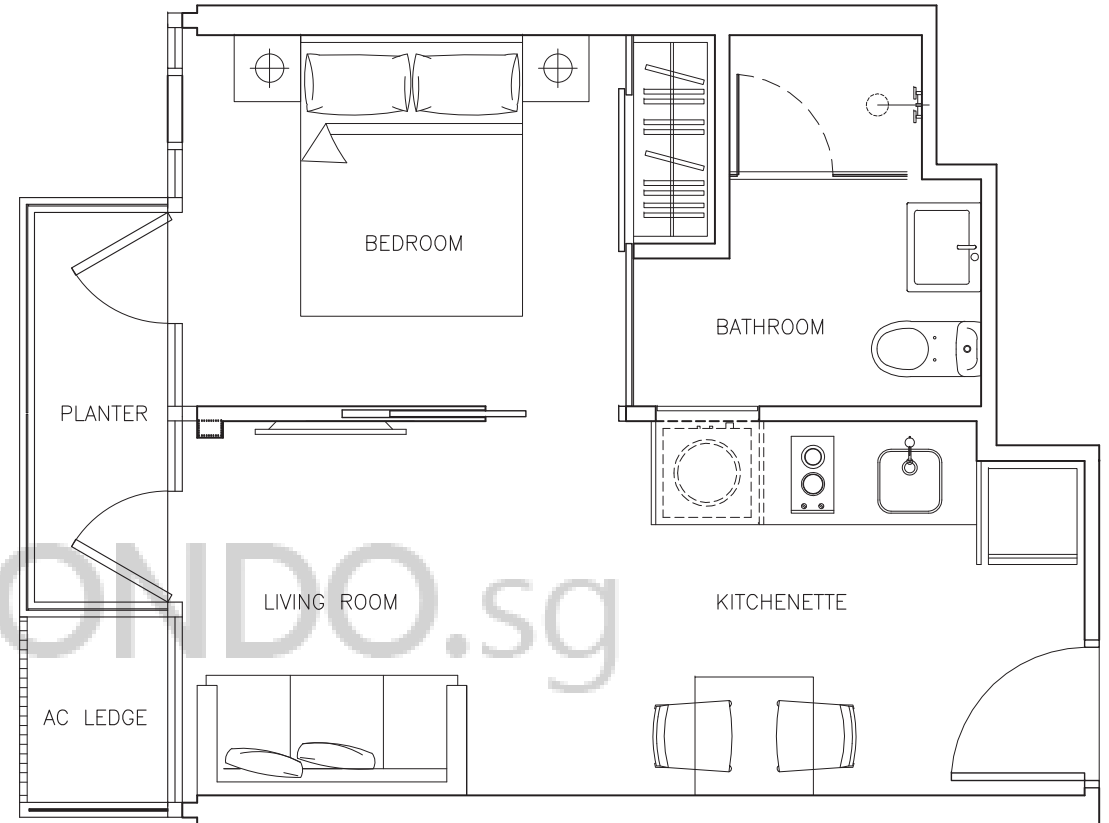

#02-02

**1 BEDROOM
TYPE 1B**

36 sq.m / 388 sq.ft

- Notes:
1. Areas includes PES / Roof Terraces (where applicable), AC Ledge, strata voids and planters
 2. All plans are not to scale and subject to change as may be approved by the relevant authorities

19 Tong Watt Road

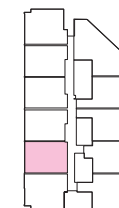

2ND & 3RD FLOOR



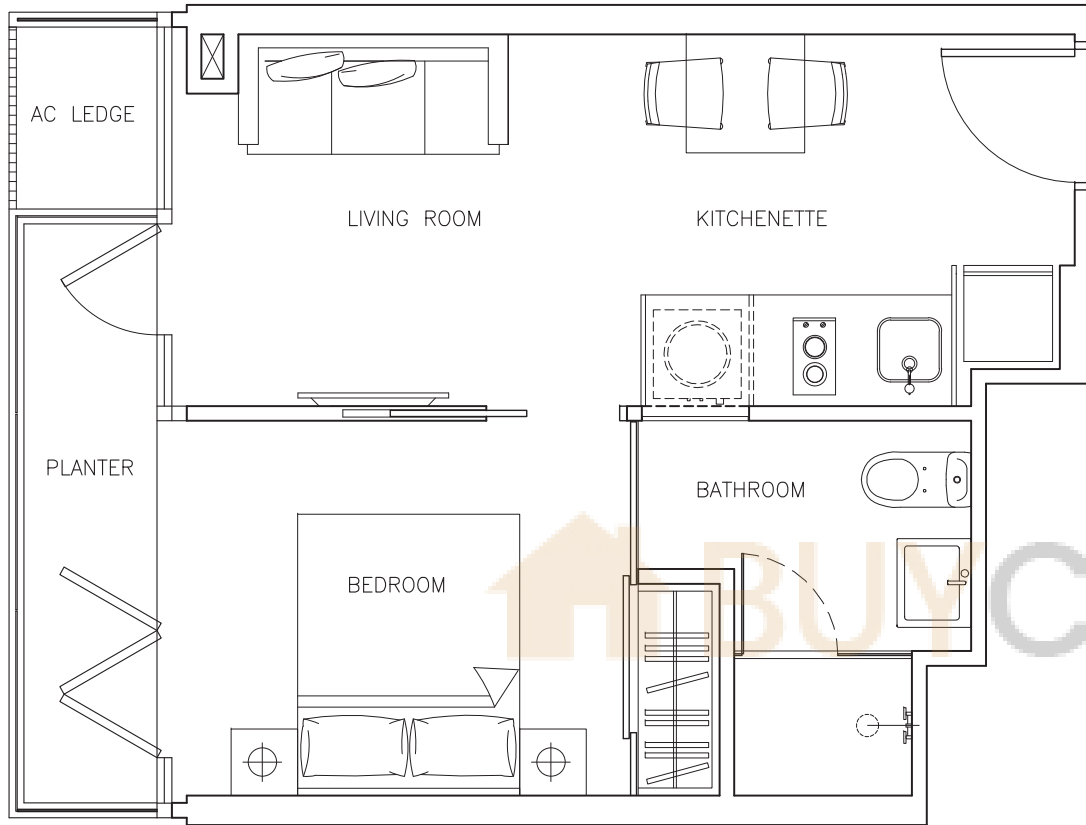

#03-05, #05-04, #07-04, #09-04

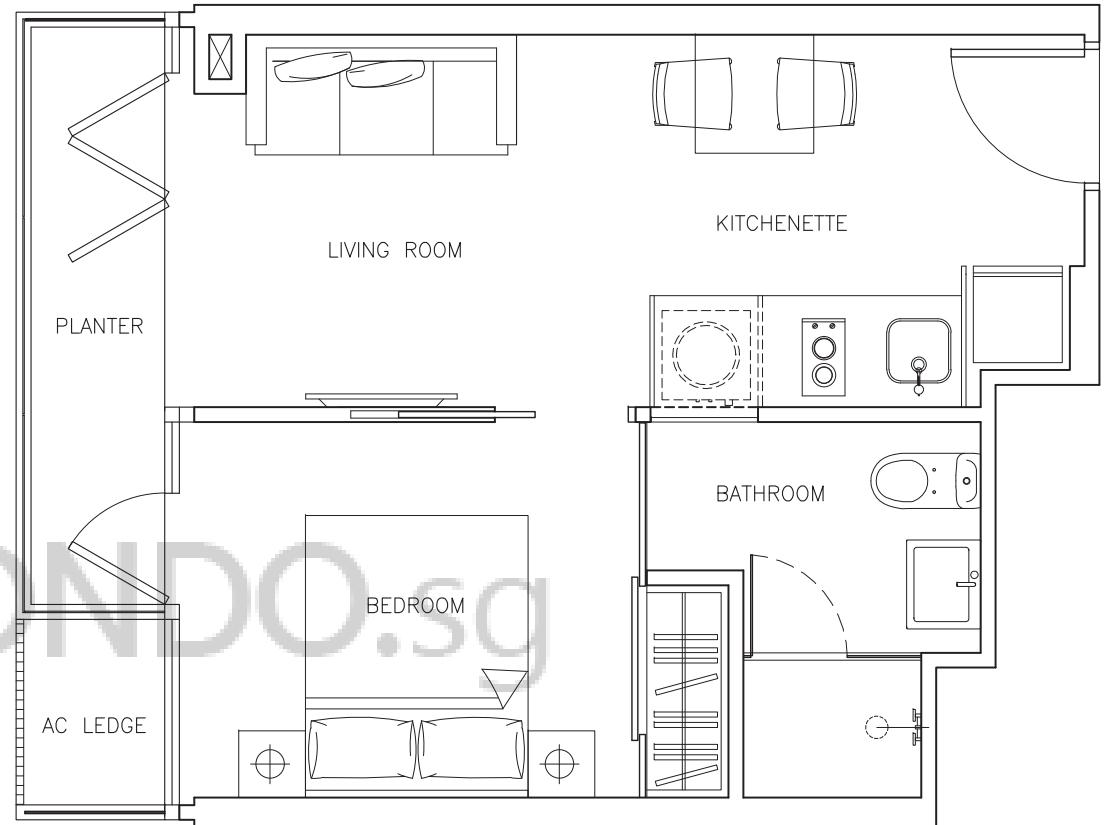

#02-05, #04-04, #06-04, #08-04

**1 BEDROOM
TYPE 1B1**

37 sq.m / 398 sq.ft

- Notes:
1. Areas includes PES / Roof Terraces (where applicable), AC Ledge, strata voids and planters
 2. All plans are not to scale and subject to change as may be approved by the relevant authorities

19 Tong Watt Road

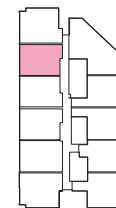

2ND & 3RD FLOOR

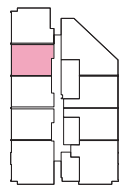

4TH-9TH FLOOR



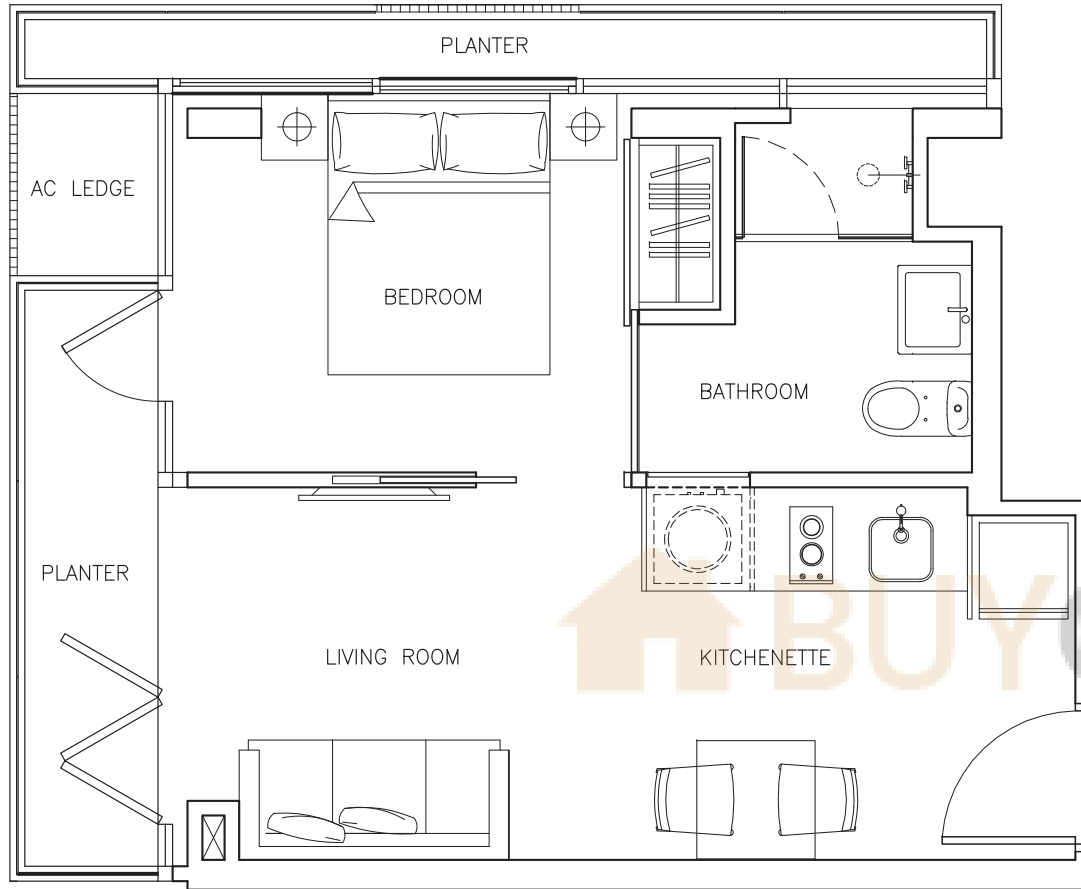

#03-06, #05-05, #07-05, #09-05

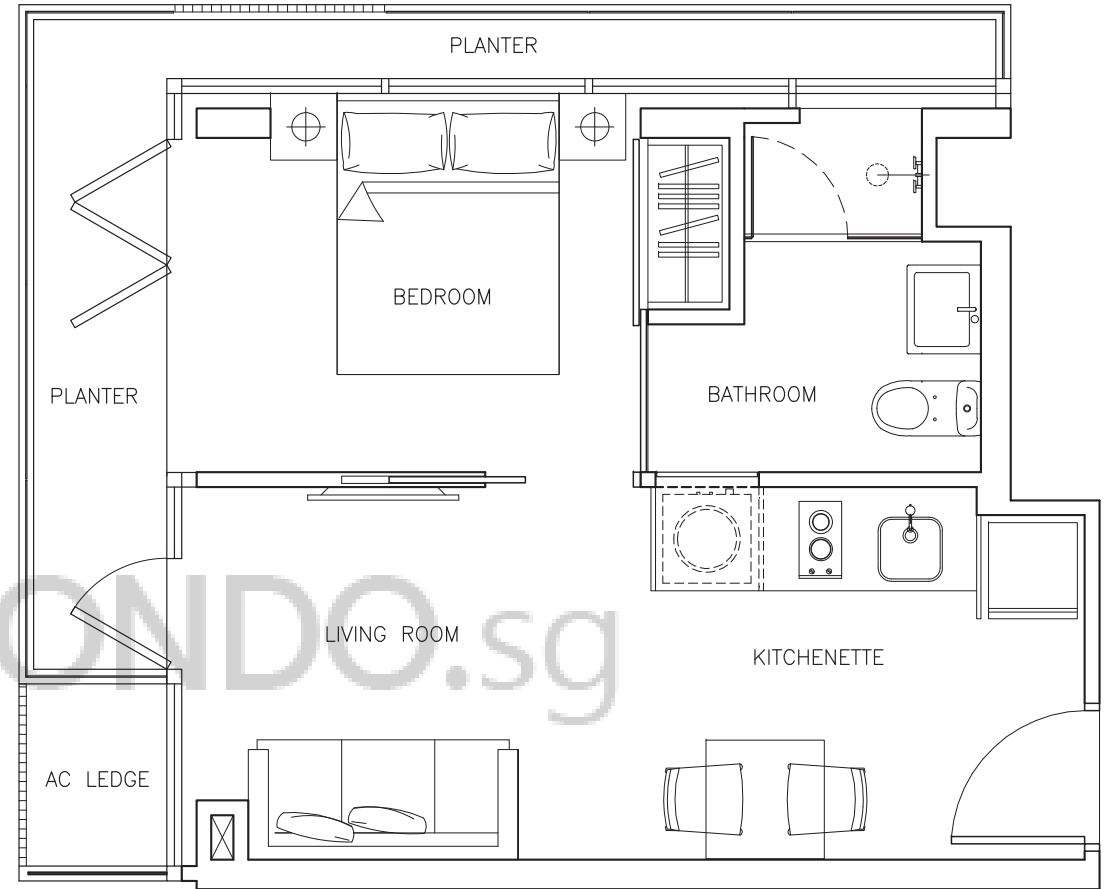

#02-06, #04-05, #06-05, #08-05

**1 BEDROOM
TYPE 1C**

41 sq.m / 441 sq.ft

- Notes:
1. Areas includes PES / Roof Terraces (where applicable), AC Ledge, strata voids and planters
 2. All plans are not to scale and subject to change as may be approved by the relevant authorities

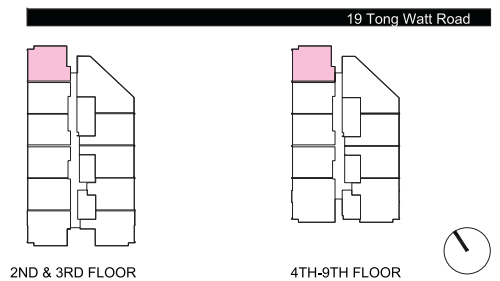

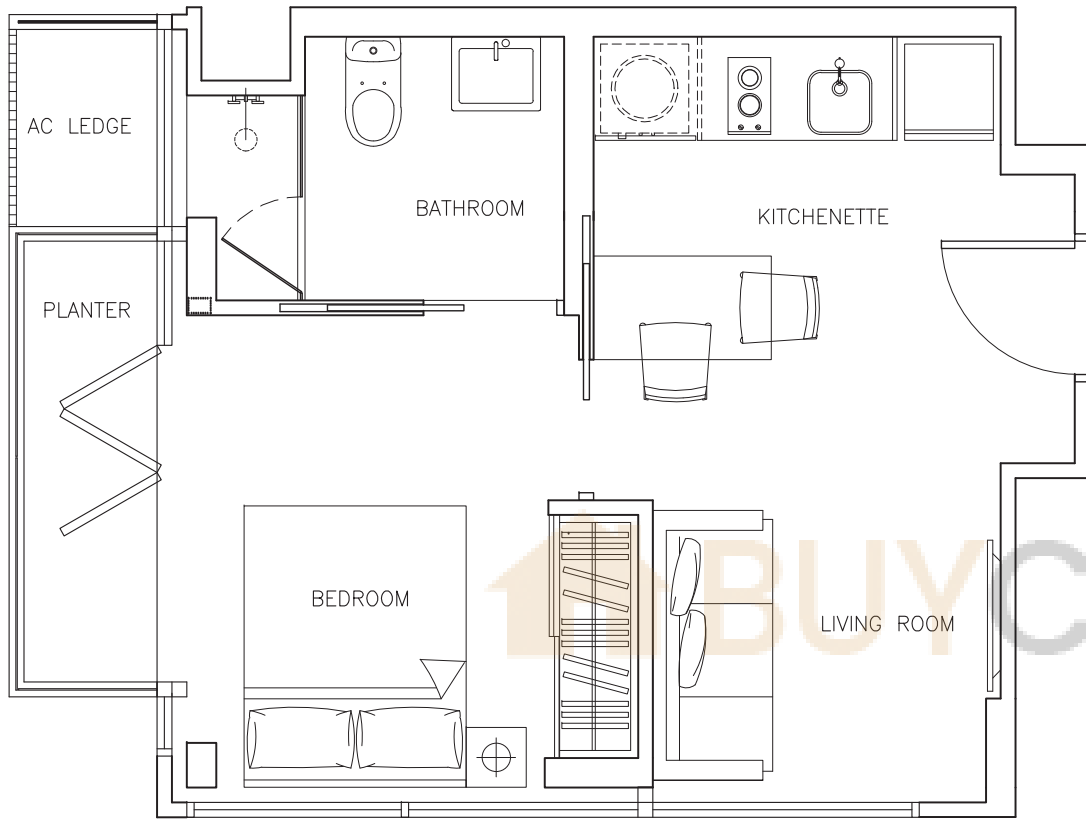

#03-01

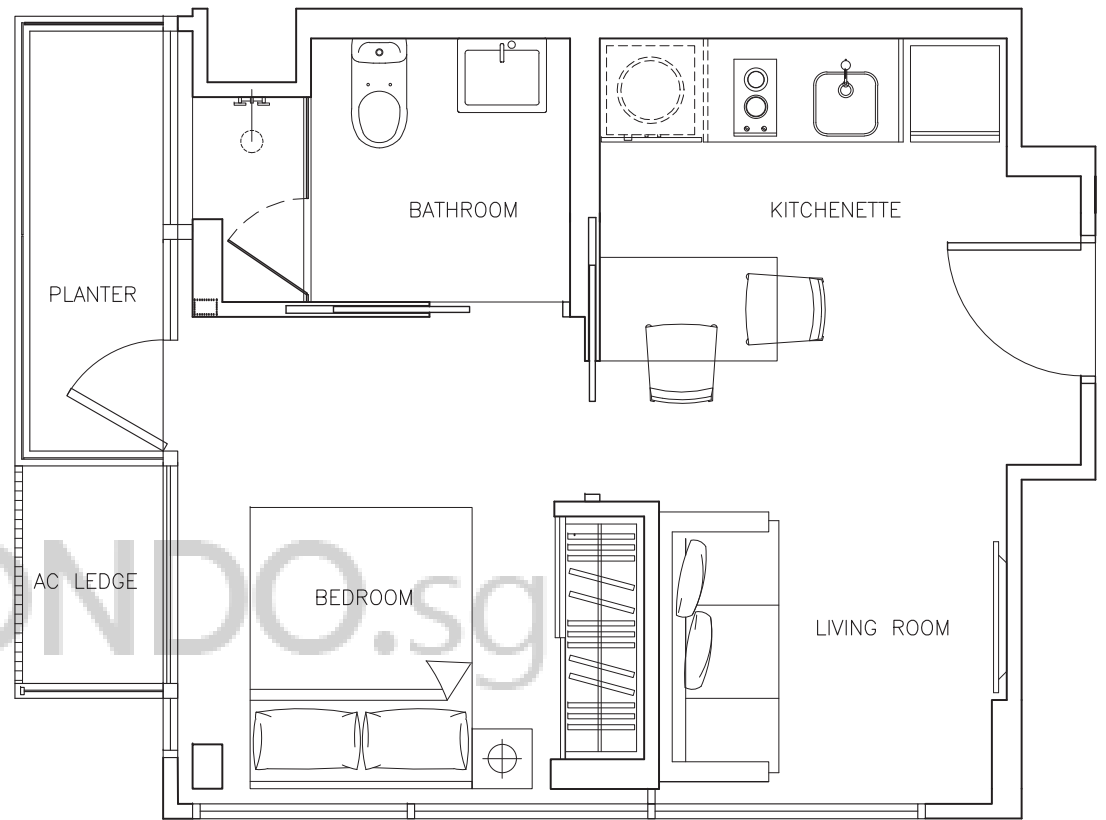

#02-01

**1 BEDROOM
TYPE 2A**

37 sq.m / 398 sq.ft

- Notes:
1. Areas includes PES / Roof Terraces (where applicable), AC Ledge, strata voids and planters
 2. All plans are not to scale and subject to change as may be approved by the relevant authorities

19 Tong Watt Road

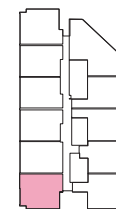

2ND & 3RD FLOOR



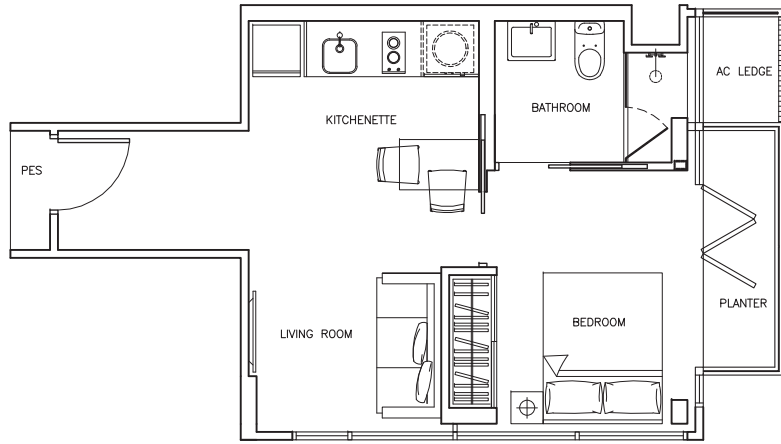

#03-07

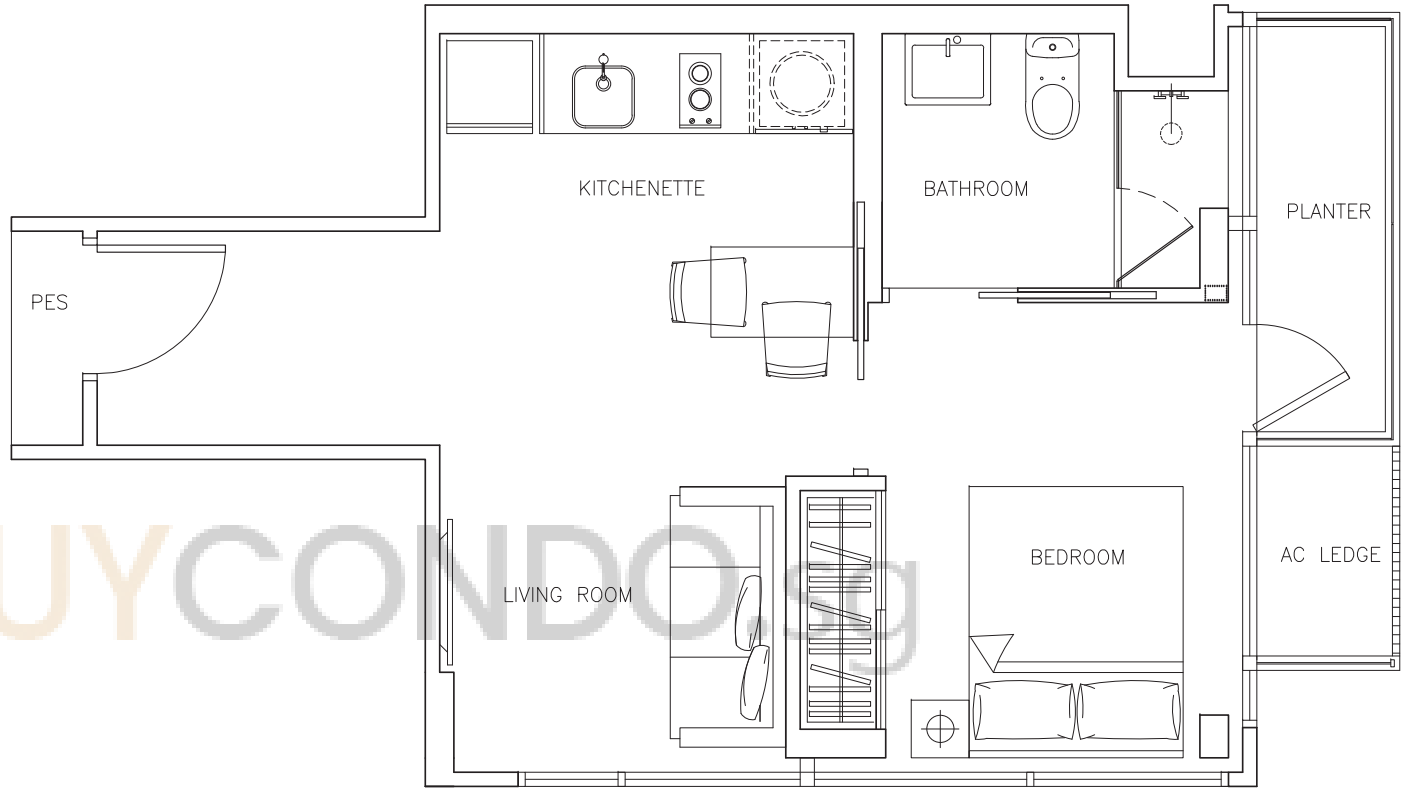

#02-07

BUYCONDO

19 Tong Watt Road

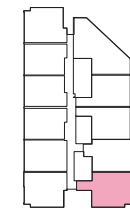

2ND & 3RD FLOOR



<p>1 BEDROOM TYPE 2B</p>	<p>41 sq.m / 441 sq.ft</p>	<p>Notes: 1. Areas includes PES / Roof Terraces (where applicable), AC Ledge, strata voids and planters 2. All plans are not to scale and subject to change as may be approved by the relevant authorities</p>
-------------------------------------	----------------------------	--

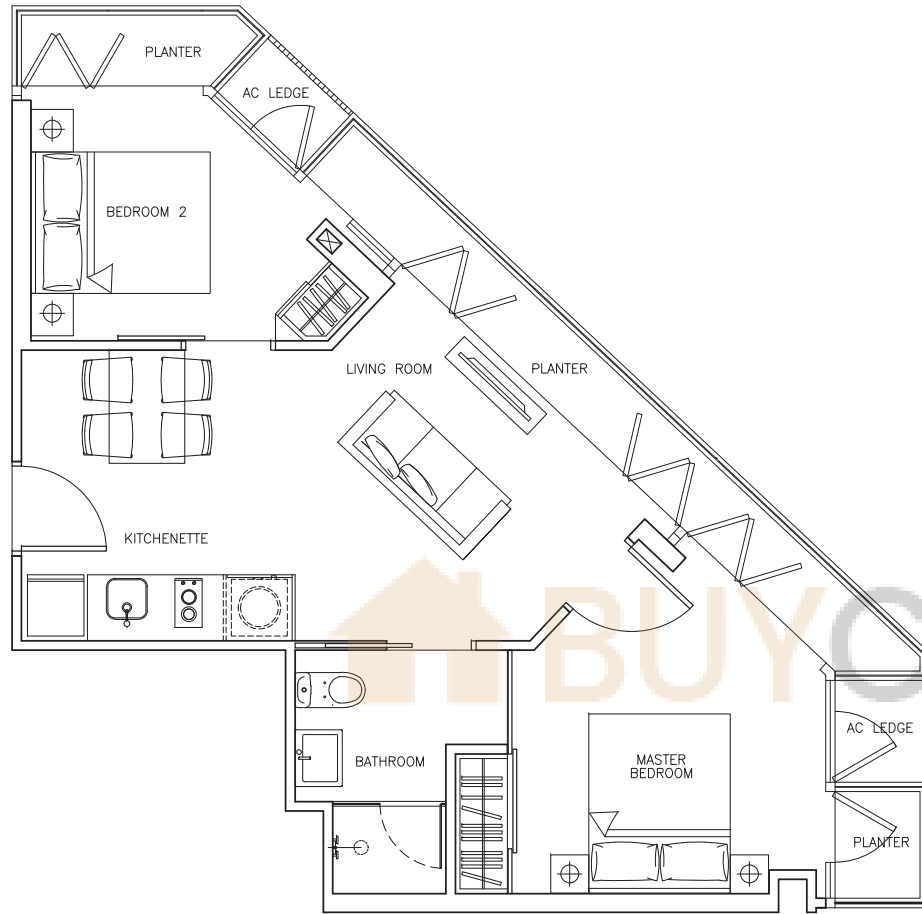

#03-11, #05-10, #07-10, #09-10

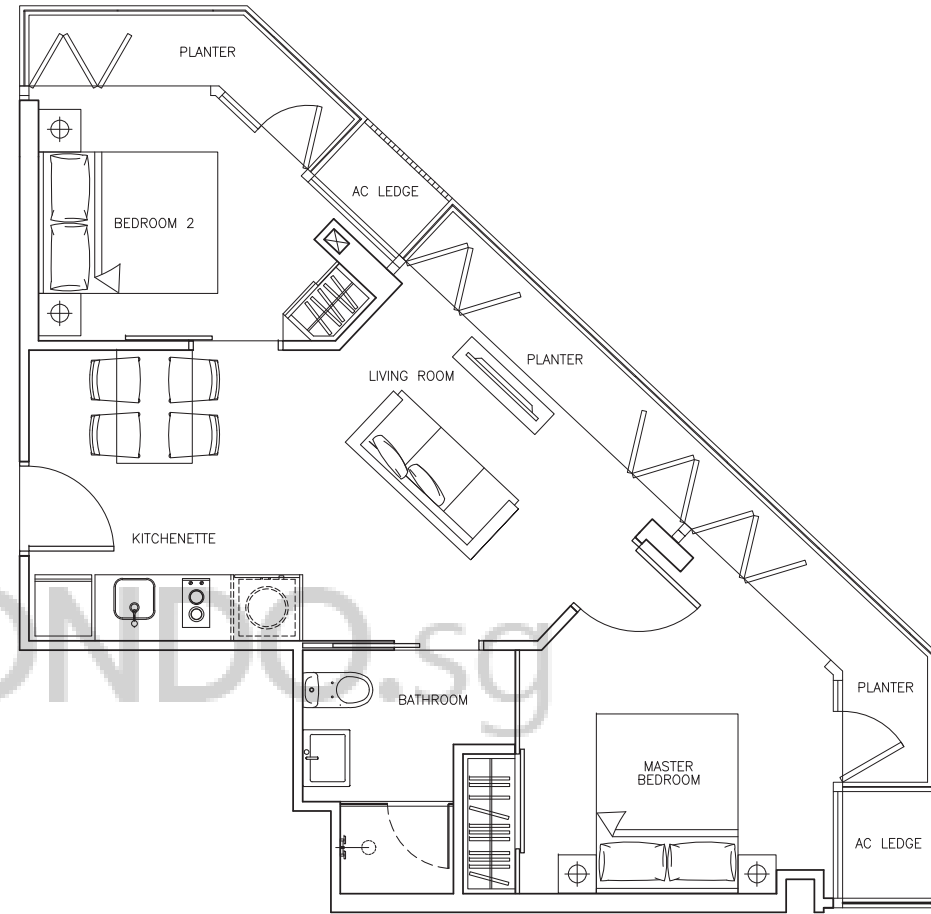

#02-11, #04-10, #06-10, #08-10

**2 BEDROOM
TYPE 3**

59 sq.m / 635 sq.ft

- Notes:
1. Areas includes PES / Roof Terraces (where applicable), AC Ledge, strata voids and planters
 2. All plans are not to scale and subject to change as may be approved by the relevant authorities

19 Tong Watt Road

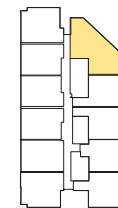

2ND & 3RD FLOOR

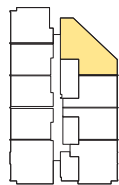

4TH-9TH FLOOR



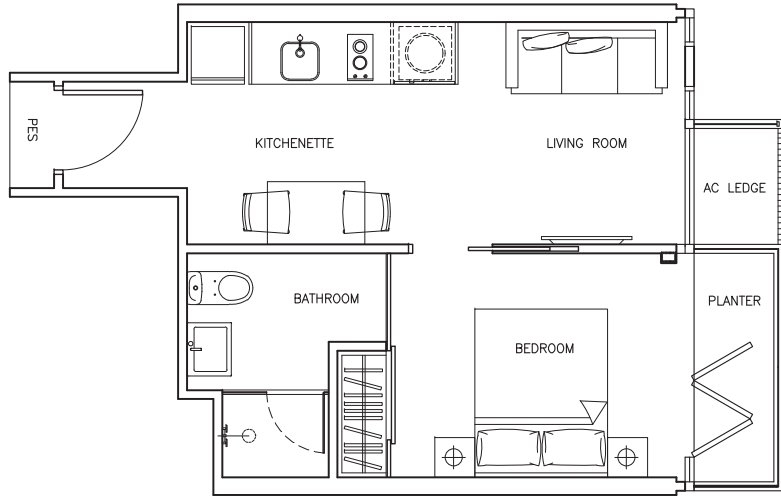

#03-08

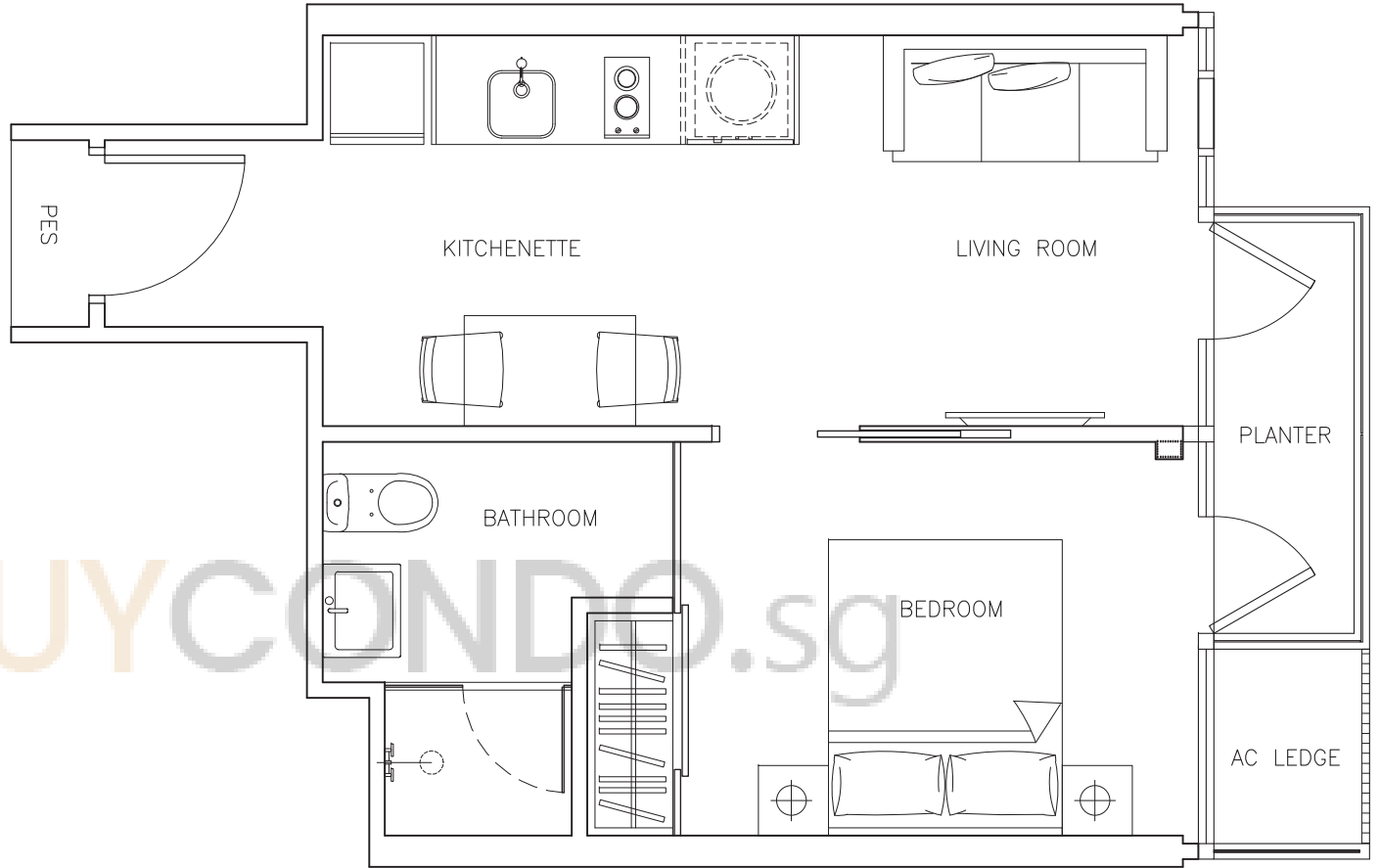

#02-08

BUYCONDO.SG

19 Tong Watt Road

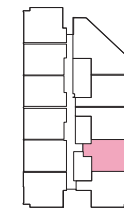

2ND & 3RD FLOOR



<p>1 BEDROOM TYPE 4A</p>	<p>39 sq.m / 420 sq.ft</p>	<p>Notes: 1. Areas includes PES / Roof Terraces (where applicable), AC Ledge, strata voids and planters 2. All plans are not to scale and subject to change as may be approved by the relevant authorities</p>
-------------------------------------	----------------------------	--

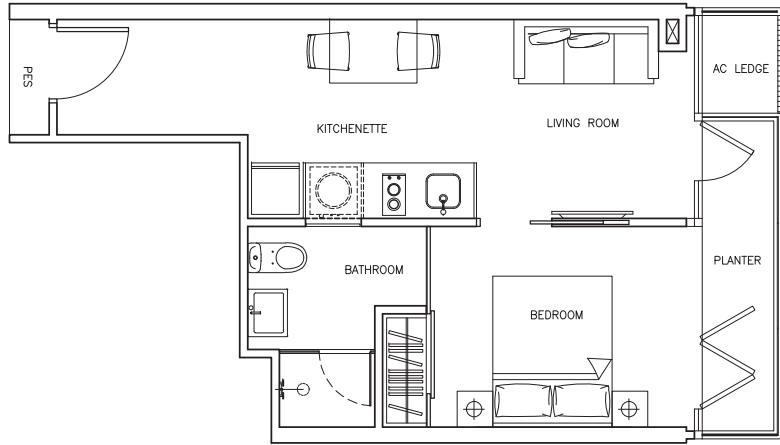

#03-09, #03-10, #05-08, #05-09, #07-08, #07-09, #09-08, #09-09

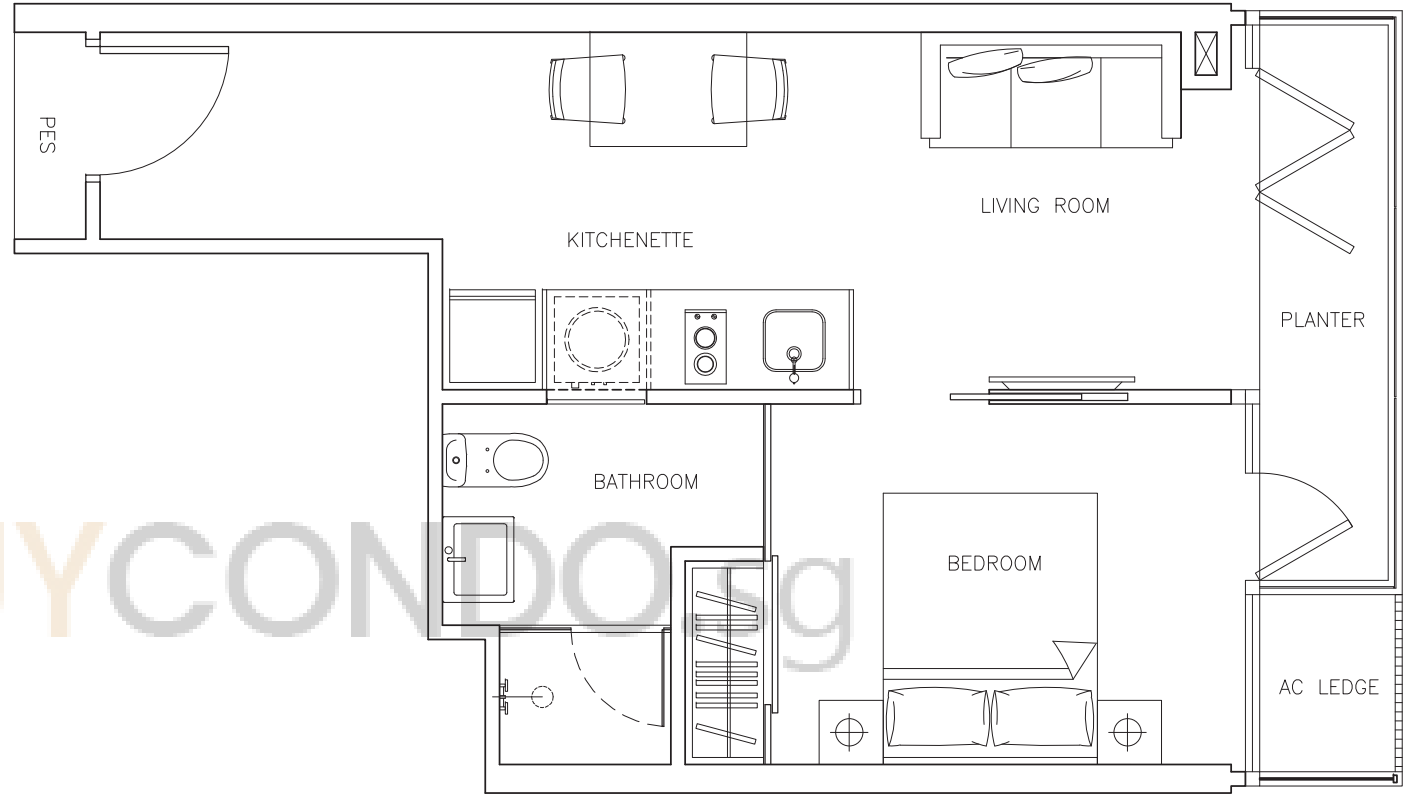

#02-09, #02-10, #04-08, #04-09, #06-08, #06-09, #08-08, #08-09



<p>1 BEDROOM TYPE 4B</p>	<p>42 sq.m / 452 sq.ft</p>	<p>Notes: 1. Areas includes PES / Roof Terraces (where applicable), AC Ledge, strata voids and planters 2. All plans are not to scale and subject to change as may be approved by the relevant authorities</p>
-------------------------------------	----------------------------	--

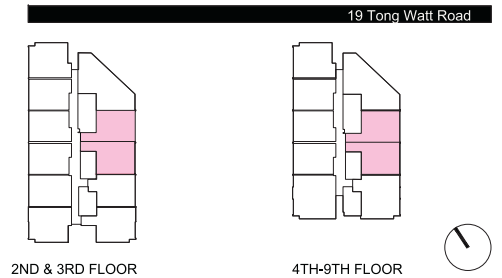

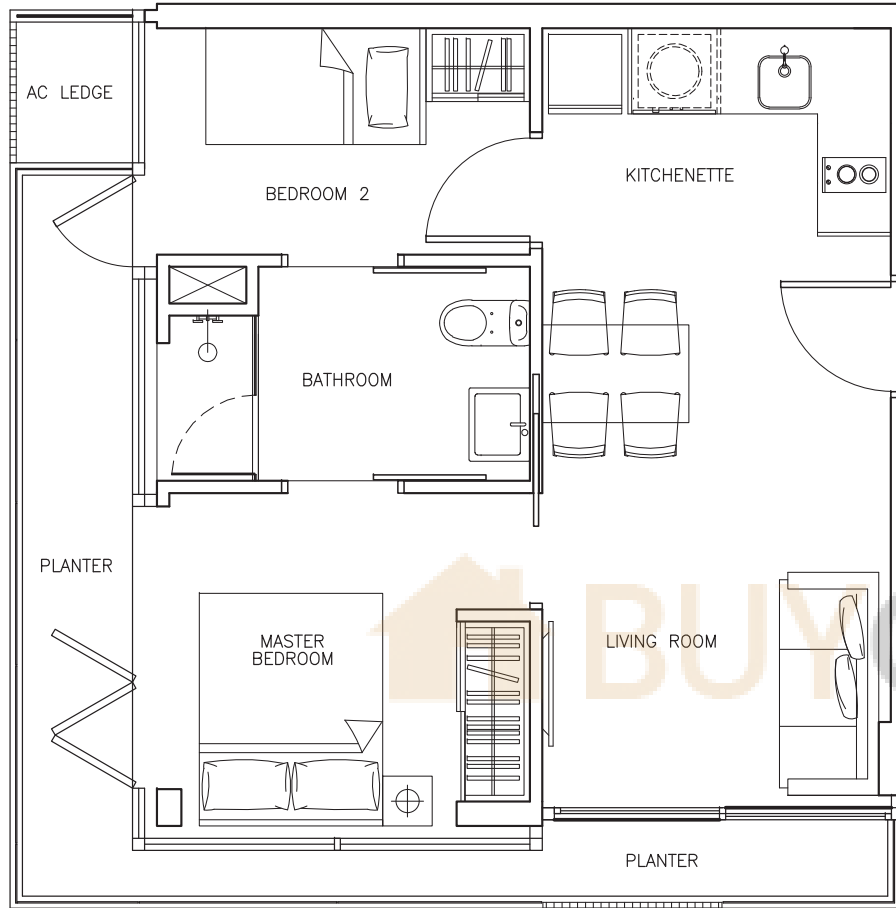

#05-01, #07-01, #09-01

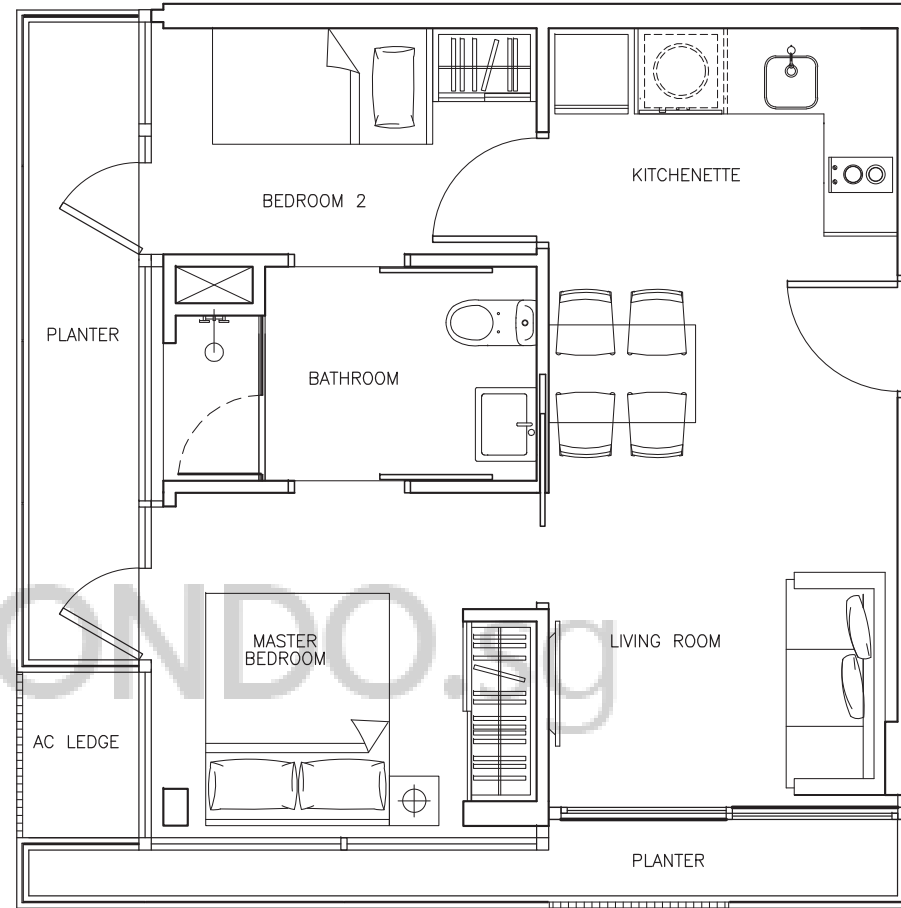

#06-01, #08-01

**2 BEDROOM
TYPE 5A**

53 sq.m / 570 sq.ft

- Notes:
1. Areas includes PES / Roof Terraces (where applicable), AC Ledge, strata voids and planters
 2. All plans are not to scale and subject to change as may be approved by the relevant authorities

19 Tong Watt Road

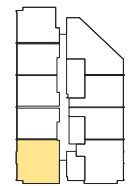

5TH-9TH FLOOR



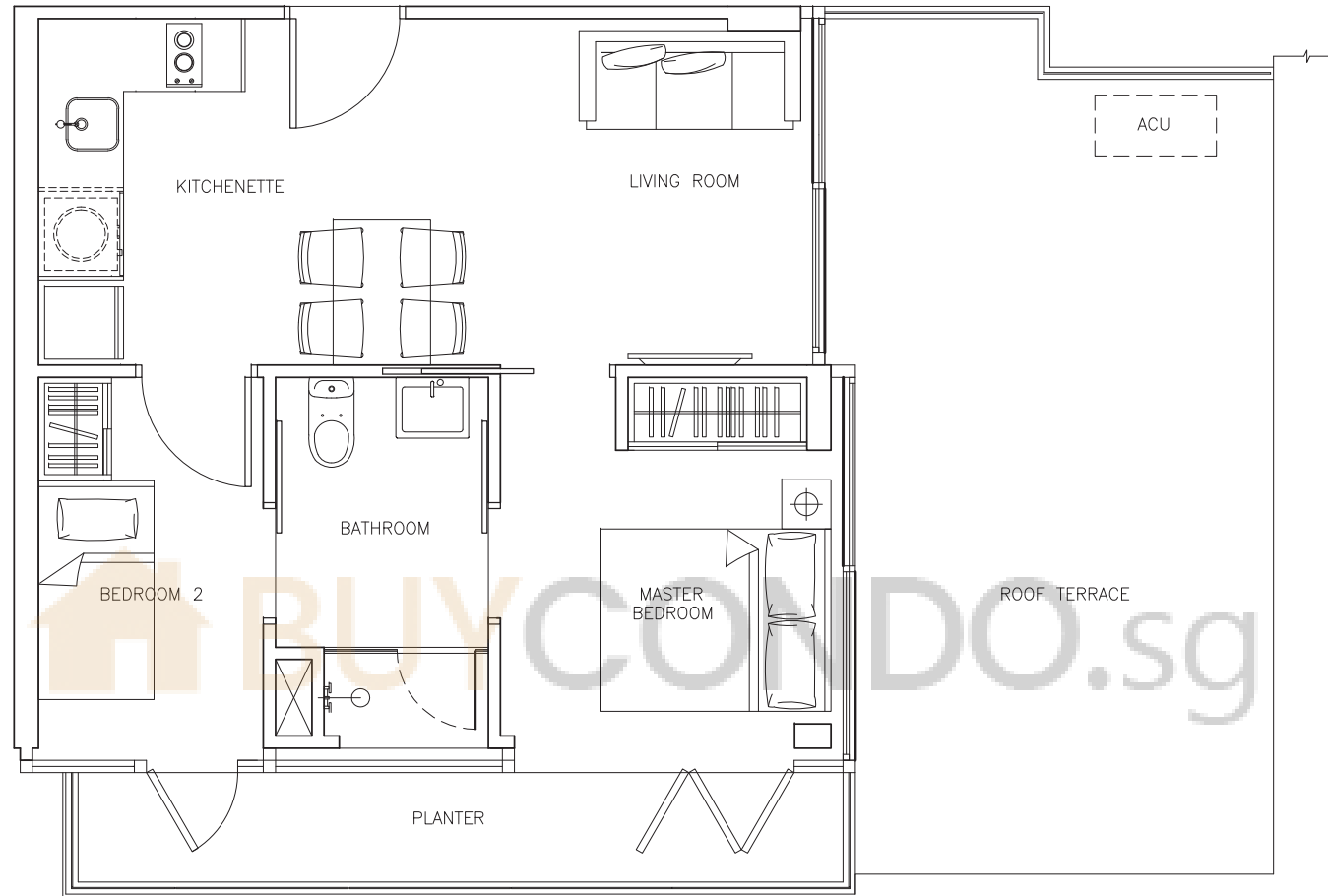

#04-01

19 Tong Watt Road

<p>2 BEDROOM TYPE 5AT</p>	<p>75 sq.m / 807 sq.ft</p>	<p>Notes: 1. Areas includes PES / Roof Terraces (where applicable), AC Ledge, strata voids and planters 2. All plans are not to scale and subject to change as may be approved by the relevant authorities</p>
--------------------------------------	----------------------------	--

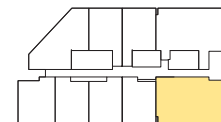

4TH FLOOR



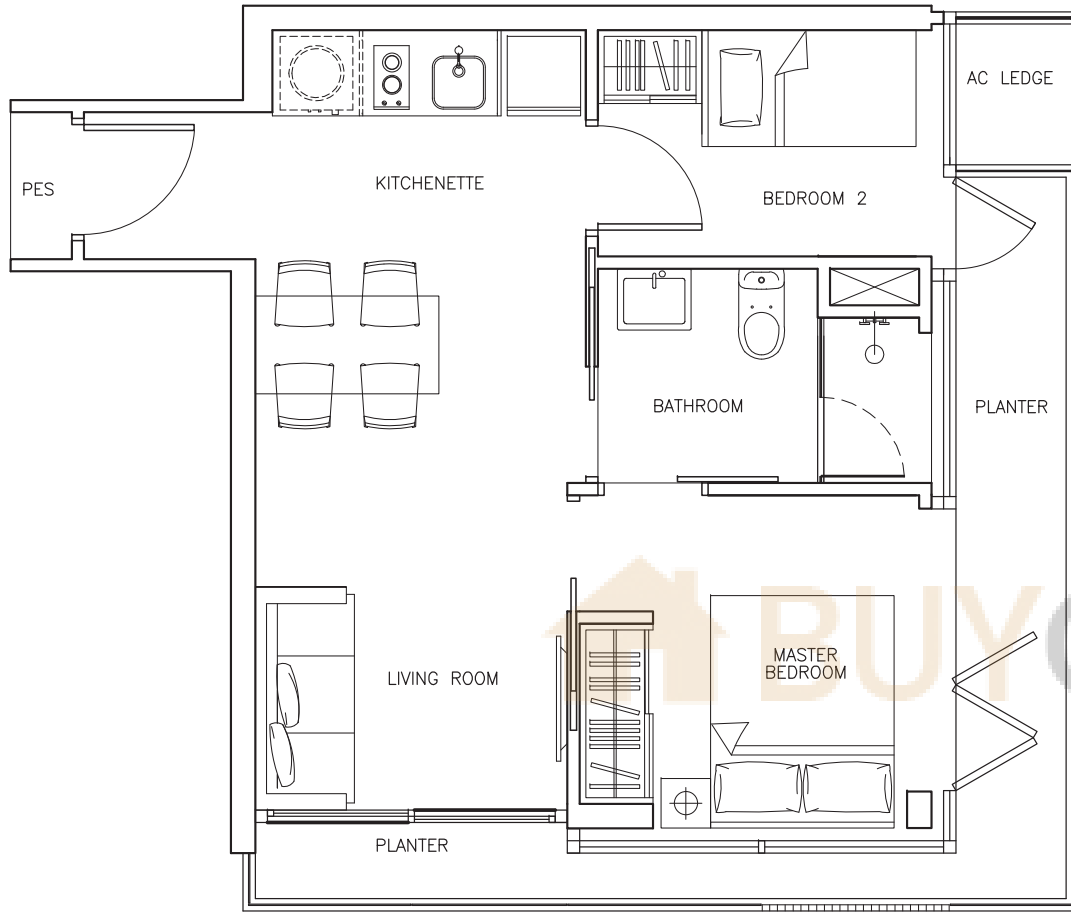

#05-07, #07-07, #09-07

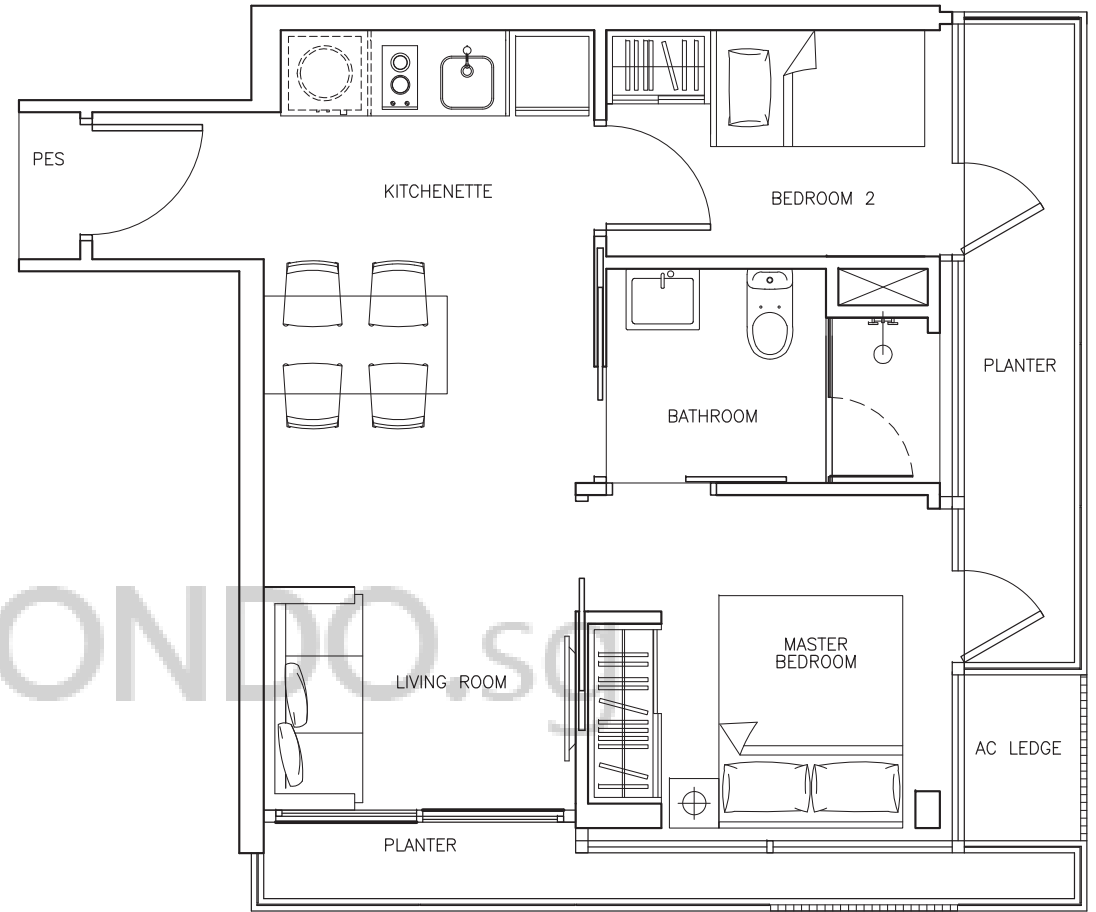

#06-07, #08-07

**2 BEDROOM
TYPE 5B**

53 sq.m / 570 sq.ft

- Notes:
1. Areas includes PES / Roof Terraces (where applicable), AC Ledge, strata voids and planters
 2. All plans are not to scale and subject to change as may be approved by the relevant authorities

19 Tong Watt Road

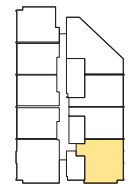

5TH-9TH FLOOR



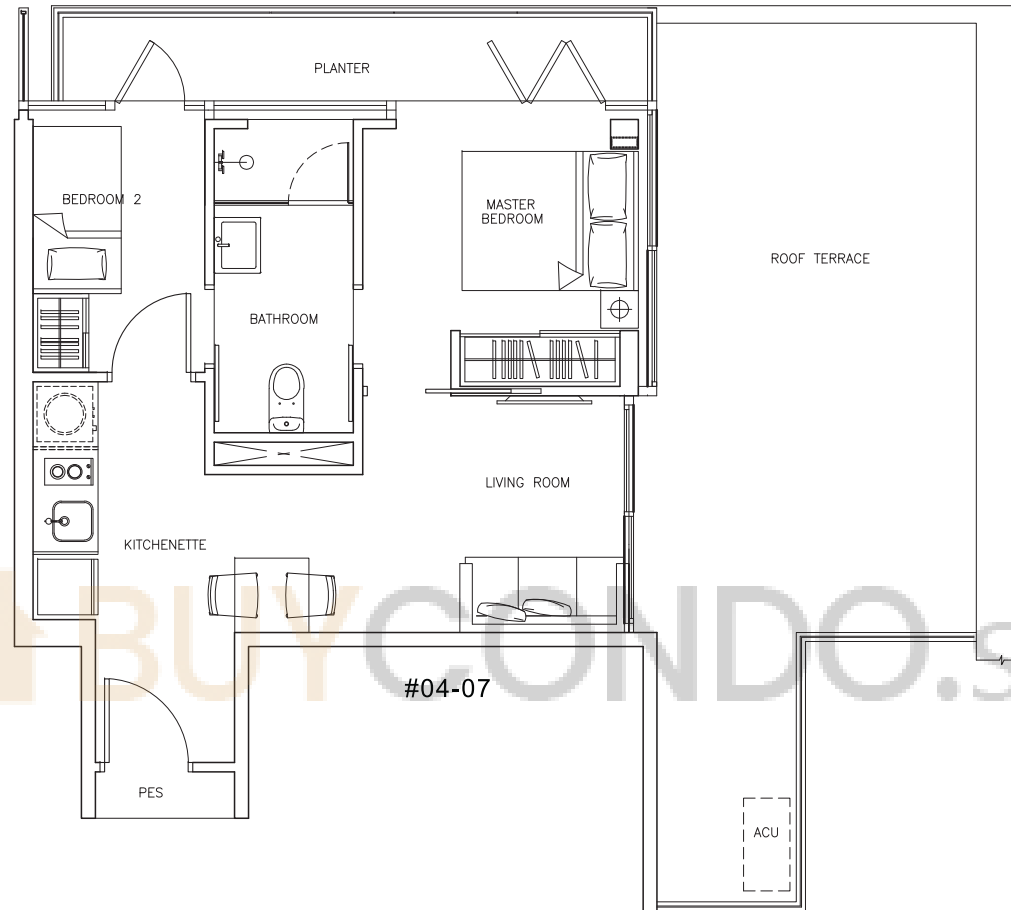

BUYCONDO.SG

19 Tong Watt Road

<p>2 BEDROOM TYPE 5BT</p>	<p>79 sq.m / 850 sq.ft</p>	<p>Notes: 1. Areas includes PES / Roof Terraces (where applicable), AC Ledge, strata voids and planters 2. All plans are not to scale and subject to change as may be approved by the relevant authorities</p>
--------------------------------------	----------------------------	--



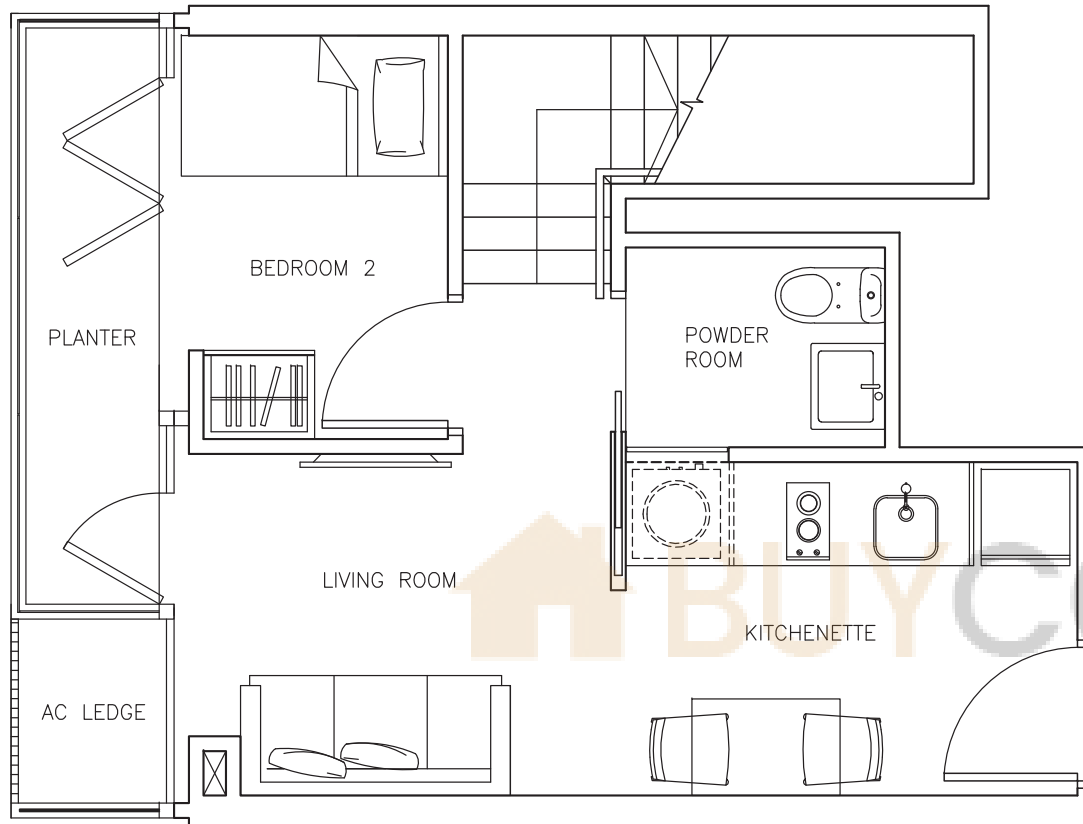

LOWER PENTHOUSE
#10-02, #10-03

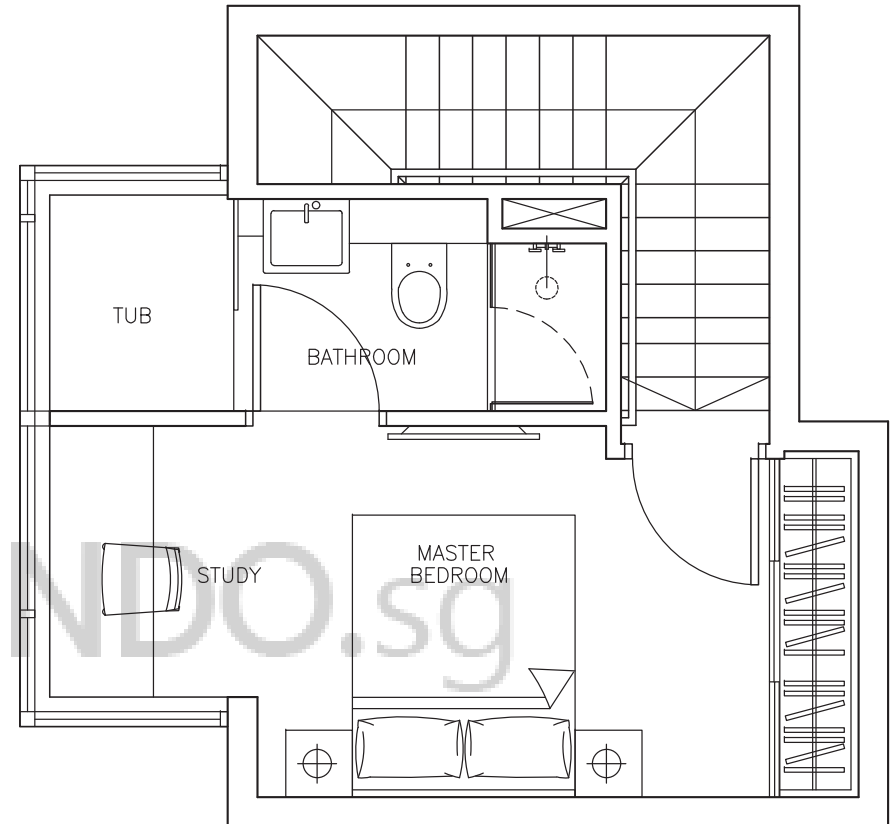

UPPER PENTHOUSE

PENTHOUSE 2 BEDROOM + STUDY
TYPE PH1A

62 sq.m / 667 sq.ft

- Notes:
1. Areas includes PES / Roof Terraces (where applicable), AC Ledge, strata voids and planters
 2. All plans are not to scale and subject to change as may be approved by the relevant authorities

19 Tong Watt Road

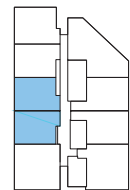

10TH & ATTIC FLOOR



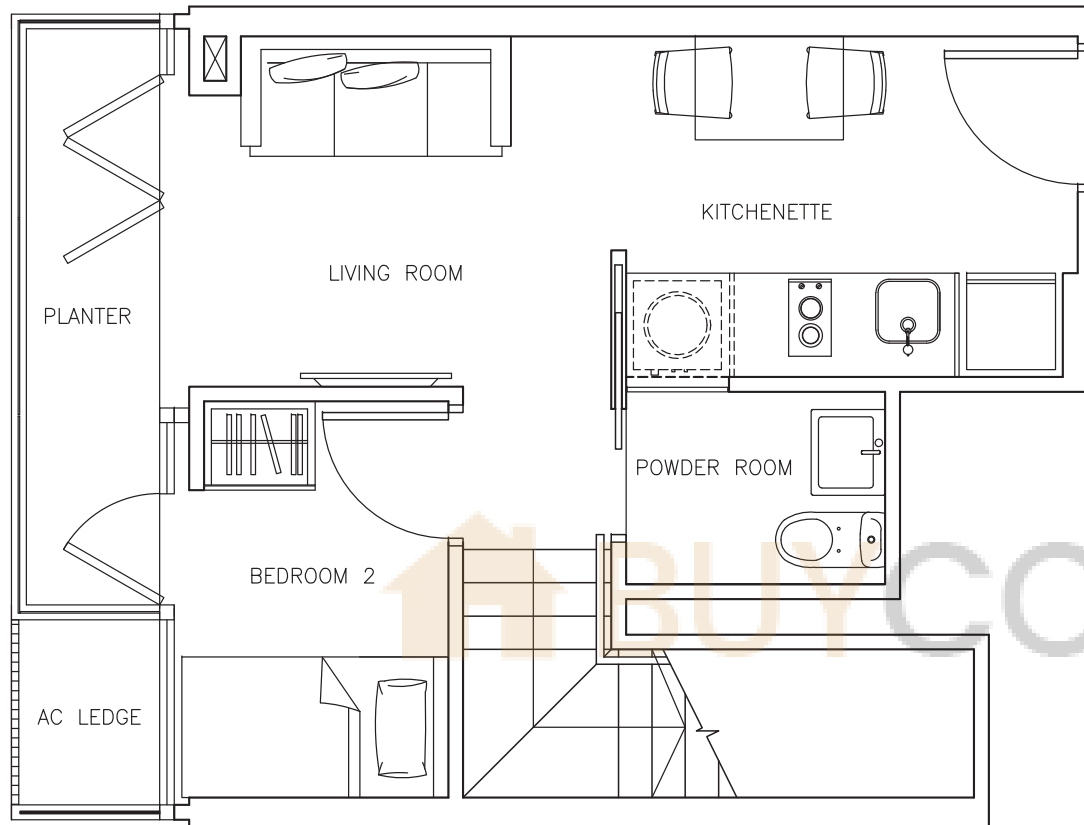

LOWER PENTHOUSE
#10-04

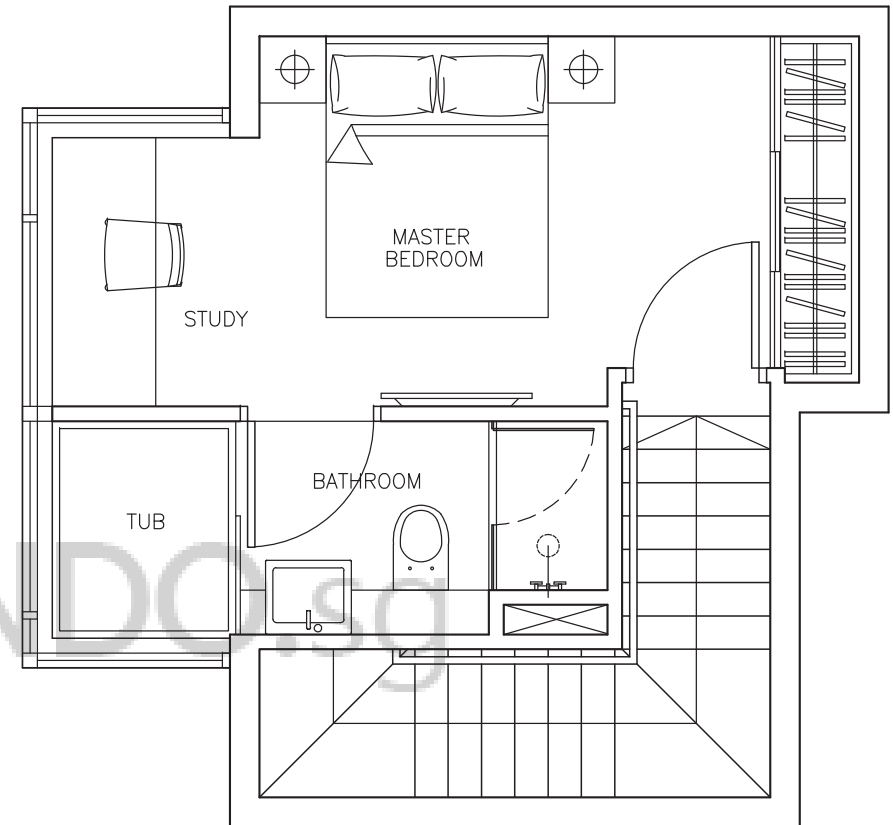

UPPER PENTHOUSE

PENTHOUSE 2 BEDROOM + STUDY
TYPE PH1B1

62 sq.m / 667 sq.ft

- Notes:
1. Areas includes PES / Roof Terraces (where applicable), AC Ledge, strata voids and planters
 2. All plans are not to scale and subject to change as may be approved by the relevant authorities

19 Tong Watt Road

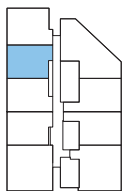

10TH & ATTIC FLOOR



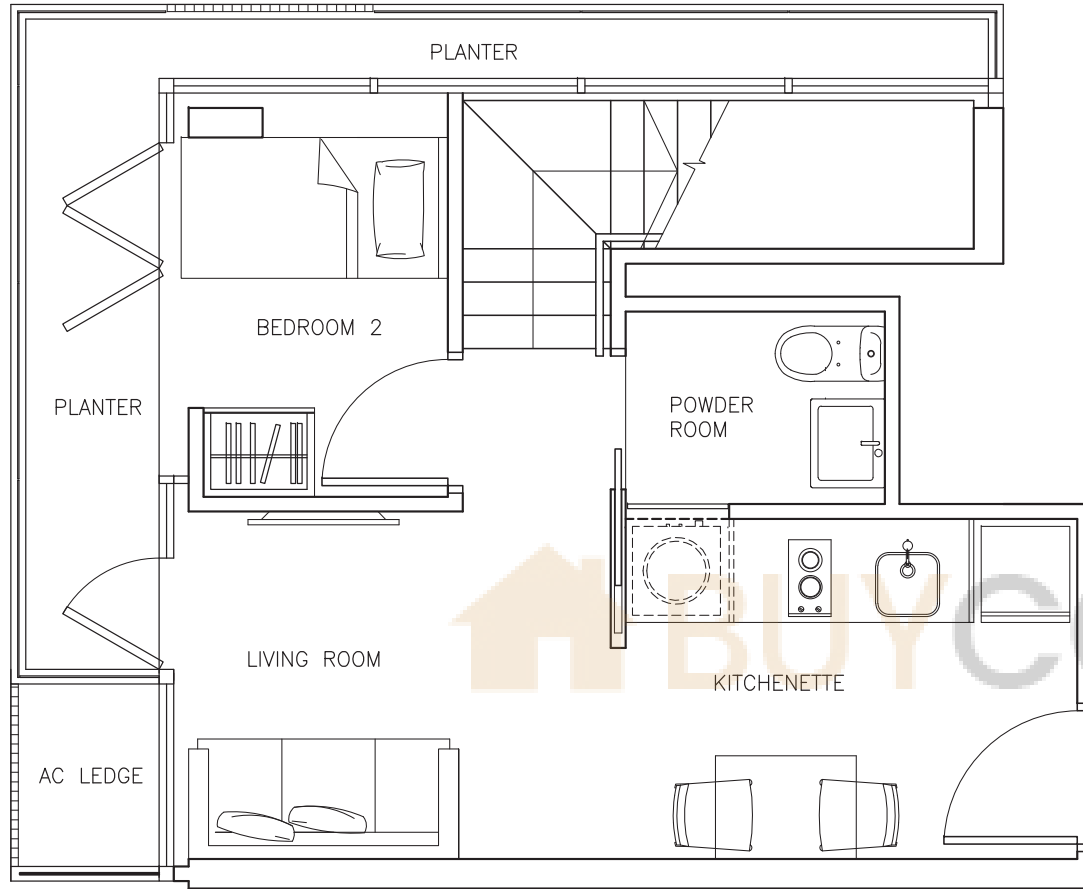

LOWER PENTHOUSE
#10-05

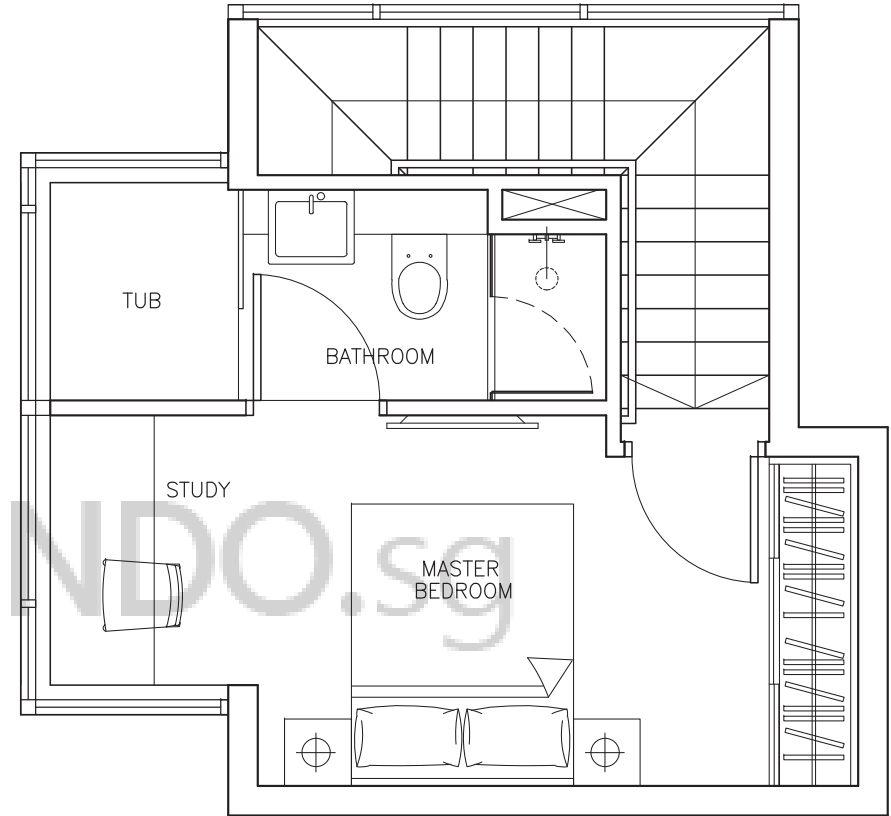

UPPER PENTHOUSE

PENTHOUSE 2 BEDROOM + STUDY
TYPE PH1C

65 sq.m / 700 sq.ft

- Notes:
1. Areas includes PES / Roof Terraces (where applicable), AC Ledge, strata voids and planters
 2. All plans are not to scale and subject to change as may be approved by the relevant authorities

19 Tong Watt Road

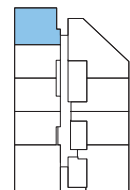

10TH & ATTIC FLOOR



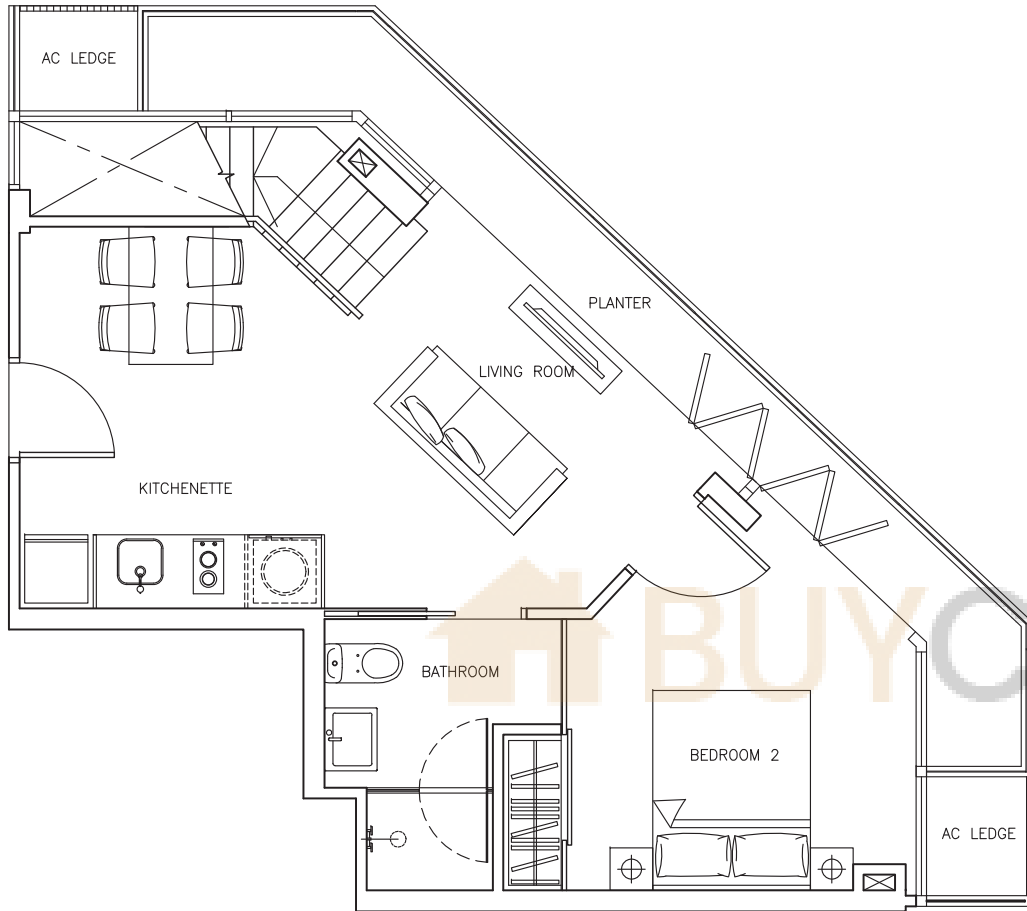

LOWER PENTHOUSE
#10-10

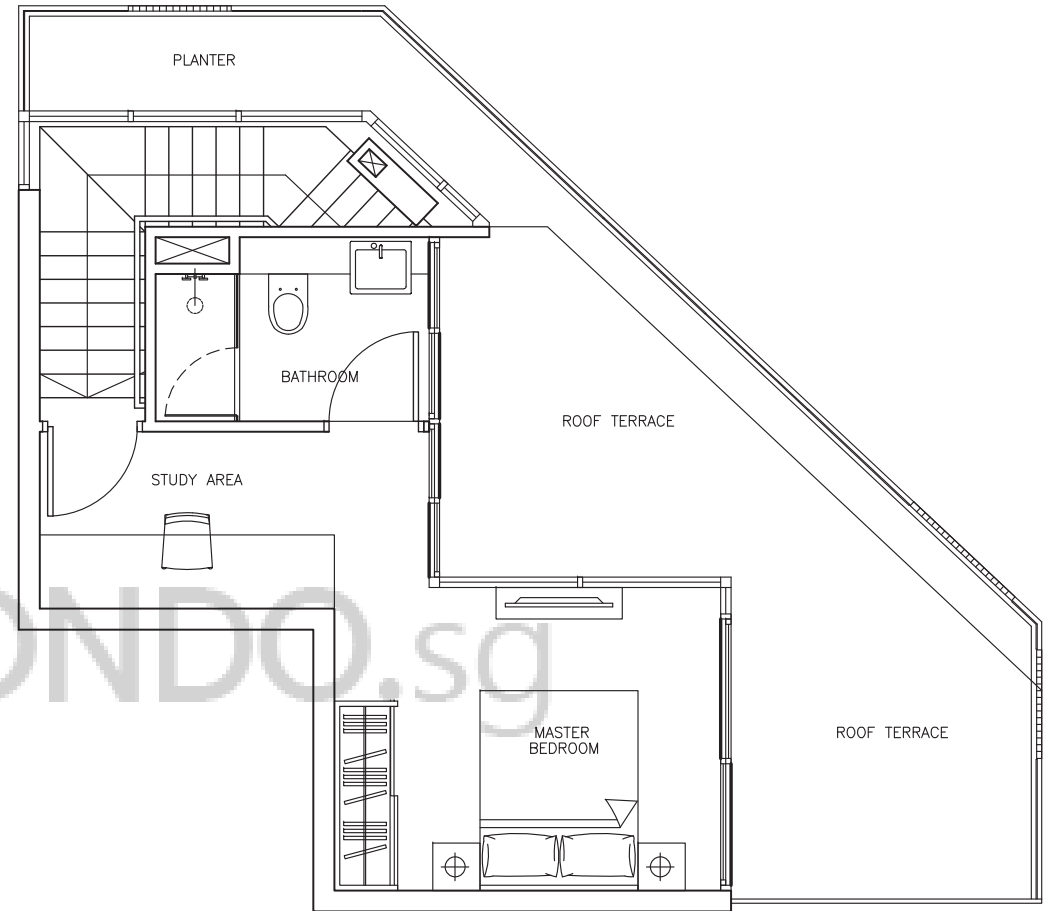

UPPER PENTHOUSE

PENTHOUSE 2 BEDROOM + STUDY
TYPE PH3

114 sq.m / 1227 sq.ft

Notes:

1. Areas includes PES / Roof Terraces (where applicable), AC Ledge, strata voids and planters
2. All plans are not to scale and subject to change as may be approved by the relevant authorities

19 Tong Watt Road

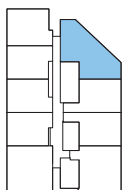

10TH & ATTIC FLOOR



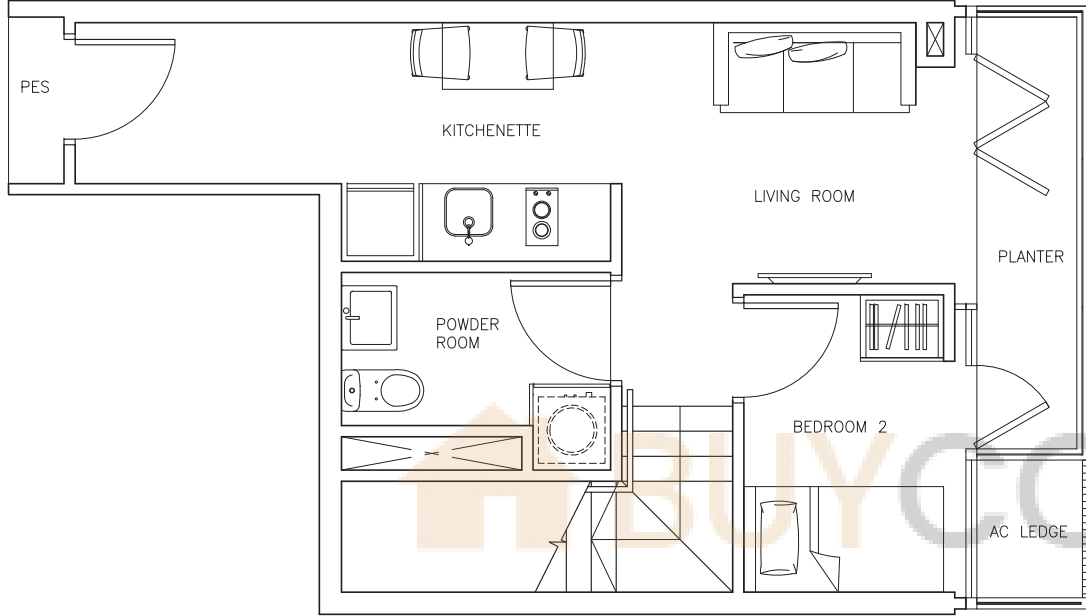

LOWER PENTHOUSE
#10-08, #10-09

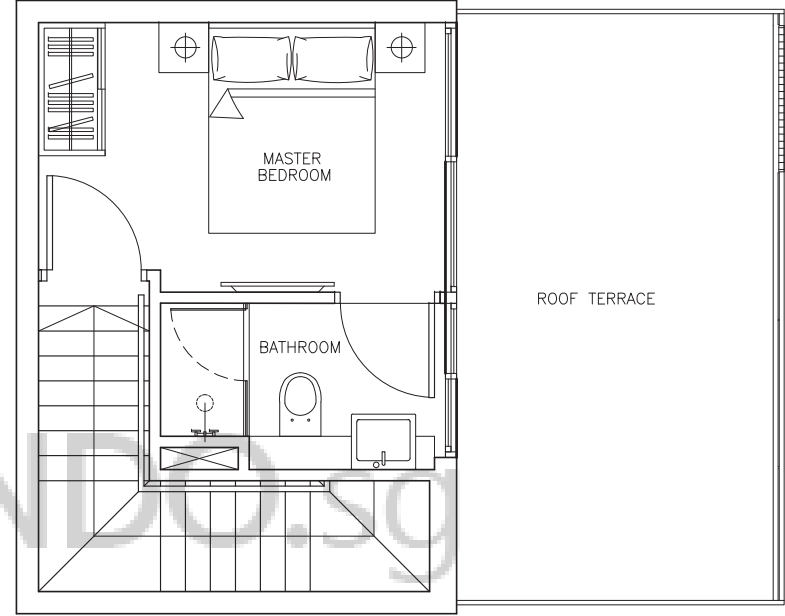

UPPER PENTHOUSE

PENTHOUSE 2 BEDROOM
TYPE PH4

77 sq.m / 829 sq.ft

- Notes:
1. Areas includes PES / Roof Terraces (where applicable), AC Ledge, strata voids and planters
 2. All plans are not to scale and subject to change as may be approved by the relevant authorities

19 Tong Watt Road

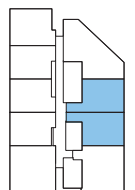

10TH & ATTIC FLOOR



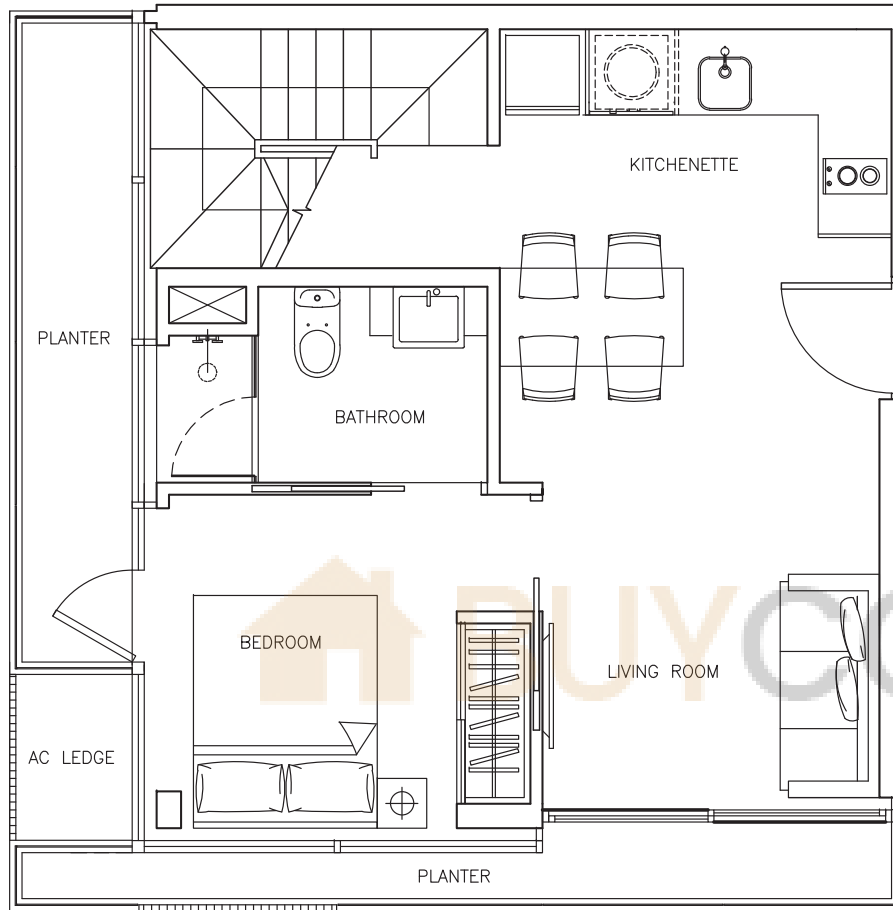

LOWER PENTHOUSE
#10-01

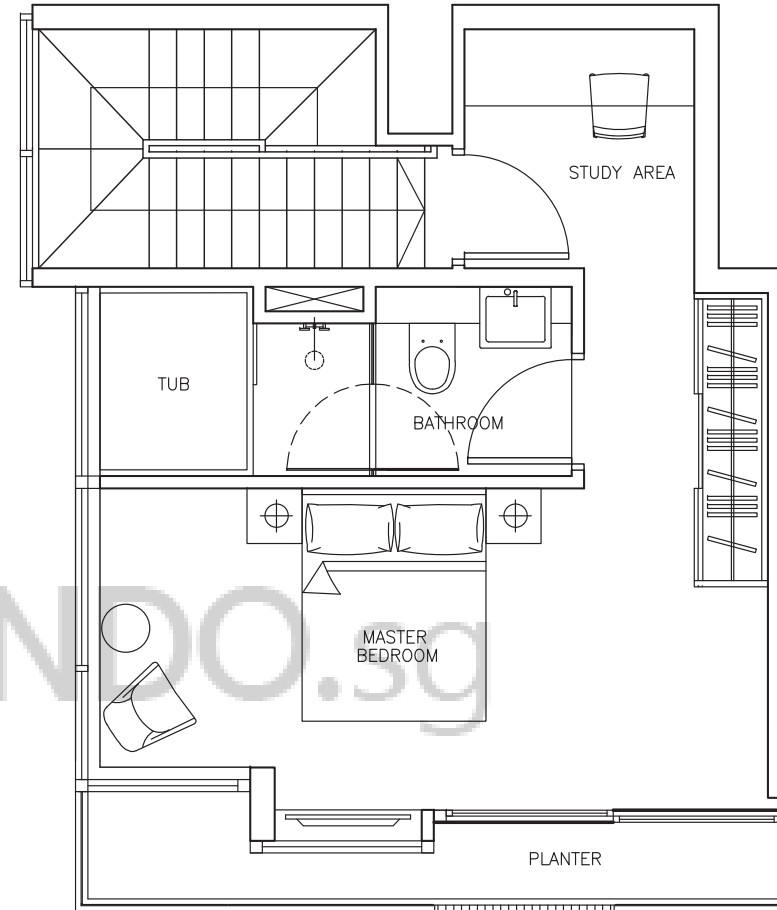

UPPER PENTHOUSE

19 Tong Watt Road

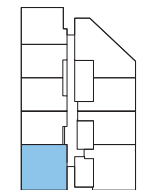

10TH & ATTIC FLOOR



PENTHOUSE 2 BEDROOM + STUDY
TYPE PH5A

92 sq.m / 990 sq.ft

- Notes:
1. Areas includes PES / Roof Terraces (where applicable), AC Ledge, strata voids and planters
 2. All plans are not to scale and subject to change as may be approved by the relevant authorities

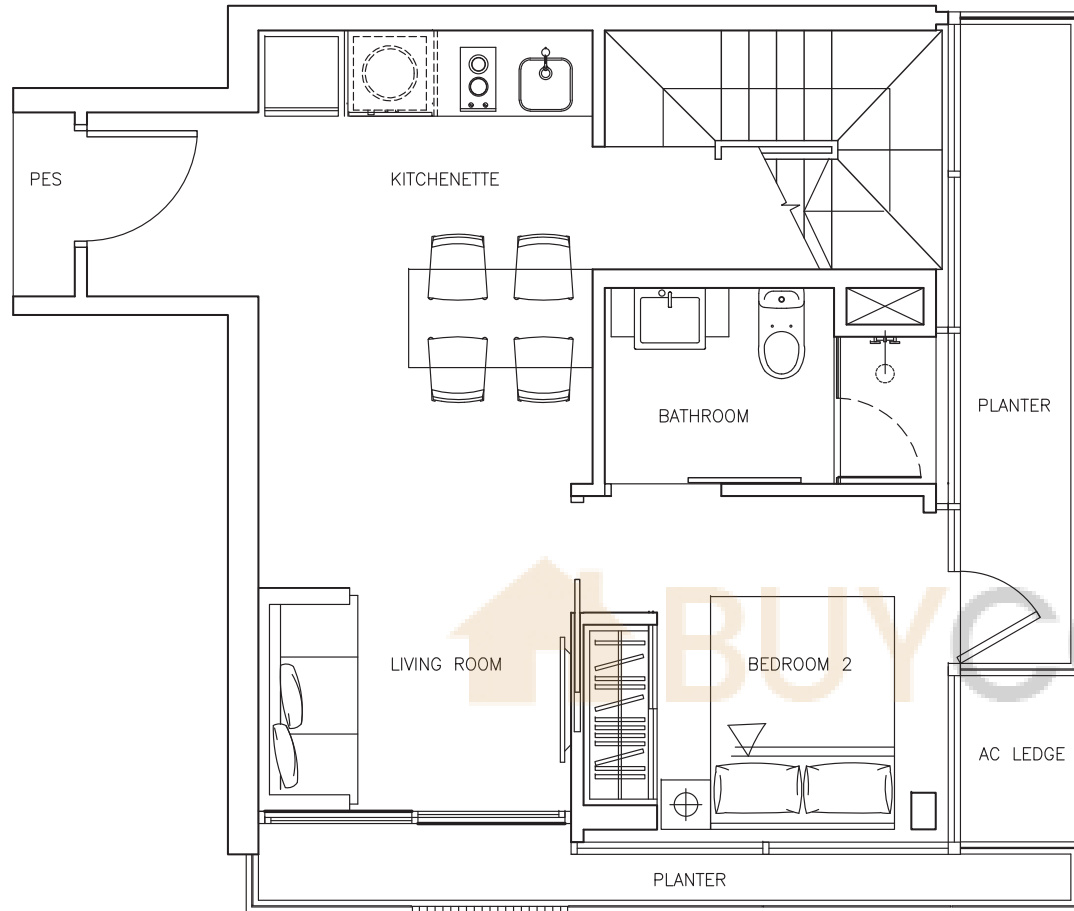

LOWER PENTHOUSE
#10-07

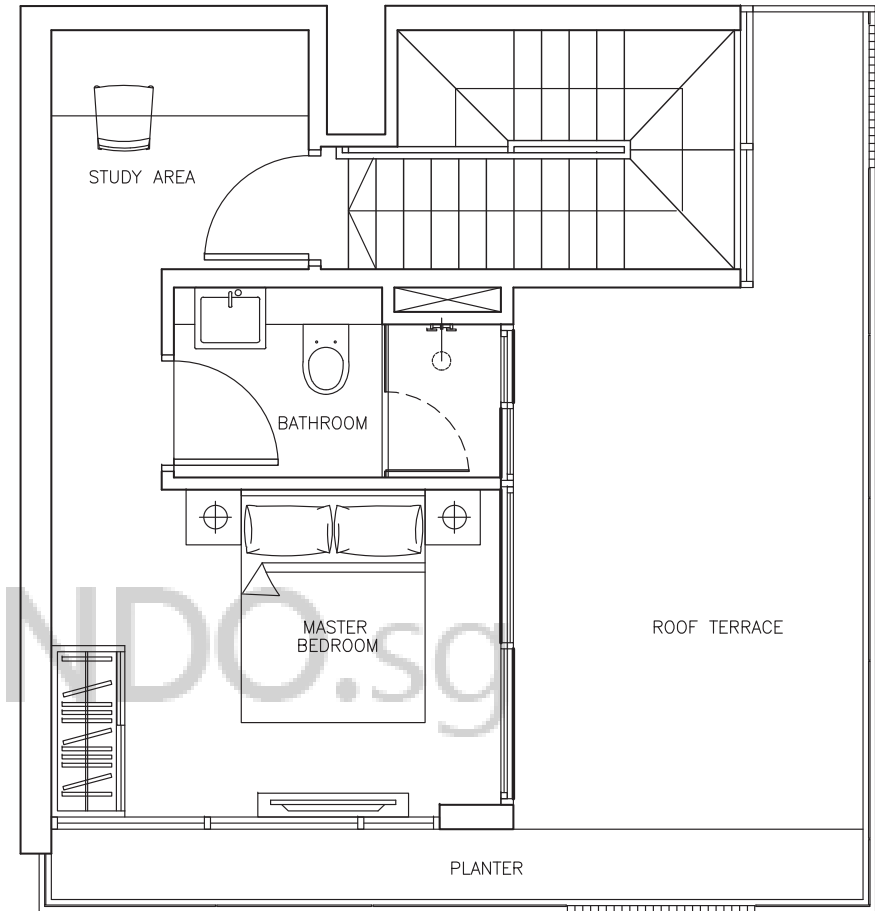

UPPER PENTHOUSE

PENTHOUSE 2 BEDROOM + STUDY
TYPE PH5B

103 sq.m / 1109 sq.ft

- Notes:
1. Areas includes PES / Roof Terraces (where applicable), AC Ledge, strata voids and planters
 2. All plans are not to scale and subject to change as may be approved by the relevant authorities

19 Tong Watt Road

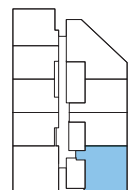

10TH & ATTIC FLOOR

