

Residential Tower
Roof Plan

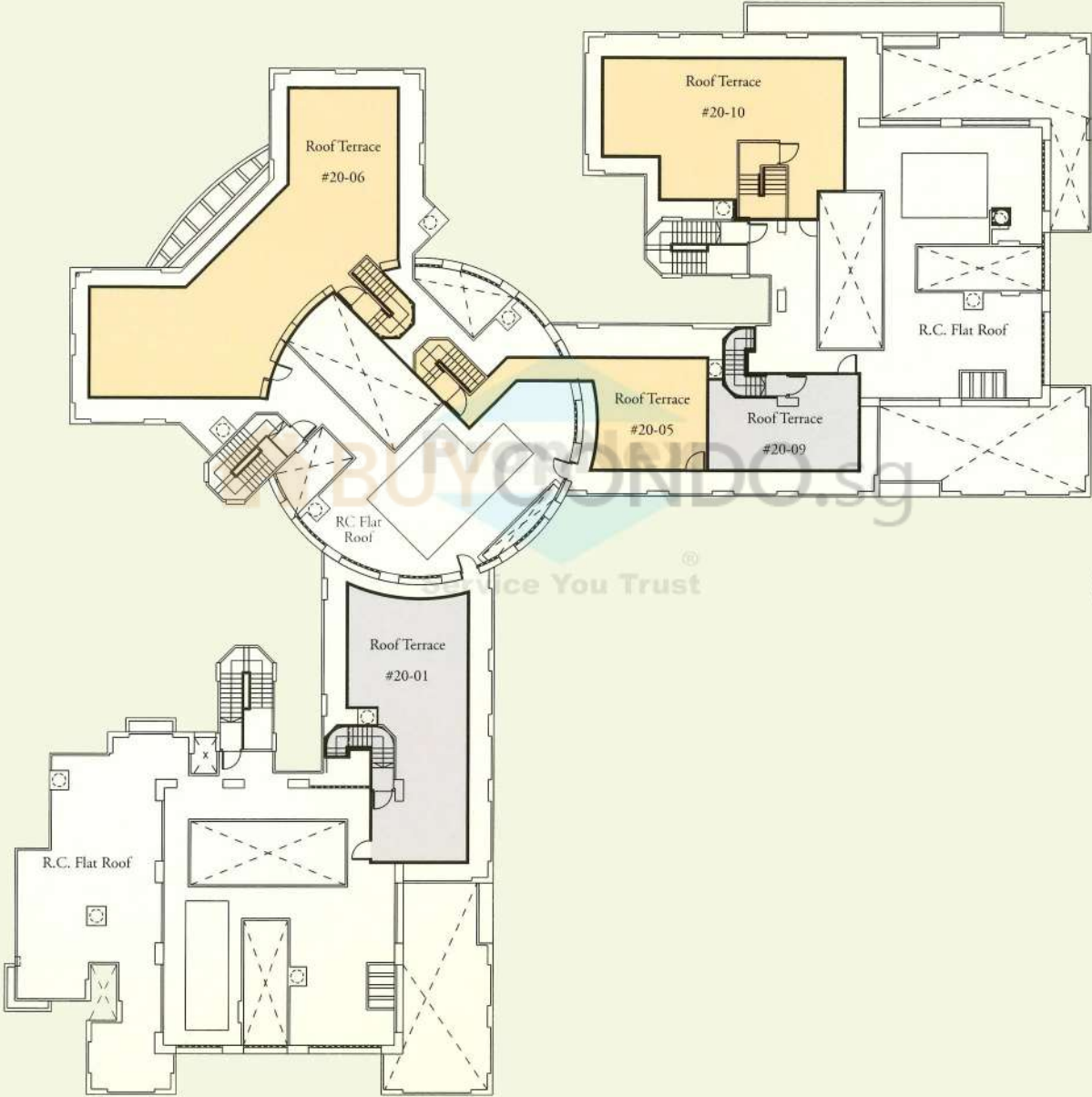

Residential Tower
20th Storey Plan



<i>Unit</i>	<i>Approx. Area (sq ft)</i>	<i>Type</i>
#20-01	2,002	C4r
#20-02	689	A2
#20-03	753	A1b
#20-05	2,174	D2r
#20-06	2,971	D3r
#20-09	1,679	C4r
#20-10	3,035	D1r

Residential Tower 19th Storey Plan

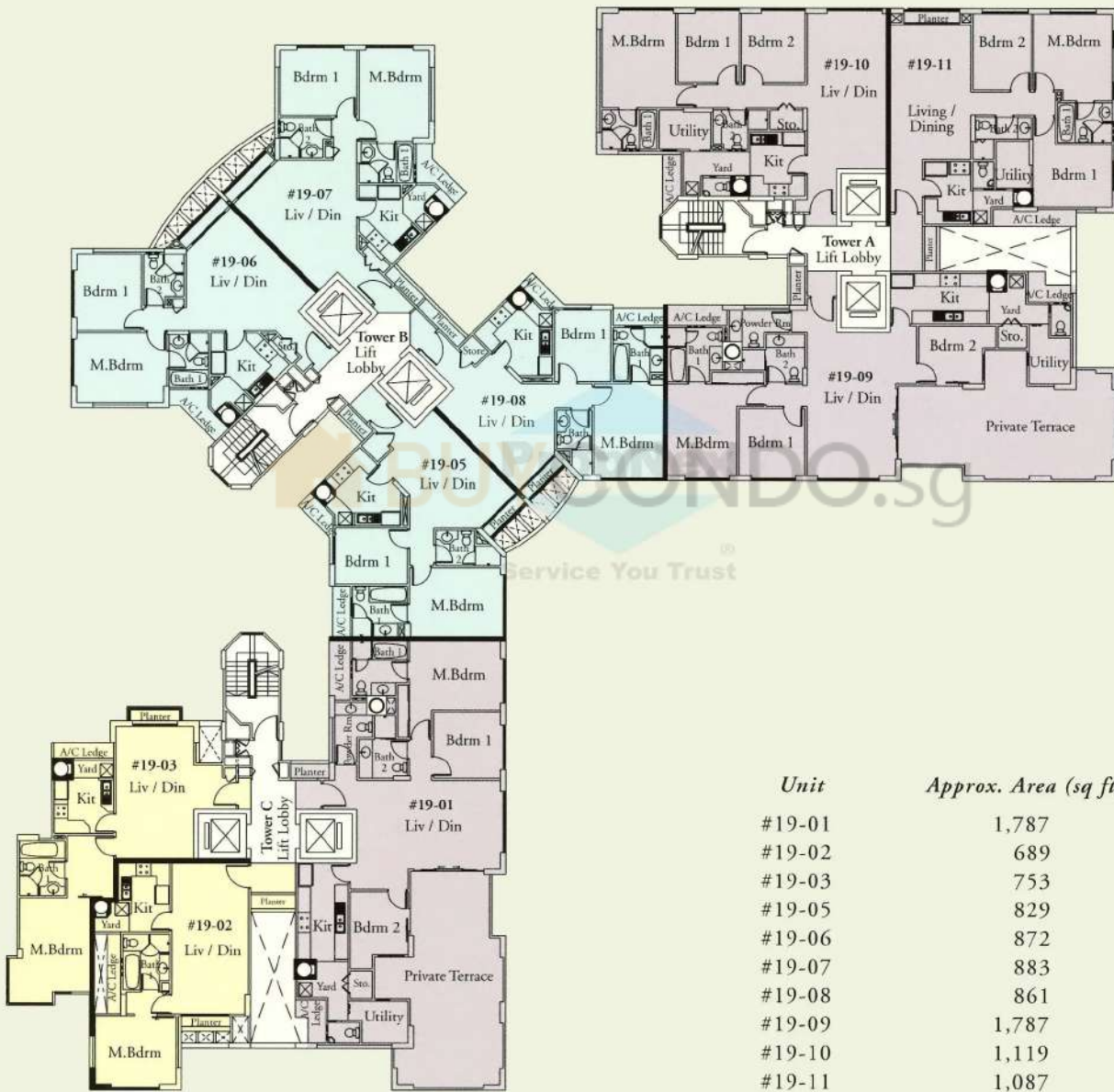

Residential Tower
 Typical 17th - 18th Storey Plan



<i>Unit</i>	<i>Approx. Area (sq ft)</i>	<i>Type</i>
#17-01-#18-01	936	B1
#17-02-#18-02	667	A2
#17-03-#18-03	753	A3
#17-04-#18-04	840	B2
#17-05-#18-05	829	B3
#17-06-#18-06	872	B4
#17-07-#18-07	883	B4
#17-08-#18-08	861	B3
#17-09-#18-09	840	B2
#17-10-#18-10	1,119	C1
#17-11-#18-11	1,066	C2
#17-12-#18-12	936	B1

Residential Tower
 Typical 7th - 16th Storey Plan



<i>Unit</i>	<i>Approx. Area (sq ft)</i>	<i>Type</i>
#07-01-#16-01	936	B1
#07-02-#16-02	667	A2
#07-03-#16-03	732	A1
#07-04-#16-04	840	B2
#07-05-#16-05	829	B3
#07-06-#16-06	872	B4
#07-07-#16-07	883	B4
#07-08-#16-08	861	B3
#07-09-#16-09	840	B2
#07-10-#16-10	1,119	C1
#07-11-#16-11	1,066	C2
#07-12-#16-12	936	B1

Residential Tower 6th Storey Plan



<i>Unit</i>	<i>Approx. Area (sq ft)</i>	<i>Type</i>
#06-01	936	B1
#06-02	667	A2
#06-03	732	A1
#06-04	840	B2
#06-06	872	B4
#06-07	915	B4
#06-09	840	B2
#06-10	1,119	C1
#06-11	1,066	C2
#06-12	936	B1

Residential Tower
5th Storey Plan

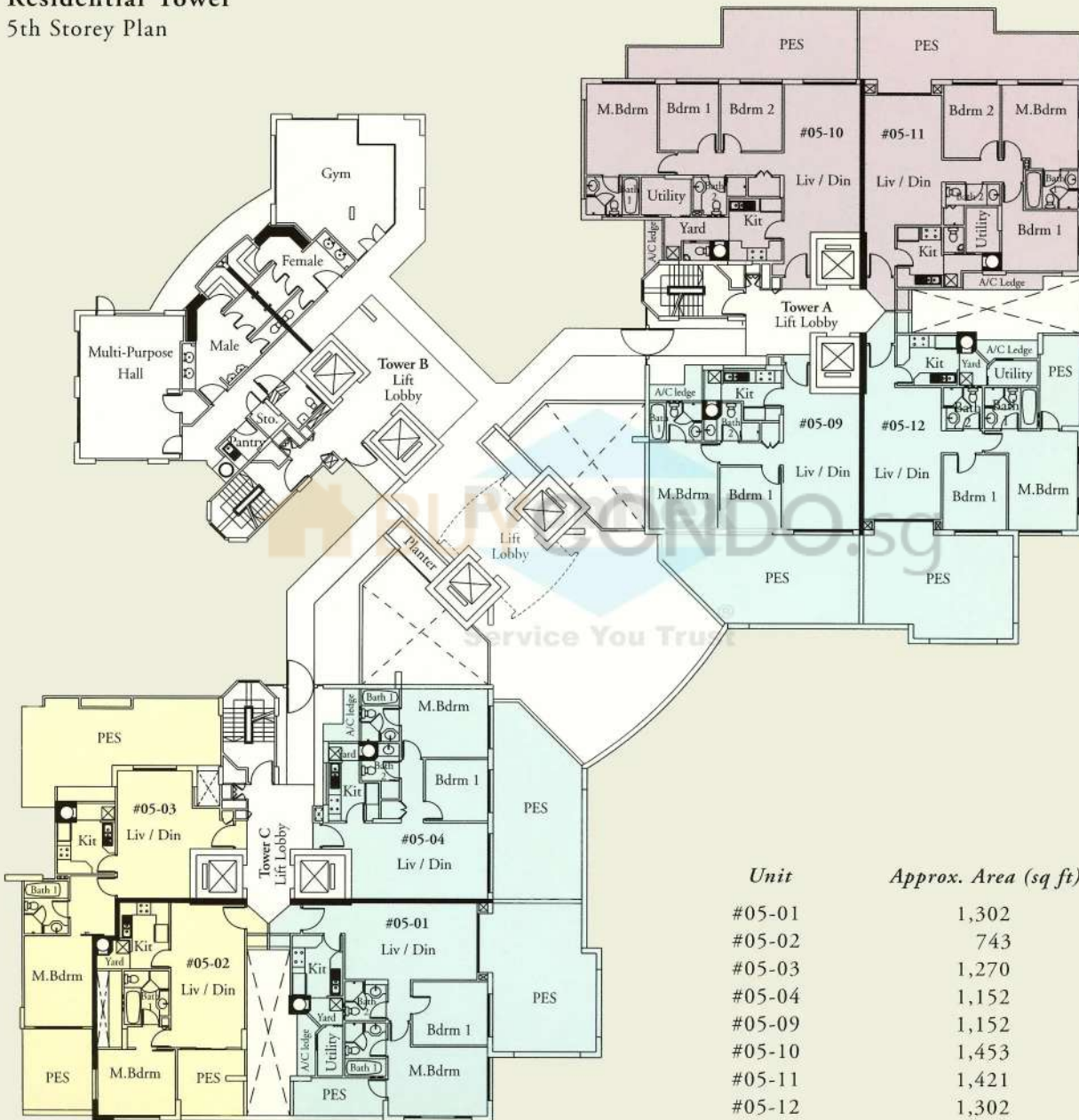

<i>Unit</i>	<i>Approx. Area (sq ft)</i>	<i>Type</i>
#05-01	1,302	B1p
#05-02	743	A2p
#05-03	1,270	A1p
#05-04	1,152	B2p
#05-09	1,152	B2p
#05-10	1,453	C1p
#05-11	1,421	C2p
#05-12	1,302	B1p