

1 Bedroom

Type A1 (55 sq m / 592 sq ft)

#03-01 to #13-01
#16-01 to #31-01
#03-07 to #13-07
#16-07 to #31-07

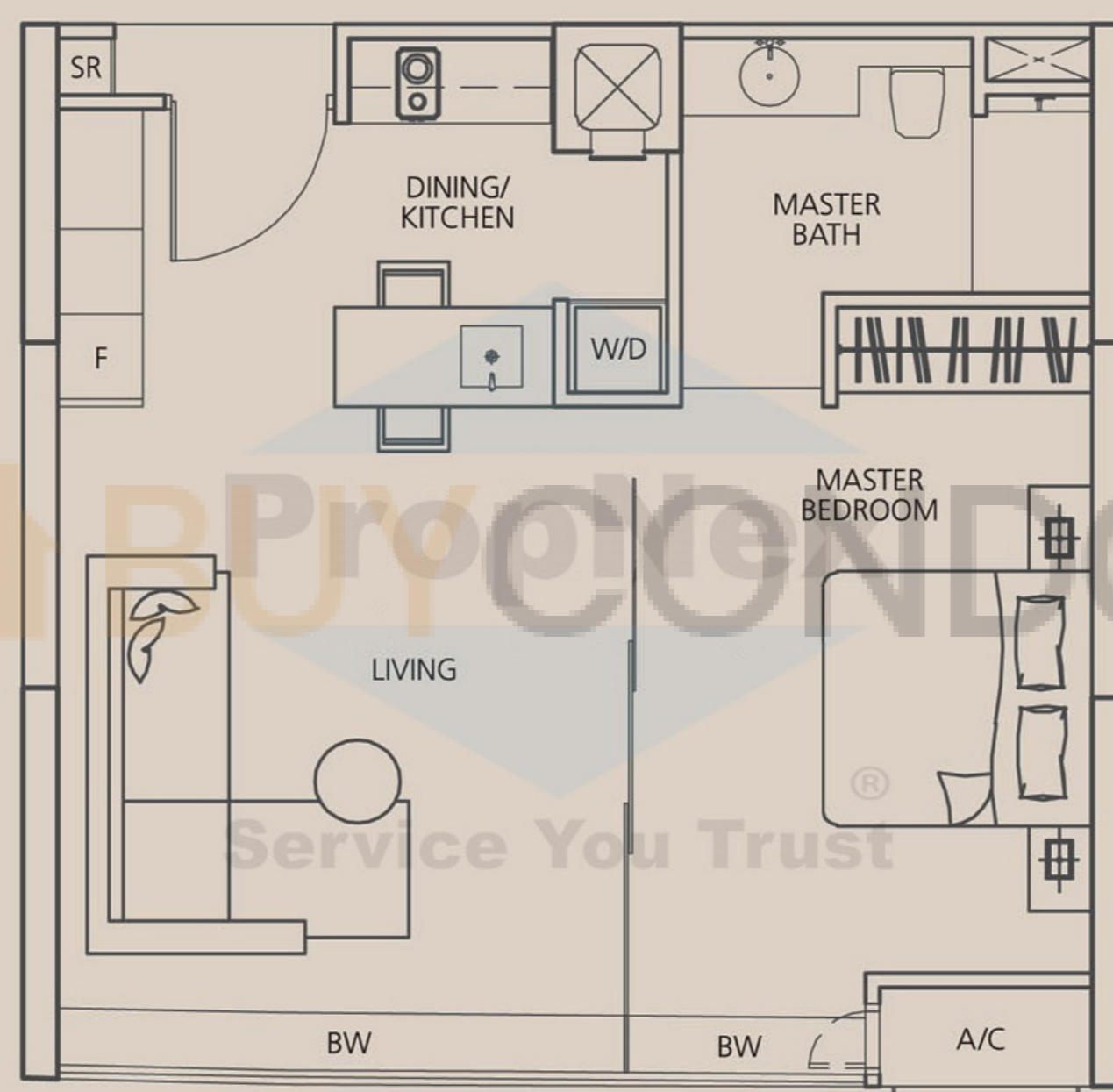
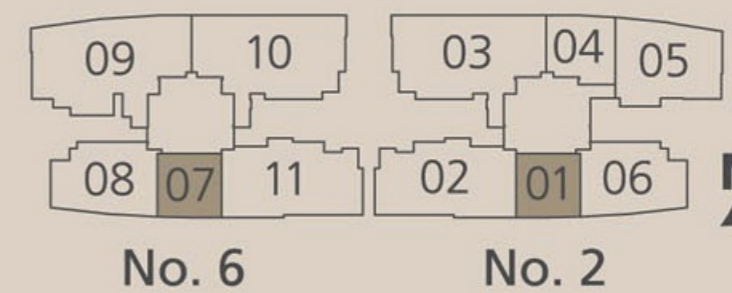

martinplace
RESIDENCES

Area includes A/C ledge, bay window, balcony, planter and roof terrace. Some units are mirror images of the apartment plans shown in the brochure. Please refer to the key plans for orientation. All plans are not drawn to scale and are subject to changes as may be approved by the relevant authorities. All floor areas are approximate measurements only and are subject to government resurvey.

1 Bedroom

Type A2 (60 sq m / 646 sq ft)

#02-04 to #13-04

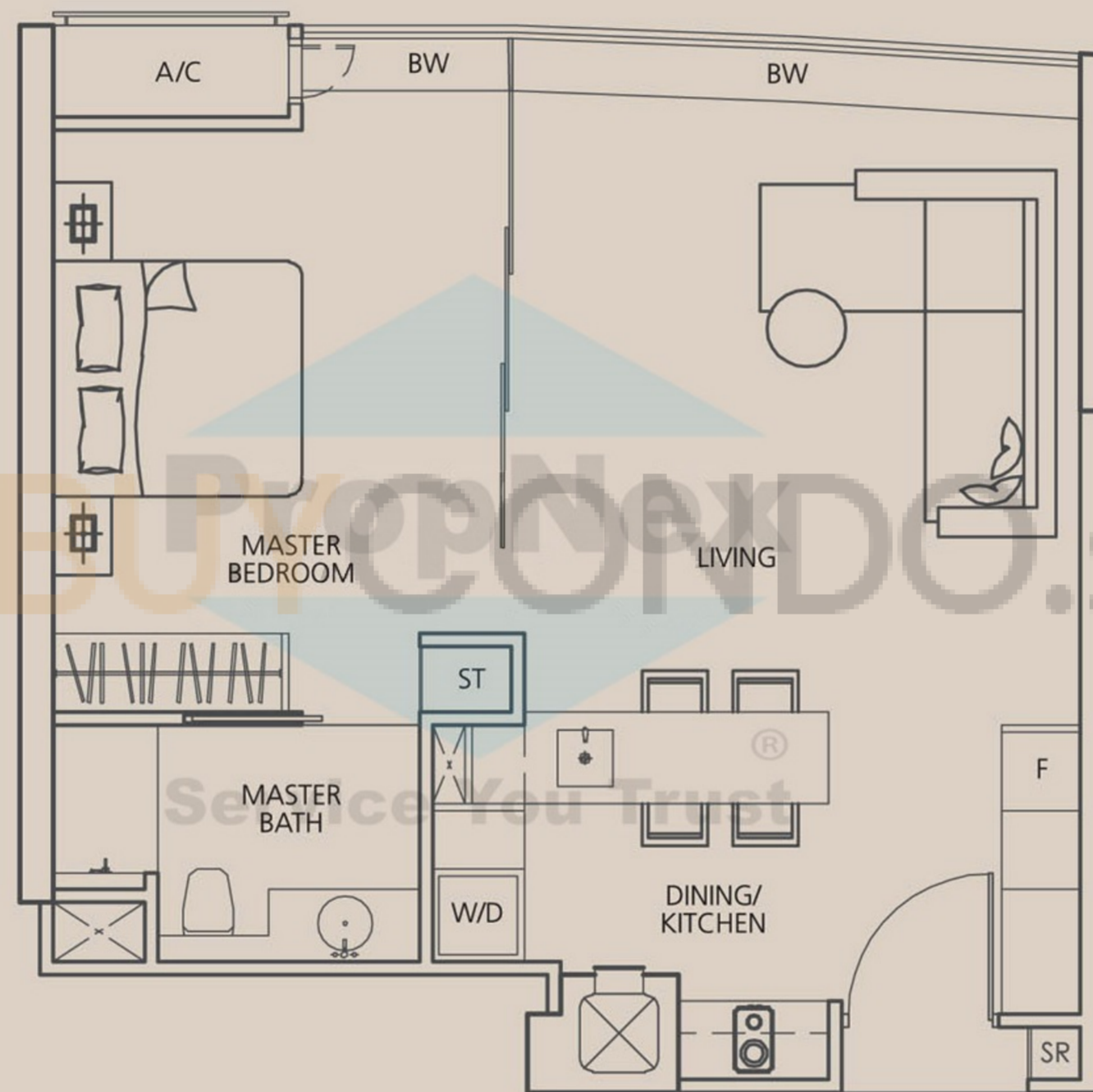
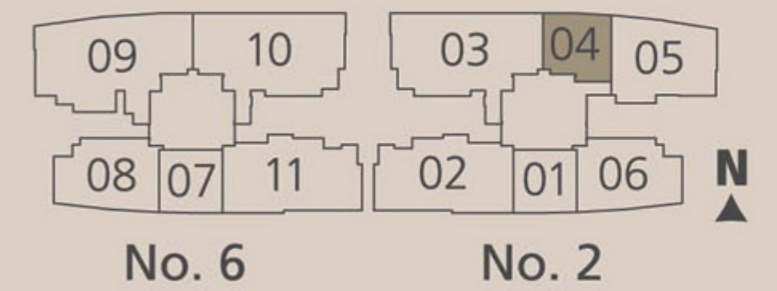

martinplace
RESIDENCES

Area includes A/C ledge, bay window, balcony, planter and roof terrace. Some units are mirror images of the apartment plans shown in the brochure. Please refer to the key plans for orientation. All plans are not drawn to scale and are subject to changes as may be approved by the relevant authorities. All floor areas are approximate measurements only and are subject to government resurvey.

2 Bedroom

Type B1 (108 sq m / 1,163 sq ft)

#02-05 to #15-05

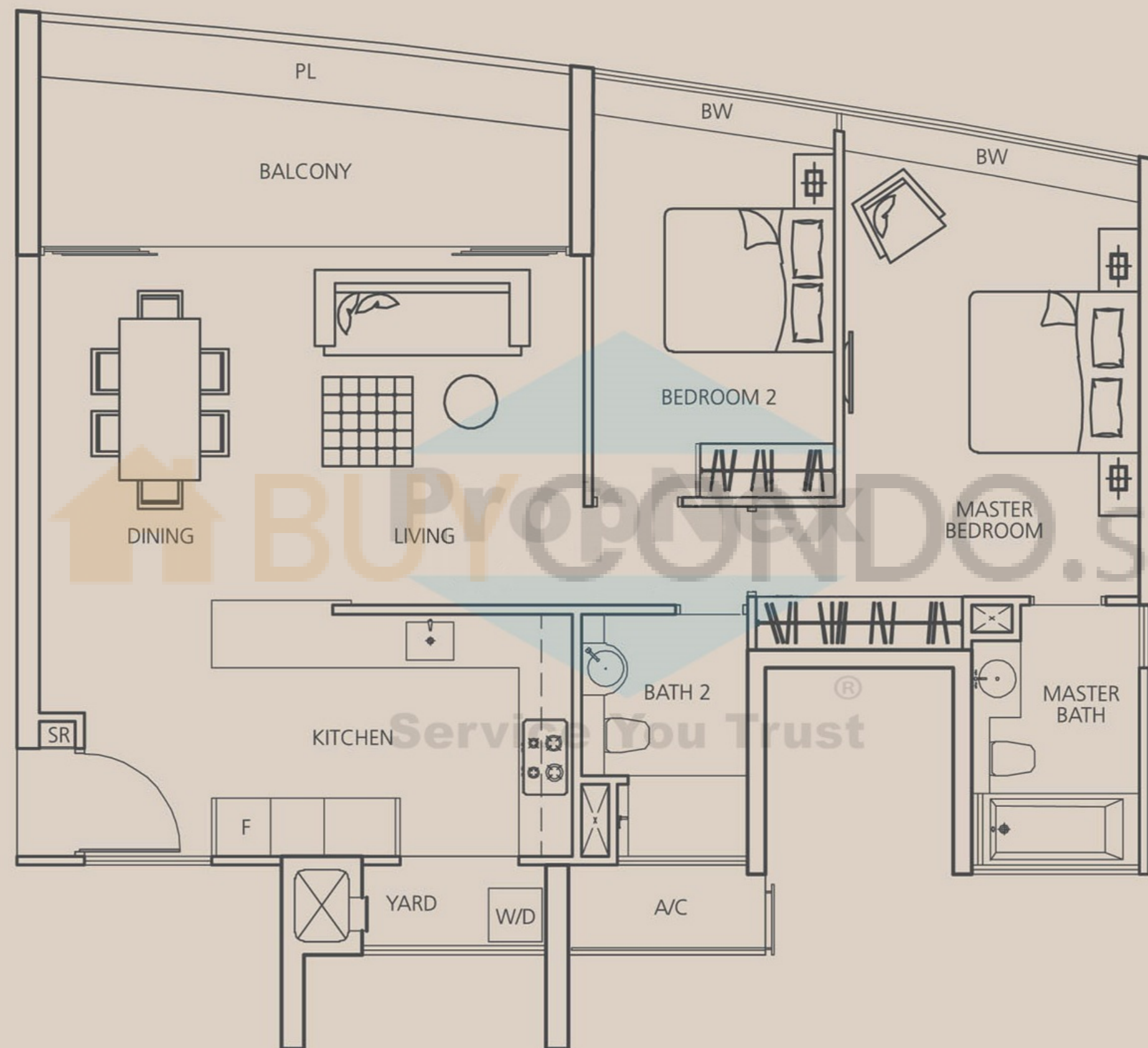
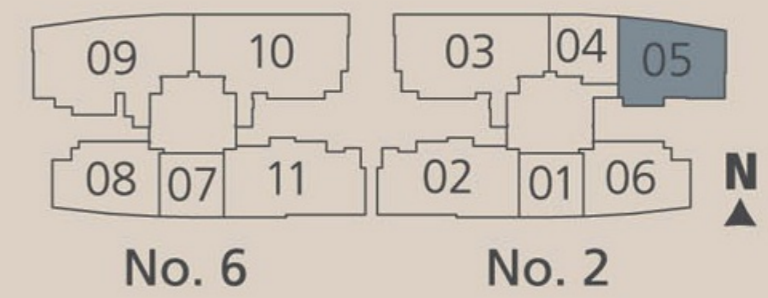

martinplace
RESIDENCES

Area includes A/C ledge, bay window, balcony, planter and roof terrace. Some units are mirror images of the apartment plans shown in the brochure. Please refer to the key plans for orientation. All plans are not drawn to scale and are subject to changes as may be approved by the relevant authorities. All floor areas are approximate measurements only and are subject to government resurvey.

2 Bedroom

Type B2 (97 sq m / 1,044 sq ft)

#03-06 to #31-06

#03-08 to #31-08

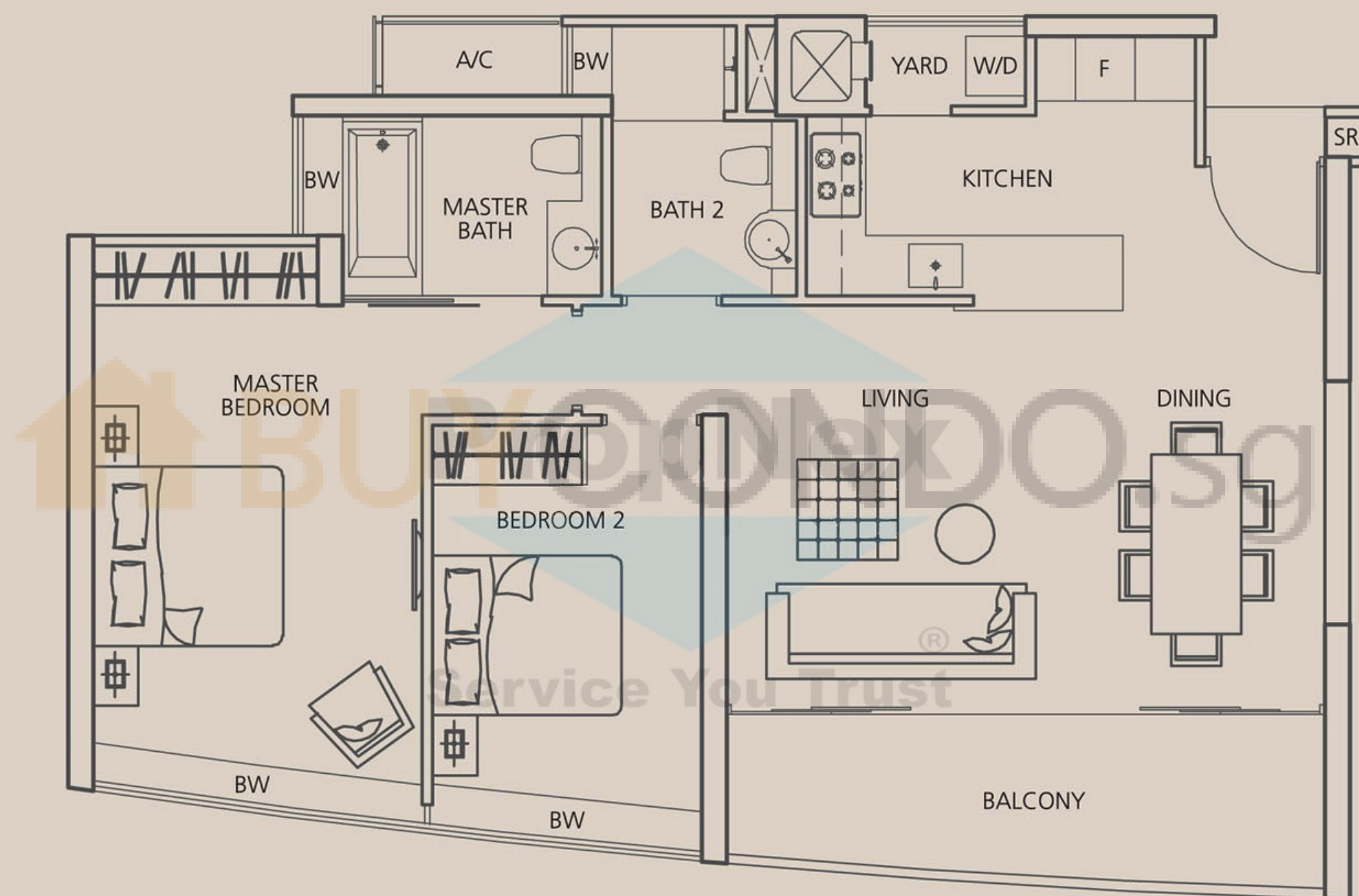
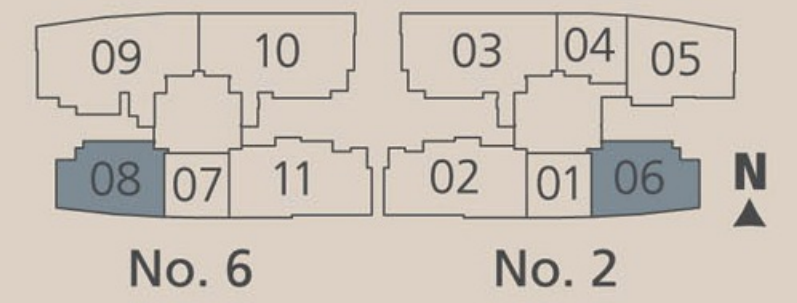

martinplace
RESIDENCES

Area includes A/C ledge, bay window, balcony, planter and roof terrace. Some units are mirror images of the apartment plans shown in the brochure. Please refer to the key plans for orientation. All plans are not drawn to scale and are subject to changes as may be approved by the relevant authorities. All floor areas are approximate measurements only and are subject to government resurvey.

3 Bedroom

Type C1 (132 sq m / 1,421 sq ft)

#03-02 to #13-02

#16-02 to #31-02

#03-11 to #13-11

#16-11 to #31-11

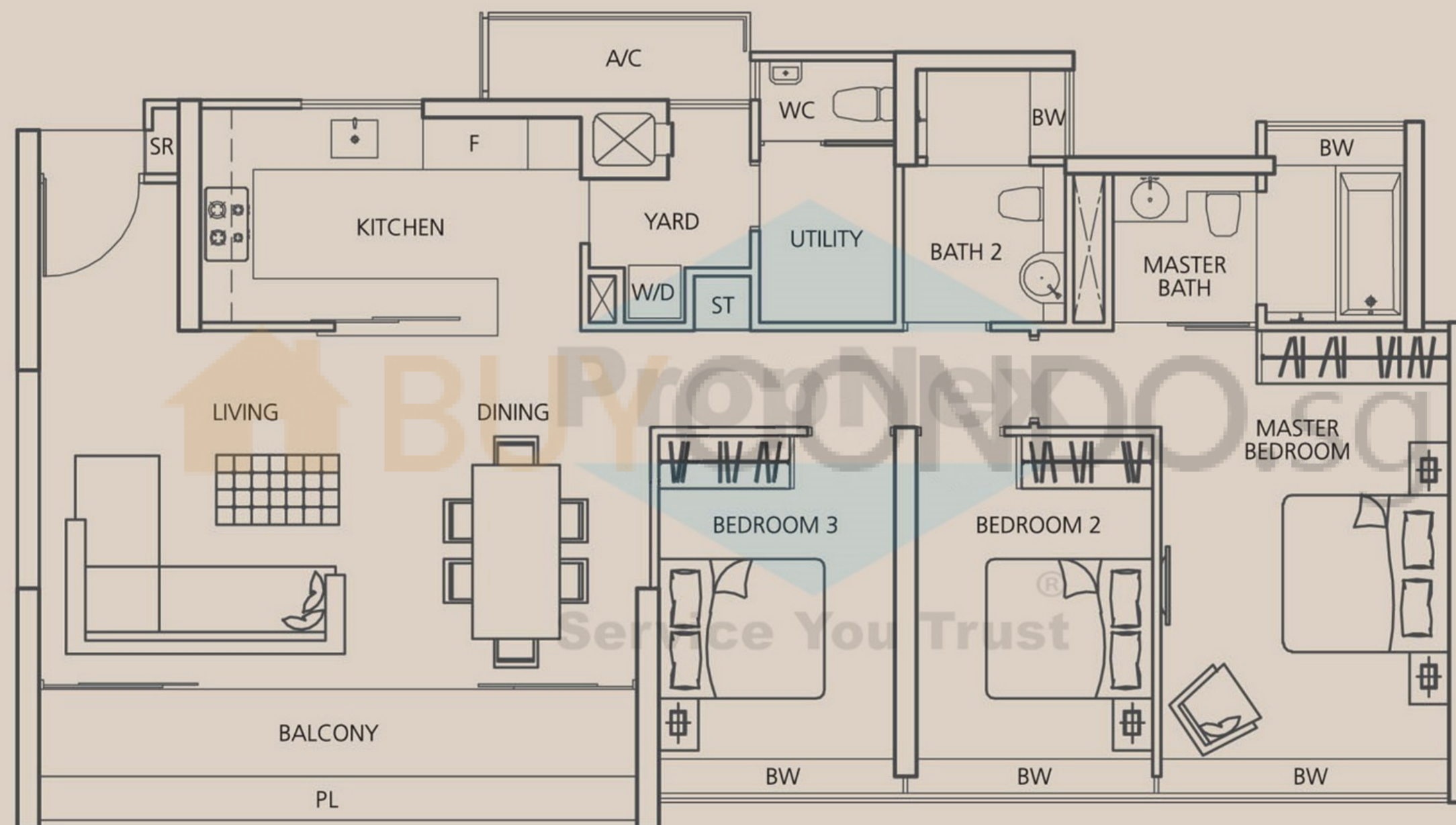
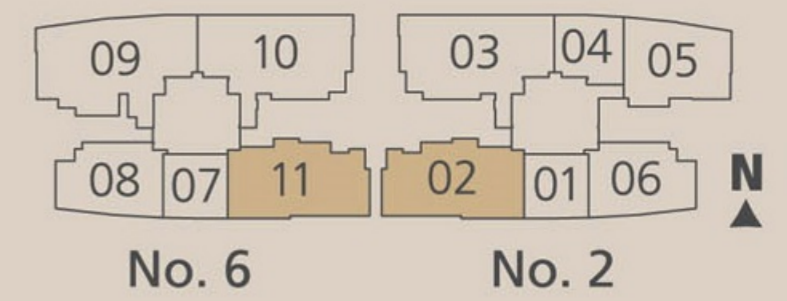

martinplace
RESIDENCES

Area includes A/C ledge, bay window, balcony, planter and roof terrace. Some units are mirror images of the apartment plans shown in the brochure. Please refer to the key plans for orientation. All plans are not drawn to scale and are subject to changes as may be approved by the relevant authorities. All floor areas are approximate measurements only and are subject to government resurvey.

3 Bedroom + Study

Type C2 (160 sq m / 1,722 sq ft)

- #02-03 to #13-03
- #16-03 to #31-03
- #02-10 to #13-10
- #16-10 to #31-10

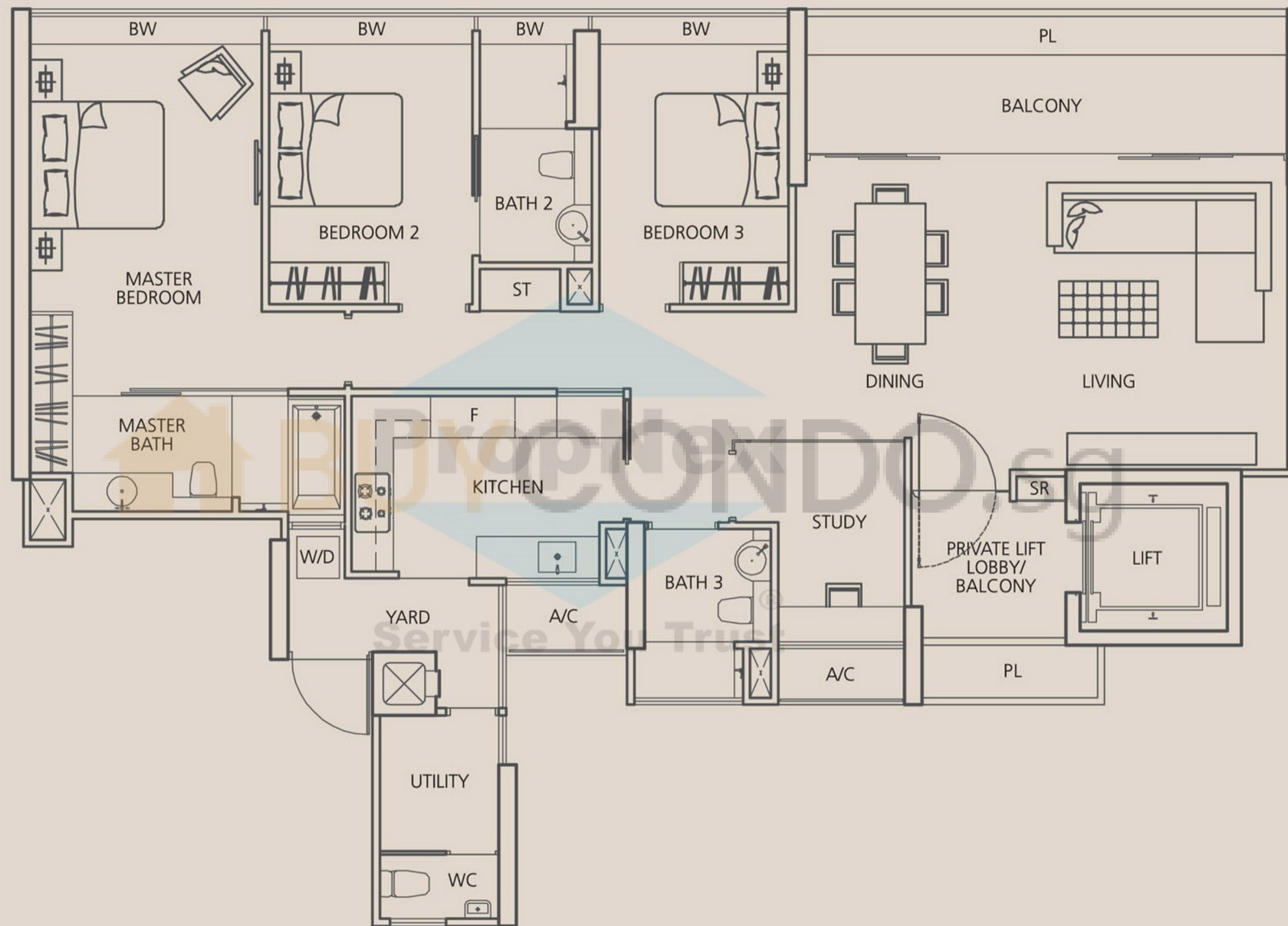
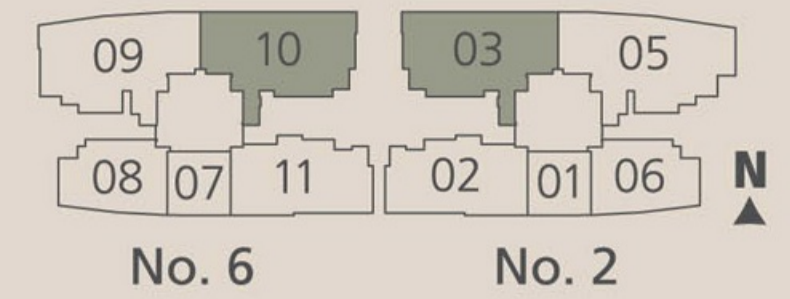

martinplace
RESIDENCES

Area includes A/C ledge, bay window, balcony, planter and roof terrace. Some units are mirror images of the apartment plans shown in the brochure. Please refer to the key plans for orientation. All plans are not drawn to scale and are subject to changes as may be approved by the relevant authorities. All floor areas are approximate measurements only and are subject to government resurvey.

4 Bedroom

Type D1 (176 sq m / 1,894 sq ft)

#02-09 to #31-09

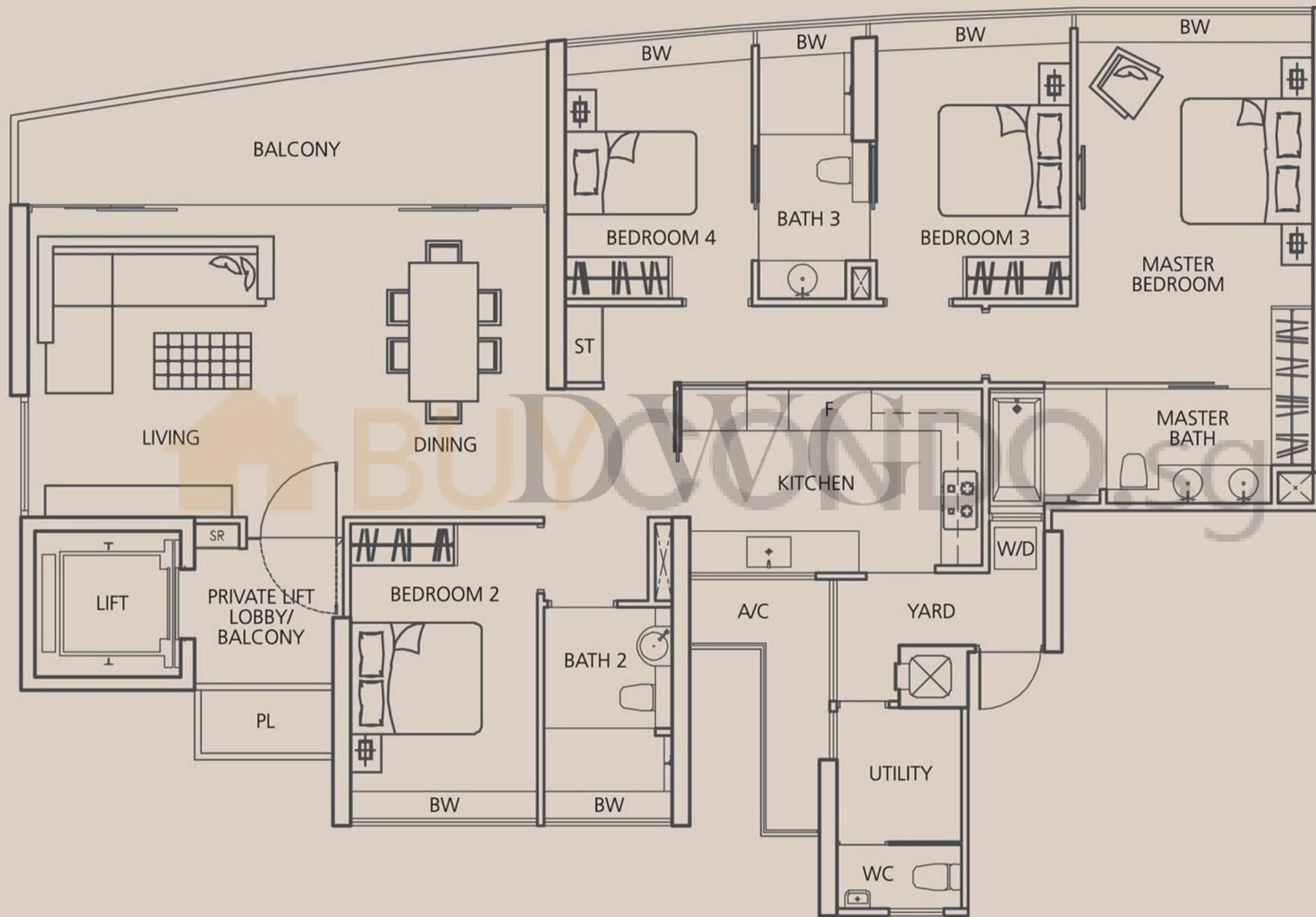
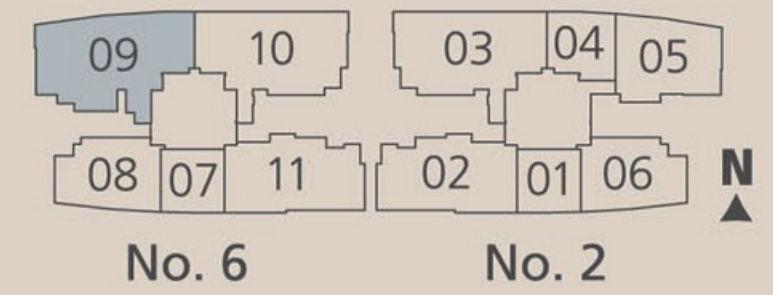

martinplace
RESIDENCES

Area includes A/C ledge, bay window, balcony, planter and roof terrace. Some units are mirror images of the apartment plans shown in the brochure. Please refer to the key plans for orientation. All plans are not drawn to scale and are subject to changes as may be approved by the relevant authorities. All floor areas are approximate measurements only and are subject to government resurvey.

4 Bedroom

Type D2 (186 sq m / 2,002 sq ft)

#16-05 to #31-05

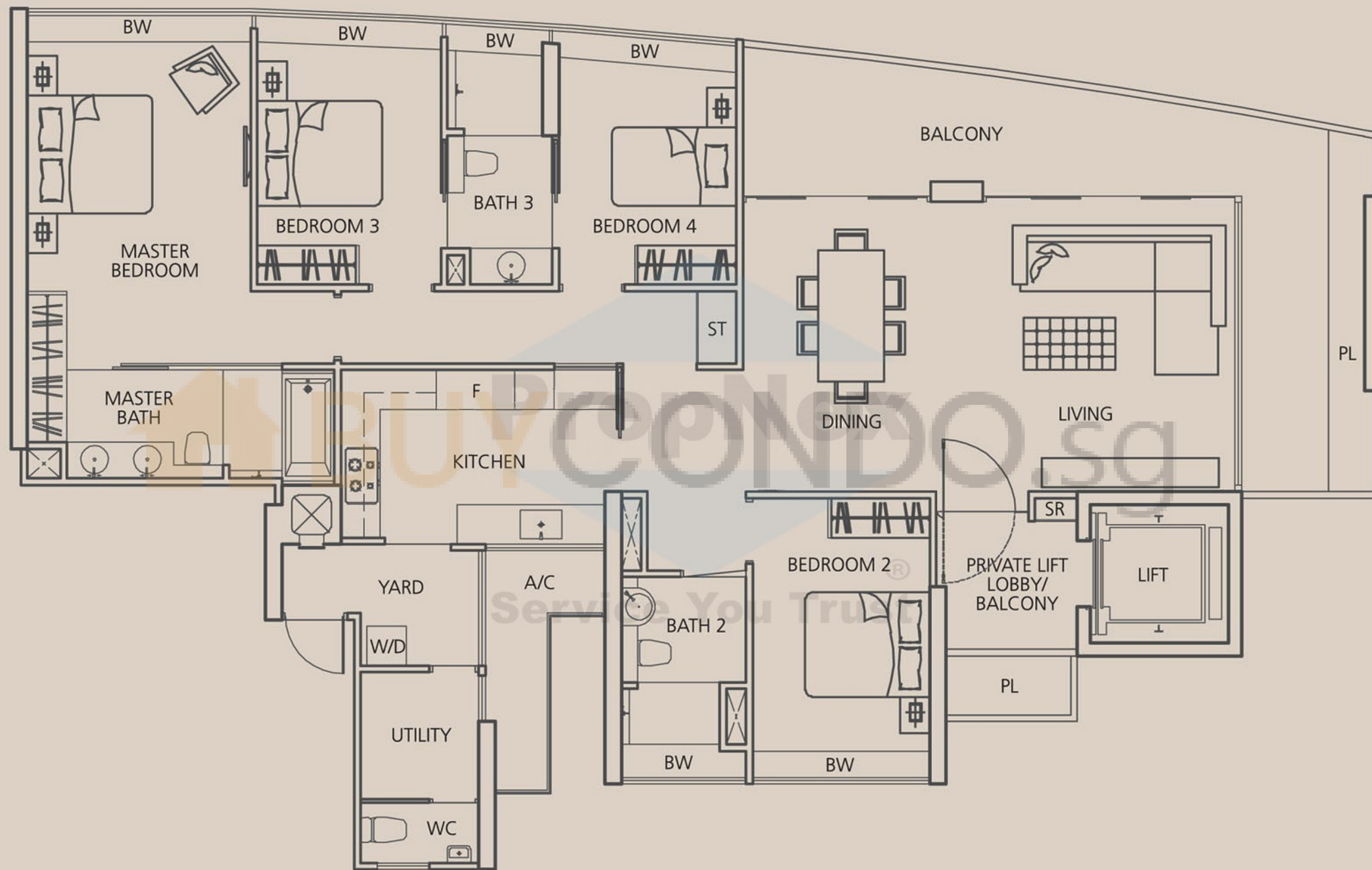
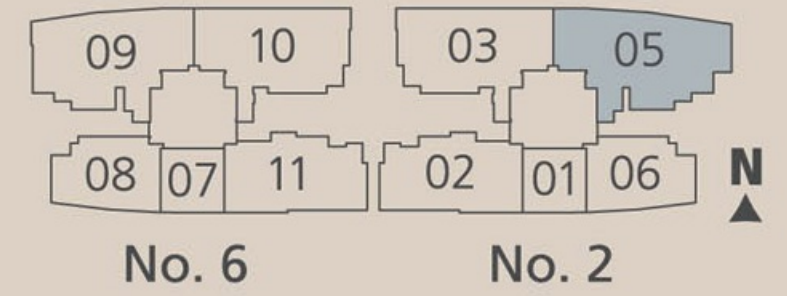

martinplace
RESIDENCES

Area includes A/C ledge, bay window, balcony, planter and roof terrace. Some units are mirror images of the apartment plans shown in the brochure. Please refer to the key plans for orientation. All plans are not drawn to scale and are subject to changes as may be approved by the relevant authorities. All floor areas are approximate measurements only and are subject to government resurvey.

Penthouse

Type E1, Type E1a (309 sq m / 3,326 sq ft)

Type E1 #32-08

Type E1a #33-08

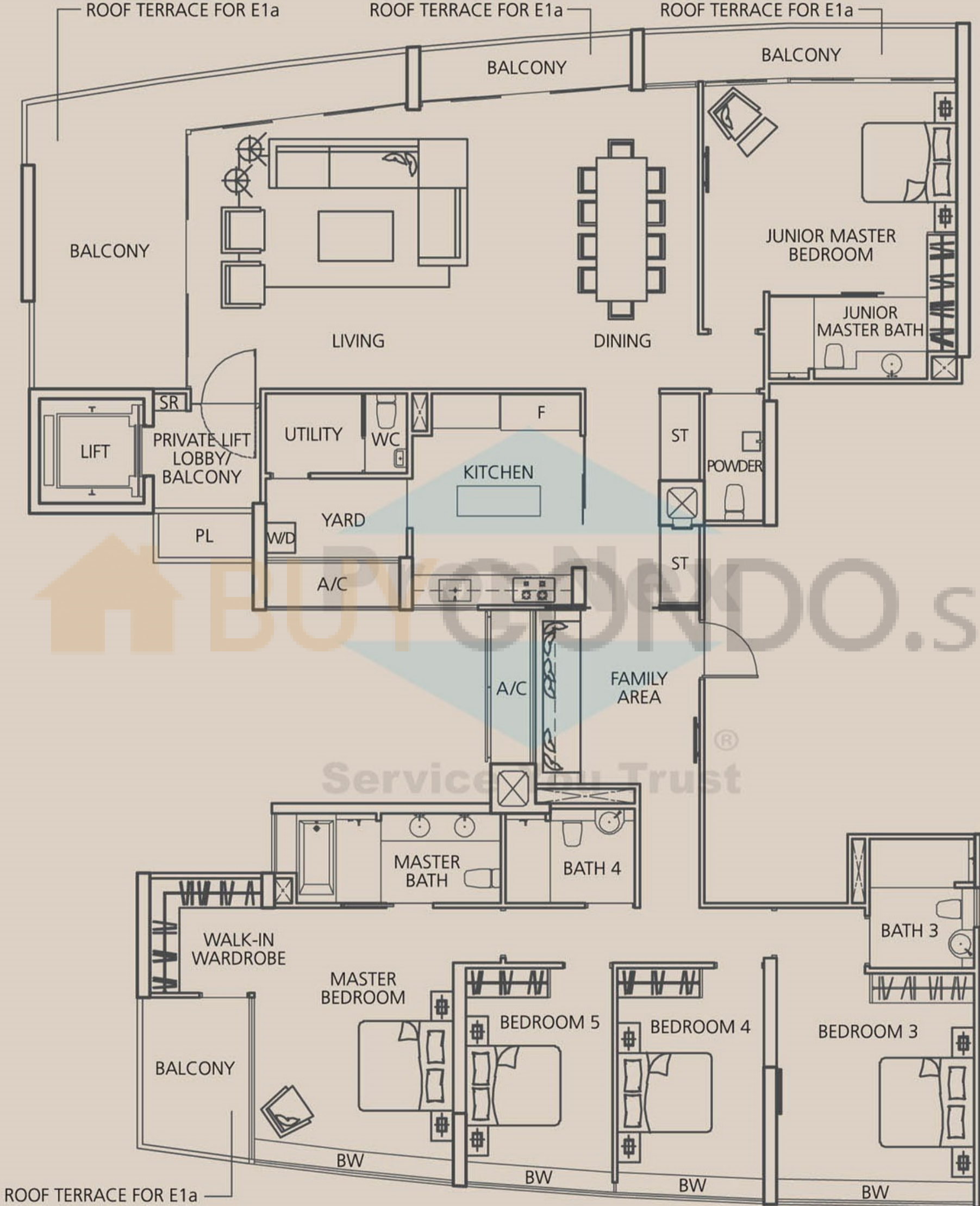
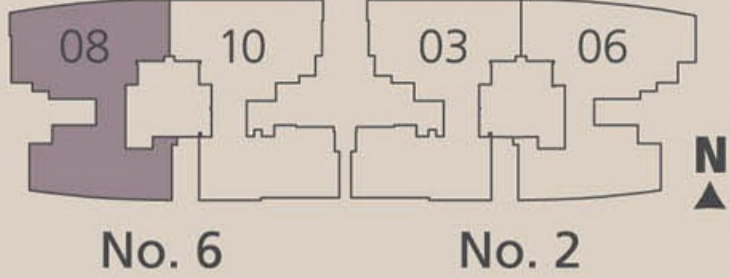

martinplace
RESIDENCES

Area includes A/C ledge, bay window, balcony, planter and roof terrace. Some units are mirror images of the apartment plans shown in the brochure. Please refer to the key plans for orientation. All plans are not drawn to scale and are subject to changes as may be approved by the relevant authorities. All floor areas are approximate measurements only and are subject to government resurvey.

Penthouse

Type E2, Type E2a (314 sq m / 3,380 sq ft)

Type E2 #32-03, #32-10

Type E2a #33-03, #33-10

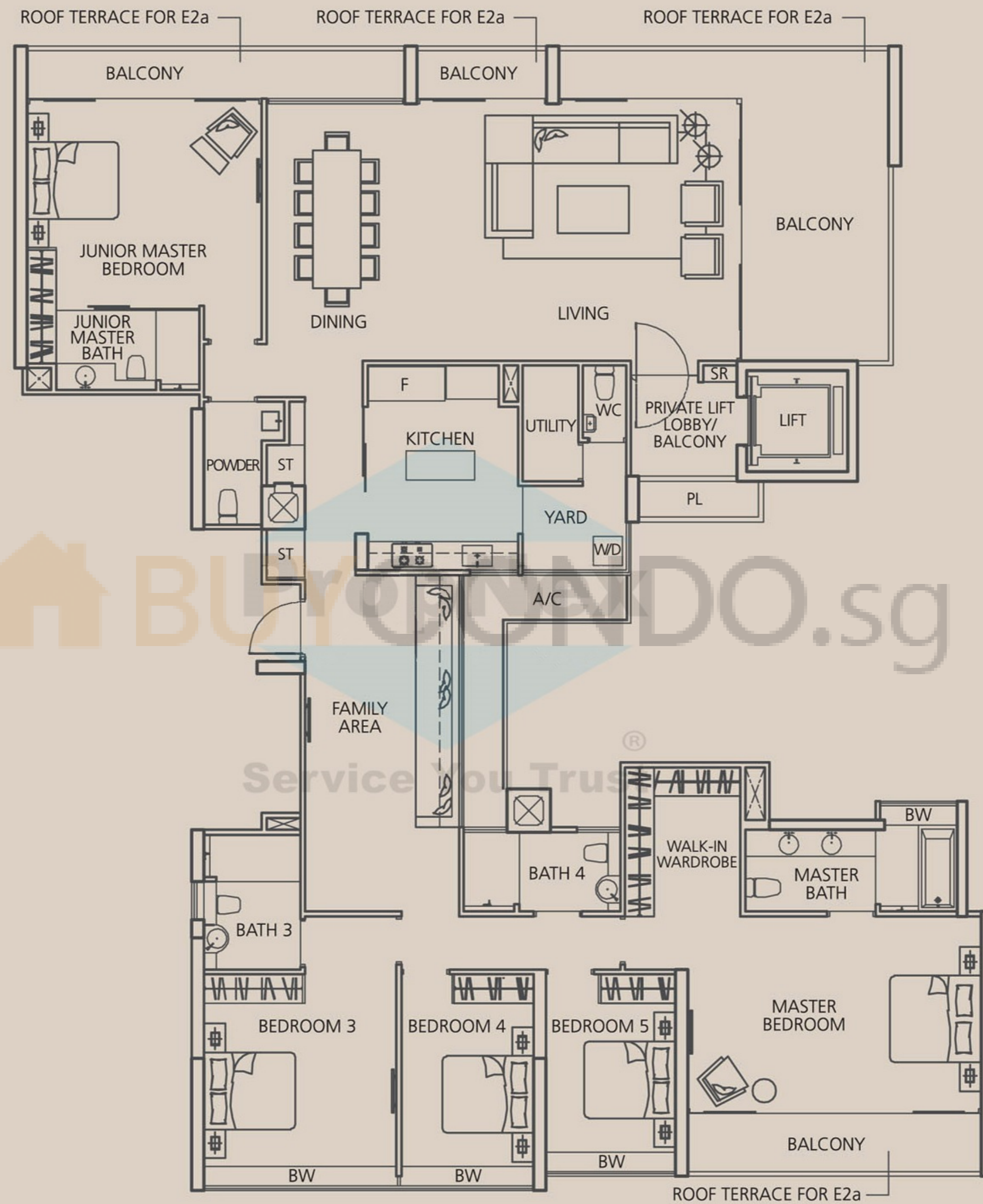
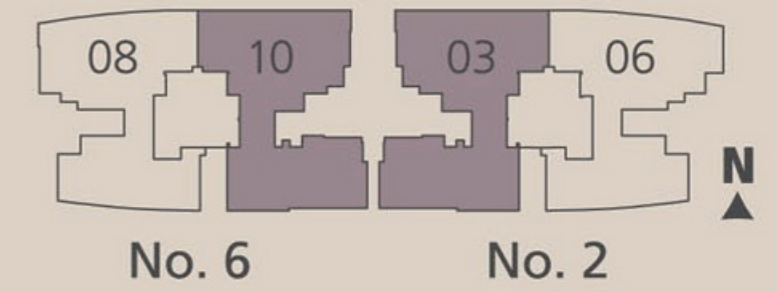

martinplace
RESIDENCES

Area includes A/C ledge, bay window, balcony, planter and roof terrace. Some units are mirror images of the apartment plans shown in the brochure. Please refer to the key plans for orientation. All plans are not drawn to scale and are subject to changes as may be approved by the relevant authorities. All floor areas are approximate measurements only and are subject to government resurvey.

Penthouse

Type E3, Type E3a (319 sq m / 3,434 sq ft)

Type E3 #32-06

Type E3a #33-06

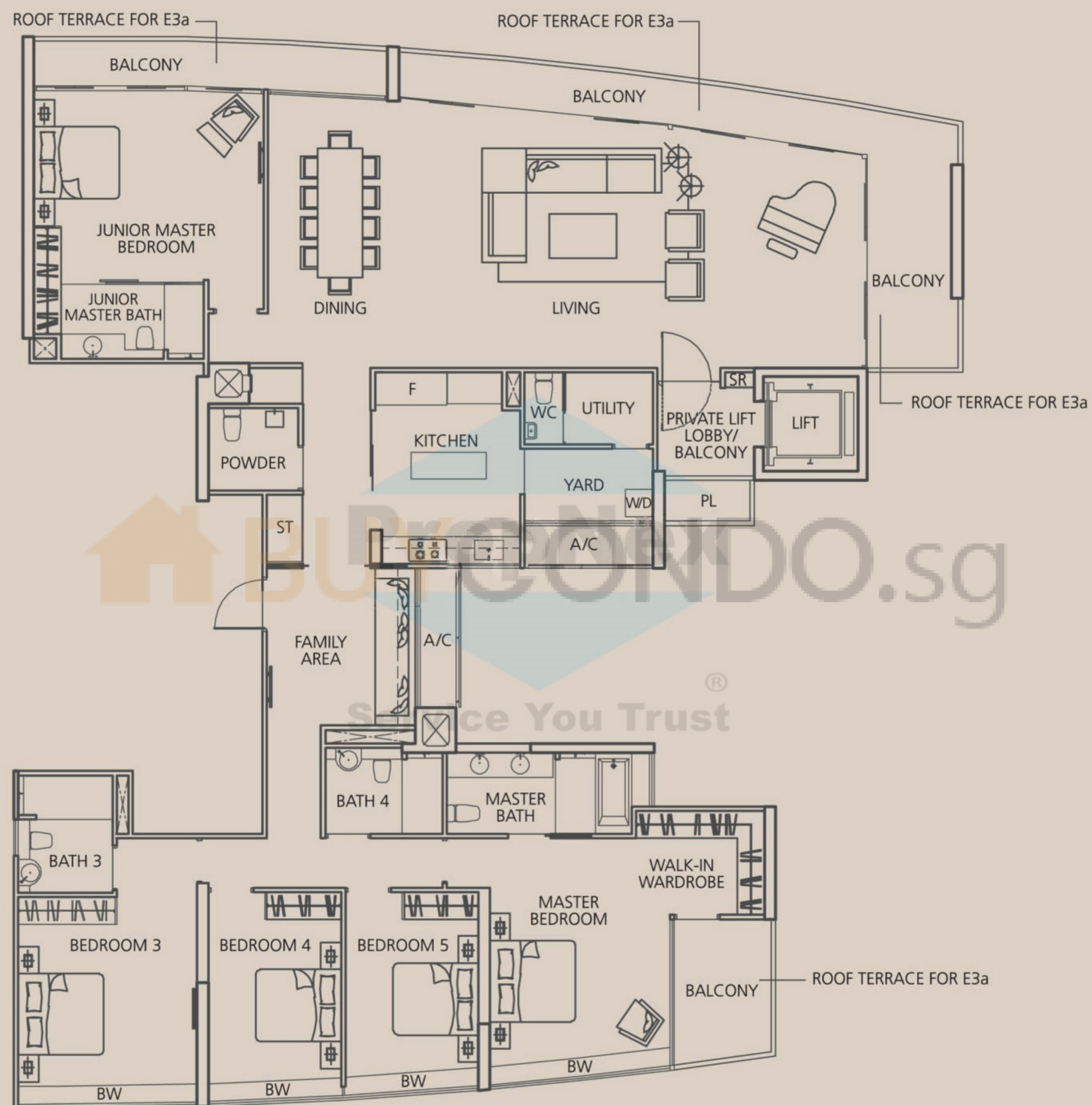
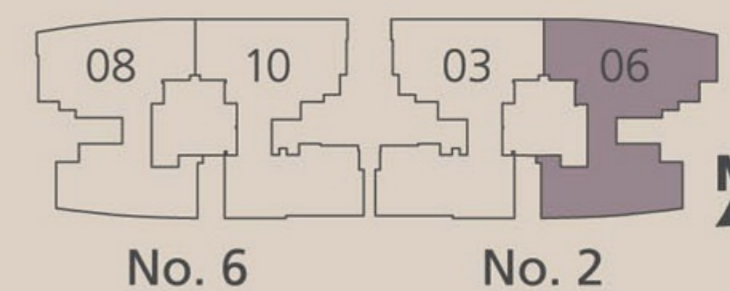

martinplace
RESIDENCES

Area includes A/C ledge, bay window, balcony, planter and roof terrace. Some units are mirror images of the apartment plans shown in the brochure. Please refer to the key plans for orientation. All plans are not drawn to scale and are subject to changes as may be approved by the relevant authorities. All floor areas are approximate measurements only and are subject to government resurvey.